

FLOOR PLAN

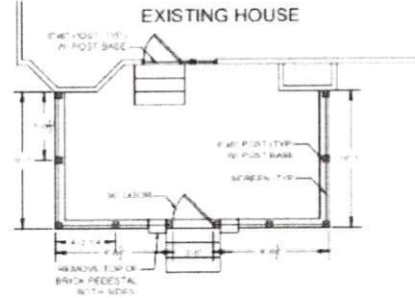

FRAMING PLAN

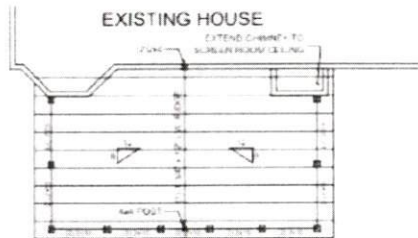

ROOF FRAMING PLAN

STRUCTURAL NOTES:

1. ALL CONSTRUCTION SHALL COMPLY WITH THE NORTH CAROLINA RESIDENTIAL BUILDING CODE 2018 EDITION.
2. FLOOR LOADS:
 

	DL (LB/ SQ. FT.)	LL (LB/ SQ. FT.)
FLOOR (PRIMARY USE ONLY)	40	10
FLOOR (SLEEPING AREAS)	30	10
ATTIC (WITH STORAGE)	20	10
DECK	15	10
DECK (WITH STORAGE)	40	10
EXTERIOR BALCONIES	60	10
STAIRS	40	10
ROOF	20	10
ROOF TRUSS	20	10
3. THE CONTRACTOR SHALL VERIFY AND BE RESPONSIBLE FOR ALL DIMENSIONS IN THE FIELD.
4. PRECUMPTIVE SOIL BEARING CAPACITY: 2000 PSF.
5. CONCRETE SHALL HAVE A MINIMUM 28 DAY STRENGTH OF 3000 PSI. PREPARED AND PLACED IN ACCORDANCE WITH AUSTRIAN STANDARD 118.
6. FRAMING LUMBER SHALL BE PRESSURE TREATED UNLESS OTHERWISE NOTED.
7. FRAMING LUMBER SHALL BE STRIP LAMINATED UNLESS OTHERWISE NOTED.
8. WIND LOADS AND EXISTING HEADWINDS SHALL BE 120 MPH. MAY BE SUBJECT TO CHANGE.

DATE: 08/08/2024	SCALE: 1/4" = 1'-0"
PROJECT: Screen Room for Christopher Hayes	DATE: 6/16/24
DESIGNER: JEFFREY MOSS, P.E.	DATE: 24/5/24
PROJECT: 1140 CHERRY LAKE DRIVE	
ADDRESS: Angier, NC 27501	
PHONE: (919) 760-0188	
EMAIL: jtmoss@jtmoss.com	
S1	