

Tyler Heishman

REVISION HISTORY			
REV.	DESCRIPTION	DATE	BY
A	RELEASED FOR QUOTE	4/19/2024	TSWALLOWS
B	ADDED STEP HSSM57740 PER REQUEST	4/27/2024	ESSEX

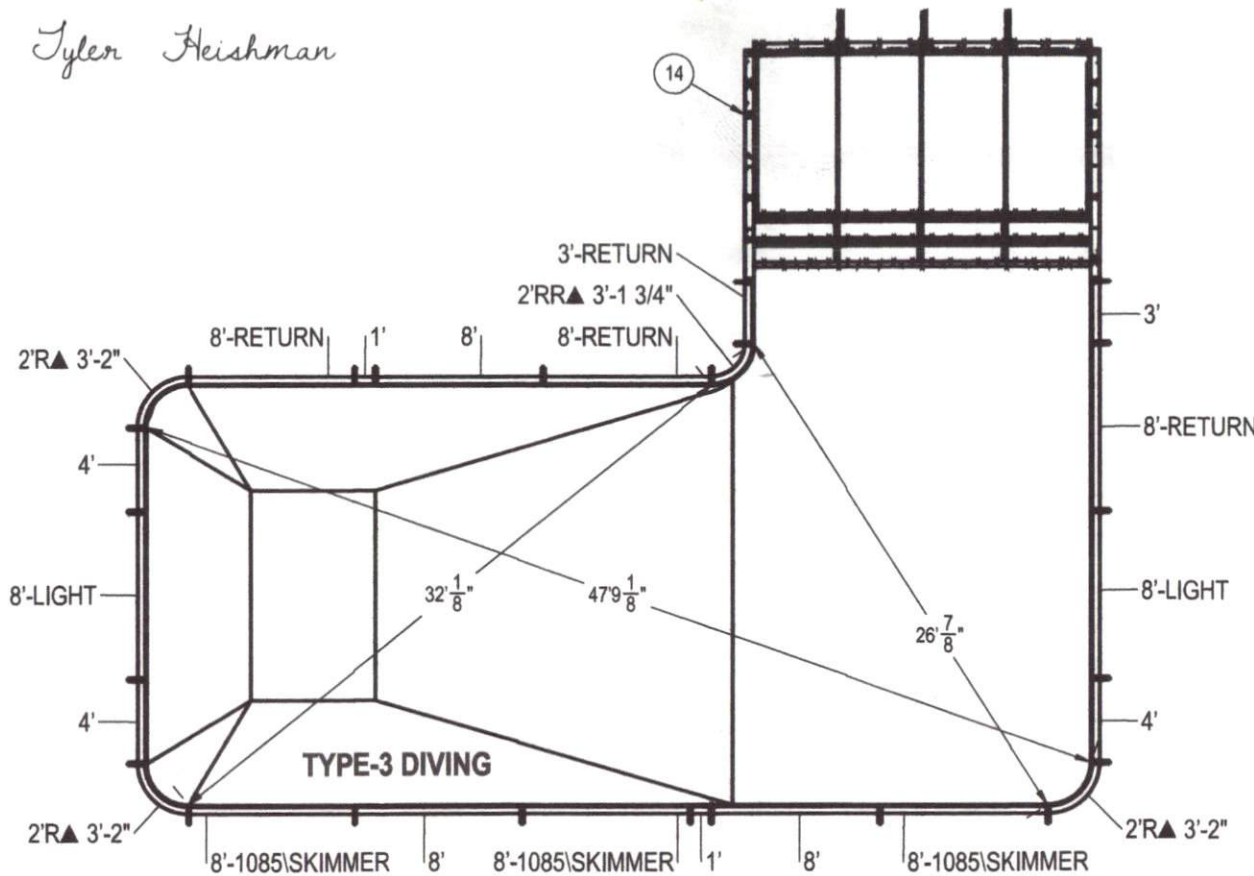

**NOTES:**

1. THESE ARE FINISHED DIMENSIONS READY FOR THE LINER.
2. DIMENSIONS ARE FROM INSIDE POOL PANELS.
3. ROPE AND FLOAT ASSEMBLY SHOULD BE INSTALLED IN ACCORDANCE WITH CURRENT ANSI/APSP/ICC REGULATIONS
4. HYDRA LINER TRACK FOR STEPS IS INSTALLED WITH THE BARB FACING THE RISER WALL ON THE STEP.

**EXCAVATION NOTES:**

5. ROUGH EXCAVATION SHOULD BE 2" DEEPER IN EACH INSTANCE.
6. SOIL TO HAVE MINIMUM BEARING CAPACITY OF 1500 PSF.
7. LOCATE TOP OF POOL AT LEAST 6" ABOVE THE SURROUNDING LAND ELEVATION.
8. SEE "OVER DIG DETAIL", IN INSTALLATION MANUAL, FOR EXCAVATION AROUND POOL.
9. FILL VOIDS UNDER BASE OF PANELS AND TAMP WELL.
10. BACK FILL WITH NON-EXPANSIVE MATERIAL.
11. FOLLOW ALL CURRENT ANSI / APSP / ICC GUIDELINES FOR RESIDENTIAL POOLS

**IMPORTANT NOTES:**

THIS DOCUMENT IS FOR ILLUSTRATIVE PURPOSES ONLY. THE DEALER OR CONTRACTOR WHO SELLS OR INSTALLS YOUR POOL IS AN INDEPENDENT CONTRACTOR AND IS NOT AN AGENT OF THE MANUFACTURER. THE CONSTRUCTION METHODS ILLUSTRATED HERE ARE SUGGESTIONS AND APPLY ONLY TO NORMAL GROUND CONDITIONS. THERE MAY BE ADDITIONAL PRECAUTIONS AND/OR METHODS OF CONSTRUCTION. PROPER INSTALLATION IS THE RESPONSIBILITY OF THE DEALER/BUILDER/CONTRACTOR.

ITEM	FILE NAME	DESCRIPTION	CUSTOMER DRAWING #	VENDOR PART #	QTY.
1	BOLT, PACK	BOLT, FLANGE, 3/8-16 X 1", PACK (50)	HPS1916	HPS1916	9
2	SBRACE	BRACE, FOLD OVER WITH TURNBUCKLE, STEEL, HPSFOB	HPSFOB	HPSFOB	23
3	PANEL, STRAIGHT	PANEL, 1' LONG, 700 SERIES	HPSE101P	00002489	2
4	PANEL, RADIUS	PANEL, 2' RADIUS, 3-2" LONG, 700 SERIES	HPSE2R	00002451	3
5	PANEL, RR	PANEL, 2' REVERSE RADIUS, 3-1 3/4" LONG, 700 SERIES	HPSE2RR	00005773	1
6	PANEL, STRAIGHT	PANEL, 3' LONG, 700 SERIES	HPSE103P	00002661	1
7	PANEL, STRAIGHT	PANEL, 3' LONG, INLET, 700 SERIES	HPSE103I	00026929	1
8	PANEL, STRAIGHT	PANEL, 4' LONG, 700 SERIES	HPSE104P	00002723	3
9	PANEL, STRAIGHT	PANEL, 8' LONG, 1085, 700 SERIES	HPSE10885	00004967	3
10	PANEL, STRAIGHT	PANEL, 8' LONG, 700 SERIES	HPSE108P	00004961	3
11	PANEL, STRAIGHT	PANEL, 8' LONG, INLET, 700 SERIES	HPSE108I	00004969	3
12	PANEL, STRAIGHT	PANEL, 8' LONG, LIGHT, 700 SERIES	HPSE108L	00004962	2
13	STAKE	STAKE, 14 GA	HPSSTAKE	00003484	23
14	00057740	STEP, 11" X 16", 6" RADIUS, 3 TREAD, 8" SUNLEDGE, OPEN POUR	HSSM57740		1

ENGINEERING DRAWING NUMBER <b>00058688</b>	WEIGHT: lbs VOLUME: Incht <sup>3</sup>	<b>UNLESS OTHERWISE SPECIFIED</b> DIMENSIONS ARE IN INCHES TOLERANCES DECIMALS: X ± .1 XX ± .01 XXX ± .001 XXXX ± .0005 ANGULAR: X ± 0.5 THIRD ANGLE PROJECTION	DESIGNED BY: <b>TSWALLOWS</b> DETAILED BY: <b>TSWALLOWS</b> LAST REVISED BY: <b>lessex</b> MATERIAL:	CREATION DATE: <b>4/9/2013</b> DETAILED DATE: <b>4/29/2024</b> LAST REVISED DATE: <b>4/27/2024</b>	<b>ATLAS STEEL</b>  TITLE: <b>LAYOUT, 20' X 45' X 36', TRUE L, RIGHT, 2' RADIUS, 9' DEEP, HSSM57740, 2-LIGHT, 4-INLET, 3-1084, 700 SERIES</b>	
	COLOR: HEAT TREAT: FINISH: TEXTURE:	SIZE: <b>A</b>	SHEET: <b>1 OF 4</b>	SCALE: <b>1:96</b>		PART NUMBER: <b>00058688</b>
						REV <b>B</b>

CHECK IN DATELINE: Saturday, April 27, 2024 10:27:07 AM  
 MADE FROM:

PROJECT: [Illegible]  
 DRAWING NO: 00028888  
 SHEET NO: 1 OF 1  
 DATE: [Illegible]

[Illegible text, possibly notes or specifications]

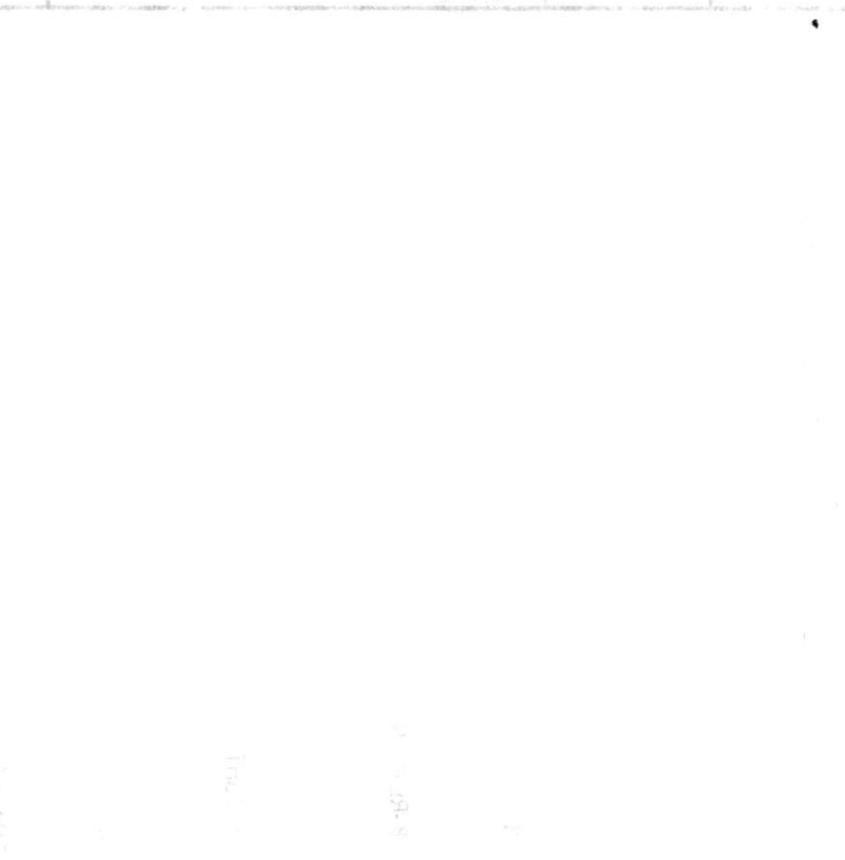

00028888

[Illegible text, possibly notes or specifications]

[Illegible text, possibly notes or specifications]

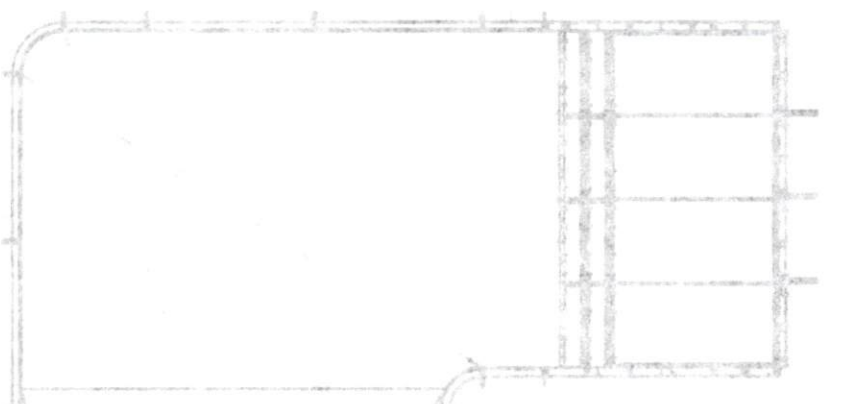

[Illegible text, possibly notes or specifications]

[Illegible text, possibly notes or specifications]

[Illegible text, possibly notes or specifications]

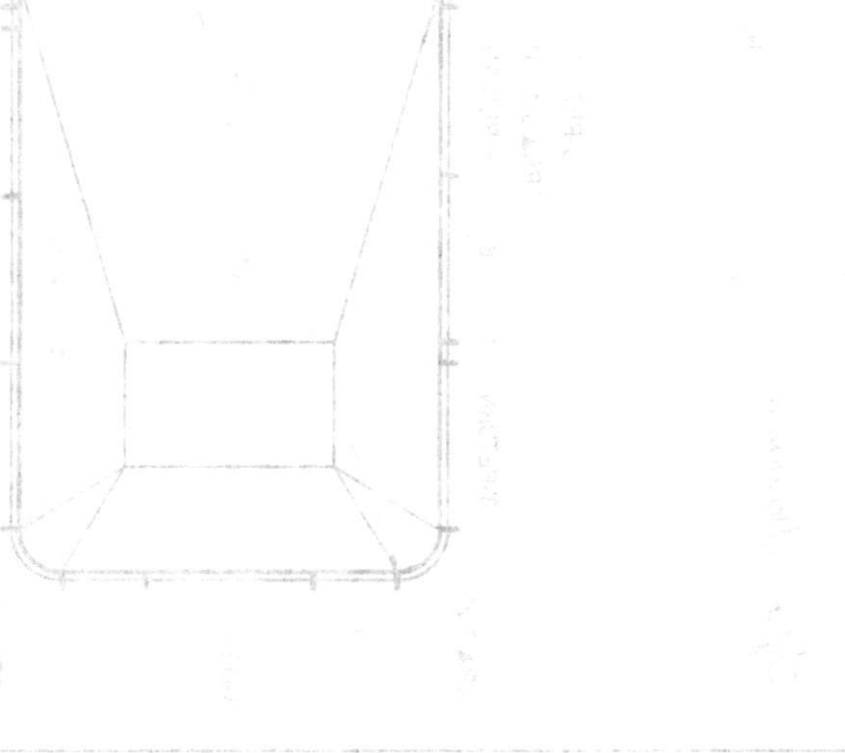

JH

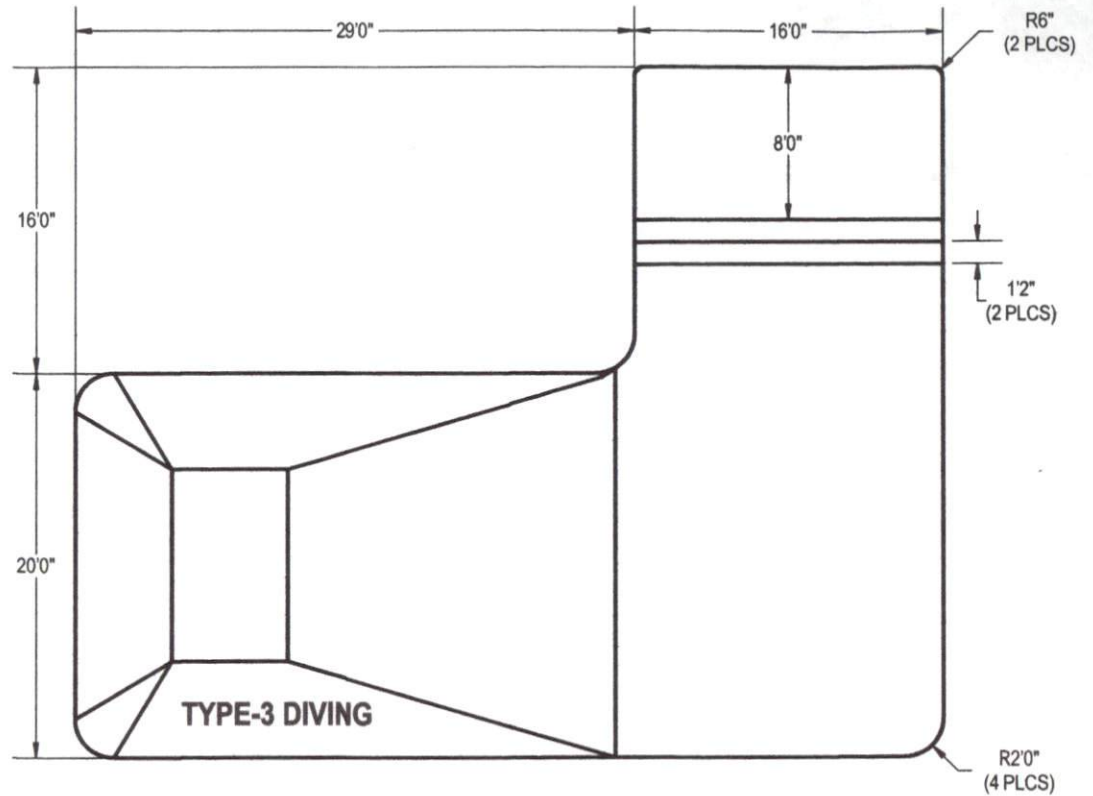
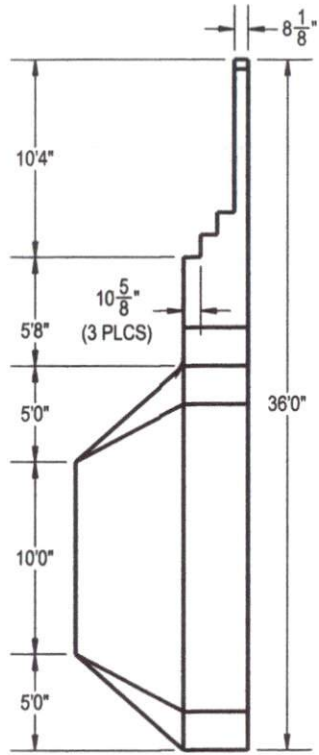

AREA		PERIMETER	VOLUME
SQ. FT.	FT.	U.S. GALLONS	
1154.19	158.14	31166.59	

**NOTES:**

- THESE ARE FINISHED DIMENSIONS READY FOR THE LINER.
- DIMENSIONS ARE FROM INSIDE POOL PANELS.
- ROPE AND FLOAT ASSEMBLY SHOULD BE INSTALLED IN ACCORDANCE WITH CURRENT ANSI/ASPS/ICC REGULATIONS
- HYDRA LINER TRACK FOR STEPS IS INSTALLED WITH THE BARB FACING THE RISER WALL ON THE STEP.

**EXCAVATION NOTES:**

- ROUGH EXCAVATION SHOULD BE 2' DEEPER IN EACH INSTANCE.
- SOIL TO HAVE MINIMUM BEARING CAPACITY OF 1500 PSF.
- LOCATE TOP OF POOL AT LEAST 6" ABOVE THE SURROUNDING LAND ELEVATION.
- SEE "OVER DIG DETAIL", IN INSTALLATION MANUAL, FOR EXCAVATION AROUND POOL.
- FILL VOIDS UNDER BASE OF PANELS AND TAMP WELL.
- BACK FILL WITH NON-EXPANSIVE MATERIAL.
- FOLLOW ALL CURRENT ANSI / ASP / ICC GUIDELINES FOR RESIDENTIAL POOLS

**IMPORTANT NOTES:**

THIS DOCUMENT IS FOR ILLUSTRATIVE PURPOSES ONLY. THE DEALER OR CONTRACTOR WHO SELLS OR INSTALLS YOUR POOL IS AN INDEPENDENT CONTRACTOR AND IS NOT AN AGENT OF THE MANUFACTURER. THE CONSTRUCTION METHODS ILLUSTRATED HERE ARE SUGGESTIONS AND APPLY ONLY TO NORMAL GROUND CONDITIONS. THERE MAY BE ADDITIONAL PRECAUTIONS AND/OR METHODS OF CONSTRUCTION. PROPER INSTALLATION IS THE RESPONSIBILITY OF THE DEALER/BUILDER/CONTRACTOR.

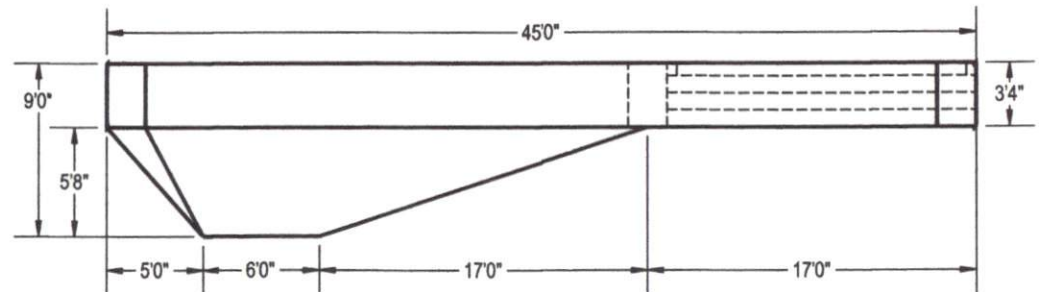

ENGINEERING DRAWING NUMBER: <b>00058688</b>	WEIGHT: lbs	<b>UNLESS OTHERWISE SPECIFIED</b> DIMENSIONS ARE IN INCHES TOLERANCES DECIMALS: X ± .1 XX ± .01 XXX ± .001 XXXX ± .0005  ANGULAR: X ± 0.5 THIRD ANGLE PROJECTION 	DESIGNED BY: <b>TSWALLOWS</b>	CREATION DATE: <b>4/9/2013</b>	<b>ATLAS STEEL</b>  TITLE: <b>LAYOUT, 20' X 45' X 36', TRUE L, RIGHT, 2' RADIUS, 9' DEEP, HSSM57740, 2-LIGHT, 4-INLET, 3-1084, 700 SERIES</b>
	VOLUME: <b>31166.59 inch<sup>3</sup></b>		DETAILED BY: <b>TSWALLOWS</b>	DETAILED DATE: <b>4/29/2024</b>	
	COLOR:		LAST REVISED BY: <b>lessex</b>	LAST REVISED DATE: <b>4/27/2024</b>	
	HEAT TREAT:		MATERIAL:		
	FINISH:		SIZE: <b>A</b>		
TEXTURE:	SHEET: <b>2 OF 4</b>	SCALE: <b>1:128</b>	PART NUMBER: <b>00058688</b>	REV <b>B</b>	

UNIFORM NUMBER: MADE FROM: CHECK IN DATE/TIME: Submitted: April 27, 2024, 10:21:07 AM

00028882

00028882  
DRAWING  
TITLE  
DATE  
BY  
CHECKED  
APPROVED

SIZE  
SHEET  
SCALE  
DATE  
BY  
CHECKED  
APPROVED

00028882

157 B

STEEL SHEET PILING  
SERIES 100  
TYPE 100  
HEIGHT 4'-10 1/2"  
THICKNESS 5/16"

STEEL SHEET

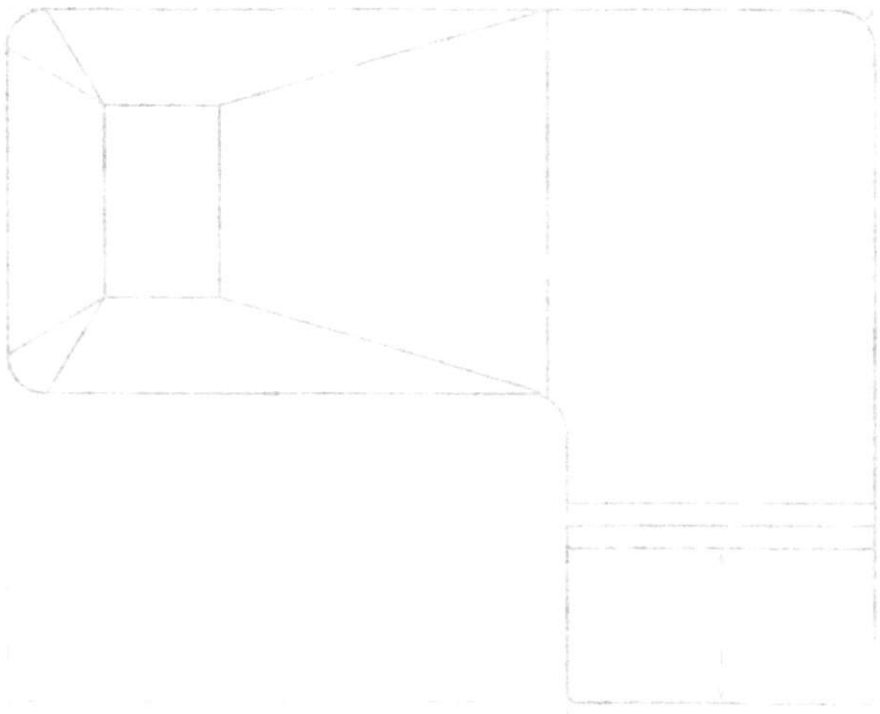

STEEL SHEET PILING  
SERIES 100  
TYPE 100  
HEIGHT 4'-10 1/2"  
THICKNESS 5/16"

NOTES

1. ALL DIMENSIONS ARE IN FEET AND INCHES.  
2. THE TOP EDGE OF THE PILING IS TO BE TAPERED TO THE BOTTOM EDGE.  
3. THE THICKNESS OF THE PILING IS TO BE 5/16 INCH.

157

JA

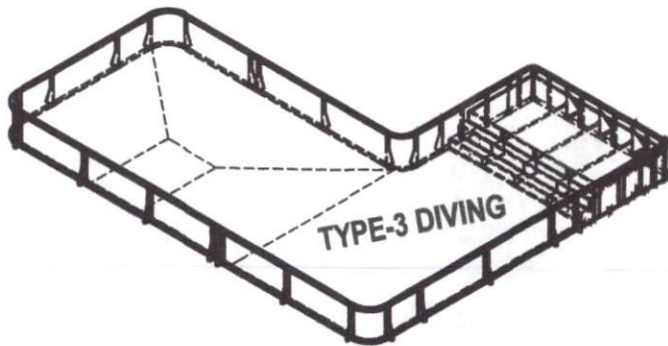
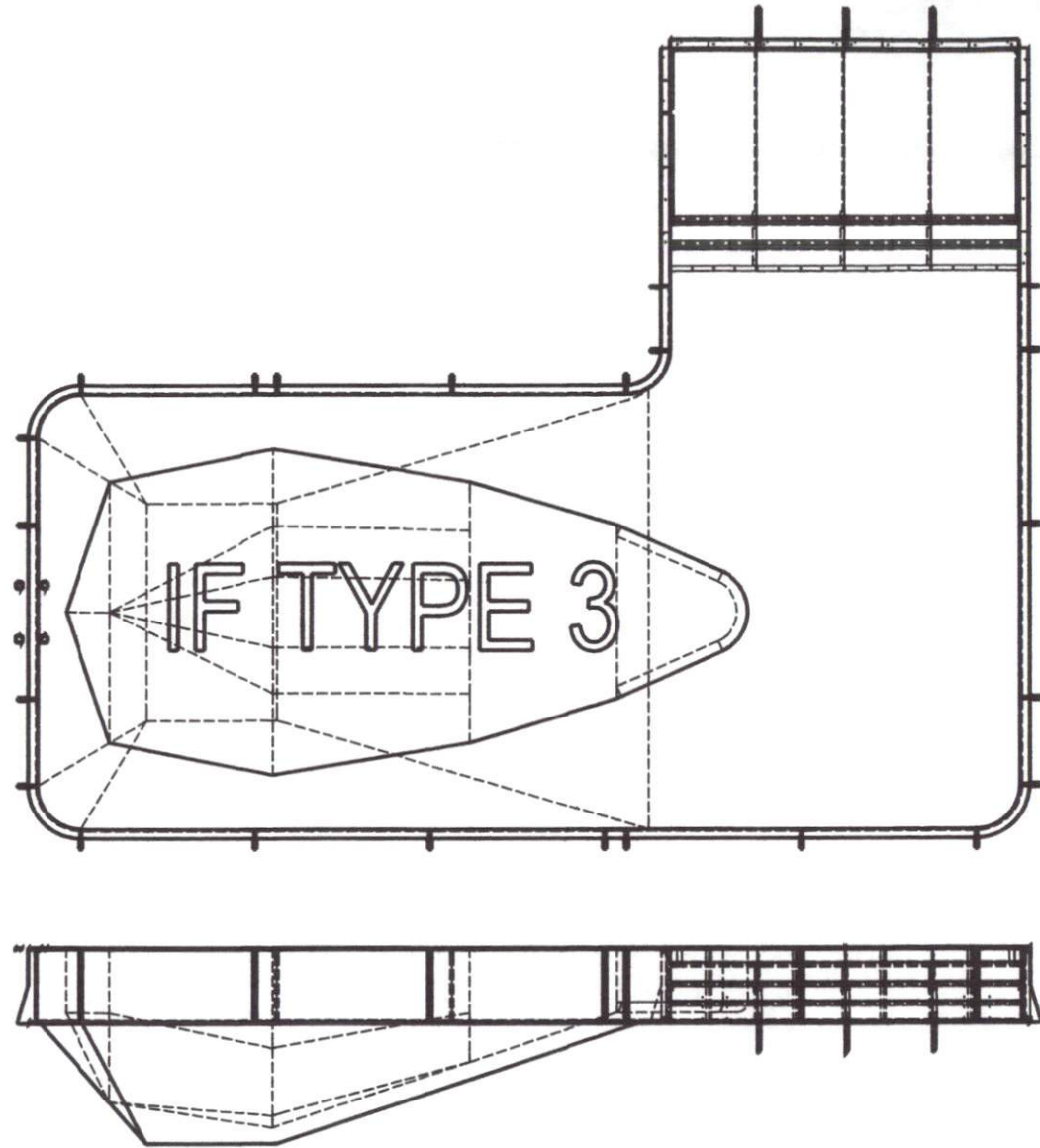

ENGINEERING DRAWING NUMBER: <b>00058688</b>	WEIGHT:	<b>UNLESS OTHERWISE SPECIFIED</b> DIMENSIONS ARE IN INCHES TOLERANCES DECIMALS: X ± .1 XX ± .01 XXX ± .001 XXXX ± .0005  ANGULAR: X ± 0.5 THIRD ANGLE PROJECTION 	DESIGNED BY:	CREATION DATE:	<b>ATLAS STEEL</b>  TITLE: LAYOUT, 20' X 45' X 36', TRUE L, RIGHT, 2' RADIUS, 9' DEEP, HSSM57740, 2-LIGHT, 4-INLET, 3-1084, 700 SERIES  PART NUMBER: <b>00058688</b>
	lbs		TSWALLOWS	4/9/2013	
	VOLUME:		DETAILED BY:	DETAILED DATE:	
	Inch <sup>3</sup>		TSWALLOWS	4/29/2024	
	COLOR:		LAST REVISED BY:	LAST REVISED DATE:	
HEAT TREAT:	lessex	4/27/2024	SCALE:		
FINISH:	MATERIAL:		3 OF 4	1:72	REV <b>B</b>
TEXTURE:					

PAPER NUMBER:      MADE FROM:      CHECK IN DATE/TIME: Saturday, April 27, 2024 10:27:07 AM



SW20

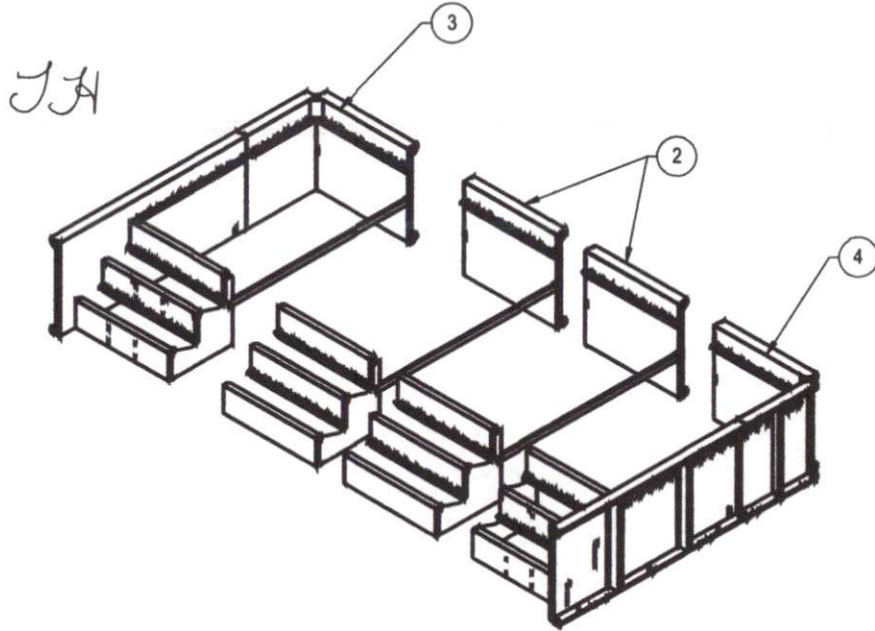

JA

REVISION HISTORY				
REV.	DESCRIPTION	DATE	ECO	BY
A	RELEASED FOR PRODUCTION	3/28/2024		CCRAMER

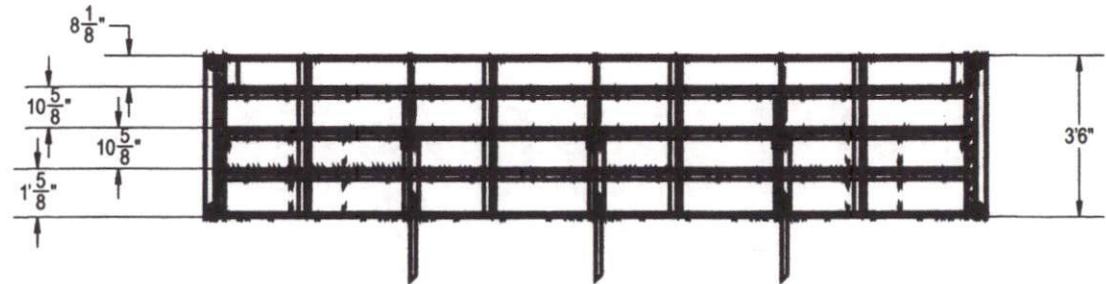
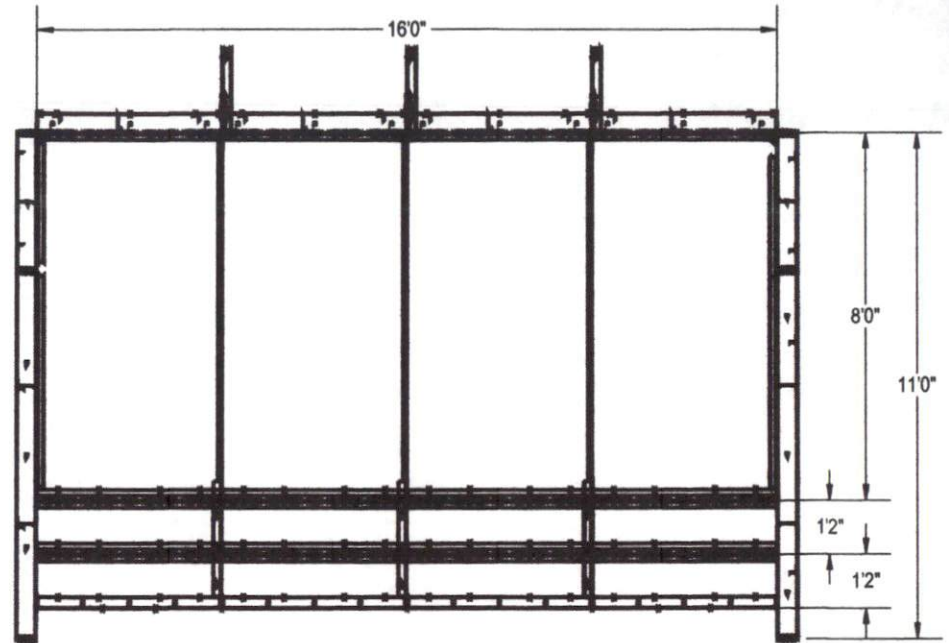

ITEM	FILE NAME	DESCRIPTION	CUSTOMER DRAWING #	VENDOR PART #	QTY.
1	BOLT PACK	BOLT FLANGE 3/8-16 X 1" PACK (50)	HPS1916	HPS1916	3
2	00038914	STEP 4 X 11' 6" RADIUS 3 TREAD OPEN POUR 8" TANNING LEDGE SUB ASSEMBLY	HSM38914	00038914	2
3	00038917	STEP 4 X 11' 6" RADIUS 3 TREAD LEFT OPEN POUR 8" TANNING LEDGE SUB ASSEMBLY	00038917	00038917	1
4	00038924	STEP 4 X 11' 6" RADIUS 3 TREAD RIGHT OPEN POUR 8" TANNING LEDGE SUB ASSEMBLY	00038924	00038924	1

ENGINEERING DRAWING NUMBER  
**00057740**

UNLESS OTHERWISE SPECIFIED

DIMENSIONS ARE IN INCHES  
TOLERANCES  
DECIMALS: X ± .1  
XX ± .01  
XXX ± .001  
XXXX ± .0005

ANGULAR: X ± 0.5  
THIRD ANGLE PROJECTION



DESIGNED BY:  
**CCRAMER**  
CREATION DATE:  
**9/21/2022**  
DETAILED BY:  
**TSWALLOWS**  
DETAILED DATE:  
**4/29/2024**  
LAST REVISED BY:  
**lessex**  
LAST REVISED DATE:  
**3/28/2024**  
MATERIAL:

**SAMSON STEEL**  
TITLE: **STEP, 11' X 16', 6" RADIUS, 3 TREAD, 8" SUNLEDGE, OPEN POUR**

PART NUMBER: **HSSM57740**  
SCALE: **1:96**  
SHEET: **4 OF 4**  
SIZE: **A**

UNLESS OTHERWISE SPECIFIED, DIMENSIONS ARE IN INCHES. CHECK IN DATE/TIME: Thursday, March 28, 2024 2:27:48 AM





This is NOT your Sales Agreement!

# Pool Warehouse

...we know swimming pools

## What to Expect...

Welcome to the Pool Warehouse Family! We know that you are very eager and excited about your new pool purchase. Your pool purchase comes with exceptional support from our experienced staff including a field experienced technical support team. To provide the best support possible, **please read this entire document prior to receiving your delivery / deliveries.**

Access to your customer account is available 24/7 via our homepage. You may click on "Account" at the top of the homepage, which will in turn allow you to log into your account.



### Login

Login with email or username

Enter Email to receive a single-use login link.

LOG IN

### Or Login With Password

Username or email address \*

Password \*

Log In  Remember me

### Register

Email address \*

A password will be sent to your email address.

Your personal data will be used to support your experience throughout this website, to manage access to your account, and for other purposes described in our privacy policy.

Register

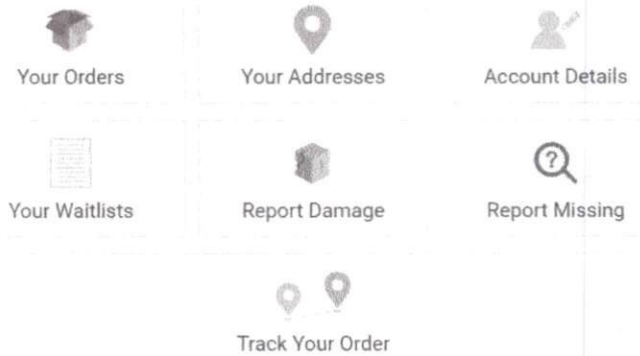

## DELIVERY EXPECTATIONS:

All Pool Kits are shipped out via a freight semi-truck. Inground kits may ship from multiple manufacturers resulting in multiple deliveries, so shipments may arrive at different times via multiple freight carriers. You must be present at time of delivery to receive and inspect your product. If you are not present at the scheduled time of delivery, you will incur additional charges including, but not limited to, redelivery and storage fees.



### I Understand that:

**\*The freight carrier should contact me once the freight has arrived at the delivery terminal to schedule my delivery. Contact may take place via Phone call, email, or text.**

*JH* **\*YOU MAY HAVE MULTIPLE SHIPMENTS. Please ask the carrier when setting up delivery appointment what specifically is being delivered as you may or may not need a forklift for each delivery (ie. Liner, Slide, Cover, etc)**

**\*I must be present at the time of delivery and inspect my product fully and notate any damaged on the delivery receipt.**

## ACCEPTING YOUR DELIVERY:

We strive to work with reputable carriers to ensure you have a pleasant delivery experience. Your order will be delivered curbside. It is your responsibility to unload the shipment and conduct a complete inventory. It is also your responsibility to have equipment on site for offload. Examples of equipment would be a tractor with forks, a skid-steer with forks, etc. If you do not have equipment on site to unload, you will need to unload by hand. If the delivery address is not accessible by semi-truck, you may need to make arrangements to meet the driver or schedule a dock pickup.



...if you do not have equipment on site to unload, you will need to unload the trailer at your own expense and risk. If the delivery receipt is not signed by you or your authorized representative, you will need to unload the trailer at your own expense and risk. If you do not have equipment on site to unload, you will need to unload the trailer at your own expense and risk. If the delivery receipt is not signed by you or your authorized representative, you will need to unload the trailer at your own expense and risk.



**ACCEPTING YOUR DELIVERY:**

- 1. It must be present at the time of delivery and inspect any product until you receive and remove on the delivery receipt.
- 2. You may have multiple shipments. Please ask the carrier when getting on delivery information what specific items you will receive and when.
- 3. The driver should contact us once the trailer has arrived at the delivery location to schedule my delivery.

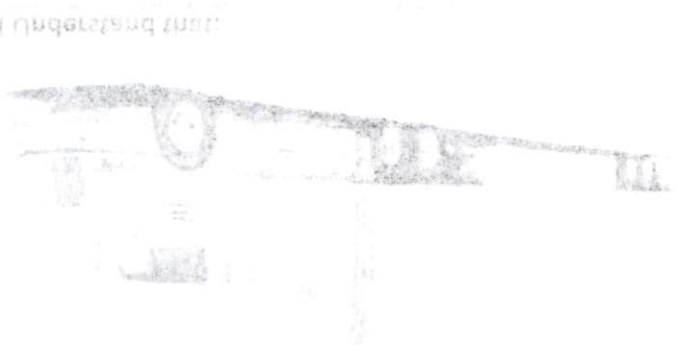

...if you do not have equipment on site to unload, you will need to unload the trailer at your own expense and risk. If the delivery receipt is not signed by you or your authorized representative, you will need to unload the trailer at your own expense and risk. If you do not have equipment on site to unload, you will need to unload the trailer at your own expense and risk. If the delivery receipt is not signed by you or your authorized representative, you will need to unload the trailer at your own expense and risk.

**DELIVERY EXPECTATIONS:**



...if you do not have equipment on site to unload, you will need to unload the trailer at your own expense and risk. If the delivery receipt is not signed by you or your authorized representative, you will need to unload the trailer at your own expense and risk. If you do not have equipment on site to unload, you will need to unload the trailer at your own expense and risk. If the delivery receipt is not signed by you or your authorized representative, you will need to unload the trailer at your own expense and risk.

**What to Expect:**

This is NOT your sales Agreement!

MAKERS 136

**I Understand that:**

- JA
- \*It is ultimately my responsibility to have equipment to offload my product from the freight truck.
  - \*I am obligated to do a full inventory at time of delivery. Any and All products that are missing or damaged must be noted on the carrier's BOL (bill of lading) and/or Delivery Ticket at the time of delivery.
  - \*If I neglect to sign for any items as missing or damaged on the BOL, I will be responsible for purchasing said items or filing a freight claim on my own. I assume liability for the contents of my shipment once I sign the BOL or Delivery Receipt.
  - \*I understand Pool Warehouse will not extend any type of "Compensation" for any missing/damaged items or for any delays that missing/damaged items may cause.

## Missing/Damaged Items



Use your Packing List to itemize the contents of your order. The Carrier will provide this upon arrival. You will need to check the number of skids, boxes, and pieces listed on the BOL match what you are physically receiving. If you have the ability to take pictures of the shipment on the truck as it is being unloaded, please do so. If you are not able to take pictures, please note the color and the condition of the shrink wrap before you break it open to begin your count and inspection. Once you remove the shrink wrap, check all the boxes for any damages. If you have any missing or damaged items, please do the following:

- \*Write on the BOL what the exact parts and quantity of items you are short or have received damaged. Please put in all caps "MISSING" or "DAMAGED" followed by the items that are missing/damaged.
  - \*\*Examples are: "One skid short", "Only received one of two skids", "3 panels missing", "Filter box crushed", etc...
- \* If you have ANY damaged items, **take pictures of any damages**. You must note it on the BOL, but a claim will only be filed if the product within the box is damaged, and the BOL is signed as damaged.
- \*You will receive a copy of the BOL, but if you have missing or damaged items, please take a picture of the drivers copy of the BOL that has your notations on it.
- \***Unless you have excessive damages, do not refuse your delivery.** Take substantial pictures of the shipment, note the damages on the BOL, and report the damages to Pool Warehouse immediately.
- \*The process to get you replacements is much quicker if we are able to get the signed BOL with all of your notes and pictures than it is to wait on a refused shipment to be returned, inspected, and a replacement order be shipped back out.
- \*You may submit the noted and signed BOL along with all pictures to [support@poolwarehouse.com](mailto:support@poolwarehouse.com) to create your customer case and ensure timely resolution.
- \*If you have damages, and chose to have them fixed locally, reimbursement will not be given.

### DRIVER DIFFICULTIES:

If the driver claims to be in a hurry, please know that you have the right to inspect your delivery. You also have the right and responsibility to sign ON THE BOL for any missing or damages that you have received. It is necessary and essential that you sign the BOL with ALL exceptions. If the driver tries to tell you any different, DO NOT SIGN THE BOL and call us Immediately. We will speak with the driver while they are there with you.

**I Understand that:**

- JA
- \*Prior to signing the BOL, I will note all missing or damaged items on the driver's copy of the BOL.
  - \*I will take pictures of the signed driver's copy of the BOL and any damages to my order.
  - \*I will send all pictures along with a list of part numbers that are missing or damaged to Pool Warehouse at [support@poolwarehouse.com](mailto:support@poolwarehouse.com).





## Final Checks:

\*Once you have successfully received all of your pool components, please do one final inventory check against your sales agreement to ensure you have everything you ordered prior to beginning construction.

\*Check the label on your liner box to ensure that the size and pattern are what you ordered. Please note that the shape on the label of the box is generic and unless you order a rectangle shape pool, the label will not reflect your particular pool shape. Once the box is opened, the liner can not be returned.

\*In the rare instance that you are missing an item, please check your inventory list against the physical items you received twice. All generic boxes should be opened and inventoried as well. This is because Pool Warehouse is only allowed to file one missing item claim per order. Once a claim is approved, the missing items will ship via normal ground shipping directly from the manufacturer.

\*If damages are found during your inventory check, you have concealed damage. Concealed damages are handled differently than damages reported on the BOL at the time of delivery. Despite the best efforts to ensure that your order is shipped to you in pristine condition, damages may occur. You will need to file a concealed damage claim DIRECTLY with the freight carrier that delivered your product within 24 – 48 hours of delivery. When reporting the damage to the carrier, please go onto the carrier's website and print off the claim forms. You will fill them out and submit them to the carrier. After submission of the form to the carrier, the carrier will validate your claim and issue payout directly to you for repair or purchasing replacement. Unfortunately, as indicated in your signed sales agreement, Pool Warehouse is not able to file a freight claim on your behalf because you did not sign for the product as damaged. Pool Warehouse will provide any assistance that we can to help you file your freight claim.

\*Now that you have received all of the ordered items, please read the installation instructions, watch the installation video, and refer to the pool packet that will be emailed to you after your pool kit is sent into production.

## POOL DRAWING IS ATTACHED:

Please refer to the drawing attached for your specific pool. Please take a moment to check the following items:



- Size
- Shape
- Skimmer quantity and placement
- Light quantity and placement
- Step style, size, and location
- Depths of the shallow and deep ends.
- Inwall ladder location if applicable
- Panel Type & Height (Steel is available in 42" or 48". Polymer is 42" only. )

I have verified the above information on the drawing.

*Tyler Heishman*

\*\*Please print a copy of this document for your records.\*\*

\*Reminder: This is **NOT** your sales agreement.

## Final Checks:

Now that you have received all of your pool parts, please take a moment to check the following items:

- Pool Type & Height (Steel is available in 42" or 48", Polymer is 42" only.)
- In-wall ladder location if applicable
- Depths of the shallow and deep ends.
- Step style, size, and location
- Light quantity and placement
- Spinner quantity and placement
- Shape
- Size

Please refer to the drawing attached for your specific pool. Please take a moment to check the following items:

**POOL DRAWING IS ATTACHED:**

\*Now that you have received all of the ordered items, please read the installation instructions, watch the installation video, and refer to the pool packet that will be emailed to you after your pool kit is sent into production.

product as damaged. Pool Warehouse will provide any assistance that we can to help you file your freight claim. Agreement, Pool Warehouse is not able to file a freight claim on your behalf because you did not sign for the issue payout directly to you for repair or replacement. Unfortunately, as indicated in your signed sales submit them to the carrier. After submission of the form to the carrier, the carrier will verify your claim and damage to the carrier, please go only through the carrier's website and print off the claim forms. You will fill them out and DIRECTLY with the freight carrier that delivered your product within 24 - 48 hours of delivery. When reporting the order is shipped to you in pristine condition, damages may occur. You will need to file a concealed damage claim differently than damages reported on the BOL at the time of delivery. During the best efforts to ensure that your fit damages are found during your inventory check, you are encouraged to check for any concealed damages. Concealed damages are handled normal ground shipping directly from the manufacturer.

only allowed to file one missing item claim per order. Once a claim is approved, the missing items will ship via received twice. All generic boxes should be opened and inspected as well. This is because Pool Warehouse is in the rare instance that you are missing an item, please check your inventory list against the physical items you returned to the manufacturer. Once the box is opened, the item can not be returned.

shape on the label of the box as a means to ensure a return to the same pool, the label will not reflect your return to the pool stage. Once the box is opened, the item can not be returned.

fit the label on your first box to ensure that the size and pattern are what you ordered. Please note that the your - also agreement to ensure you have everything you ordered prior to beginning construction.

Now you have successfully received all of your pool parts, please take a moment to check the following items:

## KIT PRODUCT LIST

**PANELS – These are example of panels and what cutouts should resemble.**

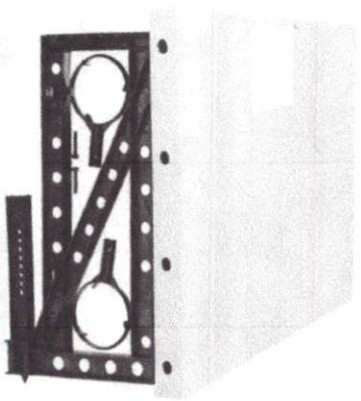

**Polymer and Steel Options**

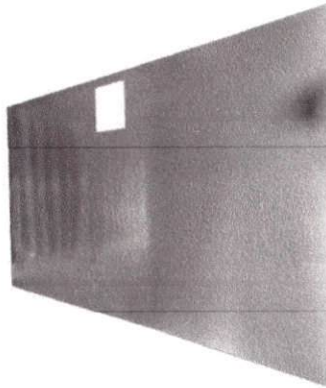
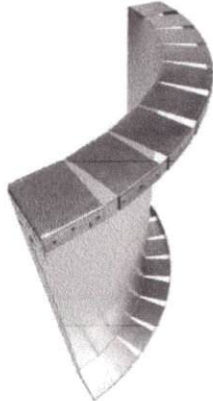

**Steel Skimmer Panel**

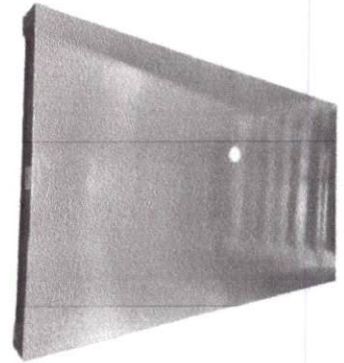

**Steel Inlet Panel**

### **BRACE OPTIONS FOR STEEL PANELS**



**Fold Over Turnbuckle**

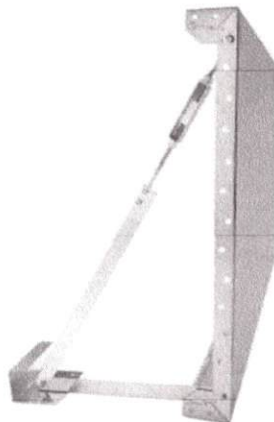

**Two Piece Turnbuckle  
(w/Concrete Locking Dead-Man Plate)**

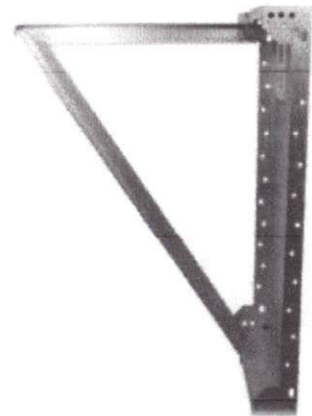

**Deck Support**

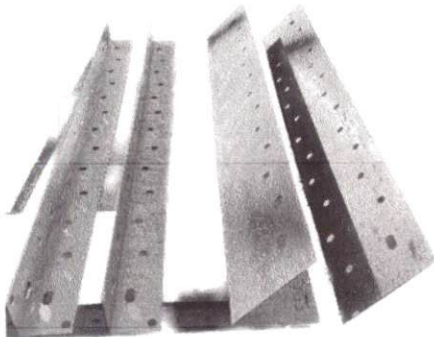

**6in Radius Corner Inserts (HPS6CA)  
\*For 6"R steel pools**

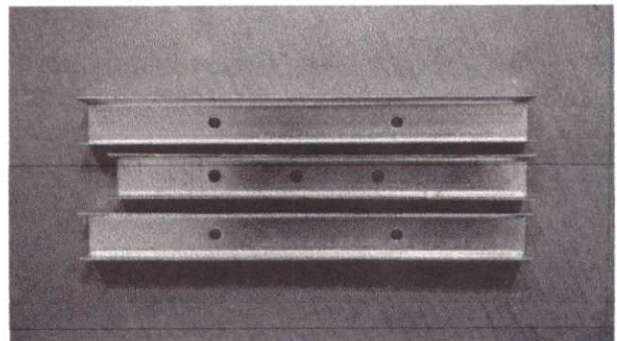

**Steel pool skimmer spacers (H01084SW & H01084SWB)  
\*Only for Steel Pools with 1084 or 1085 Skimmers**

*Tyler Feishman*

**COPING STYLES**

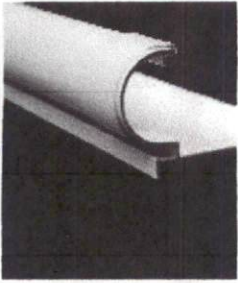

Bullnose Caplock

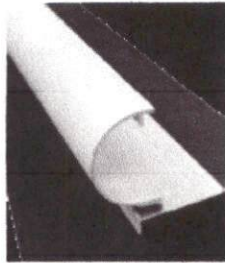

Bullnose Rimlock

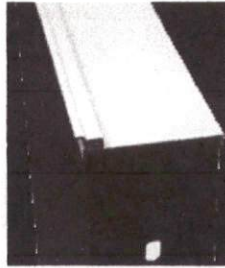

Cantilever Caplock

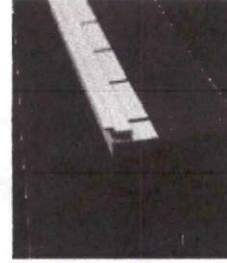

Cantilever Rimlock

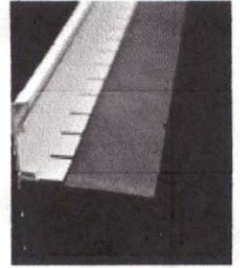

Flex Rimlock

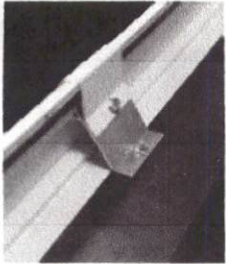

Flex Rimlock

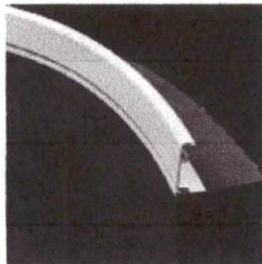

Flex Radius

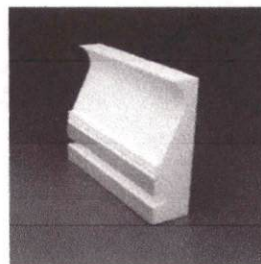

Concrete Foam Forms

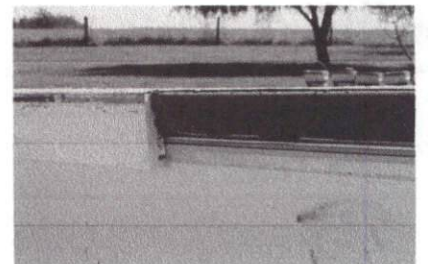

Example Photo of Concrete Form

**ACCESSORIES – Must be purchased, these are not automatically included in your pool kit – \*Part #s may vary\***

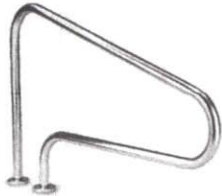

Excel Handrail (H02536)



Excel Ladder (H00692)



Inlet/ Outlet (H00982N)



Eyeball (H02658N)



Safety Rope Kit w/ Rope eyes  
(H09003PG & H01183)



Anchors 8" (Handrail) and 20" (Ladder)  
8" - H00806PL 20" - H01945PL

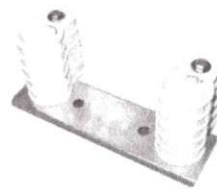

Escutcheon (H02876)



Maintenance Kit (H03121N)

Includes: Net, Brush, Thermometer, Trivac & Test Kit, Blue Pole (H00540)  
(CHEMICALS NOT INCLUDED, MUST BE PURCHASED SEPARATELY)



Vacuum Hose (H01930PG)

*Tyler Feishman*



(CHEMICALS NOT INCLUDED MUST BE PURCHASED SEPARATELY)  
 (CHEMICALS NOT INCLUDED MUST BE PURCHASED SEPARATELY)  
 (CHEMICALS NOT INCLUDED MUST BE PURCHASED SEPARATELY)

Accessories (NOTES)  
 Accessories (NOTES)



Flex V-block (NOTES)  
 Flex V-block (NOTES)

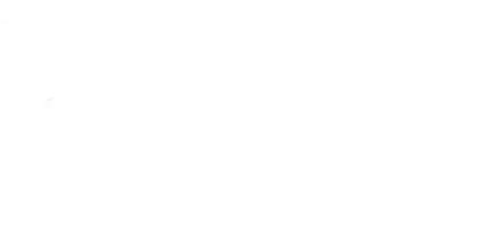

Flex V-block (NOTES)  
 Flex V-block (NOTES)



Accessories (NOTES)  
 Accessories (NOTES)



Flex V-block (NOTES)  
 Flex V-block (NOTES)



Flex V-block (NOTES)  
 Flex V-block (NOTES)



Accessories (NOTES)  
 Accessories (NOTES)



Flex V-block (NOTES)  
 Flex V-block (NOTES)



Flex V-block (NOTES)  
 Flex V-block (NOTES)



Accessories (NOTES)  
 Accessories (NOTES)

Accessories - Must be purchased separately. Not included in your purchase. - Part of your purchase.

Flex V-block

Flex V-block

Concrete form (NOTES)

Concrete form of concrete form



Flex V-block

Flex V-block

Concrete form (NOTES)

Concrete form (NOTES)

Flex V-block



CONCRETE SLAB



Hayward DuraNiche (H00382)



Hayward Transformer (H01432H)

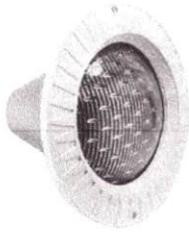

Standard Pool light



Hayward ColorLogic 320 LED Light



Sand Filter



Main Drains (H07686)  
\*Dual Suction Outlet\*



Skimmer (H07688)  
\*1084 Pictured\*



Salt System  
\*Excel System Pictured\*



Pump  
\*Excel Pictured\*



Robotic Pool Cleaner  
\*Dolphin Nautilus CC Pictured\*

**\*\*NOTE: ALL PLUMBING ADAPTERS MUST BE STANDARD SCHEDLUE 40 PVC**

**POOL LINER BOX EXAMPLE**

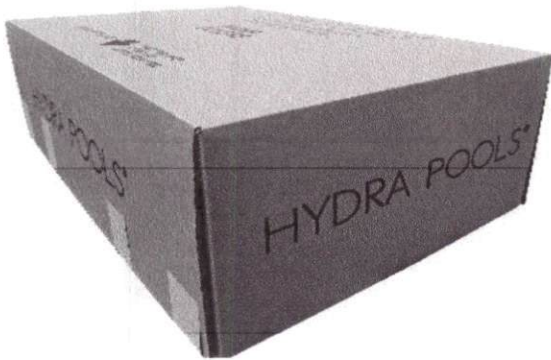

**Part# HLCUSTOM**

**NOTE: You may see a few additional lines under the "HLCUSTOM" on your packing slip that are already built into your liner. These are not additional items!**

- HYTEXTURE VINYLTEXTURED STEP TEXTURE OVER STEP (The liner has textured material on the step))
- HYALLOVER LINER ALL OVER PATTERN WALL FROM FLOOR (The liner is made w/o a boarder)
- HYVNYLSTEP LINER VINYL OVER STEP UP TO 12' WIDE (The liner has vinyl over the steel steps/bench/ledge)
- HYLEDGE LINERSUN LEDGE SUN LEDGE ONLY (The liner has vinyl over a tanning or sun ledge)
- HYPSTEPBEAD STEP BEAD HANG TAB (The liner has step bead welded to the underside of the liner portion to lock your liner into your step assembly for installation purposes)

*Tyler Heishman*

Howard Drain (H0082)



Main Drains (H0788)



Howard Transform (H01458)



Summer (H0758)



Standard (H01458)



2 1/2" System (H0758)



Howard Colologic (H01458)



Pump (H0758)



Sand Filter (H01458)



Robotic Pool Cleaner (H0758)



POOL LINER BOX EXAMPLE



Part CUSTOM

NOTE: You may see a few additional lines under the "CUSTOM" on your packing slip that are already built into your liner. These are not additional items.

- HYTEXTURE
- HYALLOVER
- HYVINYSTEP
- HYEDGE
- HYSTEPBRAD
- STEP BRAD HANG TAB
- LINER VINYL OVER STEP UP TO 12" WIDE
- LINER ALL OVER PATTERN WALL FROM FLOOR
- HYTEXTURED SLIP TEXTURE OVER STEP

Hydra Pools

## Document Details

<b>Title</b>	00058688 Rev B Heishman
<b>File Name</b>	00058688 Rev B Heishman.pdf, Inground Pool Kit Receiving Instructions & Parts.pdf
<b>Document ID</b>	a8781f6fdd6c4ab0b6109d15468650ee
<b>Fingerprint</b>	f531d8d3dcc5ff2750278ac1350417d6
<b>Status</b>	<span>Completed</span>

## Document History

<b>Document Created</b>	Document Created by Lexi Phillips (lexi@poolwarehouse.com) Fingerprint: 921fcf2a947b2bb9c97070deca237f9f	Apr 29 2024 11:16AM America/New_York
<b>Document Sent</b>	Document Sent to Tyler Heishman (heishman2191@gmail.com)	Apr 29 2024 11:16AM America/New_York
<b>Document Viewed</b>	Document Viewed by Tyler Heishman (heishman2191@gmail.com) IP: 172.59.223.167	Apr 29 2024 11:23AM America/New_York
<b>Document Viewed</b>	Document Viewed by Tyler Heishman (heishman2191@gmail.com) IP: 172.59.223.167	Apr 29 2024 11:24AM America/New_York
<b>Document Viewed</b>	Document Viewed by Tyler Heishman (heishman2191@gmail.com) IP: 172.59.223.167	Apr 29 2024 11:24AM America/New_York
<b>Document Viewed</b>	Document Viewed by Tyler Heishman (heishman2191@gmail.com) IP: 172.59.217.136	Apr 29 2024 04:04PM America/New_York
<b>Document Viewed</b>	Document Viewed by Tyler Heishman (heishman2191@gmail.com) IP: 172.59.216.70	Apr 29 2024 05:59PM America/New_York
<b>Document Viewed</b>	Document Viewed by Tyler Heishman (heishman2191@gmail.com) IP: 172.59.216.70	Apr 29 2024 05:59PM America/New_York



**Document  
Viewed**

Document Viewed by Tyler Heishman (heishman2191@gmail.com)  
IP: 172.59.216.70

**Apr 29 2024**  
06:01PM  
America/New\_York

**Document  
Signed**

Document Signed by Tyler Heishman (heishman2191@gmail.com)  
IP: 172.59.216.70

*Tyler Heishman*

**Apr 29 2024**  
06:03PM  
America/New\_York

**Document  
Completed**

This document has been completed.  
Fingerprint: f531d8d3dcc5ff2750278ac1350417d6

**Apr 29 2024**  
06:03PM  
America/New\_York