

Harnett County Environmental Health

EXISTING SYSTEM APPROVAL

Issued by: Local Health Department AOWE Certified Inspector

Existing System Approval

Site modification (e.g., storage shed) or footprint addition with no DDF or wastewater strength increase

Reconnection when the proposed facility is in the same footprint as existing/previous facility

Construction Authorization/Notice of Intent to Construct

[issued for reconnection when the proposed facility is not in the same footprint as existing/previous facility pursuant to Session Law 2023-77, Section 5.(c)]
[certified inspectors are not authorized to approve reconnections outside of footprint pursuant to Session Law 2023-77, Section 5.(c)]

Applicant: Richard Burrell
 Mailing Address: 190 Cypress Church Rd
 City: Cameron
 State: NC Zip: 28326
 Phone #: 919-478-2331
 Email: Richard.burrell@va.gov

Owner: Kaleb Burrell
 Mailing Address: 180 Cypress Church Rd
 City: Cameron
 State: NC Zip: 28326
 Phone #: 704-813-8068
 Email: Burrellfamilyhomestead@gmail.com

PIN/Lot Identifier: 9553-79-4567
 Property Location/Address: 180 Cypress Church Rd (SR 1107)

Facility Type: House/Modular Mobile/Manufactured Home Business Other: _____

Operation Permit/ATO #: _____ Design Daily Flow: 480 GPD
 Number of Bedrooms: 4 Max # Occupants: 8 Other: _____
 Wastewater Strength: Domestic High Strength Industrial Process Wastewater
 Water Supply: Private well Public well Shared well Municipal Supply Spring Other: _____

Proposed Property Improvement: 76'x32' DWMH

All of the following must be checked for approval:

***For Reconnections:**

- Site complies with its Operation Permit or the wastewater system was in use prior to July 1, 1977
- No current or past uncorrected malfunction of the system as described in 15A NCAC 18E .1303(a)(2)
- DDF and wastewater strength for the proposed facility do not exceed that of the existing system
- Facility meets the setbacks in Section .0600 of 15A NCAC 18E
- Existing system is being operated and maintained in accordance with Section .1300 of 15A NCAC 18E and permit conditions.

***For Site Modifications or Footprint Expansions:**

- Proposed structure meets the setbacks in Section .0600 of 15A NCAC 18E

Approval Conditions: _____

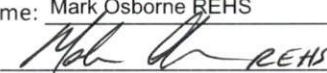
Inspector's Printed Name: Mark Osborne REHS Inspector Certification #: 2613
 Inspector's Signature:  REHS Date: 7-5-24

See attached site sketch

EXISTING SYSTEM APPROVAL SITE SKETCH

Operation Permit/ATO #: _____ PIN/Lot Identifier: 9553-79-4567
Owner: Richard Burrell _____ Property Location/Address: 180 Cypress Church Rd (SR 1107)

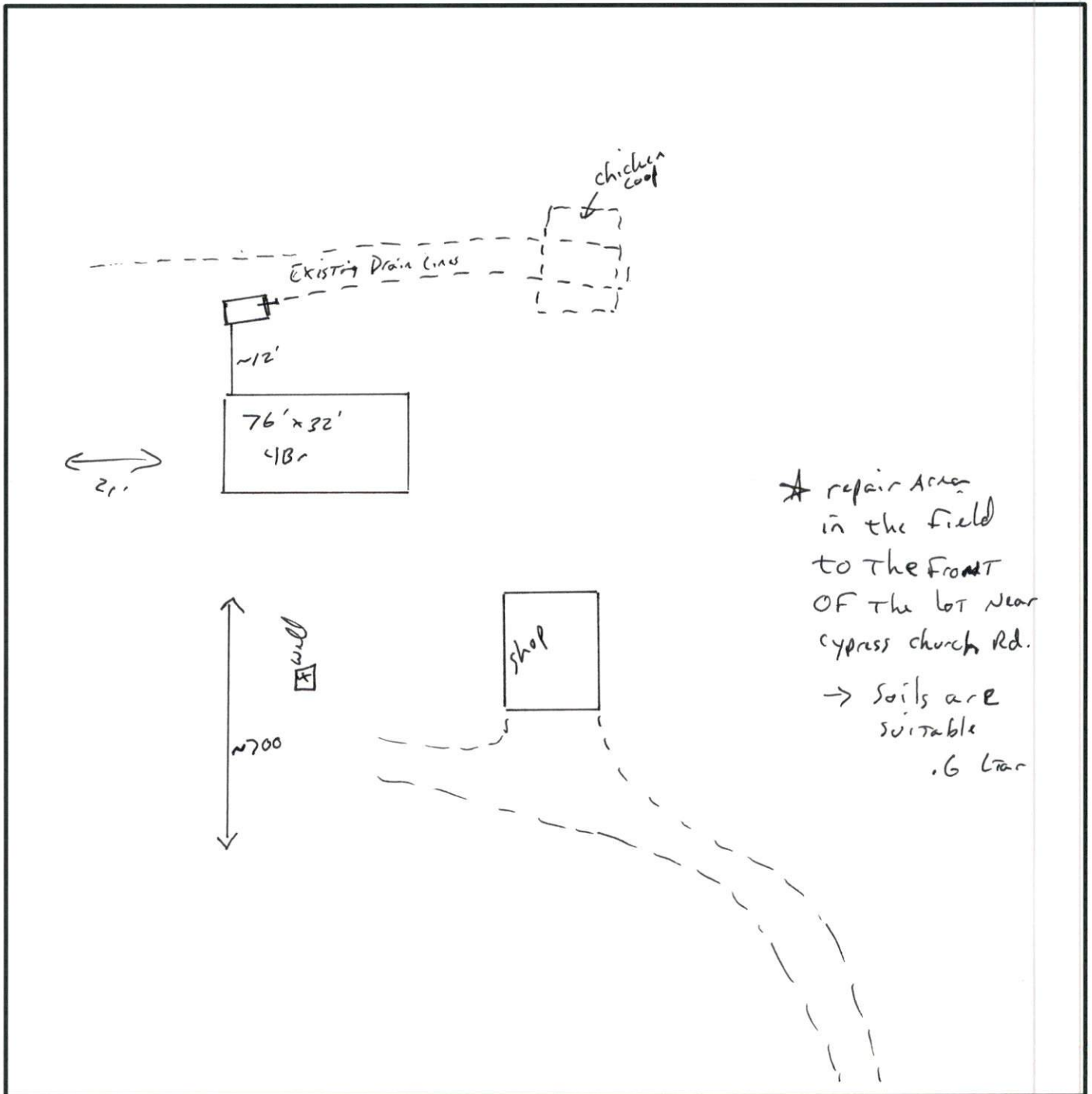

*Include the existing and proposed structures and applicable setbacks.