

# Harnett County Environmental Health

## EXISTING SYSTEM APPROVAL

Issued by:  Local Health Department  AOWE  Certified Inspector

Existing System Approval

Site modification (e.g., storage shed) or footprint addition with no DDF or wastewater strength increase

Reconnection when the proposed facility is in the same footprint as existing/previous facility

Construction Authorization/Notice of Intent to Construct

*[issued for reconnection when the proposed facility is not in the same footprint as existing/previous facility pursuant to Session Law 2023-77, Section 5.(c)]*

*[certified inspectors are not authorized to approve reconnections outside of footprint pursuant to Session Law 2023-77, Section 5.(c)]*

Applicant: James Brown Jr

Mailing Address: PO Box 243

City: Lillington

State: NC Zip: 27546

Phone #: 910-318-0709

Email: \_\_\_\_\_

Owner: Same

Mailing Address: \_\_\_\_\_

City: \_\_\_\_\_

State: \_\_\_\_\_ Zip: \_\_\_\_\_

Phone #: \_\_\_\_\_

Email: \_\_\_\_\_

PIN/Lot Identifier: 0529-41-1766

Property Location/Address: 1623 Tim Currin Rd (SR 1250)

Facility Type:  House/Modular  Mobile/Manufactured Home  Business  Other: \_\_\_\_\_

Operation Permit/ATO #: \_\_\_\_\_ Design Daily Flow: 360 GPD

Number of Bedrooms: 3 Max # Occupants: 6 Other: \_\_\_\_\_

Wastewater Strength:  Domestic  High Strength  Industrial Process Wastewater

Water Supply:  Private well  Public well  Shared well  Municipal Supply  Spring  Other: \_\_\_\_\_

Proposed Property Improvement: \_\_\_\_\_

All of the following must be checked for approval:

**\*For Reconnections:**

- Site complies with its Operation Permit or the wastewater system was in use prior to July 1, 1977
- No current or past uncorrected malfunction of the system as described in 15A NCAC 18E .1303(a)(2)
- DDF and wastewater strength for the proposed facility do not exceed that of the existing system
- Facility meets the setbacks in Section .0600 of 15A NCAC 18E
- Existing system is being operated and maintained in accordance with Section .1300 of 15A NCAC 18E and permit conditions.

**\*For Site Modifications or Footprint Expansions:**

- Proposed structure meets the setbacks in Section .0600 of 15A NCAC 18E

Approval Conditions: \_\_\_\_\_

\_\_\_\_\_

Inspector's Printed Name: Mark Osborne REHS Inspector Certification #: 2613

Inspector's Signature:  Date: 7-5-24

**\*See attached site sketch\***

**EXISTING SYSTEM APPROVAL  
SITE SKETCH**

Operation Permit/ATO #: \_\_\_\_\_ PIN/Lot Identifier: 0529-41-1766  
Owner: James Brown Jr \_\_\_\_\_ Property Location/Address: 1623 Tim Currin Rd (SR 1250)

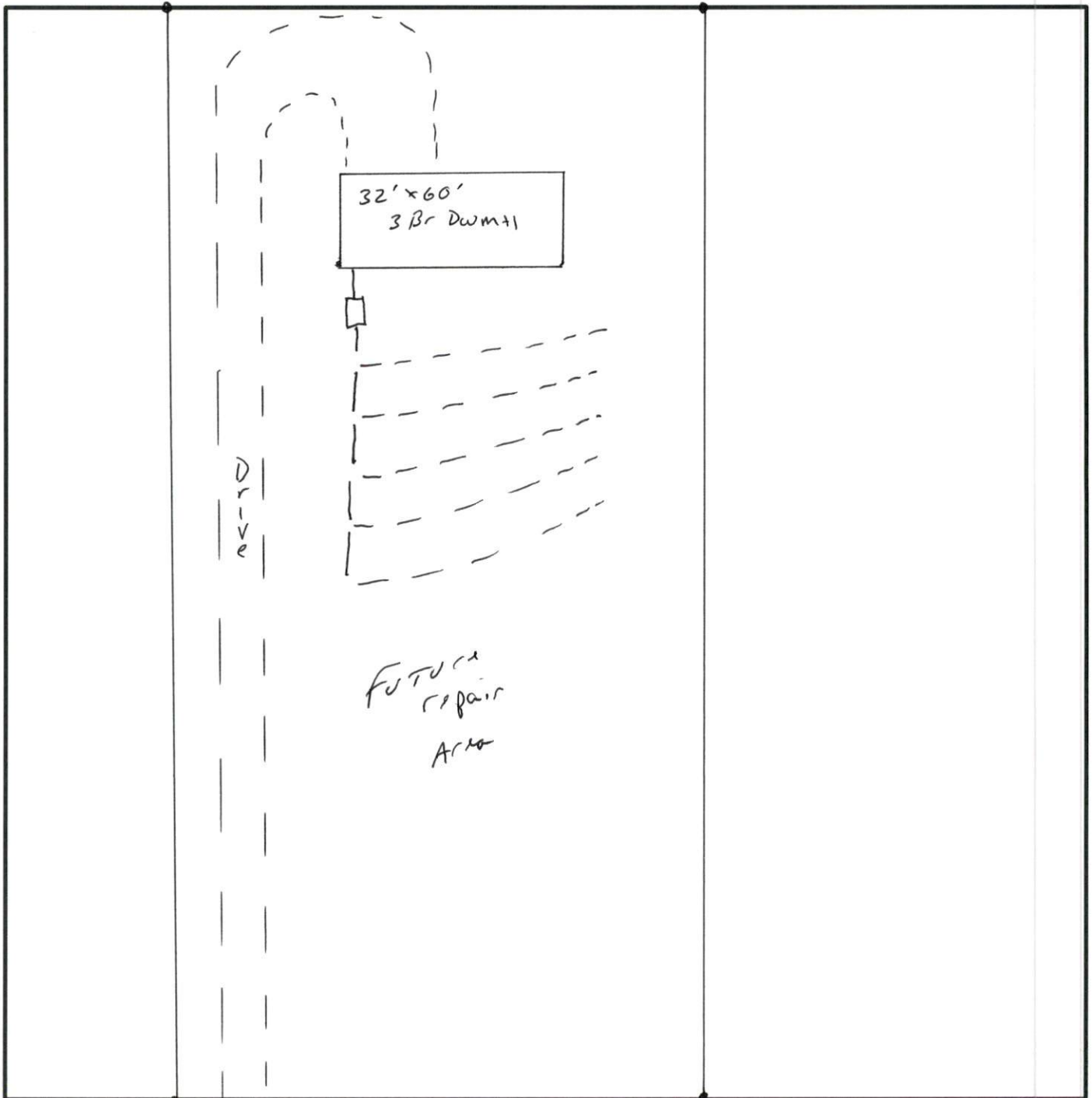

← Tim Currin Rd →  
\*Include the existing and proposed structures and applicable setbacks.