

Harnett County Department of Public Health

PERMIT # Bres 2006-0028

Operation Permit

☒ New Installation ☒ Septic Tank ☒ Nitrification Line ☐ Repair ☐ Expansion

PROPERTY LOCATION: 766 Ed Thomas Rd (SR 1100)

Name: (owner) Marta Gomez

SUBDIVISION _____

LOT # _____

System Installer: Superior Septic

Basement with plumbing: ☐ Garage ☐ Number of Bedrooms 5 (10 people)

Type of Water Supply: ☐ Community ☐ Public ☒ Well Distance from well _____ feet

System Type: Type III B Types V and VI Systems expire in 5 years.

(In accordance with Table V a)

Owner must contact Health Department 6 months prior to expiration for permit renewal.

This system has been installed in compliance with applicable North Carolina General Statutes, Rules for Sewage Treatment and Disposal, and all conditions of the Improvement Permit and Construction Authorization.

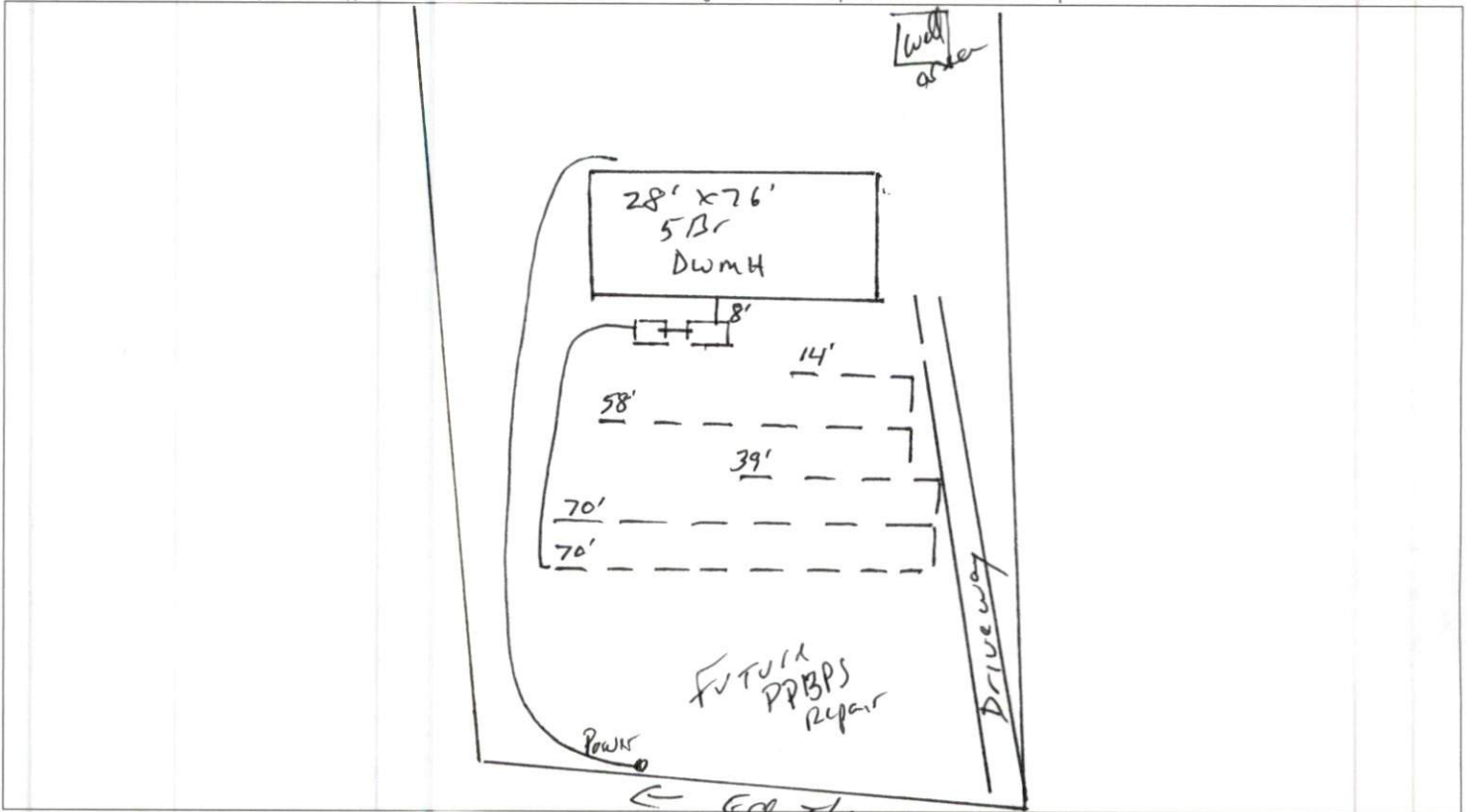

PERMIT CONDITIONS:

I. Performance: System shall perform in accordance with Rule .1961.

II. Monitoring: As required by Rule .1961.

III. Maintenance: As required by Rule .1961. Other: _____

Subsurface system operator required? Yes ☐ No ☒

If yes, see attached sheet for additional operation conditions, maintenance and reporting.

IV. Operation: _____

V. Other: _____

☐ _____ D-Box ☐ _____ Pump ☐ _____ Alarm ☐ _____ H2O Line ☐ _____ PWR Line

Following are the specifications for the sewage disposal system on the above captioned property.

Type of system: ☐ Conventional ☒ Other 25% reduction I/Q4 Septic Tank: 1250 gallons Pump Tank: 1250 gallons

Subsurface No. of exact length width of depth of
Drainage Field ditches 1 of each ditch 25 feet ditches 3 feet ditches 31 inches

French Drain Required: _____ Linear feet

Authorized State Agent _____

Marta Gomez REH

Date 5-19-25