

# Harnett County Department of Public Health

PERMIT # SFD 2312-0226

## Operation Permit

New Installation    Septic Tank    Nitrification Line    Repair    Expansion

PROPERTY LOCATION: 127 Eagle Crest Ct, Lillington

SUBDIVISION Heritage at Ne: 115 Creek LOT # 7

Name: (owner) New Home

System Installer: Denis Medlin

Basement with plumbing:  Garage  Number of Bedrooms 4

Type of Water Supply:  Community    Public    Well   Distance from well \_\_\_\_\_ feet

System Type: 25% Reduction Type III (g) EZ Flow   Types V and VI Systems expire in 5 years.

(In accordance with Table V a)

Owner must contact Health Department 6 months prior to expiration for permit renewal.

This system has been installed in compliance with applicable North Carolina General Statutes, Rules for Sewage Treatment and Disposal, and all conditions of the Improvement Permit and Construction Authorization.

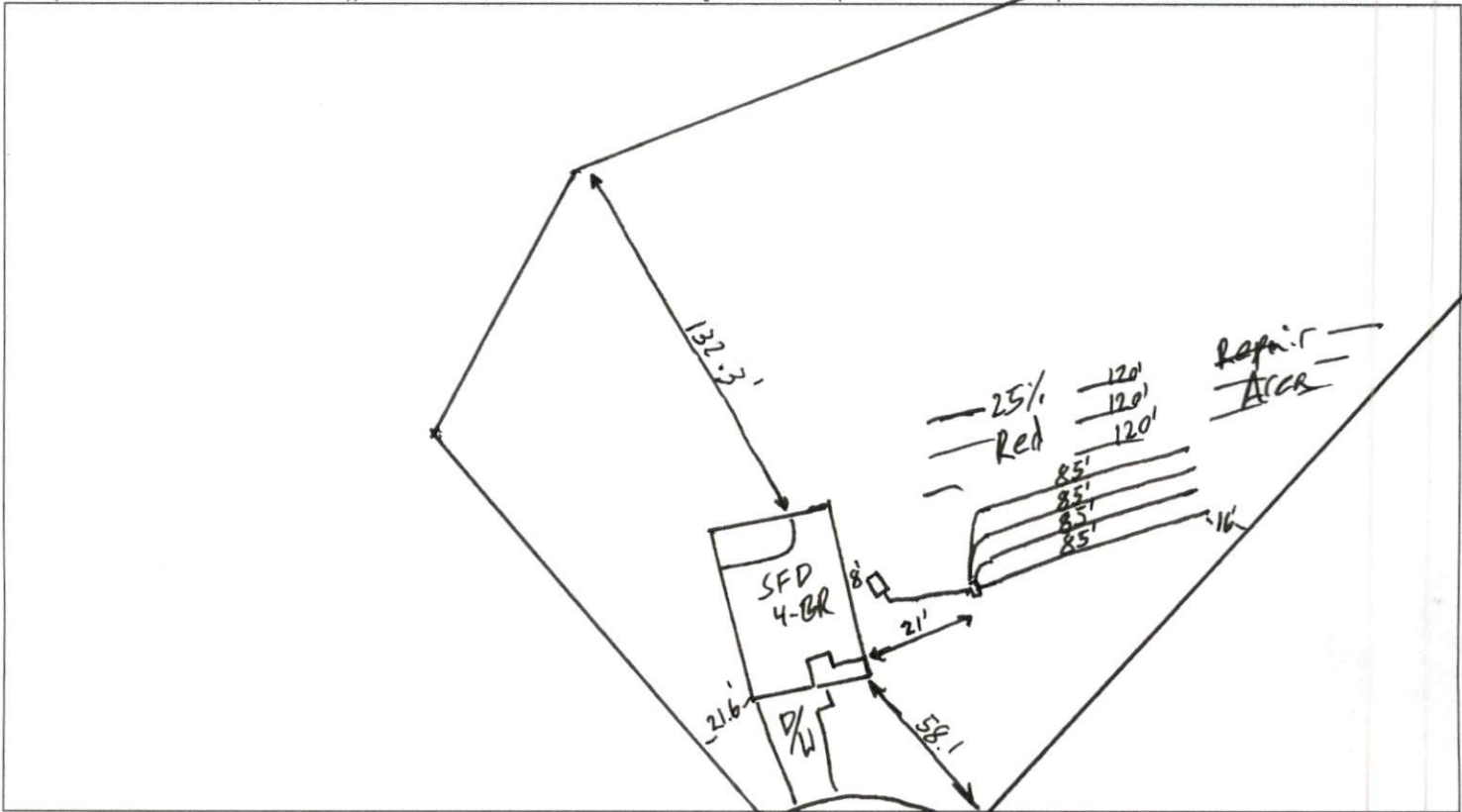

**PERMIT CONDITIONS:**

- I. Performance: System shall perform in accordance with Rule .1961.
- II. Monitoring: As required by Rule .1961.
- III. Maintenance: As required by Rule .1961. Other: \_\_\_\_\_  
Subsurface system operator required? Yes  No   
If yes, see attached sheet for additional operation conditions, maintenance and reporting.

IV. Operation: \_\_\_\_\_  
V. Other: \_\_\_\_\_

D-Box    Pump    Alarm    H2O Line    PWR Line

Following are the specifications for the sewage disposal system on the above captioned property.

Type of system:  Conventional    Other 25% Red Type III (g) EZ Flow   Septic Tank: 1400 gallons   Pump Tank: \_\_\_\_\_ gallons  
Subsurface   No. of   exact length   width of   depth of  
Drainage Field   ditches 4   of each ditch 340' feet   ditches 3 feet   ditches 20'-24" inches  
French Drain Required: \_\_\_\_\_ Linear feet

Authorized State Agent Ren Song REHS   Date 3-26-24