

# Harnett County Environmental Health

## EXISTING SYSTEM APPROVAL

Issued by:  Local Health Department  AOWE  Certified Inspector

Existing System Approval

- Site modification (e.g., storage shed) or footprint addition with no DDF or wastewater strength increase
- Reconnection when the proposed facility is in the same footprint as existing/previous facility

Construction Authorization/Notice of Intent to Construct

*[issued for reconnection when the proposed facility is not in the same footprint as existing/previous facility pursuant to Session Law 2023-77, Section 5.(c)]*  
*[certified inspectors are not authorized to approve reconnections outside of footprint pursuant to Session Law 2023-77, Section 5.(c)]*

Applicant: Donnie Simpson  
Mailing Address: 250 Kinnis Creek Dr  
City: Angier  
State: NC Zip: 27501  
Phone #: 832-359-8976  
Email: \_\_\_\_\_

Owner: Jean Todd  
Mailing Address: 100 Mystic Ln (SR 1229)  
City: Lillington  
State: NC Zip: 27546  
Phone #: 910-890-7871  
Email: \_\_\_\_\_

PIN/Lot Identifier: 0630-50-4783  
Property Location/Address: 100 Mystic Ln (SR 1229)

Facility Type:  House/Modular  Mobile/Manufactured Home  Business  Other: deck addition

Operation Permit/ATO #: \_\_\_\_\_ Design Daily Flow: 480 GPD  
Number of Bedrooms: 4 Max # Occupants: 8 Other: \_\_\_\_\_  
Wastewater Strength:  Domestic  High Strength  Industrial Process Wastewater  
Water Supply:  Private well  Public well  Shared well  Municipal Supply  Spring  Other: \_\_\_\_\_

Proposed Property Improvement: Deck Addition / Future pool

All of the following must be checked for approval:

**\*For Reconnections:**

- Site complies with its Operation Permit or the wastewater system was in use prior to July 1, 1977
- No current or past uncorrected malfunction of the system as described in 15A NCAC 18E .1303(a)(2)
- DDF and wastewater strength for the proposed facility do not exceed that of the existing system
- Facility meets the setbacks in Section .0600 of 15A NCAC 18E
- Existing system is being operated and maintained in accordance with Section .1300 of 15A NCAC 18E and permit conditions.

**\*For Site Modifications or Footprint Expansions:**

- Proposed structure meets the setbacks in Section .0600 of 15A NCAC 18E

Approval Conditions: \_\_\_\_\_  
\_\_\_\_\_

Inspector's Printed Name: Mark Osborne REHS Inspector Certification #: 2613  
Inspector's Signature:  Date: 7-15-24

**\*See attached site sketch\***

**EXISTING SYSTEM APPROVAL  
SITE SKETCH**

Operation Permit/ATO #: \_\_\_\_\_ PIN/Lot Identifier: 0630-50-4783  
Owner: Jean Todd Property Location/Address: 100 Mystic Ln (SR 1229)

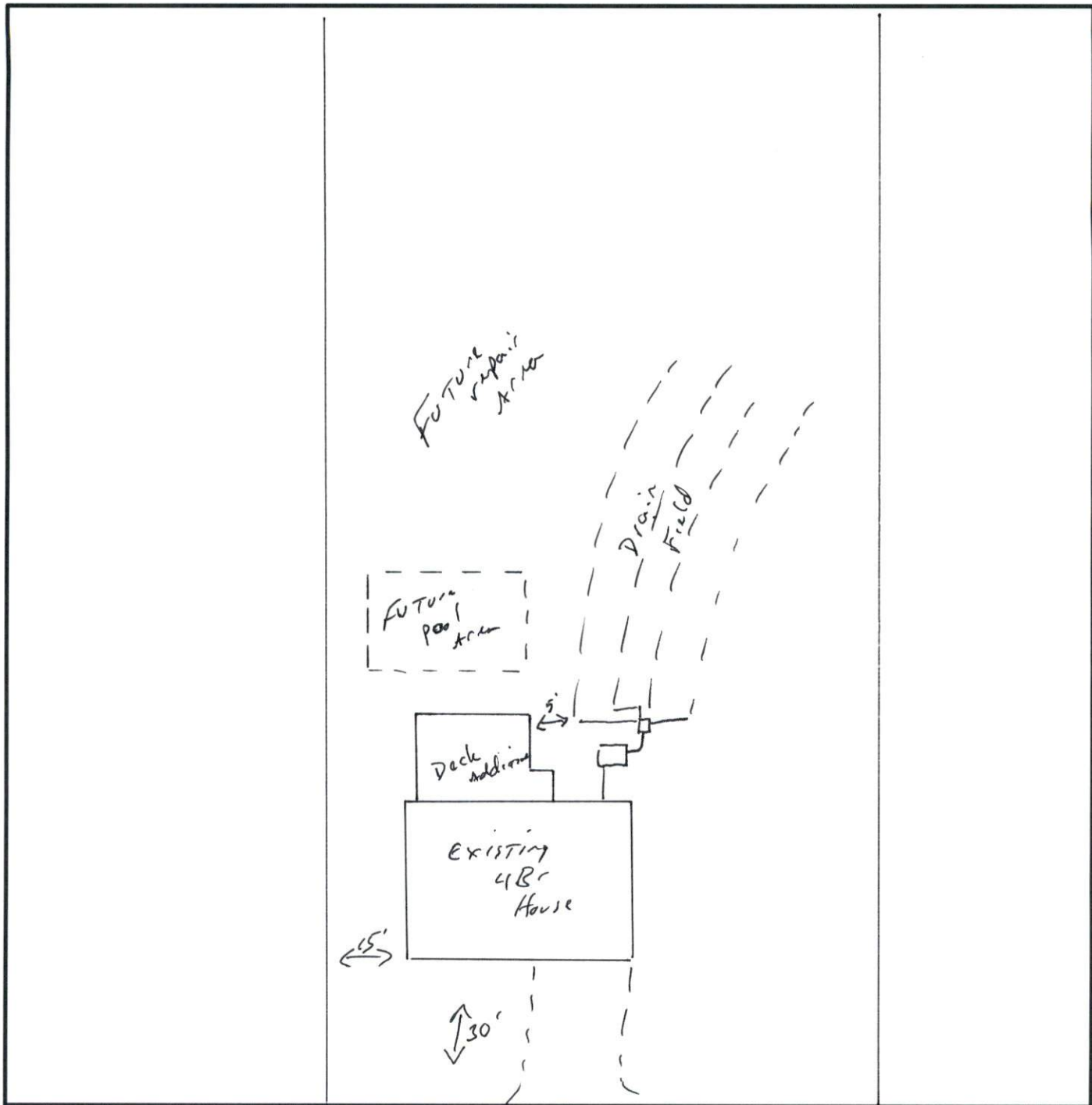

← Mystic Ln →  
\*Include the existing and proposed structures and applicable setbacks.