

## Harnett County Environmental Health

### EXISTING SYSTEM APPROVAL

Issued by:  Local Health Department     AOWE     Certified Inspector

Existing System Approval

Site modification (e.g., storage shed) or footprint addition with no DDF or wastewater strength increase

Reconnection when the proposed facility is in the same footprint as existing/previous facility

Construction Authorization/Notice of Intent to Construct

*[issued for reconnection when the proposed facility is not in the same footprint as existing/previous facility pursuant to Session Law 2023-77, Section 5.(c)]*

*[certified inspectors are not authorized to approve reconnections outside of footprint pursuant to Session Law 2023-77, Section 5.(c)]*

Applicant: Rory Bultinck

Mailing Address: 145 Anderson Creek School Rd

City: Bunnlevel

State: NC                      Zip: 28323

Phone #: 910-309-0496

Email: rory.bultinck@outlook.com

Owner: \_\_\_\_\_

Mailing Address: \_\_\_\_\_

City: \_\_\_\_\_

State: \_\_\_\_\_                      Zip: \_\_\_\_\_

Phone #: \_\_\_\_\_

Email: \_\_\_\_\_

PIN/Lot Identifier: 0526-70-3764

Property Location/Address: 145 Anderson Creek School Rd (SR 2064)

Facility Type:  House/Modular     Mobile/Manufactured Home     Business     Other: \_\_\_\_\_

Operation Permit/ATO #: \_\_\_\_\_ Design Daily Flow: 360 GPD

Number of Bedrooms: 3                      Max # Occupants: 6                      Other: \_\_\_\_\_

Wastewater Strength:  Domestic     High Strength     Industrial Process Wastewater

Water Supply:  Private well     Public well     Shared well     Municipal Supply     Spring     Other: \_\_\_\_\_

Proposed Property Improvement: addition of a 30'x50' garage

- All of the following must be checked for approval:
- \*For Reconnections:**
- Site complies with its Operation Permit or the wastewater system was in use prior to July 1, 1977
  - No current or past uncorrected malfunction of the system as described in 15A NCAC 18E .1303(a)(2)
  - DDF and wastewater strength for the proposed facility do not exceed that of the existing system
  - Facility meets the setbacks in Section .0600 of 15A NCAC 18E
  - Existing system is being operated and maintained in accordance with Section .1300 of 15A NCAC 18E and permit conditions.
- \*For Site Modifications or Footprint Expansions:**
- Proposed structure meets the setbacks in Section .0600 of 15A NCAC 18E

Approval Conditions: \_\_\_\_\_

\_\_\_\_\_

Inspector's Printed Name: Mark Osborne REHS                      Inspector Certification #: 2613

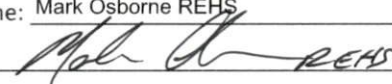
Inspector's Signature:                       Date: 06-26-24

**\*See attached site sketch\***

**EXISTING SYSTEM APPROVAL  
SITE SKETCH**

Operation Permit/ATO #: \_\_\_\_\_ PIN/Lot Identifier: 0526-70-3764  
Owner: Rory Bultinck \_\_\_\_\_ Property Location/Address: 145 Anderson Creek School Rd (SR 2064)

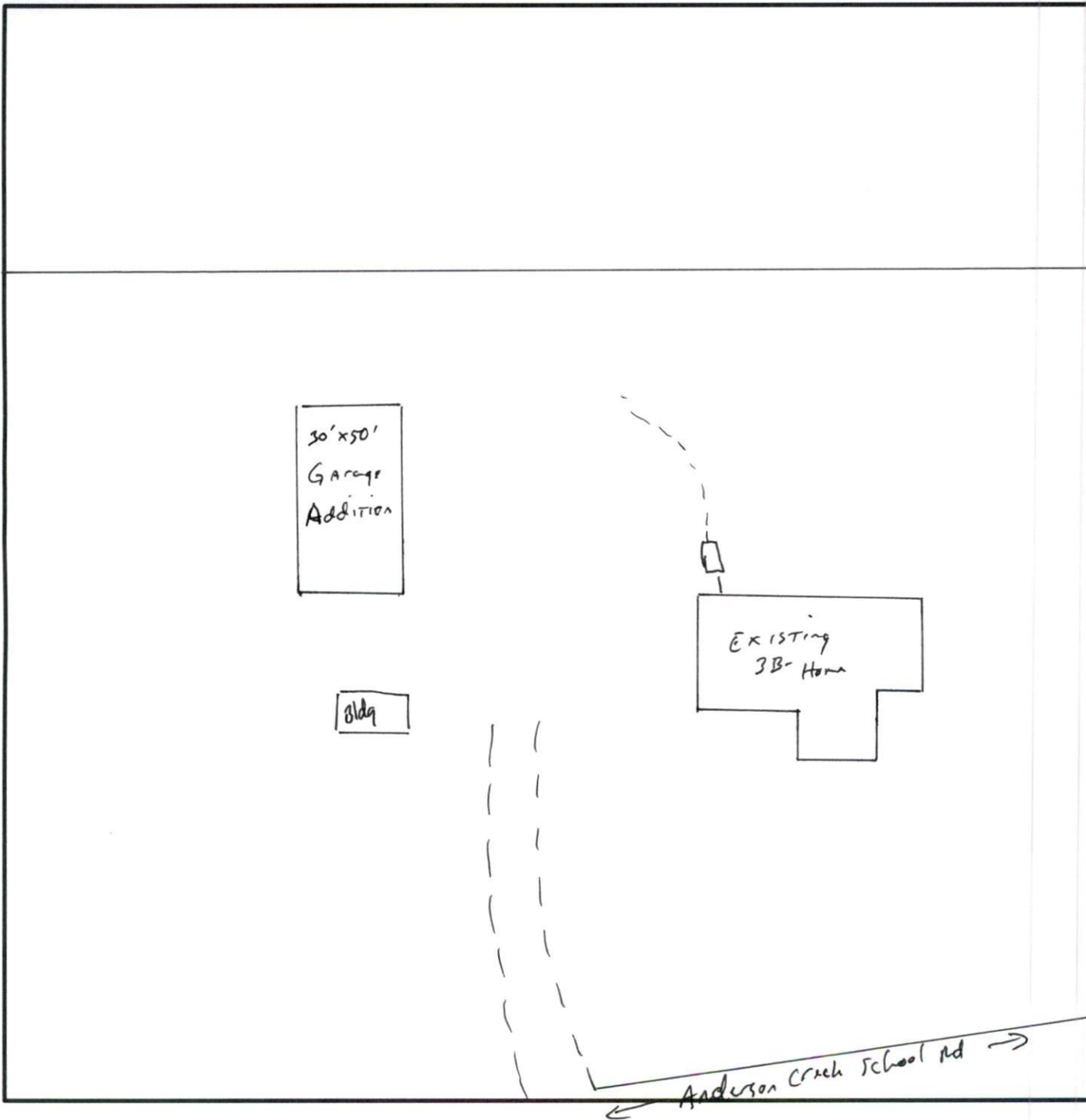

*\*Include the existing and proposed structures and applicable setbacks.*