

MINIMUM BUILDING SETBACKS  
ZONING: RA-30

FRONT.....35'  
SIDE.....10'  
REAR.....25'

LINE	BEARING	DISTANCE
L1	N64°45'00"W	7.50'
L2	N64°45'00"W	22.74'
L3	S71°40'00"E	30.07'
L4	S71°40'00"E	71.75'

ARROWHEAD ROAD  
SR 1780  
60' R/W (PUBLIC)

N/F  
HEADWATERS TIMBER, LLC  
DB 2132 PG 969  
PID 021515 0244

N/F  
CORBETT F. BLACKMAN  
DB 11E PG 221  
PID 021505 0019

DB 4230 PG 1293  
PID 021505 0089

AREA IN LOT  
810404 SF  
18.604 AC

AREA IN R/W  
14225 SF  
0.327 AC

N/F  
JOHNNY B. SMITH  
DB 799 PG 151  
PID 021504 0050

N/F  
ALENE T. SMITH  
DB 3282 PG 0100  
PID 021505 0200

NOTE: BLACK RIVER, THE FLOODWAY,  
THE APPROXIMATE LOCATION OF THE  
100 YEAR FLOOD, THE POWER LINE  
EASEMENTS, AND THE TREE LINES  
WERE SCALED IN FROM GIS.

IMPERVIOUS SURFACE TABLE

HOUSE	1780 SF
DRIVEWAY	11820 SF
BARN	1500 SF
TOTAL IMPERVIOUS	15100 SF
MAXIMUM IMPERVIOUS	N/A

IMPERVIOUS COVERAGE N/A  
REMAINING IMPERVIOUS N/A

OVERALL HOUSE DIMENSIONS:  
60.0' x 29.7'

SCALE: 1" = 100'  
50 0 100 200

PLOT PLAN  
OF  
**21**  
**W. BLACKMAN ROAD**  
**HARNETT COUNTY**  
FOR  
**BOBBY JOHNSON**

PLOT PLAN IS FOR PRECONSTRUCTION ONLY

\* PID: 021505 0089  
\* SITE: 21 W. BLACKMAN ROAD  
DUNN, NC 28334

PROPOSED DRIVEWAY CULVERT SIZE

STORMWATER ADMINISTRATOR SIGNATURE

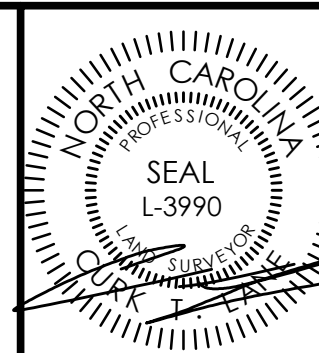

**TRUE LINE SURVEYING, P.C.**

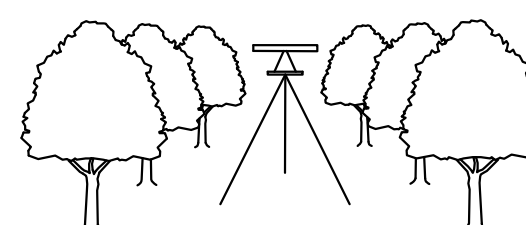

205 WEST MAIN STREET  
CLAYTON, N.C. 27520  
TELEPHONE: (919) 359-0427  
FAX: (919) 359-0428

C-1859

JOB NO: 5079.001

DATE: 05/10/2024

DRAWN: RICHIE

CHECKED: CURK