

NORTH CAROLINA HARNETT COUNTY
 I, Mickey R. Bennett, PLS do certify that this plat was drawn under
 my supervision and description recorded in Book SEE,
 Page SEE, etc) that the boundaries not surveyed or clearly
 indicated as drawn from information as calculated is 1:7500; that this plat
 was prepared in accordance with G.S. 47-30 as amended. Witness
 my original signature, registration number and seal this 24th
 day of February A.D. 2010.



M. R. Bennett
 MICKEY R. BENNETT
 L - 1514

I MICKEY R. BENNETT PLS
 DO HERE BY CERTIFY THAT THIS
 IS AN EXISTING PARCEL OR PARCELS
 OF LAND AND DOES NOT CREATE
 A NEW STREET OR CHANGE ANY
 EXISTING STREETS.

NORTH REFERENCE MAP NO. 98-469



MINIMUM BUILDING SET BACKS
 FRONT YARD ----- 35'
 REAR YARD ----- 25'
 SIDE YARD ----- 10'
 CORNER LOT SIDE YARD -- 20'
 MAXIMUM HEIGHT ----- 35'



FOR REGISTRATION REGISTERED OF DEEDS
 HARNETT COUNTY, N.C.
 2010 FEB 01 10:53:08 AM
 BK: 2010 PG: 122-123 FEE: \$21.00
 INSTRUMENT # 2010082478

NO APPROVAL NECESSARY
Kelli H. O'Neil 3-1-10
 REVIEW OFFICER

- LEGEND**
- LINES NOT SURVEYED
 - LINES SURVEYED
 - EP----- EXISTING IRON PIPE
 - ECM----- EXISTING CONCRETE MONUMENT
 - EIS----- EXISTING IRON STAKE
 - EPN----- EXISTING P.C. NAIL
 - E.L.S----- EXISTING LIGHTWOOD STAKE
 - NIS----- NEW IRON STAKE NIP----- NEW IRON PIPE
 - PKNS----- P.C. NAIL SET
 - ERS----- EXISTING RAILROAD SPIKE
 - NRS----- NEW RAILROAD SPIKE
 - EMT----- EXISTING MAGNETIC NAIL
 - MN----- NEW MAGNETIC NAIL
 - EC----- EXISTING COTTON SPINDLE
 - NCS----- NEW COTTON SPINDLE
 - EP/ES----- (CONTROL CORNERS)
 - ECM/PN/TKS (CONTROL CORNERS)
 - C/L----- CENTER LINE N/F----- NOW OR FORMALLY
 - CP----- CALCULATED POINT
 - CRD----- CHORD BEARING AND DISTANCE
 - D.E----- DRAINAGE EASEMENT R/W----- RIGHT OF WAY
 - EX----- EXISTING AC----- ACRES

NORTH CAROLINA
 HARNETT COUNTY
 This Map/Plat was presented for registration and
 recorded in this office on Map Number 2010-122
 This 1 day of March 2010,
 at 10:53 o'clock A. M.
 KIMBERLY S. HARGROVE Register of Deeds
 By: *Ana J. Boyd*
 Assistant County Register of Deeds

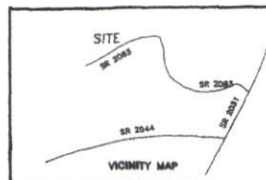

EXISTING PARCEL				BENNETT SURVEYS, INC. C-1080 1662 CLARK RD., LILLINGTON, N.C. 27546 (910) 893-5252	
SURVEY FOR: PAUL E. GRIFFIN JR. SHERI A. GRIFFIN				40' 0 80'	FIELD BOOK
TOWNSHIP	STEWARTS CREEK	COUNTY	HARNETT	SURVEYED BY:	JRM
STATE:	NORTH CAROLINA	DATE:	FEBRUARY 24, 2010	DRAWN BY:	MRB
ZONE	RA-20R	TAX PARCEL ID#:	120555 0223 01	CHECKED & CLOSURE BY:	MRB
		PIN #	0555-05-0123.000		10098

MAP # 2010-122