

NOTES:

- Trim existing 100' trenches to 80' and add an 80' trench below
- Shift D-Box/Pressure manifold to accommodate setbacks
- Keep existing tanks

4-Bedroom
 LTAR: 0.3 gpd/ft²
 Existing Initial: Pump-to-Innovative 25% Reduction Status Product utilizing lines 5-8 (400')
 Proposed New Initial: Pump-to-Innovative 25% Reduction Status Product utilizing lines 5-9 (400')
 Repair: Pump-to-PPBPS utilizing lines 1-4 (268')

Repair septic drainfield

Initial septic drainfield

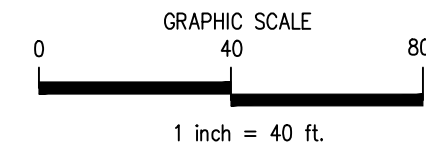
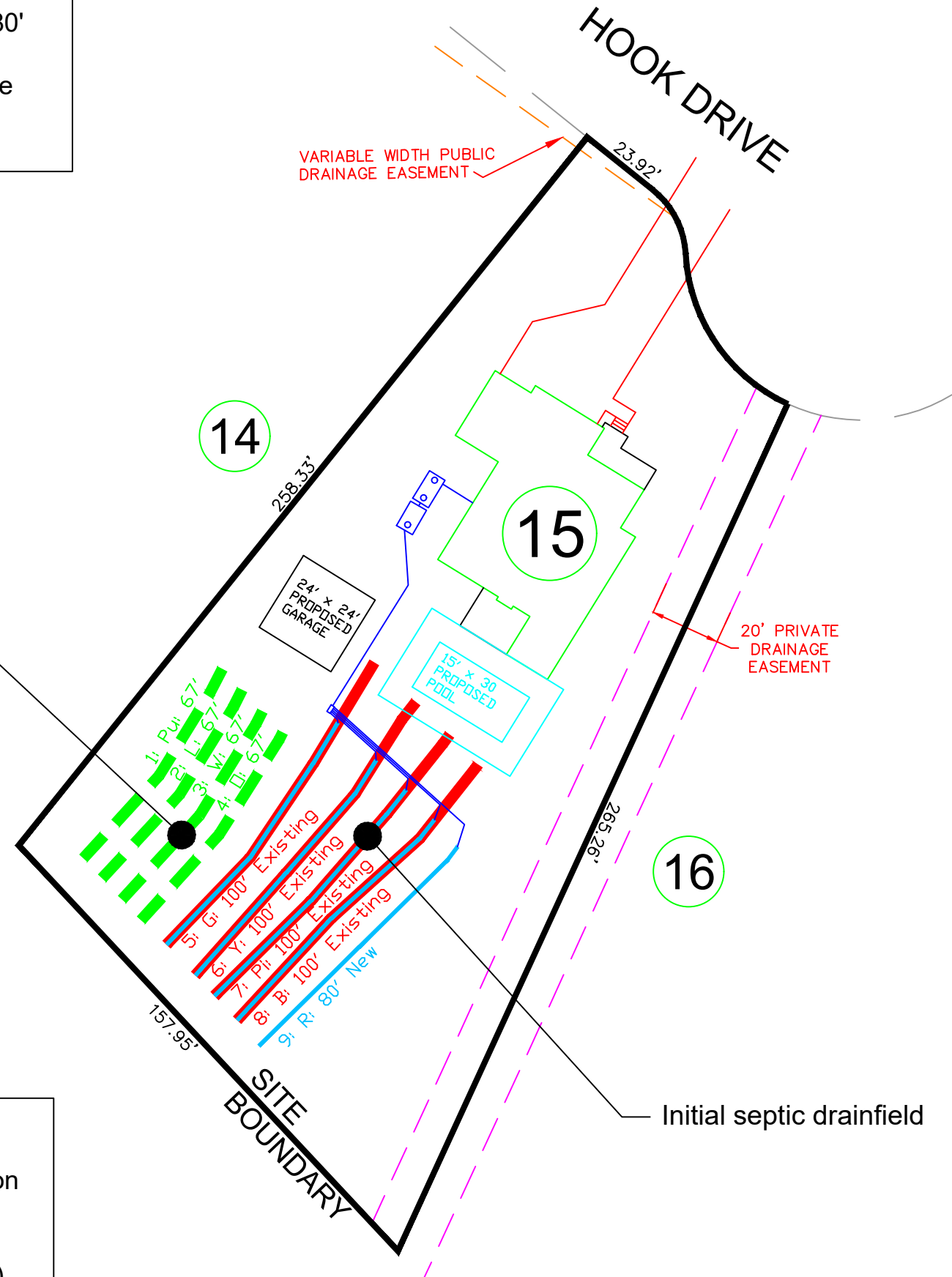

MITCHELL ENVIRONMENTAL, PA
 C-2917
 1501 LAKESTONE VILLAGE LANE
 SUITE 205
 FUQUAY VARINA, NC 27526

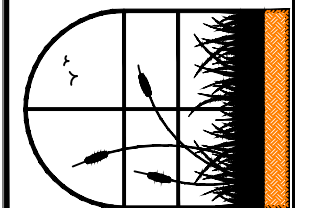

PREPARED FOR : Triple A Homes
 1013 Green Oaks Parkway
 Holly Springs, NC 27540

DATE : February 27, 2024

DESIGNER CONTACT:
 ADAM AYCOCK, EI

DRAWN BY:
 ADAM AYCOCK, EI

REVISION NO. DATE
 Original Submittal February 27, 2024
 Revision 1
 Revision 2
 Revision 3
 Master Set

SHEET NUMBER
 1 of 1

Cotton Farms
 Lot 4
 Overall Septic