

**VICINITY MAP**  
Not To Scale

SETBACKS: (PB 2023 PG 618)

FRONT - 35'  
SIDE - 10'  
REAR - 25'  
CORNER SIDE - 20'

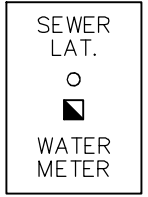
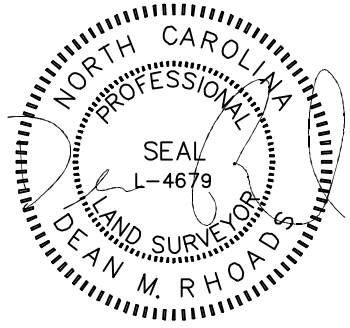
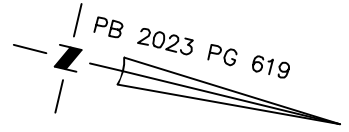

| SOD/SEEDING  |       |
|--------------|-------|
| TYPE         | S.F.  |
| SOD          | 3,075 |
| SEED & STRAW | 0     |

THIS DRAWING DOES NOT REFLECT AS-BUILT INFORMATION

**PRELIMINARY PLAT**  
NOT FOR RECORDATION, CONVEYANCES, OR SALES.

THIS PROPERTY MAY BE SUBJECT TO ANY AND ALL APPLICABLE DEED RESTRICTIONS, EASEMENTS, RIGHT-OF-WAY, UTILITIES AND RESTRICTIVE COVENANTS WHICH MAY BE OF RECORD OR IMPLIED

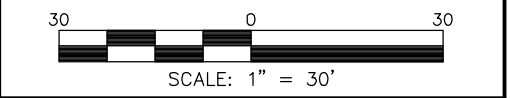

**RESIDENTIAL LAND SERVICES, PLLC.**

1917 Evans Road  
Cary, North Carolina 27513  
Phone (919) 378-9316  
Firm License # P-0873

**HOUSE LOCATION PLOT PLAN**

FOR  
#164, #160, #156, #152, #148, #144, #140, & #136 CAMEL CRAZIES PLACE  
LOTS 33-40, BUIES CREEK TOWNHOMES  
Neills Creek Township, Harnett County, North Carolina  
TRUE HOMES

MAP BOOK 2023 PAGE 618-620 DEED REFERENCE \_\_\_\_\_

DRAWN: ADP    SURVEYED: N/A    CHECKED: xxx    DATE: MARCH 22, 2024

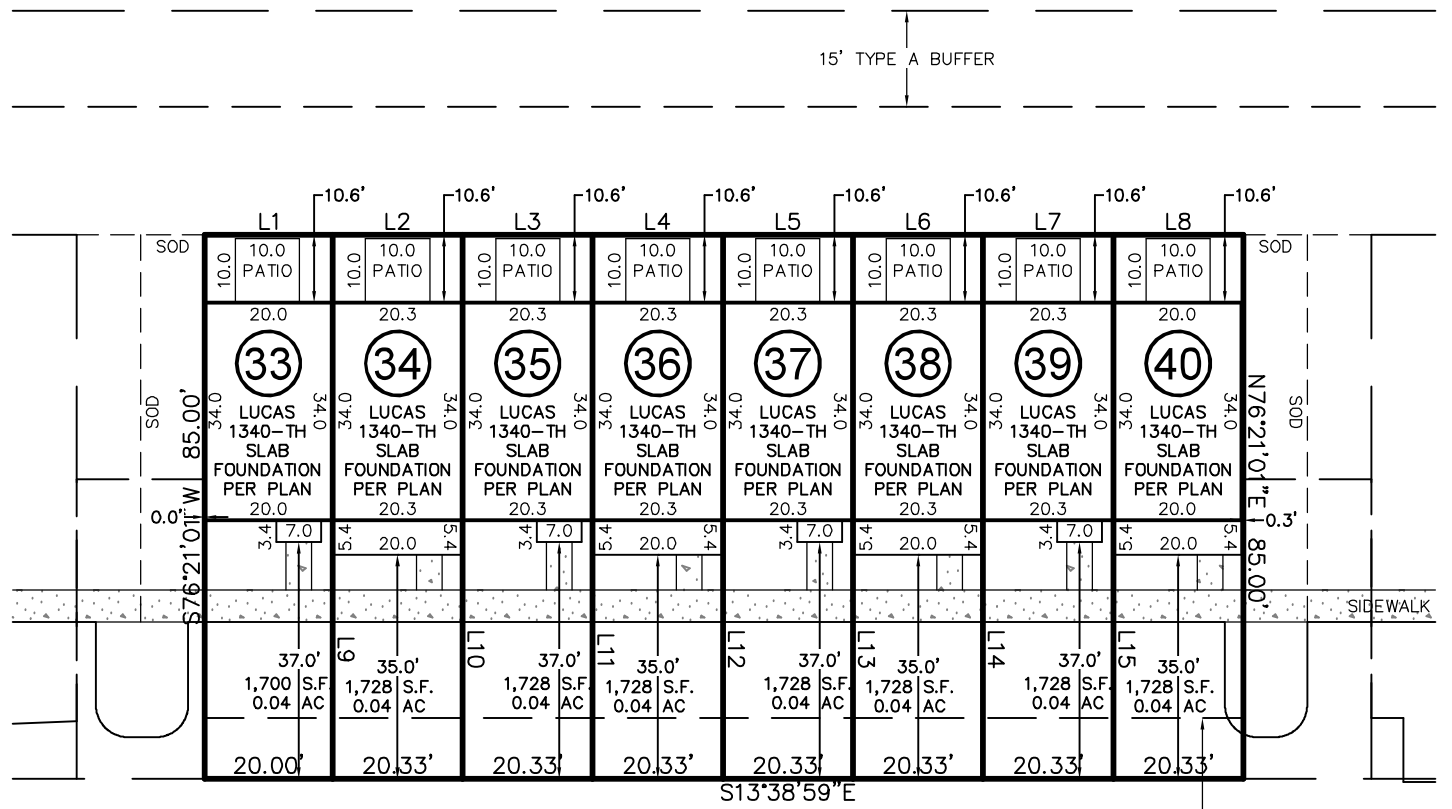

**CAMEL CRAZIES PLACE**

30' PUBLIC ACCESS & UTILITY EASEMENT

30' PUBLIC ACCESS & UTILITY EASEMENT

| LINE | BEARING     | DISTANCE |
|------|-------------|----------|
| L1   | N13°38'59"W | 20.00'   |
| L2   | N13°38'59"W | 20.33'   |
| L3   | N13°38'59"W | 20.33'   |
| L4   | N13°38'59"W | 20.33'   |
| L5   | N13°38'59"W | 20.33'   |
| L6   | N13°38'59"W | 20.33'   |
| L7   | N13°38'59"W | 20.33'   |
| L8   | N13°38'59"W | 20.33'   |
| L9   | N76°21'01"E | 85.00'   |
| L10  | N76°21'01"E | 85.00'   |
| L11  | N76°21'01"E | 85.00'   |
| L12  | N76°21'01"E | 85.00'   |
| L13  | N76°21'01"E | 85.00'   |
| L14  | N76°21'01"E | 85.00'   |
| L15  | N76°21'01"E | 85.00'   |

| IMPERVIOUS SURFACE AREA |             |
|-------------------------|-------------|
| DESCRIPTION             | AREA (S.F.) |
| LOT AREA TO SIDEWALK    | 11,030      |
| BUILDING w/PORCHES      | 6,035       |
| DRIVE TO R/W @ 4"       | 0           |
| DRIVE APRON @ 6"        | 0           |
| PATIOS                  | 800         |
| 4' LEAD WALKS           | 208         |
| PUBLIC WALK             | 912         |
| TOTAL PROPOSED          | 7,955       |
| % IMPERVIOUS AREA       | =72.1%      |