

THIS IS TO CERTIFY THAT ON THE 4th DAY OF JUNE 2024 AN ACTUAL SURVEY WAS DONE UNDER MY SUPERVISION OF THE PROPERTY SHOWN HEREON, THIS MAP IS NOT INTENDED TO MEET GS 47-30 RECORDING REQUIREMENTS.

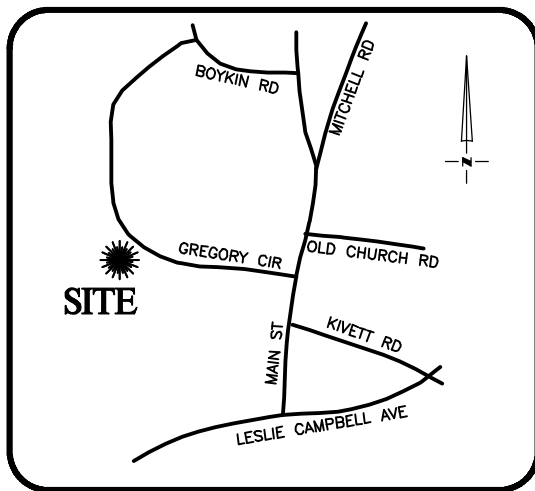

**VICINITY MAP**  
Not To Scale

SETBACKS: (PB 2023 PG 618)

- FRONT - 35'
- SIDE - 10'
- REAR - 25'
- CORNER SIDE - 20'

**LEGEND**

- PROPERTY LINE
- ADJACENT PROPERTY LINES
- CLOSURE EXCEEDS 1 INCH IN 10,000 FT.
- IPS ● - IRON PIN SET
- EIP ○ - EXISTING IRON PIPE
- CP ○ - COMPUTED POINT
- DB - DEED BOOK
- PB - BOOK OF MAPS/PLAT BOOK
- PG - PAGE
- #136-164 STREET ADDRESS

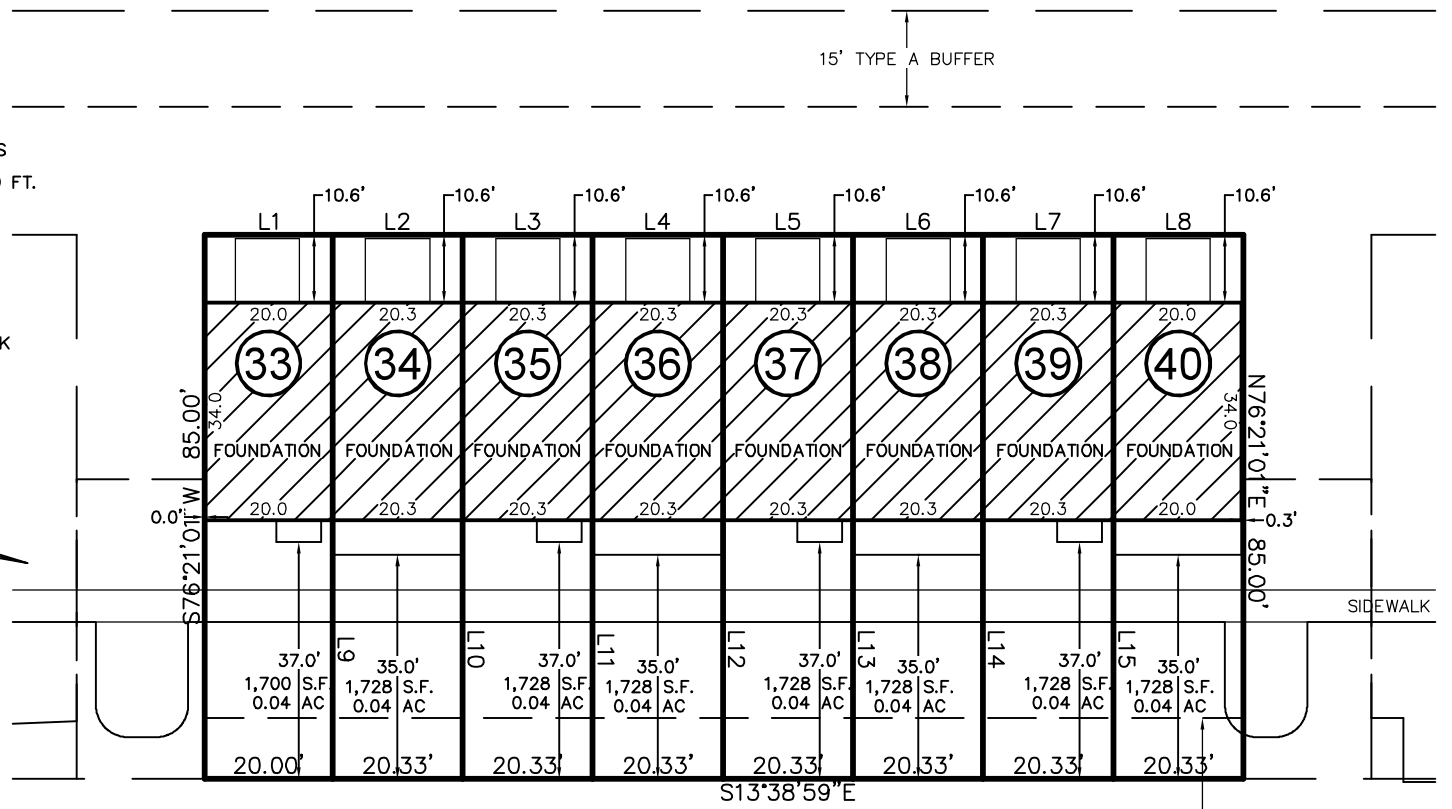
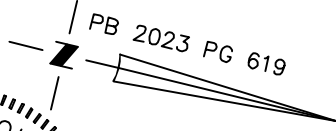
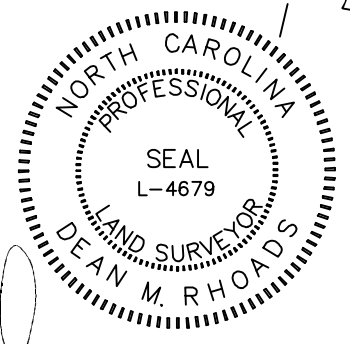

**CAMEL CRAZIES PLACE**

30' PUBLIC ACCESS & UTILITY EASEMENT

SIGNED   
DEAN M. RHOADS, PLS (L-4679)

THIS PROPERTY MAY BE SUBJECT TO ANY AND ALL APPLICABLE DEED RESTRICTIONS, EASEMENTS, RIGHT-OF-WAY, UTILITIES AND RESTRICTIVE COVENANTS WHICH MAY BE OF RECORD OR IMPLIED

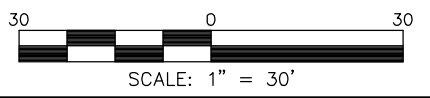

**RESIDENTIAL LAND SERVICES, PLLC.**

1917 Evans Road  
Cary, North Carolina 27513  
Phone (919) 378-9316  
Firm License # P-0873

**FOUNDATION SURVEY**

FOR  
#164, #160, #156, #152, #148, #144, #140, & #136 CAMEL CRAZIES PLACE  
LOTS 33-40, BUIES CREEK TOWNHOMES  
Neills Creek Township, Harnett County, North Carolina  
TRUE HOMES

MAP BOOK 2023 PAGE 618-620 DEED REFERENCE \_\_\_\_\_

DRAWN: JLS    SURVEYED: N/A    CHECKED: JLS    DATE: JUNE 4, 2024

LINE	BEARING	DISTANCE
L1	N13°38'59"W	20.00'
L2	N13°38'59"W	20.33'
L3	N13°38'59"W	20.33'
L4	N13°38'59"W	20.33'
L5	N13°38'59"W	20.33'
L6	N13°38'59"W	20.33'
L7	N13°38'59"W	20.33'
L8	N13°38'59"W	20.33'
L9	N76°21'01"E	85.00'
L10	N76°21'01"E	85.00'
L11	N76°21'01"E	85.00'
L12	N76°21'01"E	85.00'
L13	N76°21'01"E	85.00'
L14	N76°21'01"E	85.00'
L15	N76°21'01"E	85.00'