

VICINITY MAP
Not To Scale

SETBACKS: (PB 2023 PG 618)

FRONT - 35'
SIDE - 10'
REAR - 25'
CORNER SIDE - 20'

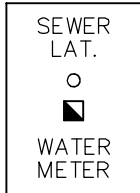
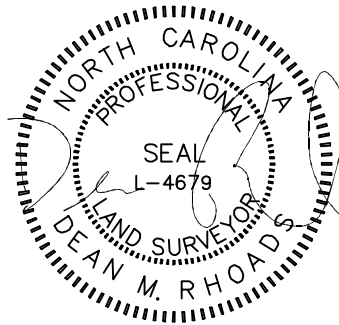
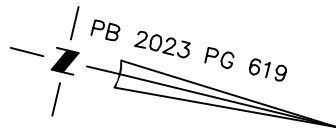

SOD/SEEDING	
TYPE	S.F.
SOD	3,075
SEED & STRAW	0

THIS DRAWING DOES NOT REFLECT AS-BUILT INFORMATION

PRELIMINARY PLAT
NOT FOR RECORDATION, CONVEYANCES, OR SALES.

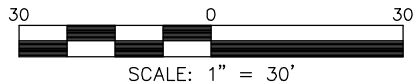

THIS PROPERTY MAY BE SUBJECT TO ANY AND ALL APPLICABLE DEED RESTRICTIONS, EASEMENTS, RIGHT-OF-WAY, UTILITIES AND RESTRICTIVE COVENANTS WHICH MAY BE OF RECORD OR IMPLIED

HOUSE LOCATION PLOT PLAN

FOR
#164, #160, #156, #152, #148, #144, #140, & #136 CAMEL CRAZIES PLACE
LOTS 33-40, BUIES CREEK TOWNHOMES

Neills Creek Township, Harnett County, North Carolina
TRUE HOMES

MAP BOOK 2023 PAGE 618-620 DEED REFERENCE _____

DRAWN: ADP SURVEYED: N/A CHECKED: xxx DATE: MARCH 22, 2024

RESIDENTIAL LAND SERVICES, PLLC.

1917 Evans Road
Cary, North Carolina 27513
Phone (919) 378-9316
Firm License # P-0873

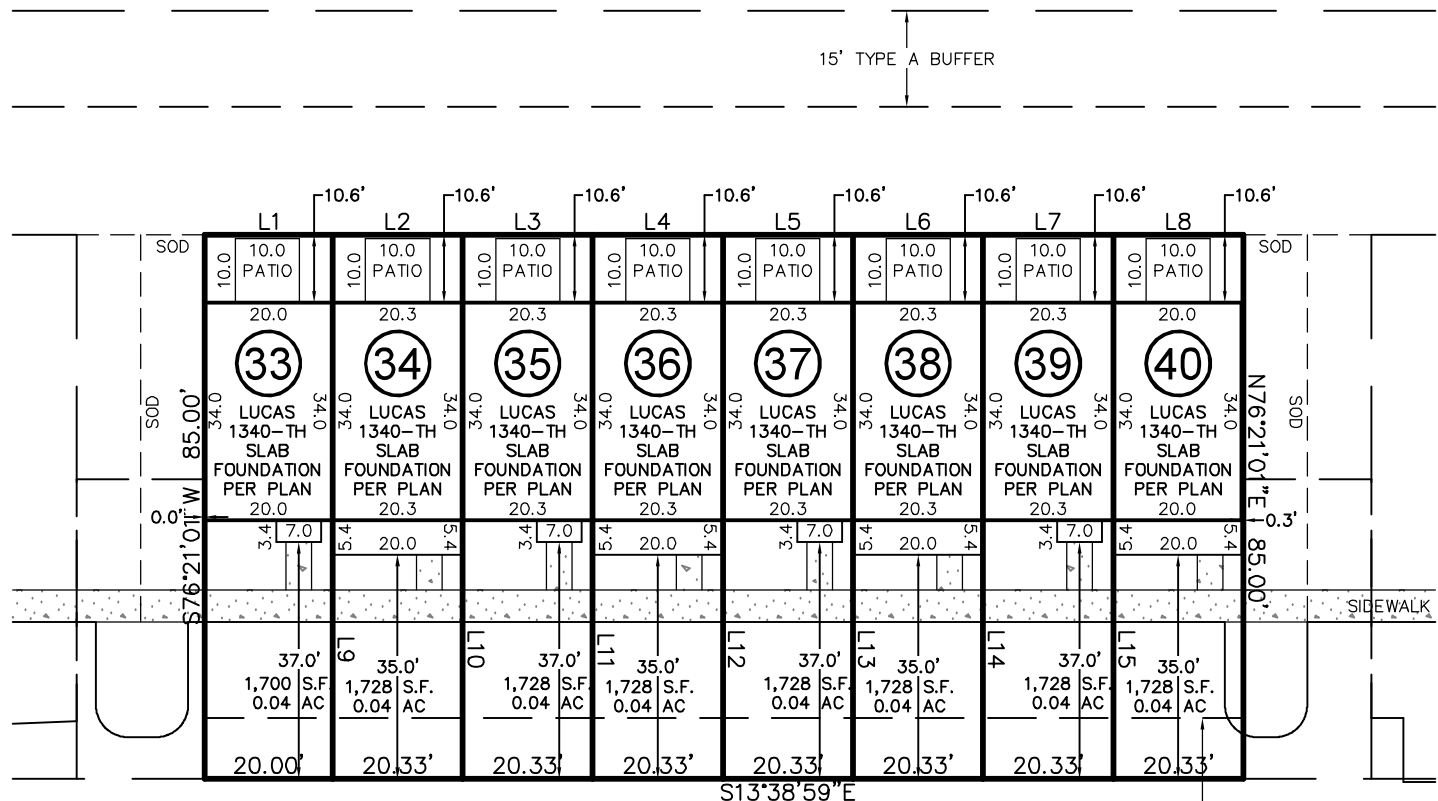

CAMEL CRAZIES PLACE

30' PUBLIC ACCESS & UTILITY EASEMENT

30' PUBLIC ACCESS & UTILITY EASEMENT

LINE	BEARING	DISTANCE
L1	N13°38'59"W	20.00'
L2	N13°38'59"W	20.33'
L3	N13°38'59"W	20.33'
L4	N13°38'59"W	20.33'
L5	N13°38'59"W	20.33'
L6	N13°38'59"W	20.33'
L7	N13°38'59"W	20.33'
L8	N13°38'59"W	20.33'
L9	N76°21'01"E	85.00'
L10	N76°21'01"E	85.00'
L11	N76°21'01"E	85.00'
L12	N76°21'01"E	85.00'
L13	N76°21'01"E	85.00'
L14	N76°21'01"E	85.00'
L15	N76°21'01"E	85.00'

IMPERVIOUS SURFACE AREA	
DESCRIPTION	AREA (S.F.)
LOT AREA TO SIDEWALK	11,030
BUILDING w/PORCHES	6,035
DRIVE TO R/W @ 4"	0
DRIVE APRON @ 6"	0
PATIOS	800
4' LEAD WALKS	208
PUBLIC WALK	912
TOTAL PROPOSED	7,955
% IMPERVIOUS AREA	=72.1%