

VICINITY MAP

Not To Scale

SETBACKS: (PB 2023 PG 618)

FRONT - 35'
 SIDE - 10'
 REAR - 25'
 CORNER SIDE - 20'

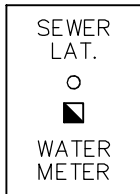
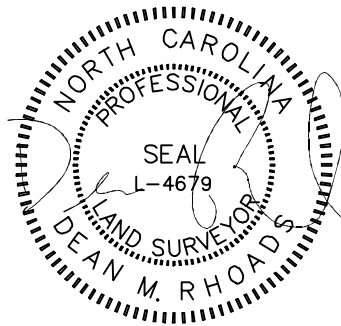
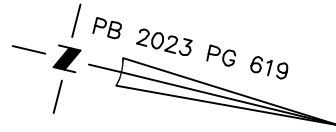

| | |
|--------------|-------|
| SOD/SEEDING | |
| TYPE | S.F. |
| SOD | 2,572 |
| SEED & STRAW | 0 |

THIS DRAWING DOES NOT REFLECT AS-BUILT INFORMATION

PRELIMINARY PLAT
 NOT FOR RECORDATION, CONVEYANCES, OR SALES.

THIS PROPERTY MAY BE SUBJECT TO ANY AND ALL APPLICABLE DEED RESTRICTIONS, EASEMENTS, RIGHT-OF-WAY, UTILITIES AND RESTRICTIVE COVENANTS WHICH MAY BE OF RECORD OR IMPLIED

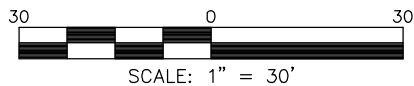

RESIDENTIAL LAND SERVICES, PLLC.

1917 Evans Road
 Cary, North Carolina 27513
 Phone (919) 378-9316
 Firm License # P-0873

HOUSE LOCATION PLOT PLAN

FOR
 #132, #128, #124, #120, #116, & #112 CAMEL CRAZIES PLACE
 LOTS 41-46, BUIES CREEK TOWNHOMES

Neills Creek Township, Harnett County, North Carolina
 TRUE HOMES

MAP BOOK 2023 PAGE 618-620 DEED REFERENCE _____

DRAWN: ADP SURVEYED: N/A CHECKED: DMR DATE: MARCH 7, 2024

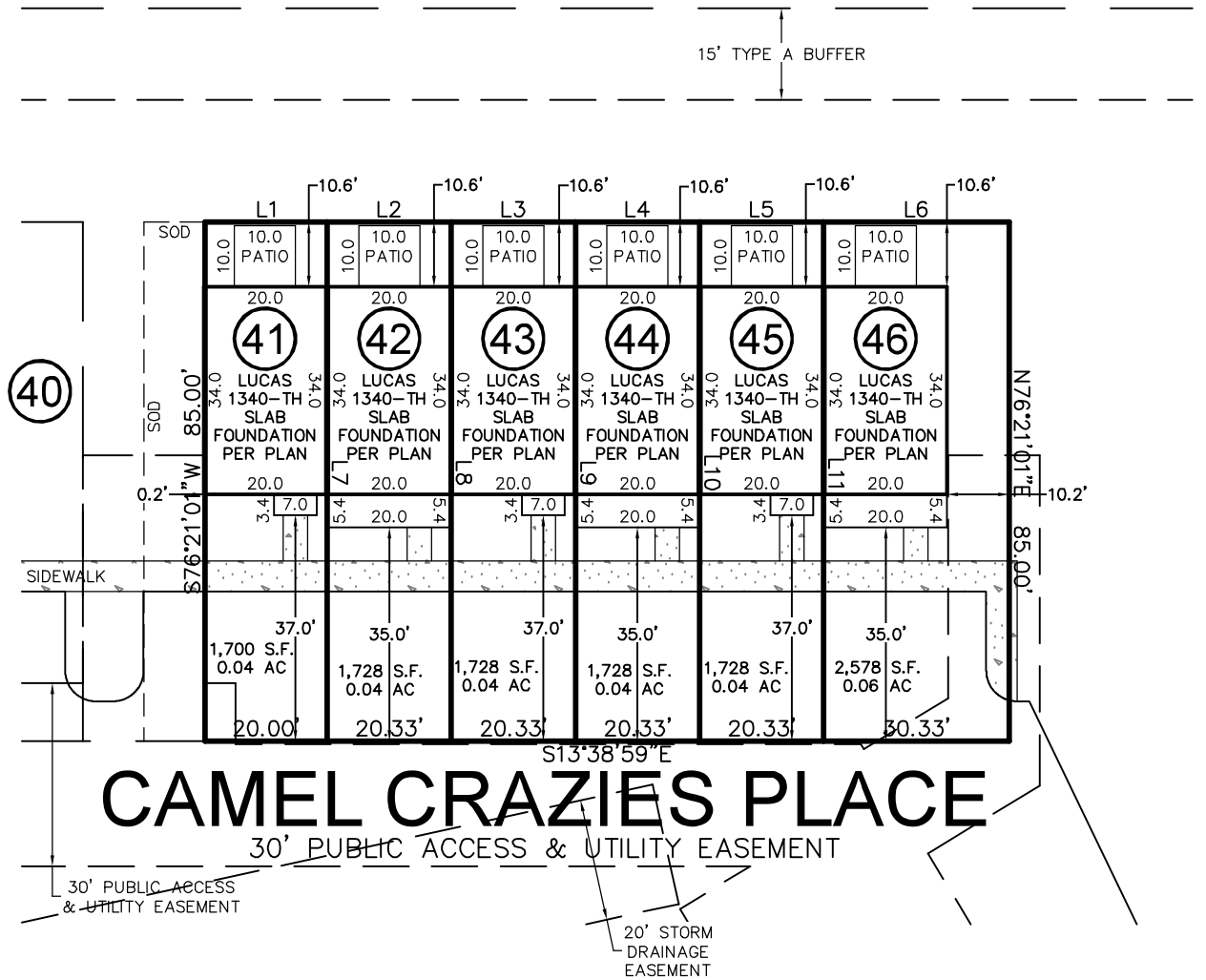

CAMEL CRAZIES PLACE

30' PUBLIC ACCESS & UTILITY EASEMENT

20' STORM DRAINAGE EASEMENT

| LINE | BEARING | DISTANCE |
|------|-------------|----------|
| L1 | N13°38'59"W | 20.00' |
| L2 | N13°38'59"W | 20.33' |
| L3 | N13°38'59"W | 20.33' |
| L4 | N13°38'59"W | 20.33' |
| L5 | N13°38'59"W | 20.33' |
| L6 | N13°38'59"W | 30.33' |
| L7 | S76°21'01"W | 85.00' |
| L8 | S76°21'01"W | 85.00' |
| L9 | S76°21'01"W | 85.00' |
| L10 | S76°21'01"W | 85.00' |
| L11 | S76°21'01"W | 85.00' |

| IMPERVIOUS SURFACE AREA | |
|-------------------------|-------------|
| DESCRIPTION | AREA (S.F.) |
| LOT AREA TO SIDEWALK | 7,862 |
| BUILDING w/PORCHES | 4,534 |
| DRIVE TO R/W @ 4" | 0 |
| DRIVE APRON @ 6" | 0 |
| PATIOS | 600 |
| 4' LEAD WALKS | 156 |
| PUBLIC WALK | 720 |
| TOTAL PROPOSED | 6,010 |
| % IMPERVIOUS AREA | =76.4% |