

**VICINITY MAP**

Not To Scale

SETBACKS: (PB 2023 PG 618)

FRONT - 35'  
 SIDE - 10'  
 REAR - 25'  
 CORNER SIDE - 20'

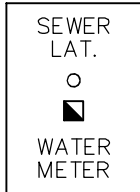
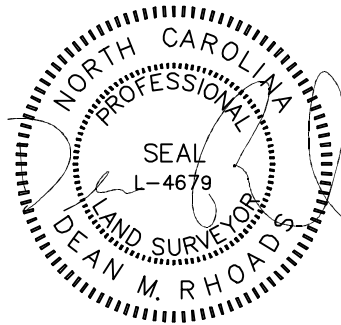
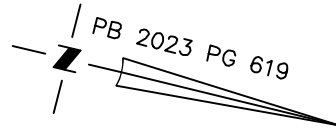

SOD/SEEDING	
TYPE	S.F.
SOD	2,572
SEED & STRAW	0

THIS DRAWING DOES NOT REFLECT AS-BUILT INFORMATION

**PRELIMINARY PLAT**  
 NOT FOR RECORDATION, CONVEYANCES, OR SALES.

THIS PROPERTY MAY BE SUBJECT TO ANY AND ALL APPLICABLE DEED RESTRICTIONS, EASEMENTS, RIGHT-OF-WAY, UTILITIES AND RESTRICTIVE COVENANTS WHICH MAY BE OF RECORD OR IMPLIED

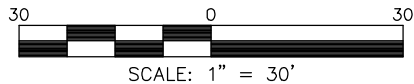

**RESIDENTIAL LAND SERVICES, PLLC.**

1917 Evans Road  
 Cary, North Carolina 27513  
 Phone (919) 378-9316  
 Firm License # P-0873

**HOUSE LOCATION PLOT PLAN**

FOR  
 #132, #128, #124, #120, #116, & #112 CAMEL CRAZIES PLACE  
 LOTS 41-46, BUIES CREEK TOWNHOMES

Neills Creek Township, Harnett County, North Carolina  
 TRUE HOMES

MAP BOOK 2023 PAGE 618-620 DEED REFERENCE \_\_\_\_\_

DRAWN: ADP    SURVEYED: N/A    CHECKED: DMR    DATE: MARCH 7, 2024

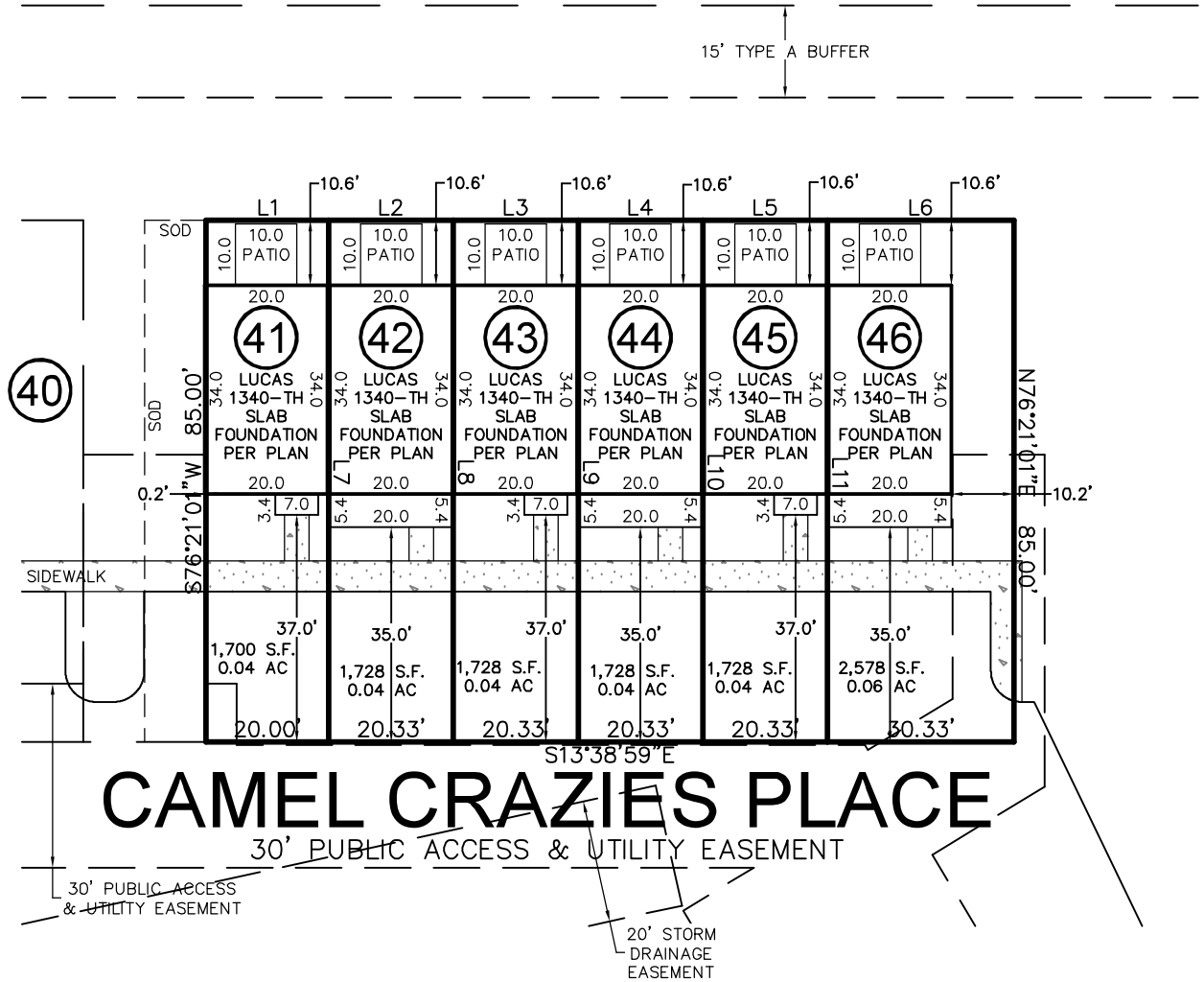

**CAMEL CRAZIES PLACE**

30' PUBLIC ACCESS & UTILITY EASEMENT

20' STORM DRAINAGE EASEMENT

LINE	BEARING	DISTANCE
L1	N13°38'59"W	20.00'
L2	N13°38'59"W	20.33'
L3	N13°38'59"W	20.33'
L4	N13°38'59"W	20.33'
L5	N13°38'59"W	20.33'
L6	N13°38'59"W	30.33'
L7	S76°21'01"W	85.00'
L8	S76°21'01"W	85.00'
L9	S76°21'01"W	85.00'
L10	S76°21'01"W	85.00'
L11	S76°21'01"W	85.00'

IMPERVIOUS SURFACE AREA	
DESCRIPTION	AREA (S.F.)
LOT AREA TO SIDEWALK	7,862
BUILDING w/PORCHES	4,534
DRIVE TO R/W @ 4"	0
DRIVE APRON @ 6"	0
PATIOS	600
4' LEAD WALKS	156
PUBLIC WALK	720
TOTAL PROPOSED	6,010
% IMPERVIOUS AREA	=76.4%