

Legend

- Foundation 
- Pipe Pier 

Reference

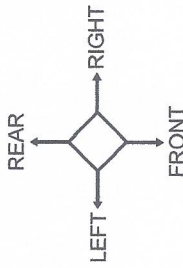

Note

- Footings must be 16"x16"x10", 12" below grade.
- Girder: treated (3) 2"x8" or 6"x2"x1/4" steel tubing
- Concrete must be 3000 PSI.
- Soil bearing capacity must be 2000 PSF.



3-18-24

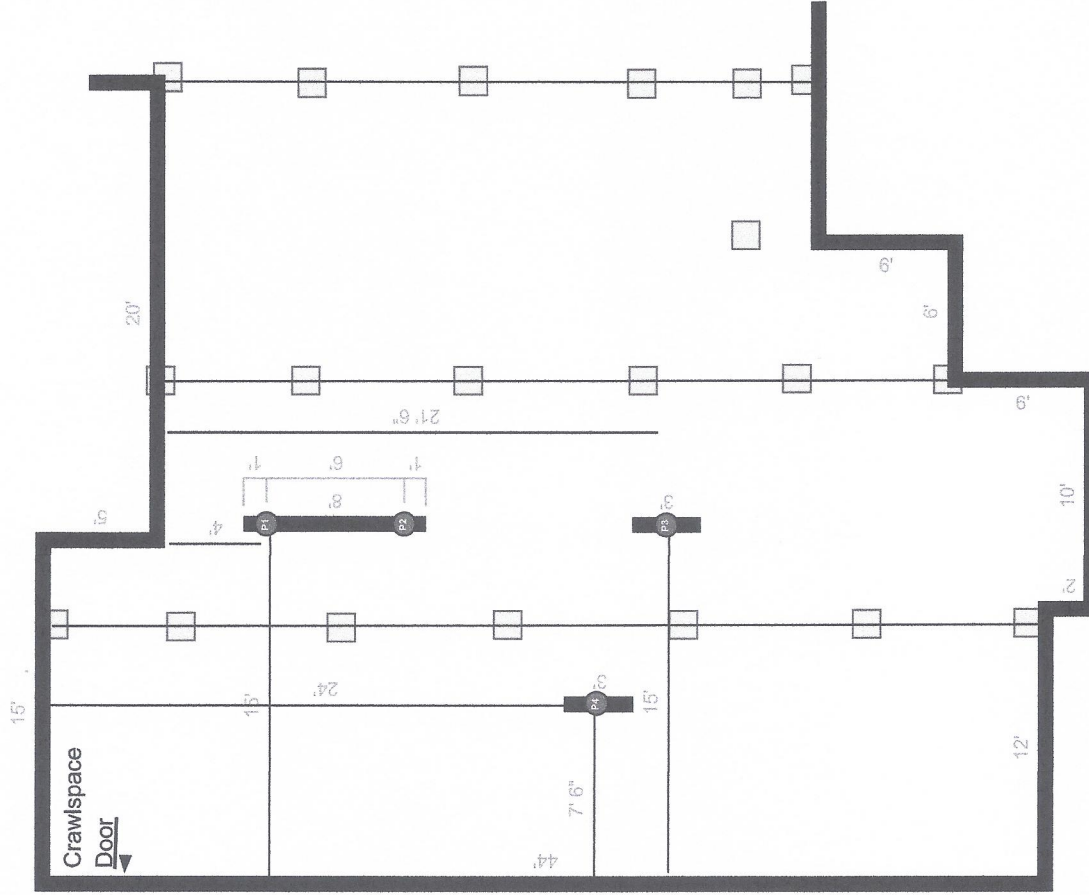

NOTE: ALL LOCATIONS AND DIMENSIONS PROVIDED BY CONTRACTOR

Job Number: GFE-24-076
Ground Force Engineering, PLLC
 4122 Bennett Memorial Rd Suite 300
 Durham, NC 27705

Created By:
 Derek Harwood, PE
 Phone: (984) 484-0495
 Date: 3-18-24

Kimberly Dillow - 50 Shellnut Cir. Spring Lake, NC 28390
Client:
 Foundation Solutions, dba Ram Jack
 4122 Bennett Memorial Rd Suite 304
 Durham, NC 27705