

- NOTES:
1. ALL FINAL MATERIALS ARE TO BE CHOSEN BY HOME OWNER AND / OR BUILDER.
 2. FINAL NUMBER OF EXTERIOR STEPS WILL BE DETERMINED ON SITE BY GRADE
 3. CONTRACTOR MUST MEET OR EXCEED ALL LOCAL BUILDING CODES (NC 2018)
 4. DESIGNER ASSUMES NO RESPONSIBILITY FOR CHANGES TO DRAWINGS BY OTHERS DURING CONSTRUCTION
 5. ALL STRUCTURAL INFO SHOWN ON PLANS ARE FOR REFERENCE PURPOSES ONLY. CONTRACTOR SHALL HAVE STRUCTURAL ENG. REVIEW AND DESIGN ALL STRUCTURAL ELEMENTS

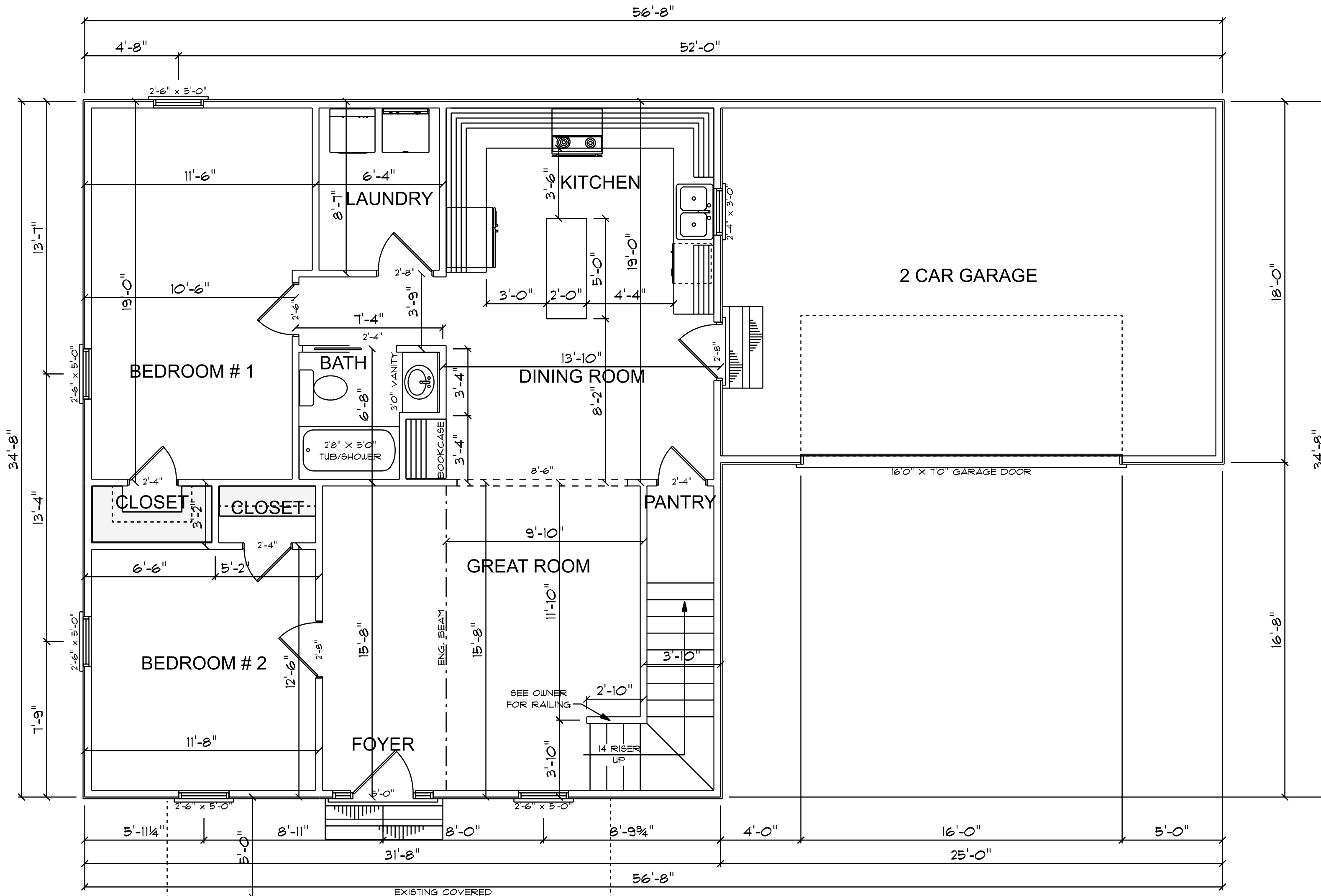

DATE: 11-9-2023
SUBDIVISION:
BUILDER:

**RESIDENCE OF
MS. ASHLEY ADAMO**



8'0" FINISHED CEILING HEIGHT ON FIRST FLOOR
6'8" WINDOW HEADER HEIGHT ON FIRST FLOOR
8'0" FINISHED CEILING HEIGHT ON SECOND FLOOR
6'8" WINDOW HEADER HEIGHT ON SECOND FLOOR

**FIRST FLOOR
NEW CONSTRUCTION**

SCALE: 1/4" = 1'0"

1198 S/F ON FIRST FLOOR
448 S/F ON SECOND FLOOR
1646 S/F TOTAL HEATED AREA

CONTRACTOR TO MATCH EXISTING OVERHANG AND RAKE
CONFIRM ALL MEASUREMENT ON SITE AND ROOF HEIGHTS
SEE HVAC CONTRACTOR FOR UNIT AND SIZE

NOTE:
BUILDING CONTRACTOR TO MEET LOCAL WIND LOADS
PER LOCAL CODE AS IT PERTAINS TO LOCATION OF HOUSE
100, 110, 120, 130, 140, 150, MPH