

NOTES:
 1. ALL FINAL MATERIALS ARE TO BE CHOSEN BY HOME OWNER AND / OR BUILDER.
 2. FINAL NUMBER OF EXTERIOR STEPS WILL BE DETERMINED ON SITE BY GRADE.
 3. CONTRACTOR MUST MEET OR EXCEED ALL LOCAL BUILDING CODES.(NC 2018)
 4. DESIGNER ASSUMES NO RESPONSIBILITY FOR CHANGES TO DRAWINGS BY OTHERS DURING CONSTRUCTION.
 5. ALL STRUCTURAL INFO SHOWN ON PLANS ARE FOR REFERENCE PURPOSES ONLY. CONTRACTOR SHALL HAVE STRUCTURAL ENG. REVIEW AND DESIGN ALL STRUCTURAL ELEMENTS



GCP Designs Group LLC
 Designs You Can Trust

DATE: 11-9-2023

SUBDIVISION:

BUILDER:

**RESIDENCE OF
 MS. ASHLEY ADAMO**

NOTE:
 BUILDING CONTRACTOR TO MEET LOCAL WIND LOADS PER LOCAL CODE AS IT PERTAINS TO LOCATION OF HOUSE
 100, 110, 120, 130, 140, 150, MPH

ELECTRICAL LEGEND		
ELECTRICAL	COUNT	SYMBOL
ceiling fan spotlights 01	3	
can light 6inch	4	
ceiling light 03	3	
ceiling light 17	1	
ceiling teorema	1	
fan	1	
outlet	22	
outlet 220v	2	
outlet gfi	9	
switch	27	
italian sconce 01	2	
vanity bar light 02	1	

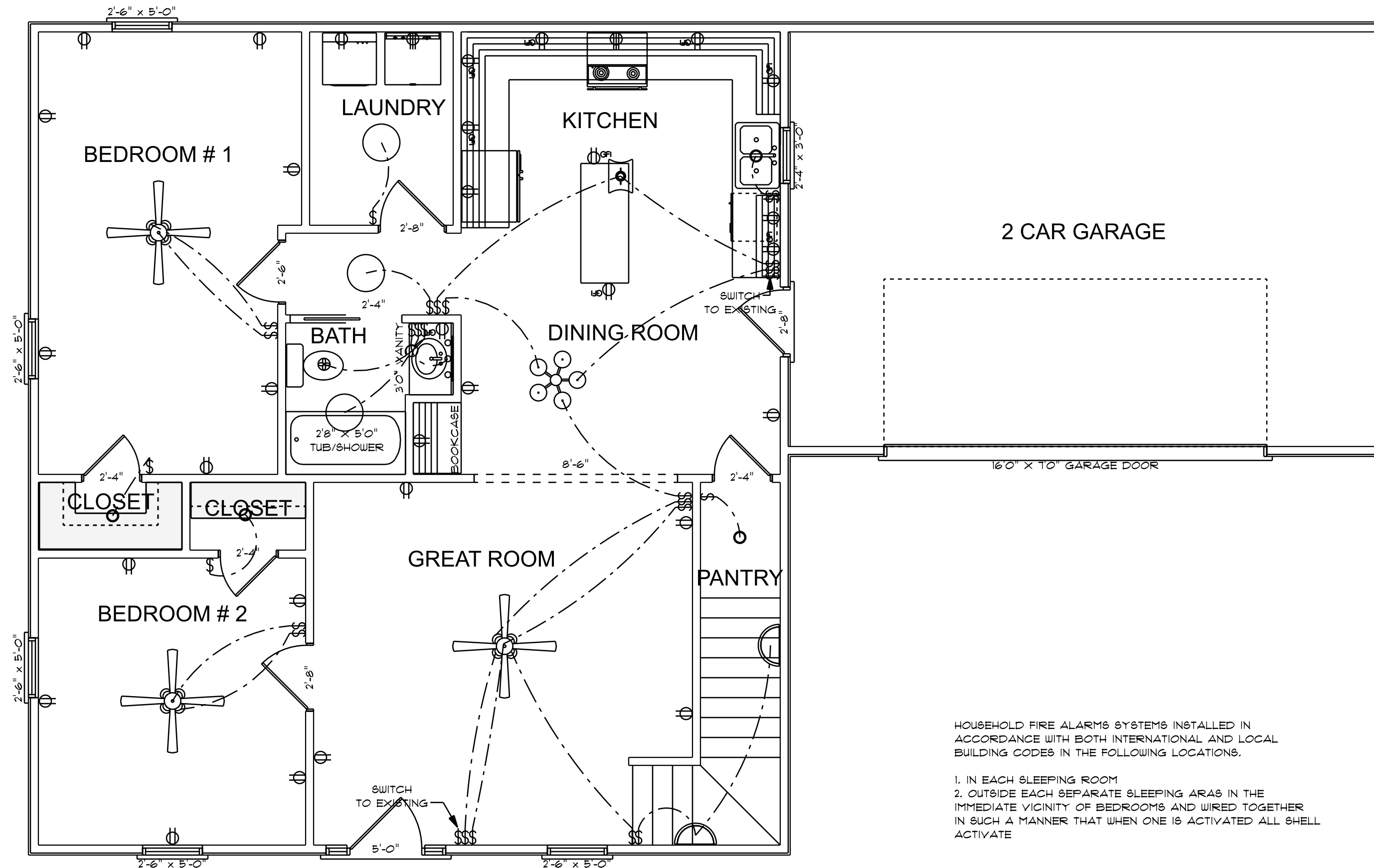

HOUSEHOLD FIRE ALARMS SYSTEMS INSTALLED IN ACCORDANCE WITH BOTH INTERNATIONAL AND LOCAL BUILDING CODES IN THE FOLLOWING LOCATIONS.

1. IN EACH SLEEPING ROOM
2. OUTSIDE EACH SEPARATE SLEEPING AREA IN THE IMMEDIATE VICINITY OF BEDROOMS AND WIRED TOGETHER IN SUCH A MANNER THAT WHEN ONE IS ACTIVATED ALL SHALL ACTIVATE

ELECTRICAL CONTRACTOR TO CONFIRM LOCATION OF OUTLET AND FIXTURES, SEE HOME OWNER FOR TYPE AND STYLE OF ELECTRICAL FIXTURES

CONTRACTOR TO MATCH EXISTING OVERHANG AND RAKE
 CONFIRM ALL MEASUREMENT ON SITE AND ROOF HEIGHTS

**ELECTRICAL PLAN
 FIRST FLOOR
 SCALE: 1/4" = 1'0"**