

I, CALEB TROY CLAYTON SR., CERTIFY THAT THIS PLAT WAS DRAWN UNDER MY SUPERVISION, FROM AN ACTUAL GROUND SURVEY MADE UNDER MY SUPERVISION (DEED & PLAT DESCRIPTION AS SHOWN HEREON); THAT SURVEYED PROPERTY LINES SHOWN HEREON ARE BASED UPON THE DEEDS AND PLATS REPORTED HEREON; THAT THE BOUNDARIES NOT SURVEYED ARE CLEARLY INDICATED AS SUCH AND ARE BASED UPON THE DEEDS AND PLATS REPORTED HEREON; THAT THE RATIO OF PRECISION AS CALCULATED IS 1:10,000+; THAT THIS MAP MEETS THE REQUIREMENTS OF THE STANDARDS OF PRACTICE FOR LAND SURVEYING IN NORTH CAROLINA (21 NCAC 56. 1800). WITNESS MY ORIGINAL SIGNATURE, LICENSE NUMBER AND SEAL THIS 30th DAY OF NOVEMBER, 2023.

*Caleb Troy Clayton Sr.*

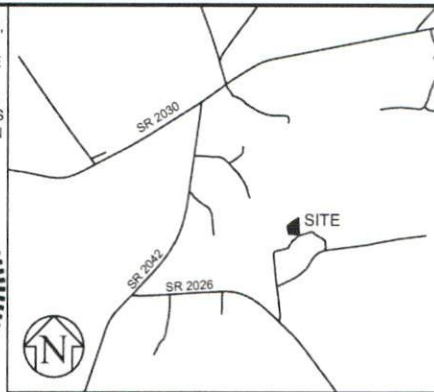

CALEB TROY CLAYTON SR., PLS NC LICENSE NO.: L-5306



VICINITY MAP  
(NOT TO SCALE)

**GENERAL NOTES:**

1. THE PURPOSE OF THIS PLAT IS TO ILLUSTRATE A BOUNDARY SURVEY ON AN EXISTING PARCEL BEARING PIN 0556-24-7198, AND BEING THE PROPERTY OF JORGE CASTRO, HAVING DEED REFERENCES AS SHOWN HEREON, BEING RECORDED IN THE HARNETT COUNTY REGISTRY.
2. THE PROPERTY SHOWN HEREON IS SUBJECT TO ALL EASEMENTS OF RECORD AFFECTING THE SAME. THIS PLAT SHOULD NOT BE RELIED UPON AS A COMPLETE RECORD OF ALL EASEMENTS THAT MAY EFFECT THIS PROPERTY.
3. THIS SURVEYOR DOES NOT CERTIFY TO THE EXISTENCE OR NON-EXISTENCE OF ANY UNDERGROUND UTILITIES THAT MAY OR MAY NOT EXIST WITHIN THE BOUNDARIES AS SHOWN HEREON.
4. NO NCGS MONUMENT FOUND WITHIN 2000 FEET OF THIS PROPERTY.
5. UNIT OF MEASUREMENT IS U.S. SURVEY FEET (FT) UNLESS SPECIFICALLY NOTED AS METERS (M). ALL DISTANCES AND COORDINATES SHOWN HEREON ARE LOCALIZED, GROUND INFORMATION, UNLESS SPECIFICALLY NOTED AS "GRID".
6. THIS PLAT HAS BEEN PREPARED WITHOUT THE BENEFIT OF A TITLE REPORT AND DOES NOT NECESSARILY SHOW ALL ENCUMBRANCES ON THE TITLE.
7. AREA(S) CALCULATED BY THE COORDINATE METHOD.

LEGEND	
	PROPERTY CORNER FOUND
	PROPERTY CORNER SET
	COMPUTED POINT

LEGEND	
	SURVEYED PROPERTY LINE
	PROPERTY LINE NOT SURVEYED
	RIGHT OF WAY LINE



*Caleb Troy Clayton, Sr. PLS*  
*Land Surveying*  
483 McLamb Road, Coats NC 27521  
(910) 985-0301 / ctclandsurveying@gmail.com

**PLOT PLAN**  
PROPERTY OF: JORGE CASTRO  
W H MCLEAN LANE, BUNNLEVEL  
STEWARTS CREEK TOWNSHIP  
HARNETT COUNTY - NORTH CAROLINA

PROJECT: 23033  
DRAWN: CTC Sr  
CHECKED: CTC Sr  
DATE: 11/30/2023