

# Harnett County Department of Public Health

SR, 1442

## Improvement Permit

A building permit cannot be issued with only an Improvement Permit

ISSUED TO: Clayton Homes PROPERTY LOCATION: 910 Parrish Rd SUBDIVISION \_\_\_\_\_ LOT # \_\_\_\_\_

NEW  REPAIR  EXPANSION  Site Improvements required prior to Construction Authorization Issuance: \_\_\_\_\_

Type of Structure: DW 28' x 48'

Proposed Wastewater System Type: 25% Reduction System

Projected Daily Flow: 360 GPD

Number of bedrooms: 3 Number of Occupants: 6 max

Basement  Yes  No

Pump Required:  Yes  No  May be required based on final location and elevations of facilities

Type of Water Supply:  Community  Public  Well Distance from well \_\_\_\_\_ feet

Permit valid for:  Five years  No expiration

Permit conditions: \_\_\_\_\_

Authorized State Agent: James E. Manhart Date: 11-22-23 SEE ATTACHED SITE SKETCH

The issuance of this permit by the Health Department in no way guarantees the issuance of other permits. The permit holder is responsible for checking with appropriate governing bodies in meeting their requirements. This site is subject to revocation if the site plan, plat, or the intended use changes. The Improvement Permit shall not be affected by a change in ownership of the site. This permit is subject to compliance with the provisions of the Laws and Rules for Sewage Treatment and Disposal and to conditions of this permit.

## Construction Authorization

(Required for Building Permit)

The construction and installation requirements of Rules .1950, .1952, .1954, .1955, .1956, .1957, .1958, and .1959 are incorporated by references into this permit and shall be met. Systems shall be installed in accordance with the attached system layout.

ISSUED TO: Clayton Homes PROPERTY LOCATION: 910 Parrish Rd SUBDIVISION \_\_\_\_\_ LOT # \_\_\_\_\_

Facility Type: DW 28' x 48'  New  Expansion  Repair

Basement?  Yes  No Basement Fixtures?  Yes  No

Type of Wastewater System\*\* 25% Reduction System (Initial) Wastewater Flow: 360 GPD

(See note below, if applicable  50% Reduction System (Repair))

**Installation Requirements/Conditions**

Septic Tank Size 1,000 gallons Exact length of each trench 100 feet Trench Spacing: 9 Feet on Center

Pump Tank Size \_\_\_\_\_ gallons Trenches shall be installed on contour at a Soil Cover: \_\_\_\_\_ inches

Maximum Trench Depth of: 18" inches (Maximum soil cover shall not exceed 36" above the trench bottom)

(Trench bottoms shall be level to +/-1/4" in all directions)

Pump Requirements: \_\_\_\_\_ ft. TDH vs. \_\_\_\_\_ GPM \_\_\_\_\_ inches below pipe

Aggregate Depth: \_\_\_\_\_ inches above pipe

Conditions: Repair Area may allow for a 25% Reduction System if water line is placed as on site sketch on right side of Drive way \_\_\_\_\_ inches total

**WATER LINES (INCLUDING IRRIGATION) MUST BE 10FT. FROM ANY PART OF SEPTIC SYSTEM OR REPAIR AREA. NO UTILITIES ALLOWED IN INITIAL OR REPAIR DRAIN FIELD AREA.**

\*\*If applicable: I understand the system type specified is different from the type specified on the application. I accept the specifications of this permit.

Owner/Legal Representative Signature: \_\_\_\_\_ Date: \_\_\_\_\_

This Construction Authorization is subject to revocation if the site plan, plat, or the intended use changes. The Construction Authorization shall not be transferred when there is a change in ownership of the site. This Construction Authorization is subject to compliance with the provisions of the Laws and Rules for Sewage Treatment and Disposal and to the conditions of this permit. SEE ATTACHED SITE SKETCH

Authorized State Agent: James E. Manhart Date: 11-22-23

Construction Authorization Expiration Date: 11-22-28

Application # Bres 2310-0037

Harnett County Department of Public Health  
Site Sketch

Property Location: 910 Parrish Rd, Fuquay, 27526 SR, 1442

Issued To: Clayton Homes Subdivision \_\_\_\_\_ Lot # \_\_\_\_\_

Authorized State Agent: James E. Marshall JPA REHS Date: 11-22-23

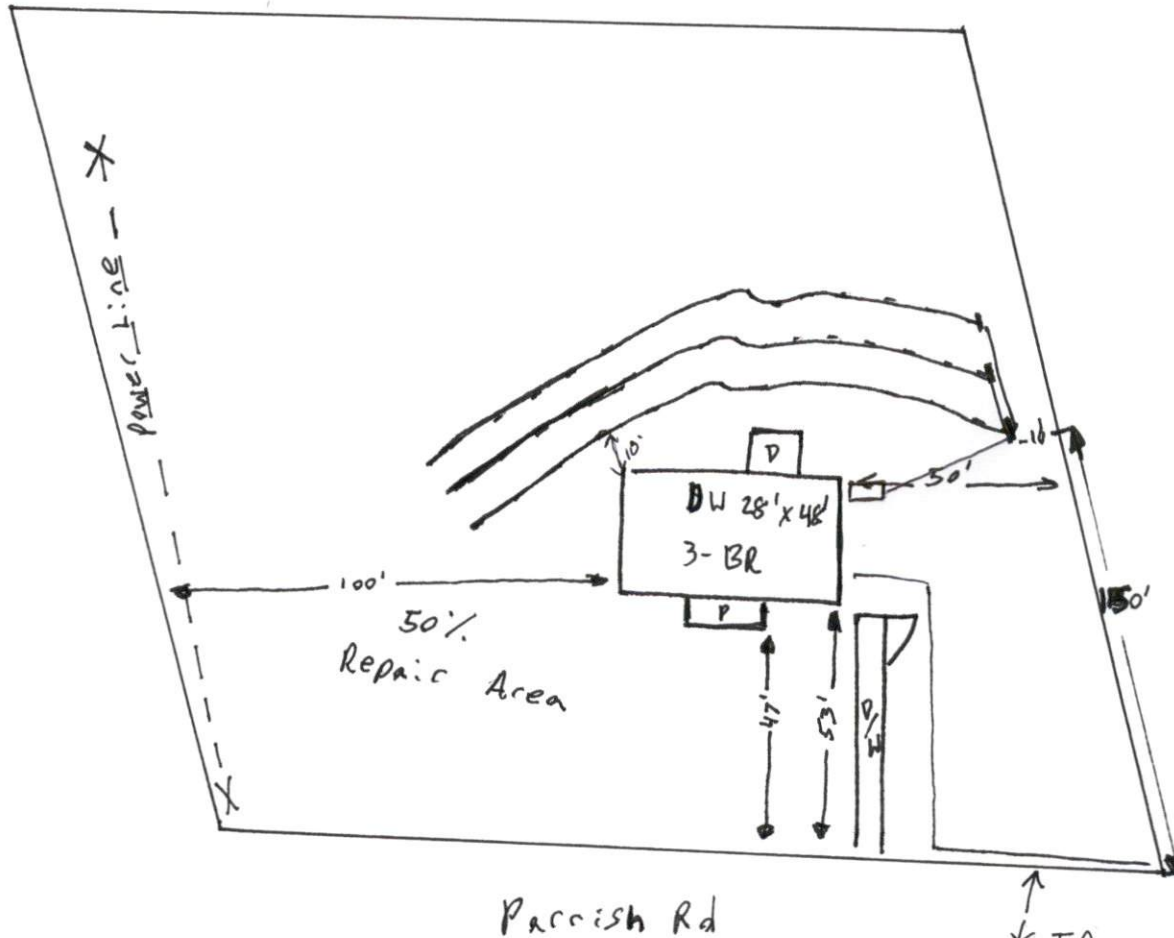

\* If Water meter is Placed on right side of Drive way then Repair May be 25% Reduction.

This drawing is for illustrative purposes only. System installation must meet all pertinent laws, rules, and regulations.