

NOTES:

This property does not appear to be located within 2000 feet of N. C. Grid Monumentation.

All measurements shown are horizontal ground measurements unless otherwise noted.

Area calculated by computer.

Set #4 rebar at all corners unless otherwise indicated.

Adjoining References are From the County GIS Office and other sources and May Not Have Been Verified by this Office.

"*" Denotes Control Corner.

ZONED: RA-20M

MINIMUM SETBACK REQUIREMENT

Front -----35'
Side-----10'
Rear-----25'

LINE	BEARING	DISTANCE
L1	N 16°17'28" W	139.52'
L2	S 21°50'09" W	264.62'
L3	S 21°50'09" W	25.44'
L4	S 21°50'09" W	34.95'

State of North Carolina
County of Harnett

Kelli H. D'Arcy Review Officer of Harnett County, certify that the map or plat to which this certification is affixed meets all statutory requirements for recording.

11-19-09 Date Kelli H. D'Arcy Review Officer

NORTH CAROLINA
HARNETT COUNTY

This Map/Plat was presented for registration and recorded in this office at Map Number 2009-796 This 19th day of November 2009 at 1:12 o'clock P. M.

KIMBERLY S. HARGROVE Register of Deeds
By: Judi S. Wester Asst./Deputy Register of Deeds

LEGEND:

- FIP..... Found Iron Pipe
- SIP..... Set Iron Pipe
- FCM..... Found Concrete Monument
- FPK..... Found P.K. Nail
- PKS..... Set P.K. Nail
- FRB..... Found Rebar
- SRB..... Set Rebar
- R/W..... Right of Way
- CL..... Centerline
- CP..... Computed Point
- FRRS..... Found Railroad Spike
- SRRS..... Set Railroad Spike
- AXF..... Found Axle
- FLK..... Found Lightwood Knot

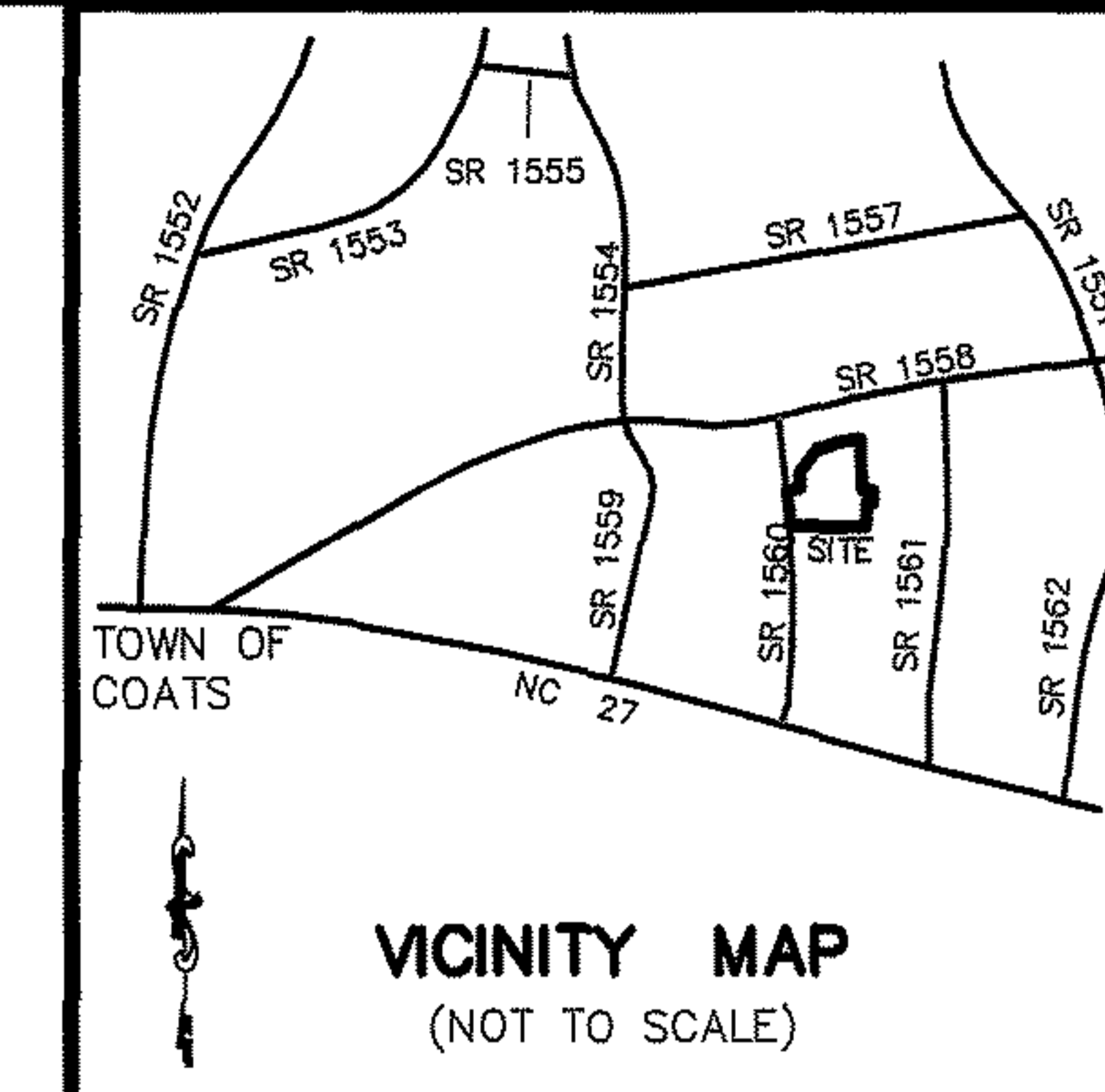

NOTE: Lots 2 & 3, 4 & 5 and 6 & 7 Share a 20' x 20' Joint Driveway.

DEPARTMENT OF TRANSPORTATION
DIVISION OF HIGHWAYS
NO APPROVAL NECESSARY
L.R. HINES DISTRICT ENGINEER
11/2/09 DATE

TOTAL ACREAGE
45.15 ACRES TOTAL
1.77 ACRES in R/W
43.38 ACRES NET

45.15 ACRES TOTAL
1.77 ACRES in R/W
43.38 ACRES NET

BOBBY L. MCLEOD
Deed Book 1348, Page 80
Plat Cabinet F, Slide 109-A

KENNETH ELMOND JOHNSON
and Others
Deed Book 1269, Page 15
Plat Cabinet F, Slide 109-A

I hereby certify that the development depicted hereon has been granted final approval from Harnett County E-911 Addressing, Environmental Health, Planning, Public Utilities, and the North Carolina Department of Transportation. This plat is subject to any and all conditions stated below and is eligible for recording in the Harnett County Register of Deeds within thirty days of the date below.

E-911 Addressing: _____
Public Utilities: _____
NCDOT: _____
Jessie P. Byrd 11-19-09
Subdivision Administration Date
Reviewed by Landon Chandler

NOTE: 6" Harnett County Water Line on the West Side of NCSR 1560 "Festus Road".

MINOR SUBDIVISION FOR:

MARIE P. BASS

314 W. Church St., Benson NC 27504

GROVE TWP., HARNETT CO., N.C.

SURVEY BY: JOYNER PIEDMONT SURVEYING

P.O. Box 115 105 East Cumberland Street
Dunn, NC 28334 Phone (910) 892-2511

OCTOBER 12, 2009

GRAPHIC SCALE

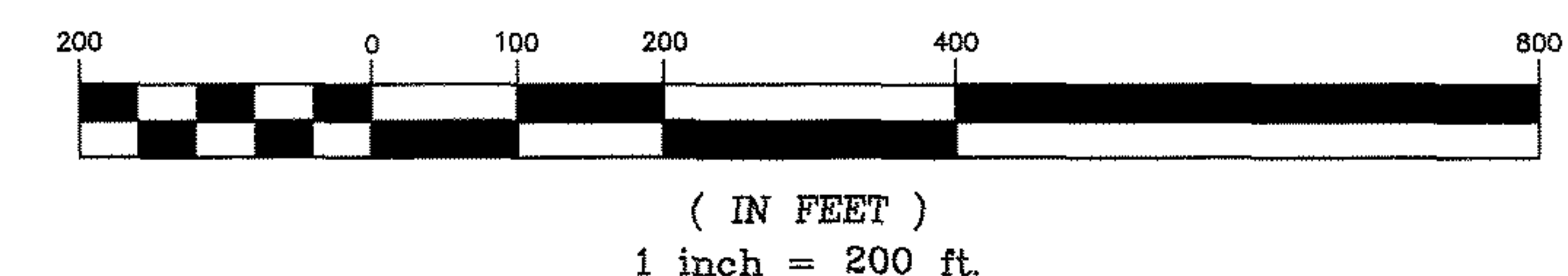

Parcel ID: 071610 0060 01 NCPIN: 1610-19-6291.000

This is to certify that I have consulted the Federal Insurance Administration Flood Hazard Boundary Maps and found that the above property described is NOT located in a special flood hazard area.

Andrew H. Joyner
ANDREW H. JOYNER
PROFESSIONAL LAND SURVEYOR NO. 2469

NORTH CAROLINA
HARNETT COUNTY

I, Andrew H. Joyner, a Professional Land Surveyor, certify that this plat was drawn under my supervision from (an actual survey made under my supervision) (deed description recorded in Book 2295, Page 511, etc.), (other), that the ratio of precision as calculated by latitude and departures is 1/10000+, that the boundaries not surveyed are shown as broken lines plotted from information found in Book 2295 Page 511 that this plat was prepared in accordance with G.S. 47-30 as amended. Witness my original signature, registration number, and seal this 12th day of Oct, A.D., 2009.

Surveyor
L-2469
Registration Number

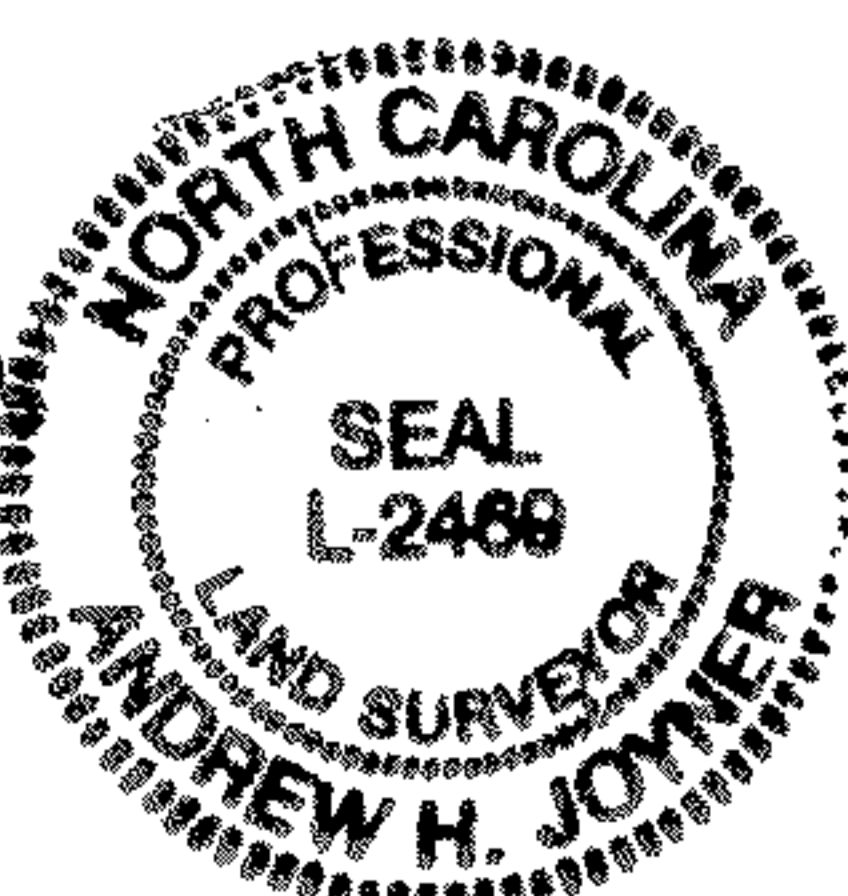

I hereby certify that I am the owner of the property shown and described hereon, which is located in the subdivision jurisdiction of Harnett County, North Carolina and that I hereby adopt this plan of subdivision with my free consent and establish minimum setback lines as noted. I further certify that I have not been involved as an owner, leaser, option holder or had any equitable interest in any subdivision adjacent to or located directly across a street, easement or road right-of-way from the property shown and described hereon, within the previous three years.

10-16-09
Date

Marie P. Bass
Owners



FOR REGISTRATION REGISTER OF DEEDS
KIMBERLY S. HARGROVE
HARNETT COUNTY, NC
2009 NOV 19 01:12:20 PM
BK: 2009 PG: 796-797 FEE: \$21.00

INSTRUMENT # 2009017680

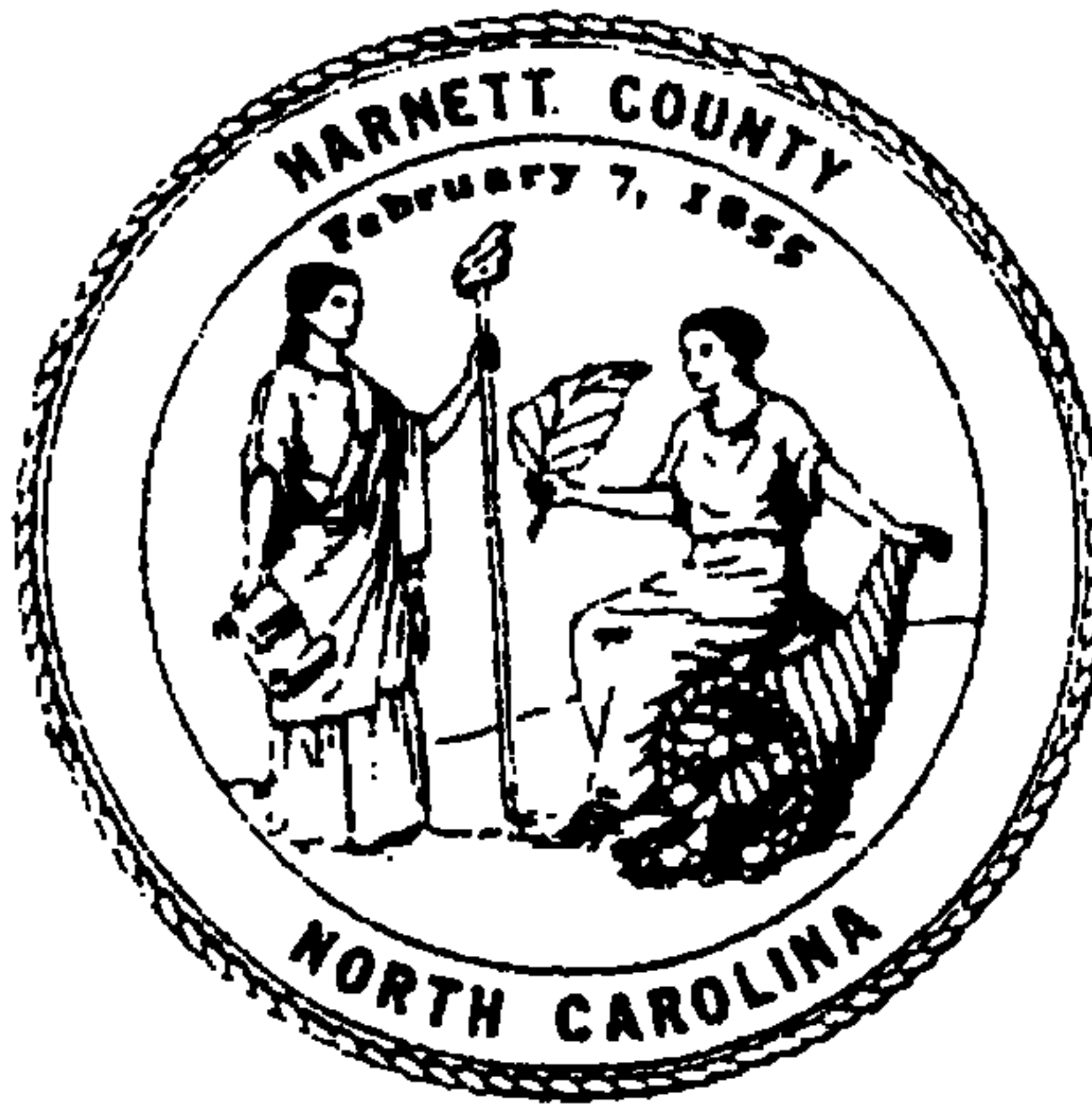

KIMBERLY S. HARGROVE
REGISTER OF DEEDS, HARNETT
305 W CORNELIUS HARNETT BLVD
SUITE 200
LILLINGTON, NC 27546

Filed For Registration: 11/19/2009 01:12:20 PM
Book: PLAT 2009 Page: 796-797
Document No.: 2009017680
MAP 2 PGS \$21.00
Recorder: TRUDI S WESTER

State of North Carolina, County of Harnett

KIMBERLY S. HARGROVE , REGISTER OF DEEDS

DO NOT DISCARD

2009017680

2009017680