



**Scope of Work for:
405 N 14th St
Erwin NC 28339**

The following will be performed as Crawl Space Closed Encapsulation:

*2" Spray Foam R-19 Insulation on walls of crawlspace

*20 ml Vapor Barrier installed wall to wall with 100% floor coverage. All sections of liner will be overlapped a minimum of 1' and will be seamed together, attached with Christmas Tree fasteners, and caulked.

*All Vents will be sealed from inside the crawl space with R-10 Rigid 2" Foam Sheathing.

*Wrap all existing CMU/Brick Piers 20 ml Vapor Barrier. Contractor will leave a termite inspection gap at the top of each pier. The liner will be fastened to the pier and the top edge of the liner will be sealed with caulking.

*R-19 Insulation installed in the rim joist cavities

*Electrical - Installation of new dedicated 120vac/20amp electrical circuit/s and electrical outlet/s (WP-GFCI) to supply sump pump and /or dehumidifier in crawl space (basement).

Davis Dunlap Electrical LLC
210 Timberland Dr
Angier NC 27501
919-669-0768
david@dunlapelectric.com
License #27056-L

*AprilAire E100 Dehumidifier install - specifications on page 2

TARHEEL™

BASEMENT SYSTEMS

A Groundworks Company

SPECIFICATIONS		
Capacity		
	@ 80°F/60% RH	100 ppd
	@ 73°F/60% RH	85 ppd
Energy Factor		
	@ 80°F/60% RH	2.6 L/kW-h
	@ 73°F/60% RH	2.35 L/kW-h
Airflow @ varying E.S.P. (external static pressure - dry coil)		
	0.0" w.c.	280 CFM
	0.2" w.c.	245 CFM
	0.4" w.c.	210 CFM
Voltage, phase, frequency		120VAC, 1 phase, 60 Hz
Current draw⁽¹⁾		6.9 Amps
Noise		55 dBA ducted
Dimensions: (cabinet only)⁽²⁾		Width: 14" Height: 15" Length: 26"
Unit Weight		64 lbs.
Shipping Weight		82 lbs.
Inlet air operating conditions during		
-Dehumidification:	50°F-104°F, 40°F dew point min.	
-Ventilation:	40°F-140°F, 0%-99% RH (non-condensing)	
<small>⁽¹⁾Rated capacity, energy factor and current draw measured at 80°F/60% RH inlet air at 0.0 ESP.</small>		
<small>⁽²⁾Height does not include adjustable feet. The width excludes the filter doors and length excludes the duct collars.</small>		

Back



all 3 doors are being replaced

Drip line

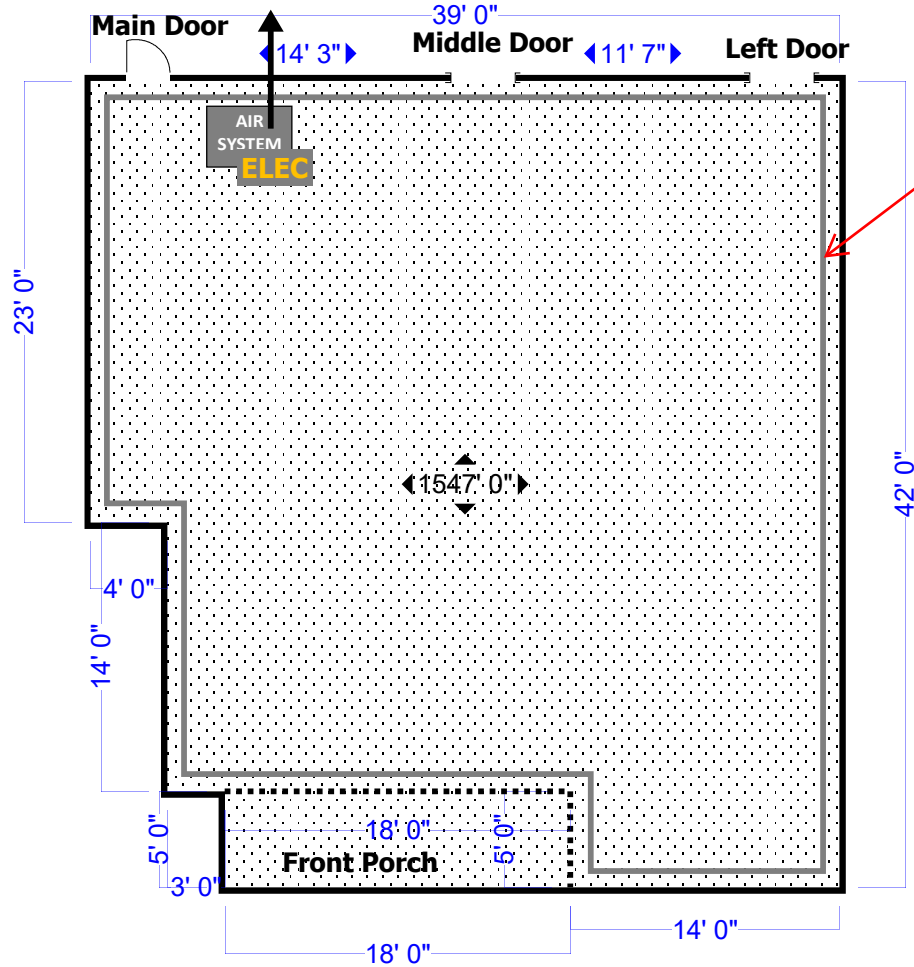

Maintain 3 inch termite inspection gap between foam/top of block wall

- = False Wall/Block Porch from Crawlspace
- = Spray Foam Walls/Block All Vents
- AIR SYSTEM** = AprilAire E100 Dehumidifier
- ELEC** = New Electric Outlet
- = 20 Mil Vapor/Wrap all Columns

Site:	Customer Address: 405 N 14th St Erwin NC, 28339	Drawing:	801506	Project:	0000416	Drawn:	Matthew Kernich	Notes:	Groundworks 1741 Corp Landing Virginia Beach, VA 23454
Title:	Customer Name : Christine Sumes	Scale:	1/8" : 1' 0"	Date:	01/30/2017	Rev:	A		