

JAMES DEAN  
 WORK SHOP  
 29 BLUEGRASS CT  
 ANGLIER

4 FOOTINGS 24" x 24" x 12"  
 POURED WITH FLOOR FOR  
 6" x 6" POST WITH SIMPSON  
 STRONG TIE CPT 662

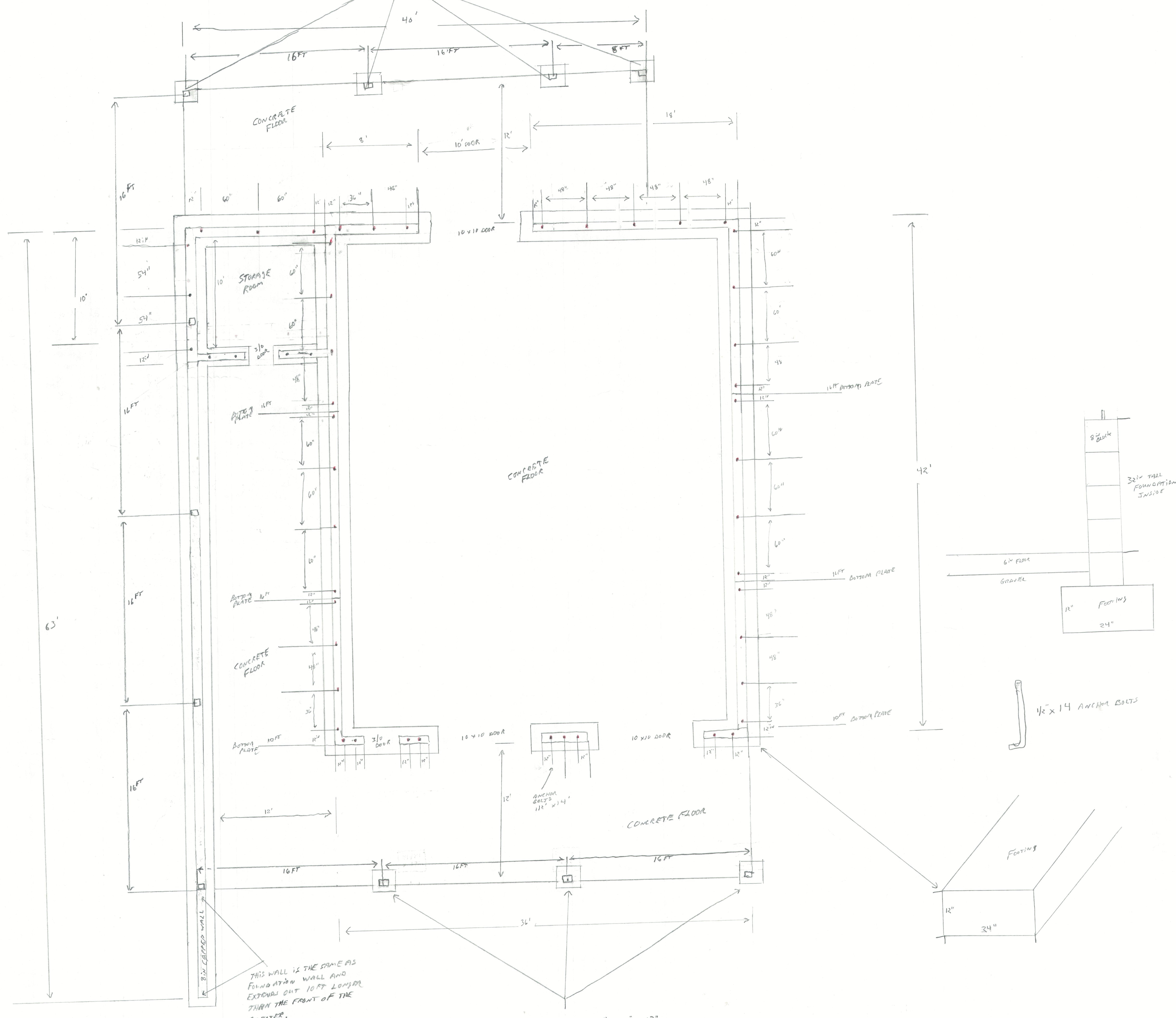

THIS WALL IS THE SAME AS  
 FOUNDATION WALL AND  
 EXTENDS OUT 10 FT LONGER  
 THAN THE FRONT OF THE  
 SHELTER.

3 FOOTINGS 24" x 24" x 12"  
 POURED WITH FLOOR TO PLACE  
 6" x 6" TREATED POST TO SUPPORT  
 SHELTER. ATTACH POST WITH  
 SIMPSON STRONG TIE CPT 662