

SOIL/SITE EVALUATION
for ON-SITE WASTEWATER SYSTEM

Owner: *Sandhills Real Estate*
 Applicant:

Address: *37 Patton Ln*
 Proposed Facility: *SWMH*

Date Evaluated: *9-18-23*
 Design Flow (.1949): *360 GPD*

Property Size:

Location of Site: Property Recorded:
 Water Supply: Public Individual Well Spring Other
 Evaluation Method: Auger Boring Pit Cut
 Type of Wastewater: Sewage Industrial Process Mixed

P R O F I L E #	.1940 Landscape Position/ Slope %	Horizon Depth (In.)	SOIL MORPHOLOGY .1941		OTHER PROFILE FACTORS				Profile Class & LTAR
			.1941 Structure/ Texture	.1941 Consistence Mineralogy	.1942 Soil Wetness/ Color	.1943 Soil Depth (IN.)	.1956 Sapro Class	.1944 Restr Horiz	
1	L	0-26	LS	Fr/usp/ncp	>48"	>48"	—	—	S-7 Group II
	2-5%	26-48	SL	Fr/usp/ncp					
2	L	0-40	LS	Fr/usp/ncp	>48"	>48"	—	—	S-7 Group II
	2-5%	40-48	SL	Fr/usp/ncp					
3	L	0-26	LS	Fr/usp/ncp	>48"	>48"	—	—	S-7 Group II
	2-5%	26-48	SL	Fr/usp/ncp					

Description	Initial System	Repair System	Other Factors (.1946): Site Classification (.1948): <i>S</i> Evaluated By: <i>M. D. REH</i> Others Present: <i>A. T.</i>
Available Space (.1945)	<i>✓</i>	<i>✓</i>	
System Type(s)	<i>✓</i>	<i>✓</i>	
Site LTAR	<i>.7</i>	<i>.7</i>	

COMMENTS: _____

LANDSCAPE POSITIONS	GROUP	TEXTURES	.1955 LTAR	CONSISTENCE MOIST	WET
R-RIDGE	I	S-SAND	1.2 - 0.8	VFR-VERY FRIABLE	NS-NON-STICKY
S-SHOULDER SLOPE		LS-LOAMY SAND		FR-FRIABLE	SS-SLIGHTLY STICKY
L-LINEAR SLOPE	II	SL-SANDY LOAM	0.8 - 0.6	FI-FIRM	S-STICKY
FS-FOOT SLOPE		L-LOAM		VFI-VERY FIRM	VS-VERY STICKY
N-NOSE SLOPE	III	SI-SILT	0.6 - 0.3	EFI-EXTREMELY FIRM	NP-NON-PLASTIC
H-HEAD SLOPE		SIL-SILT LOAM			SP-SLIGHTLY STICKY
CC-CONCLAVE SLOPE	IV	CL-CLAY LOAM	0.4 - 0.1		P-PLASTIC
CV-CONVEX SLOPE		SCL-SANDY CLAY LOAM			VP-VERY PLASTIC
T-TERRACE		SIC-SILTY CLAY			
FP-FLOOD PLAN		C-CLAY			
		SC-SANDY CLAY			

STRUCTURE
 SG-SINGLE GRAIN
 M- MASSIVE
 CR-CRUMB
 GR-GRANULAR
 SBK-SUBANGULAR BLOCKY
 ABK-ANGULAR BLOCKY
 PL-PLATY
 PR-PRISMATIC

MINERALOGY
 SLIGHTLY EXPANSIVE
 EXPANSIVE

Show profile locations and other site features (dimensions, references or benchmark, and North)

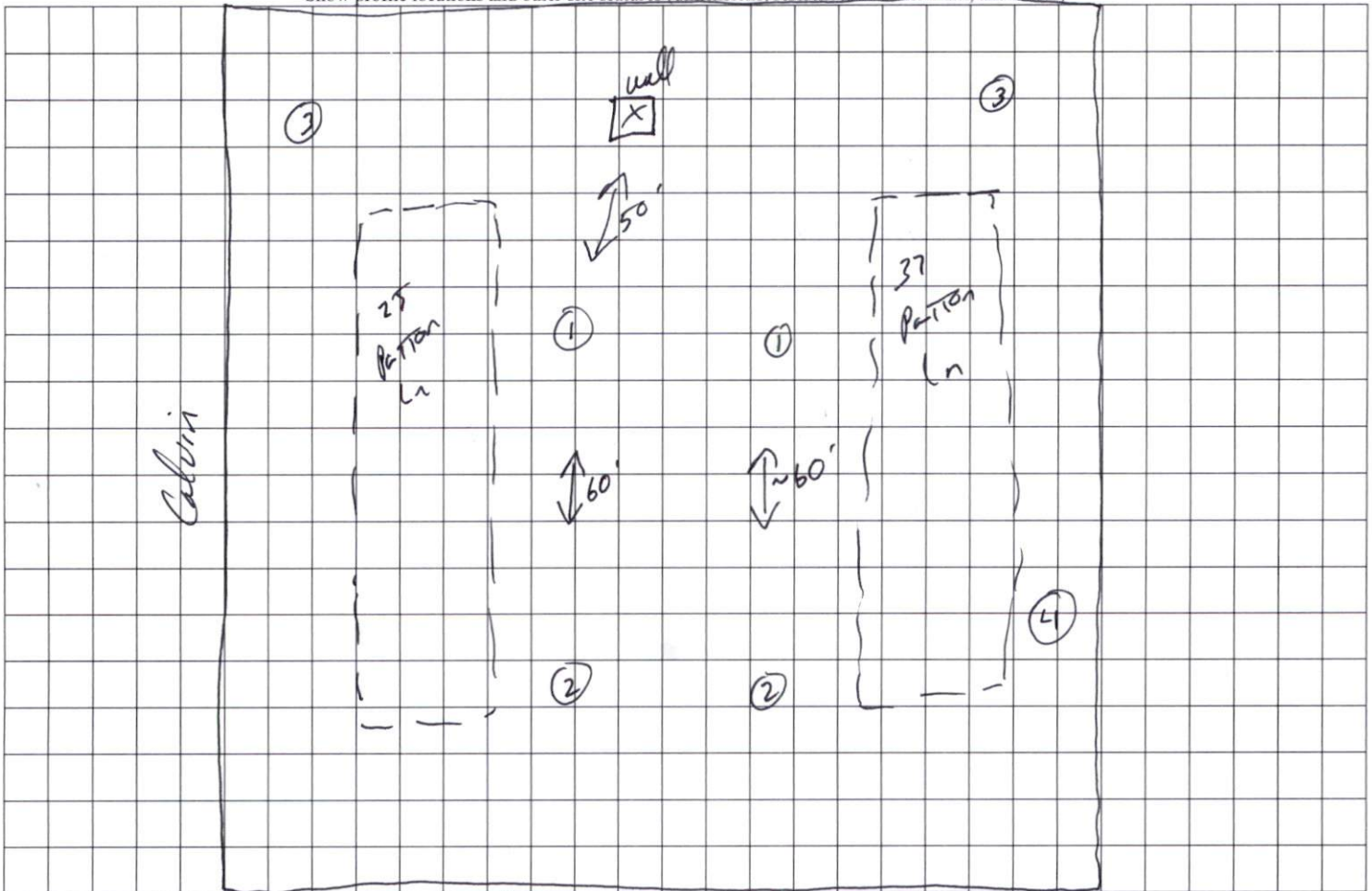

Patton