

THE INFORMATION CONTAINED IN THIS DRAWING IS THE SOLE PROPERTY OF VERSATUBE BUILDING SYSTEMS ANY REPRODUCTION IN PART OR WHOLE WITHOUT THE WRITTEN PERMISSION OF VERSATUBE BUILDING SYSTEMS IS PROHIBITED.
 NOTE TO BUILDING DEPARTMENT OFFICIAL: THESE DRAWINGS AND/OR CALCULATIONS ARE VALID ONLY FOR STRUCTURES MANUFACTURED BY VERSATUBE BUILDING SYSTEMS. VERIFICATION IS RECOMMENDED PRIOR TO BUILDING APPROVAL.
 © VERSATUBE BUILDING SYSTEMS 2023

FRANK CASTANEDA
 284 PERRY RD
 SANFORD, NC 27332
 24' X 30'-2" X 12'

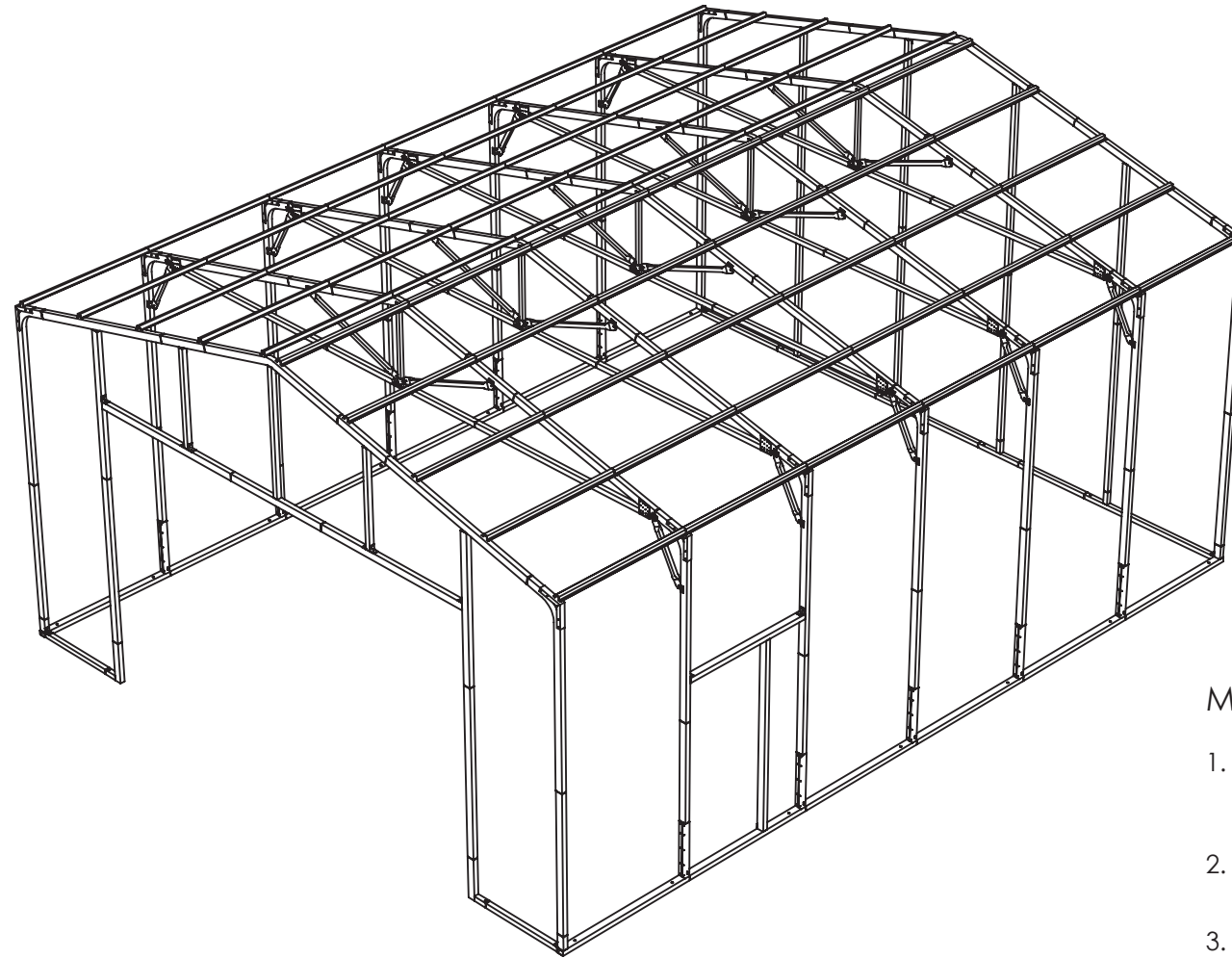
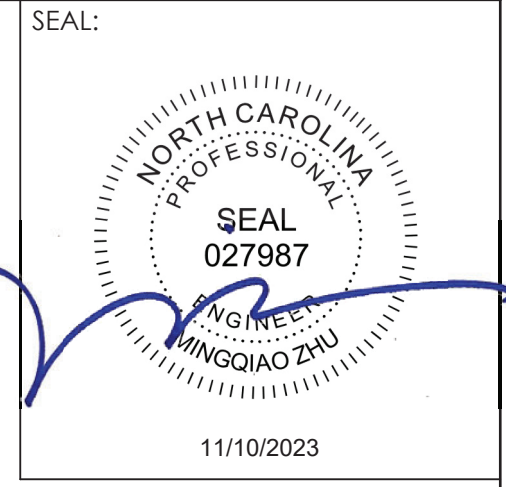

DRAWING INDEX:

1. COVER PAGE
2. ELEVATIONS
3. FRONT GABLE DETAILS
4. ROOF WALL SECTION DETAILS
5. BACK GABLE DETAILS
6. SHEET METAL INSTALL DETAILS
7. BASE RAIL LAYOUT DETAILS
8. FOUNDATION DETAILS

DESIGN CRITERIA:

CODE COMPLIANCE: 2018 IBC
 OCCUPANCY GROUP: U-1
 3:12 PITCH

1. DEAD LOAD: 2 PSF
2. ROOF LIVE LOAD: 20 PSF
 GROUND SNOW LOAD: 15 PSF
3. WIND LOAD: 120 MPH, EXPOSURE (C)
 STRUCTURAL RISK CATEGORY: II
4. SEISMIC CATEGORY: C
5. ON CENTER FRAME SPACING: 5'
 ROOF HAT CHANNEL SPACING: 2'-11 3/8"
6. SHEET METAL: 29GA MULTIPURPOSE, 80KSI, STEEL
 ALLOWABLE WIND PRESSURE LOAD ON 5' CENTERS: 23 PSF
 ALLOWABLE GRAVITY LOAD ON 2'-11 3/8" CENTERS: 57.13 PSF
 PANELS ARE CLASS (A) FIRE RATED. EXTERIOR SHEETING NOT SHOWN.

EXISTING SLAB DESIGNED BY OTHERS

MATERIALS:

1. SIDE POSTS, RAFTERS, PEAKS, DOOR HEADERS, DOOR JAMBS,
 BASE RAILS, HEIGHT EXTENSIONS:
 2" X 3" 14 GA 1015 STEEL, 50 KSI
2. END WALL VERTICALS & BASE RAILS, COLLAR TIE:
 2" X 2" 15 GA 1015 STEEL, 50 KSI
3. WEB BRACES, KNEE BRACES:
 1 1/2" X 1 1/2" 18 GA 1008 STEEL, 45 KSI
4. HAT CHANNEL (ROOF PURLINS):
 18 GA, 1010 STEEL, 50 KSI
5. BRACKETS:
 BK-30, BK-60, BK-61: 14GA, 50 KSI STEEL
 BK-10, BK-20, BK-WEB-1.5SQ: 12GA, 50 KSI STEEL
 BK-BPR-24: 16GA, 50 KSI STEEL
 BK-40: 18GA, 50 KSI STEEL

STRUCTURAL DESIGN		PROJECT: VERSATUBE FRONTIER BUILDING	
T & Z Consulting Services, LLC 1428 N Shevlin Court Sewickley, PA 15143		TITLE: 24' X 30'-2" X 12' ENCLOSED	
		DWG NO: FBSQ24301205-KB24-R+FE02412116X10+BE02412-4V	DRAWN BY: A. STRICKER
		DATE: 10/5/2023	PAGE 1 OF 8

THE INFORMATION CONTAINED IN THIS DRAWING IS THE SOLE PROPERTY OF VERSATUBE BUILDING SYSTEMS ANY REPRODUCTION IN PART OR WHOLE WITHOUT THE WRITTEN PERMISSION OF VERSATUBE BUILDING SYSTEMS IS PROHIBITED.
 NOTE TO BUILDING DEPARTMENT OFFICIAL: THESE DRAWINGS AND/OR CALCULATIONS ARE VALID ONLY FOR STRUCTURES MANUFACTURED BY VERSATUBE BUILDING SYSTEMS. VERIFICATION IS RECOMMENDED PRIOR TO BUILDING APPROVAL.
 © VERSATUBE BUILDING SYSTEMS 2023

FRANK CASTANEDA
 284 PERRY RD
 SANFORD, NC 27332
 24' X 30'-2" X 12'

SEAL:



11/10/2023

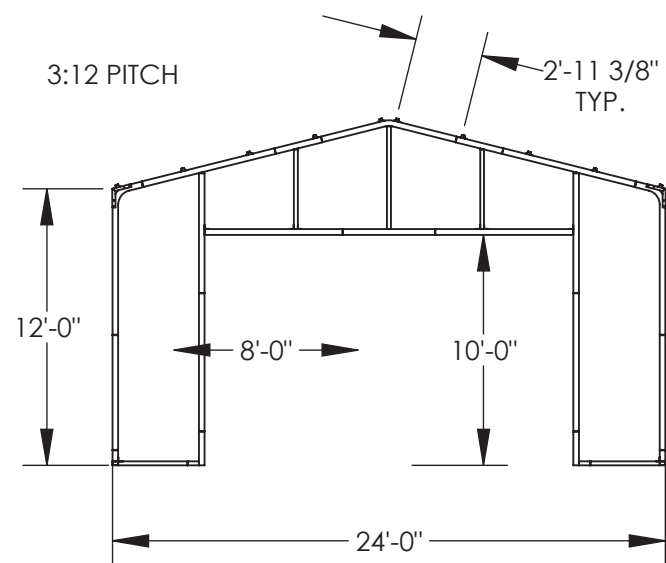
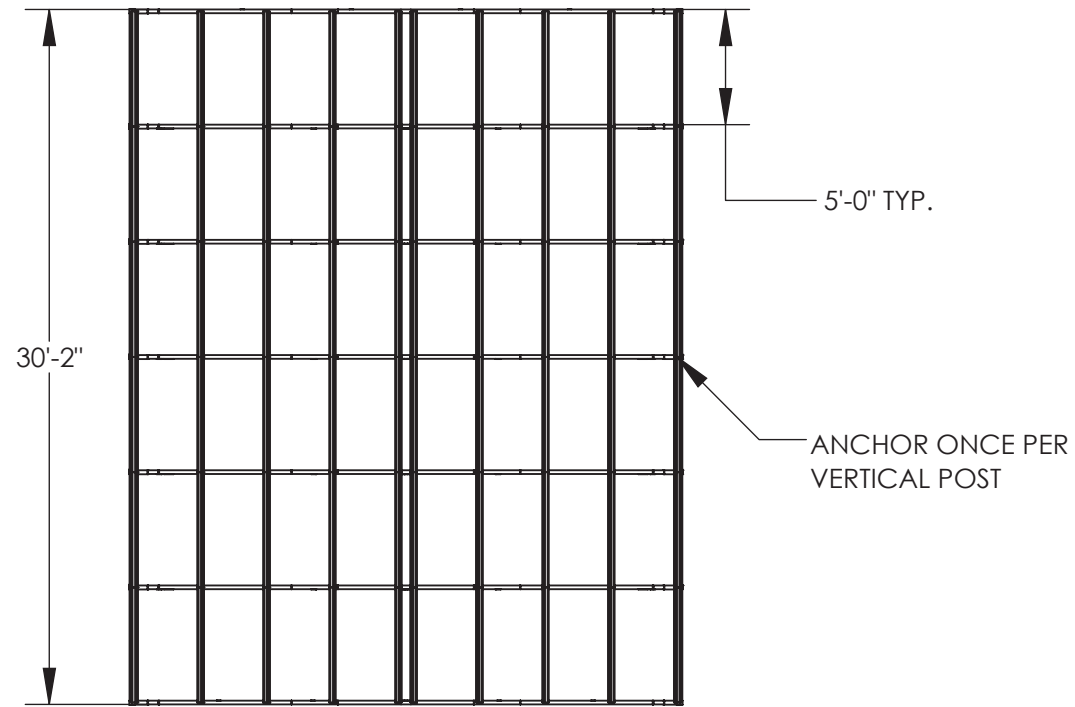

SECTION A-A
 SCALE 1 : 100

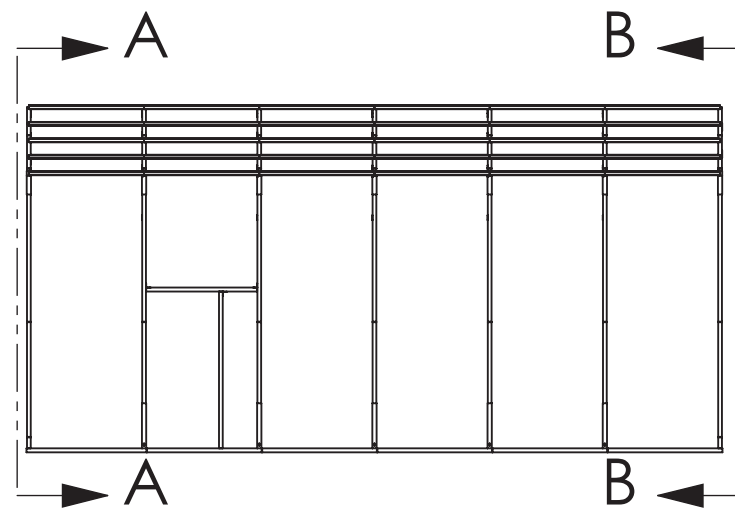

- FOR WALK DOOR:
 (1) 7100-8175, 2X3X81 3/4"
 (1) 7100-5775, 2X3X57 3/4"
 (3) BK-10 ANGLE BRACKET
 (1) BK-20 FLAT BRACKET
 (12) 71-9999-C314, 3" CONCEALER SCREW
 (1) 7500-04200P2, 1 1/2X1 1/2X42"
 (2) 7500-08175P5, 1 1/2X1 1/2X81 3/4"

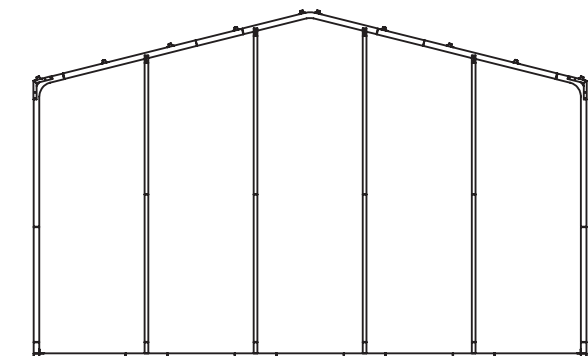

SECTION B-B
 SCALE 1 : 100

STRUCTURAL DESIGN

T & Z Consulting Services, LLC
 1428 N Shevlin Court
 Sewickley, PA 15143



PROJECT: VERSATUBE FRONTIER BUILDING

TITLE: 24' X 30'-2" X 12' ENCLOSED

DWG NO: FBSQ24301205-KB24-R+FE02412116X10+BE02412-4V

DRAWN BY: A. STRICKER

DATE: 10/5/2023

PAGE 2 OF 8

THE INFORMATION CONTAINED IN THIS DRAWING IS THE SOLE PROPERTY OF VERSATUBE BUILDING SYSTEMS ANY REPRODUCTION IN PART OR WHOLE WITHOUT THE WRITTEN PERMISSION OF VERSATUBE BUILDING SYSTEMS IS PROHIBITED.

NOTE TO BUILDING DEPARTMENT OFFICIAL: THESE DRAWINGS AND/OR CALCULATIONS ARE VALID ONLY FOR STRUCTURES MANUFACTURED BY VERSATUBE BUILDING SYSTEMS. VERIFICATION IS RECOMMENDED PRIOR TO BUILDING APPROVAL.

© VERSATUBE BUILDING SYSTEMS 2023

FRANK CASTANEDA
284 PERRY RD
SANFORD, NC 27332
24' X 30'-2" X 12'

SEAL:



11/10/2023

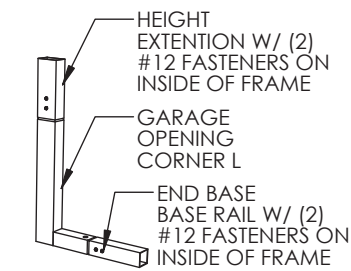

END WALL DOOR L CONNECTION

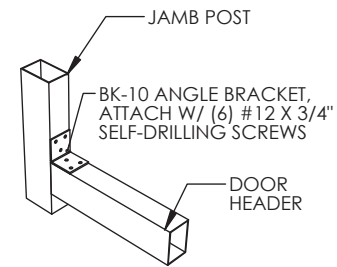

BK-10 ANGLE BRACKET, END WALL HEADER TO VERTICAL

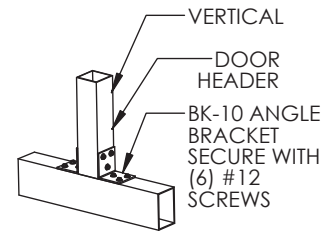

VERTICAL TO HEADER

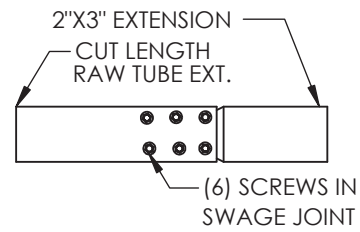

HEADER CONNECTION

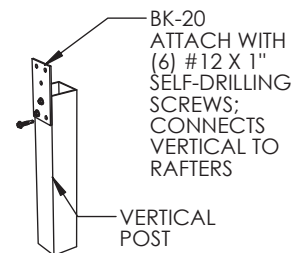

FLAT BRACKET TO VERTICAL

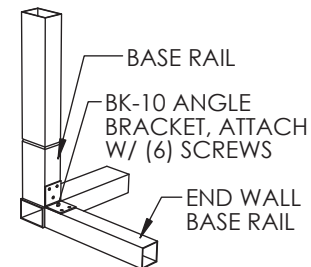

END WALL BASE RAIL TO EAVE WALL

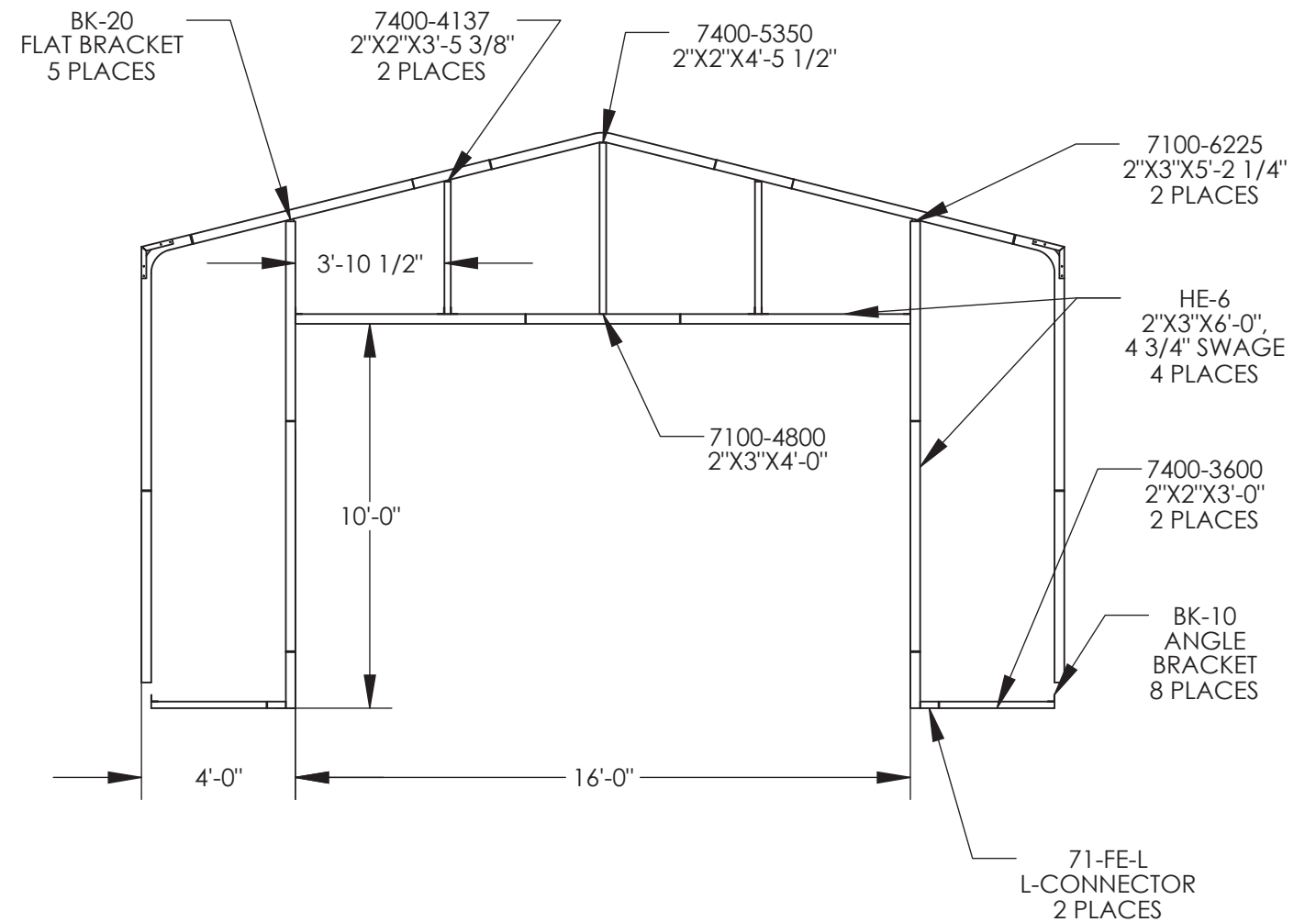

STRUCTURAL DESIGN

T & Z Consulting Services, LLC
1428 N Shevlin Court
Sewickley, PA 15143



PROJECT: VERSATUBE FRONTIER BUILDING

TITLE: 24' X 30'-2" X 12' ENCLOSED

DWG NO: FE02412116X10

DRAWN BY: A. STRICKER

DATE: 10/5/2023

PAGE 3 OF 8

THE INFORMATION CONTAINED IN THIS DRAWING IS THE SOLE PROPERTY OF VERSATUBE BUILDING SYSTEMS ANY REPRODUCTION IN PART OR WHOLE WITHOUT THE WRITTEN PERMISSION OF VERSATUBE BUILDING SYSTEMS IS PROHIBITED.

NOTE TO BUILDING DEPARTMENT OFFICIAL: THESE DRAWINGS AND/OR CALCULATIONS ARE VALID ONLY FOR STRUCTURES MANUFACTURED BY VERSATUBE BUILDING SYSTEMS. VERIFICATION IS RECOMMENDED PRIOR TO BUILDING APPROVAL.

© VERSATUBE BUILDING SYSTEMS 2023

FRANK CASTANEDA
284 PERRY RD
SANFORD, NC 27332
24' X 30'-2" X 12'

SEAL:



11/10/2023

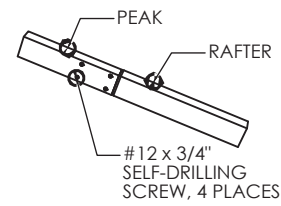

PEAK TO RAFTER

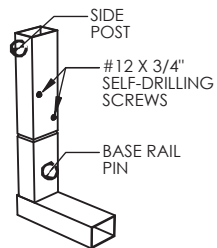

BASE RAIL TO SIDE POST

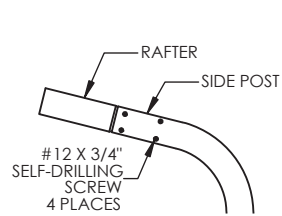

SIDE POST TO RAFTER DETAIL

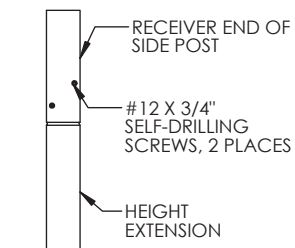

HEIGHT EXTENSION TO SIDE POST

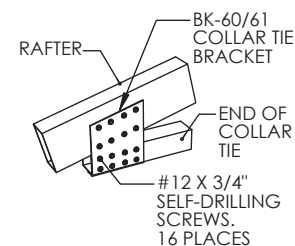

COLLAR TIE BRACKET

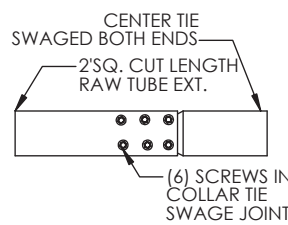

COLLAR TIE CONNECTION

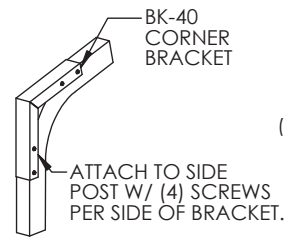

EAVE CORNER BRACKET

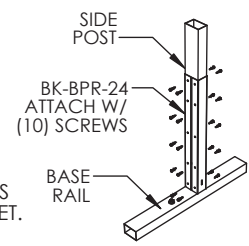

BK-BPR-24 TO SIDE POST

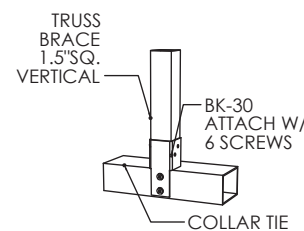

BK-30 TO COLLAR TIE

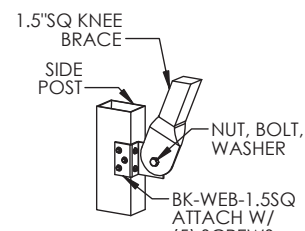

KNEE BRACE TO BRACKET

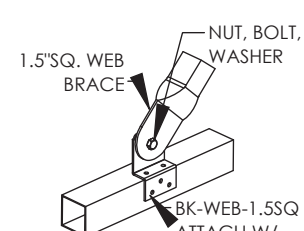

SINGLE WEB BRACE TO BRACKET

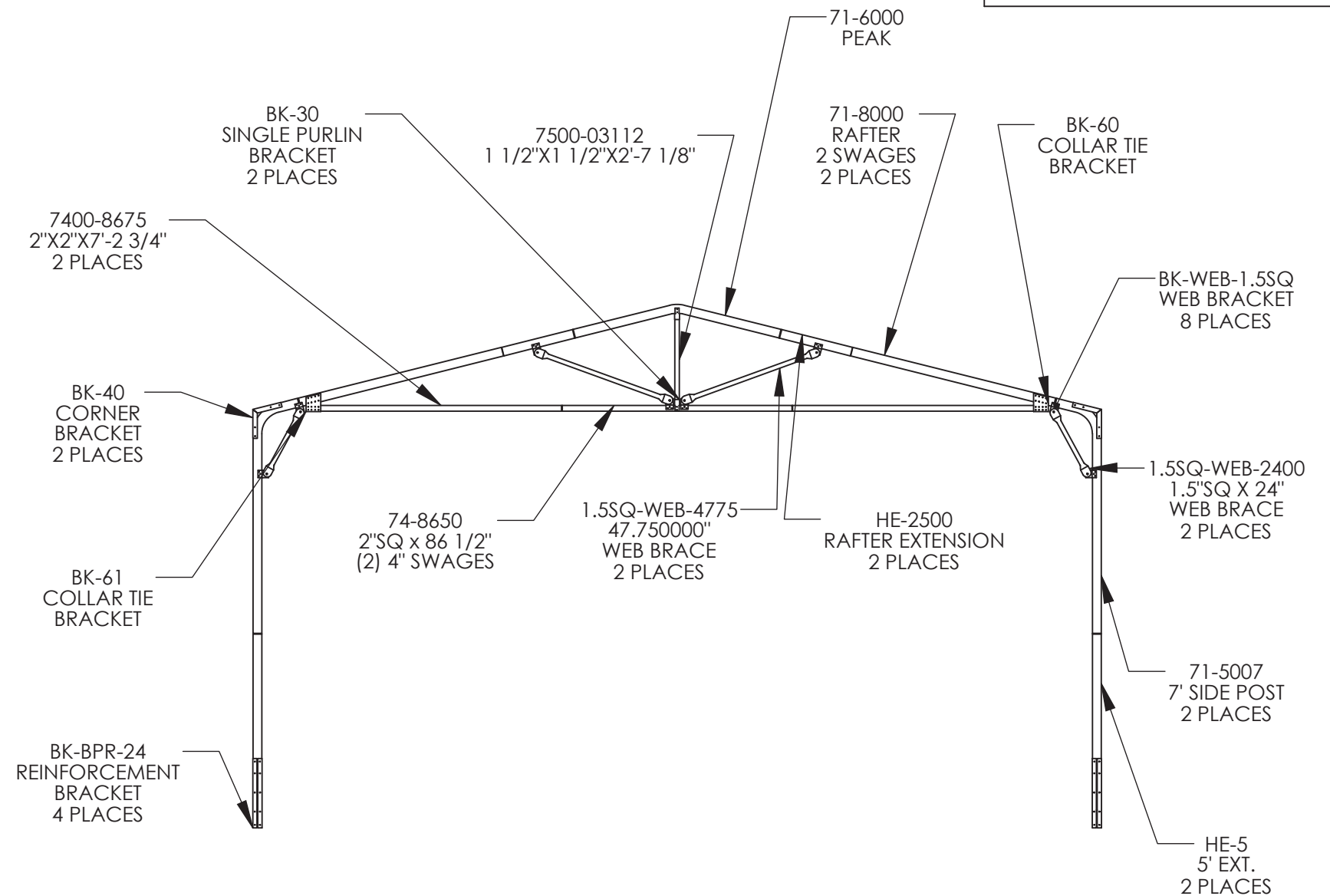

STRUCTURAL DESIGN

T & Z Consulting Services, LLC
1428 N Shevlin Court
Sewickley, PA 15143



PROJECT: VERSATUBE FRONTIER BUILDING

TITLE: 24' X 30'-2" X 12' ENCLOSED

DWG NO: 24X12 RWS BK40 2X3 FF QUEEN 24KB BK-BPR-24

DRAWN BY: A. STRICKER

DATE: 10/5/2023

PAGE 4 OF 8

THE INFORMATION CONTAINED IN THIS DRAWING IS THE SOLE PROPERTY OF VERSATUBE BUILDING SYSTEMS ANY REPRODUCTION IN PART OR WHOLE WITHOUT THE WRITTEN PERMISSION OF VERSATUBE BUILDING SYSTEMS IS PROHIBITED.
 NOTE TO BUILDING DEPARTMENT OFFICIAL: THESE DRAWINGS AND/OR CALCULATIONS ARE VALID ONLY FOR STRUCTURES MANUFACTURED BY VERSATUBE BUILDING SYSTEMS. VERIFICATION IS RECOMMENDED PRIOR TO BUILDING APPROVAL.
 © VERSATUBE BUILDING SYSTEMS 2023

FRANK CASTANEDA
 284 PERRY RD
 SANFORD, NC 27332
 24' X 30'-2" X 12'

SEAL:



11/10/2023

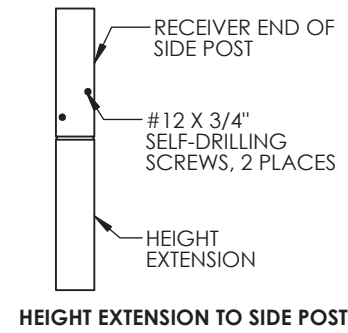

HEIGHT EXTENSION TO SIDE POST

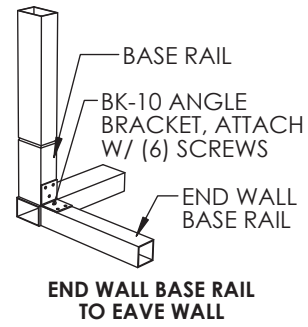

END WALL BASE RAIL TO EAVE WALL

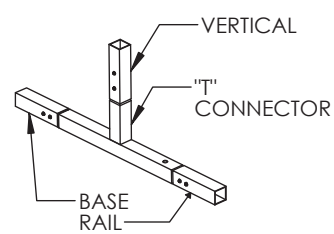

"T" CONNECTIONS

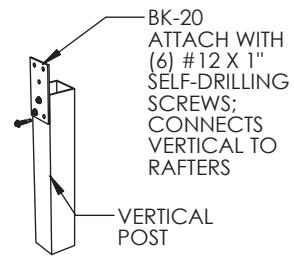

FLAT BRACKET TO VERTICAL

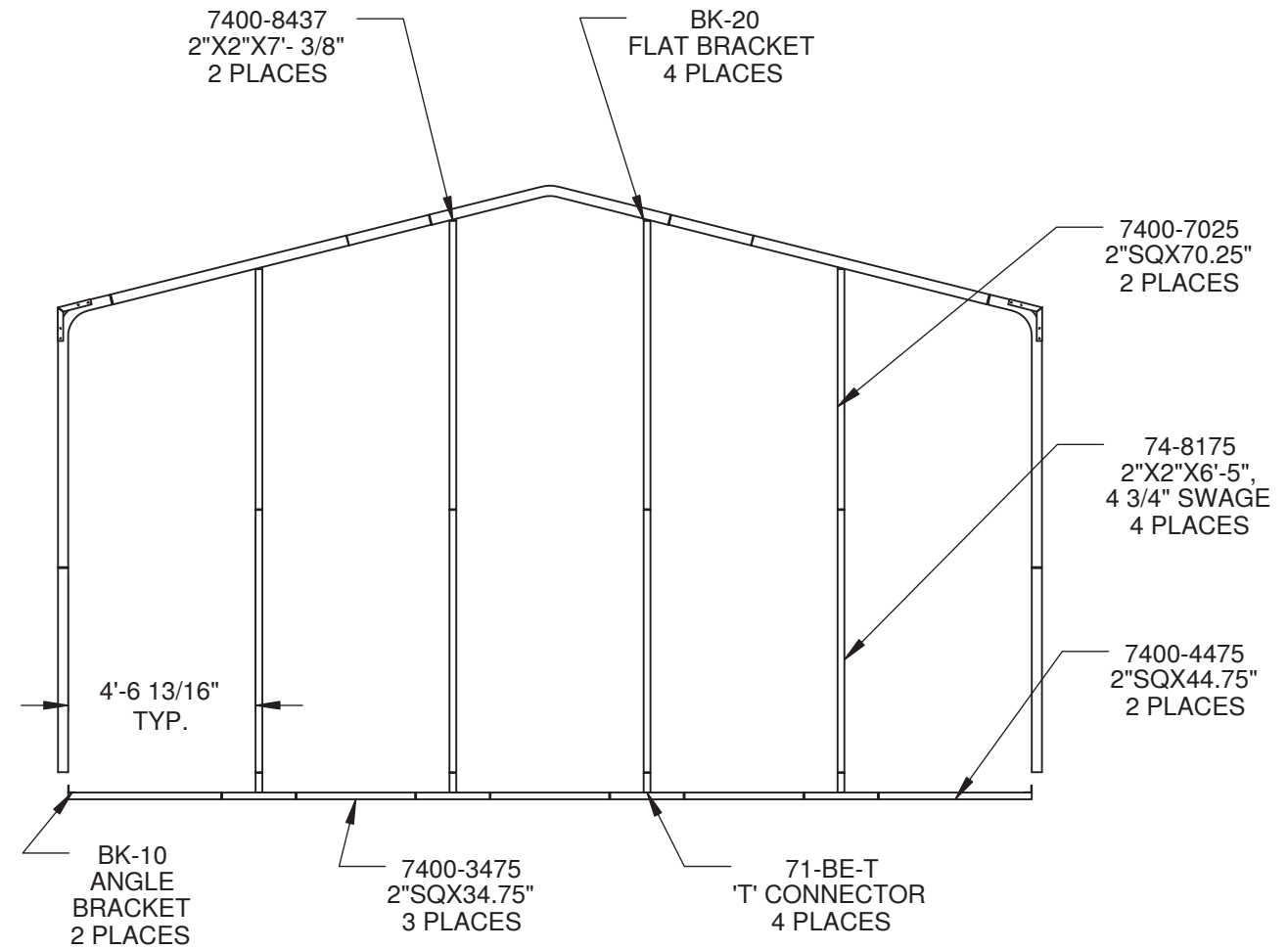

STRUCTURAL DESIGN

T & Z Consulting Services, LLC
 1428 N Shevlin Court
 Sewickley, PA 15143



PROJECT: VERSATUBE FRONTIER BUILDING

TITLE: 24' X 30'-2" X 12' ENCLOSED

DWG NO:

DRAWN BY: A. STRICKER

DATE: 10/5/2023

PAGE 5 OF 8

THE INFORMATION CONTAINED IN THIS DRAWING IS THE SOLE PROPERTY OF VERSATUBE BUILDING SYSTEMS ANY REPRODUCTION IN PART OR WHOLE WITHOUT THE WRITTEN PERMISSION OF VERSATUBE BUILDING SYSTEMS IS PROHIBITED.

NOTE TO BUILDING DEPARTMENT OFFICIAL: THESE DRAWINGS AND/OR CALCULATIONS ARE VALID ONLY FOR STRUCTURES MANUFACTURED BY VERSATUBE BUILDING SYSTEMS. VERIFICATION IS RECOMMENDED PRIOR TO BUILDING APPROVAL.

© VERSATUBE BUILDING SYSTEMS 2023

FRANK CASTANEDA
284 PERRY RD
SANFORD, NC 27332
24' X 30'-2" X 12'

SEAL:



11/10/2023

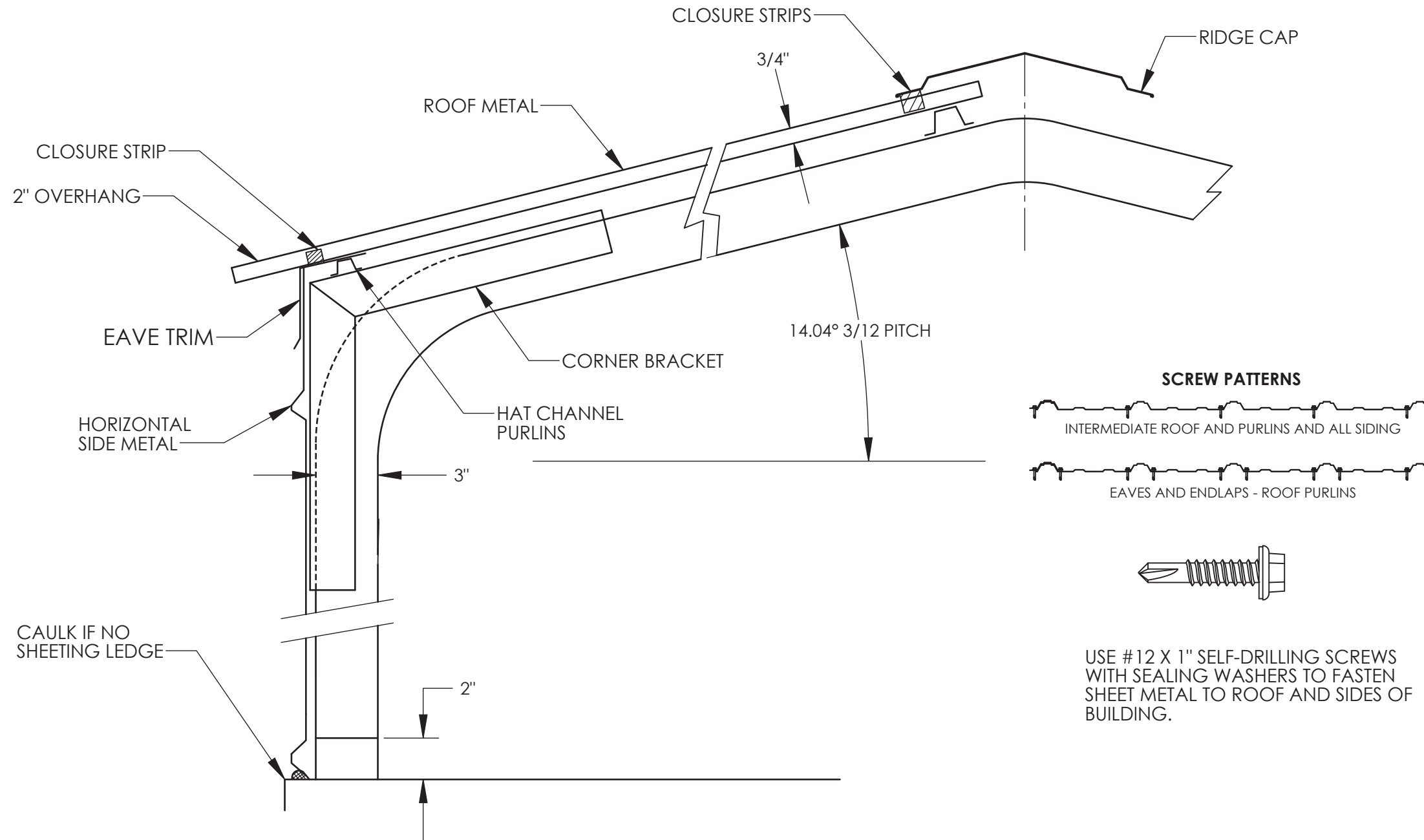

STRUCTURAL DESIGN

T & Z Consulting Services, LLC
1428 N Shevlin Court
Sewickley, PA 15143



PROJECT: VERSATUBE FRONTIER BUILDING

TITLE: 24' X 30'-2" X 12' ENCLOSED

DWG NO:

DRAWN BY: A. STRICKER

DATE: 10/5/2023

PAGE 6 OF 8

THE INFORMATION CONTAINED IN THIS DRAWING IS THE SOLE PROPERTY OF VERSATUBE BUILDING SYSTEMS ANY REPRODUCTION IN PART OR WHOLE WITHOUT THE WRITTEN PERMISSION OF VERSATUBE BUILDING SYSTEMS IS PROHIBITED.
 NOTE TO BUILDING DEPARTMENT OFFICIAL: THESE DRAWINGS AND/OR CALCULATIONS ARE VALID ONLY FOR STRUCTURES MANUFACTURED BY VERSATUBE BUILDING SYSTEMS. VERIFICATION IS RECOMMENDED PRIOR TO BUILDING APPROVAL.
 © VERSATUBE BUILDING SYSTEMS 2023

FRANK CASTANEDA
 284 PERRY RD
 SANFORD, NC 27332
 24' X 30'-2" X 12'

SEAL:



11/10/2023

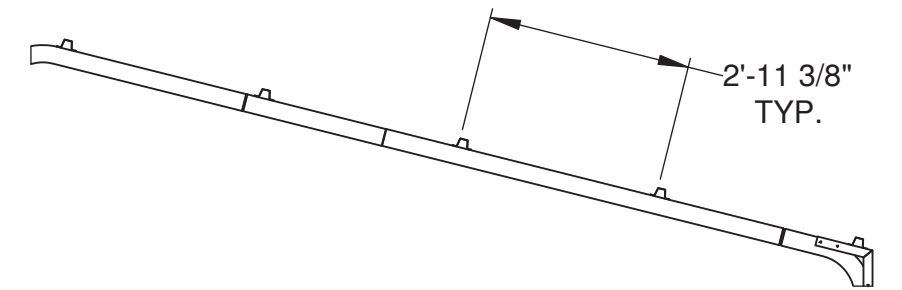
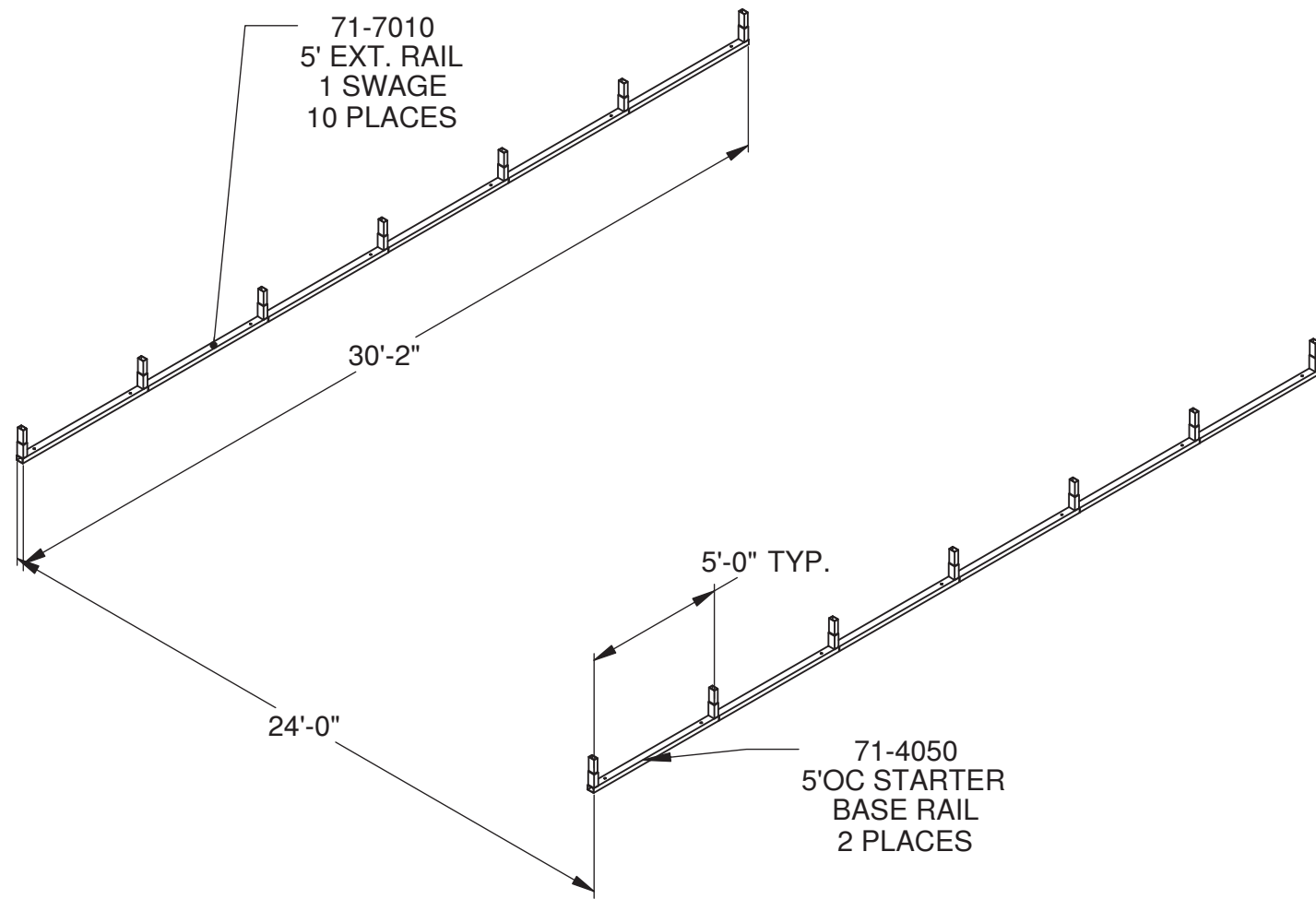

STRUCTURAL DESIGN
 T & Z Consulting Services, LLC
 1428 N Shevlin Court
 Sewickley, PA 15143



PROJECT: VERSATUBE FRONTIER BUILDING
 TITLE: 24' X 30'-2" X 12' ENCLOSED
 DWG NO:
 DRAWN BY: A. STRICKER DATE: 10/5/2023

THE INFORMATION CONTAINED IN THIS DRAWING IS THE SOLE PROPERTY OF VERSATUBE BUILDING SYSTEMS ANY REPRODUCTION IN PART OR WHOLE WITHOUT THE WRITTEN PERMISSION OF VERSATUBE BUILDING SYSTEMS IS PROHIBITED.
 NOTE TO BUILDING DEPARTMENT OFFICIAL: THESE DRAWINGS AND/OR CALCULATIONS ARE VALID ONLY FOR STRUCTURES MANUFACTURED BY VERSATUBE BUILDING SYSTEMS. VERIFICATION IS RECOMMENDED PRIOR TO BUILDING APPROVAL.
 © VERSATUBE BUILDING SYSTEMS 2023

FRANK CASTANEDA
 284 PERRY RD
 SANFORD, NC 27332
 24' X 30'-2" X 12'

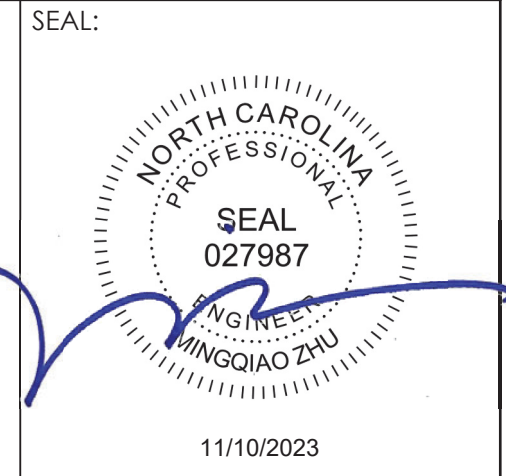

ANCHOR HOLD DOWN FORCE 2,425 LBS.
 ES REPORT: ESR-2818

INSTALLATION:
 USING HAMMER DRILL AND A 1/2" CONCRETE DRILL BIT, DRILL A HOLE INTO THE CONCRETE 3" TO DEEP. PLACE THE FLAT WASHER ON THE BOLT AND INSTALL THE NUT UNTIL ABOUT 2 THREADS ARE EXPOSED ABOVE THE NUT. TAP THE ANCHOR THROUGH THE BASE RAIL INTO THE HOLE UNTIL THE WASHER TOUCHES THE TOP OF THE BASE RAIL. NOW, TIGHTEN THE NUT TO SET THE ANCHOR. DO NOT OVER TIGHTEN AND CRUSH THE TUBE.

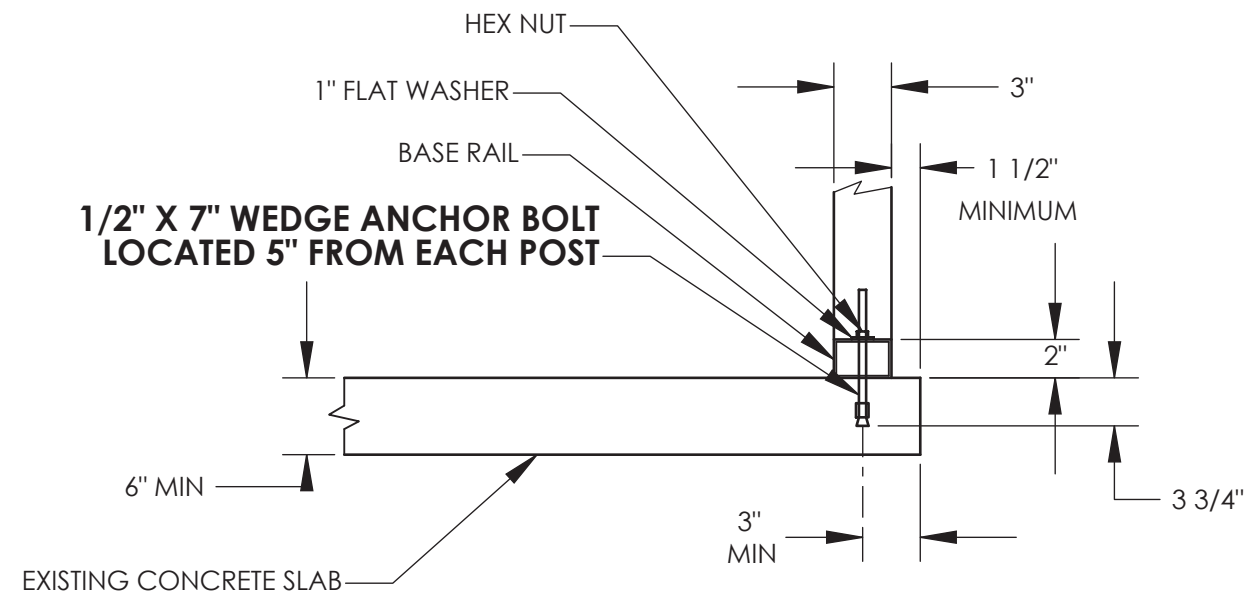

NOTE ON SLAB SIZE:
 SLAB SHOULD BE AT LEAST 3" WIDER AND 3" LONGER THAN THE CARPORT FRAME.

FOUNDATION DESIGN IS BY OTHERS
 REFER TO THE FRAME DESIGN CALCULATION
 FOR THE MAXIMUM REACTIONS.

STRUCTURAL DESIGN
 T & Z Consulting Services, LLC
 1428 N Shevlin Court
 Sewickley, PA 15143



PROJECT: VERSATUBE FRONTIER BUILDING
 TITLE: 24' X 30'-2" X 12' ENCLOSED
 DWG NO: CONCRETE ANCHOR DETAIL
 DRAWN BY: A. STRICKER DATE: 10/5/2023
 PAGE 8 OF 8