

Revised for house size

App# BRES2308-0016

## Harnett County Department of Public Health

### Improvement Permit

A building permit cannot be issued with only an Improvement Permit

ISSUED TO: Janet Clark PROPERTY LOCATION: 518 McNeill Mill Rd (SR 1228)  
NEW ☒ REPAIR ☐ EXPANSION ☐ SUBDIVISION \_\_\_\_\_ LOT # \_\_\_\_\_  
Type of Structure: 32' x 56' SFD Site Improvements required prior to Construction Authorization Issuance: \_\_\_\_\_  
Proposed Wastewater System Type: 25% reduction  
Projected Daily Flow: 240 GPD  
Number of bedrooms: 2 Number of Occupants: 4 max  
Basement ☐ Yes ☒ No  
Pump Required: ☐ Yes ☐ No ☒ May be required based on final location and elevations of facilities  
Type of Water Supply: ☐ Community ☒ Public ☐ Well Distance from well \_\_\_\_\_ feet Permit valid for: ☒ Five years  
Permit conditions: \_\_\_\_\_ ☐ No expiration

Authorized State Agent: Mel A. REHS Date: 4-25-25 SEE ATTACHED SITE SKETCH  
The issuance of this permit by the Health Department in no way guarantees the issuance of other permits. The permit holder is responsible for checking with appropriate governing bodies in meeting their requirements. This site is subject to revocation if the site plan, plat or the intended use changes. The Improvement Permit shall not be affected by a change in ownership of the site. This permit is subject to compliance with the provisions of the Laws and Rules for Sewage Treatment and Disposal and to conditions of this permit.

### Construction Authorization

(Required for Building Permit)

The construction and installation requirements of Rules 1950, 1952, 1954, 1955, 1956, 1957, 1958 and 1959 are incorporated by references into this permit and shall be met. Systems shall be installed in accordance with the attached system layout.

ISSUED TO: Janet Clark PROPERTY LOCATION: 518 McNeill Mill Rd (SR 1228)  
FACILITY TYPE: 32' x 56' SFD SUBDIVISION \_\_\_\_\_ LOT # \_\_\_\_\_  
Basement? ☐ Yes ☒ No Expansion ☐ Repair ☐  
Type of Wastewater System\*\* 25% reduction (Initial) Wastewater Flow: 240 GPD  
(See note below, if applicable ☐)  
25% reduction (Repair)  
Installation Requirements/Conditions  
Septic Tank Size 1000 gallons Number of trenches 1  
Pump Tank Size 1000 gallons Exact length of each trench 120 feet  
Trenches shall be installed on contour at a Trench Spacing: 9 Feet on Center  
Maximum Trench Depth of: 24 inches Soil Cover: 6 inches  
(Trench bottoms shall be level to  $\pm 1/4"$  (Maximum soil cover shall not exceed  
in all directions) 36" above the trench bottom)  
Pump Requirements: \_\_\_\_\_ ft. TDH vs. \_\_\_\_\_ GPM Aggregate Depth: \_\_\_\_\_ inches below pipe  
\_\_\_\_\_ inches above pipe  
Conditions: \_\_\_\_\_ inches total

WATER LINES (INCLUDING IRRIGATION) MUST BE 10FT. FROM ANY PART OF SEPTIC SYSTEM OR REPAIR AREA.  
NO UTILITIES ALLOWED IN INITIAL OR REPAIR DRAIN FIELD AREA.

\*\*If applicable: I understand the system type specified is different from the type specified on the application. I accept the specifications of this permit.

Owner/Legal Representative Signature: \_\_\_\_\_

Date: \_\_\_\_\_

This Construction Authorization is subject to revocation if the site plan, plat or the intended use changes. The Construction Authorization shall not be transferred when there is a change in ownership of the site. This Construction Authorization is subject to compliance with the provisions of the Laws and Rules for Sewage Treatment and Disposal and to the conditions of this permit.

SEE ATTACHED SITE SKETCH

Authorized State Agent: Mel A. REHS

Date: 4-25-25

Construction Authorization Expiration Date: 4-25-30

Application # BRES2308-0016

## Harnett County Department of Public Health Site Sketch

Property Location: 518 McNeill Mill Rd (SR 1228)

Issued To: Janet Clark

Subdivision \_\_\_\_\_

Lot # \_\_\_\_\_

Authorized State Agent: \_\_\_\_\_

*Moh Ali* REHS

Date: 4-25-25

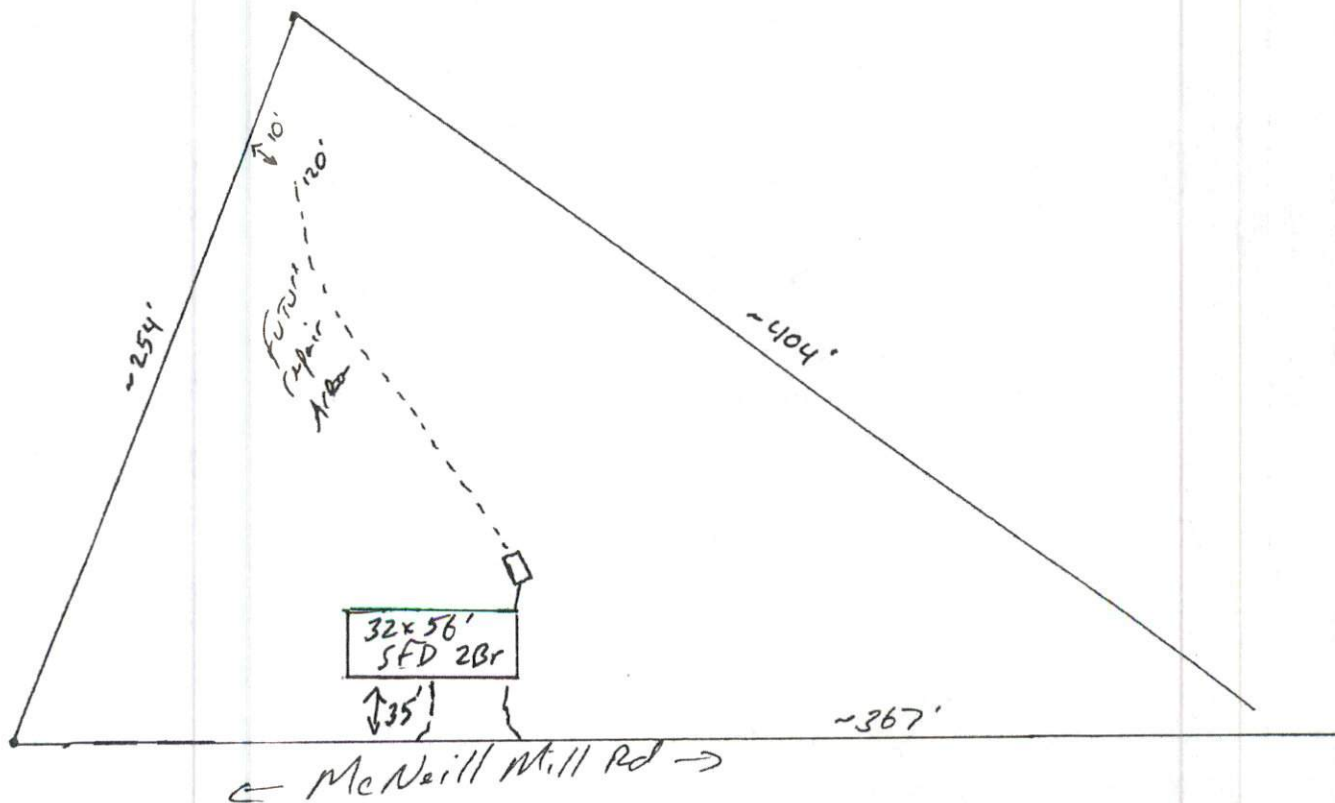

This drawing is for illustrative purposes only. System installation must meet all pertinent laws, rules, and regulations.