



ECS Southeast, LLP

6151 Raeford Road, Suite A
Fayetteville, NC 28304
9104013288
9103230539

LETTER OF TRANSMITTAL

September 29, 2023
Oakwood Homes

Fayetteville, NC 28306
ATTN: Chris Milligan

RE: **Lucky Lane Lot**
ECS Job # **33:6596-B**

Permits:
Location: **320 Lucky Ln.**
Bunnlevel, NC 28323

Field Reports For your use As requested

CC:

ENCL: Field Report # 1 9/28/2023

Jack Cowsert, P.E.
Office Manager

Aaron Kyle Adair
Team Leader

Disclaimer

1. This report (and any attachments) shall not be reproduced except in full without prior written approval of ECS.
2. The information in this report relates only to the activities performed on the report date.
3. Where appropriate, this report includes statements as to compliance with applicable project drawings, and specifications for the activities, performed on this report date.
4. Incomplete or non-conforming work will be reported for future resolution.
5. The results of samples and/or specimens obtained or prepared for subsequent laboratory testing will be presented in separate reports/documents.



ECS Southeast, LLP
6151 Raeford Road, Suite A
Fayetteville, NC 28304
(910) 401-3288 [Phone]
(910) 323-0539 [Fax]

FIELD REPORT

Project **Lucky Lane Lot**
Location **Bunnlevel, NC**
Client **Oakwood Homes**
Contractor **None Listed**

Project No. **33:6596-B**
Report No. **1**
Day & Date **Thursday 9/28/2023**
Weather **68 °/ Sunny**
On-Site Time **1.25**
Lab Time **0.00**
Travel Time* **0.00**
Total **1.25**
Re Obs Time **0.00**

Remarks					
Trip Charges*	Tolls/Parking*	Mileage*	Time of	Arrival	Departure
Chargeable Items				1:00P	2:15P

* Travel time and mileage will be billed in accordance with the contract.

Summary of Services Performed (field test data, locations, elevations & depths are estimates) & Individuals Contacted.

The undersigned arrived on site, as requested, to observe the excavation of footings at: S.E corner of lot, N.E corner of lot, N.W corner of lot, and S.W corner of lot. Please see the attached sketch.

Utilizing a Dynamic Cone Penetrometer (ASTM STP-399) to check the bearing capacity of soil at the aforementioned locations, test results indicated that soils, at the areas and elevations tested, should be capable of supporting a foundation designed for a net allowable bearing capacity of 2,000 psf respectively.

ECS will return, as requested, for additional services.

George Oxendine
 9/28/2023
 Lucky Lane Lot
 Proj#:6596-B

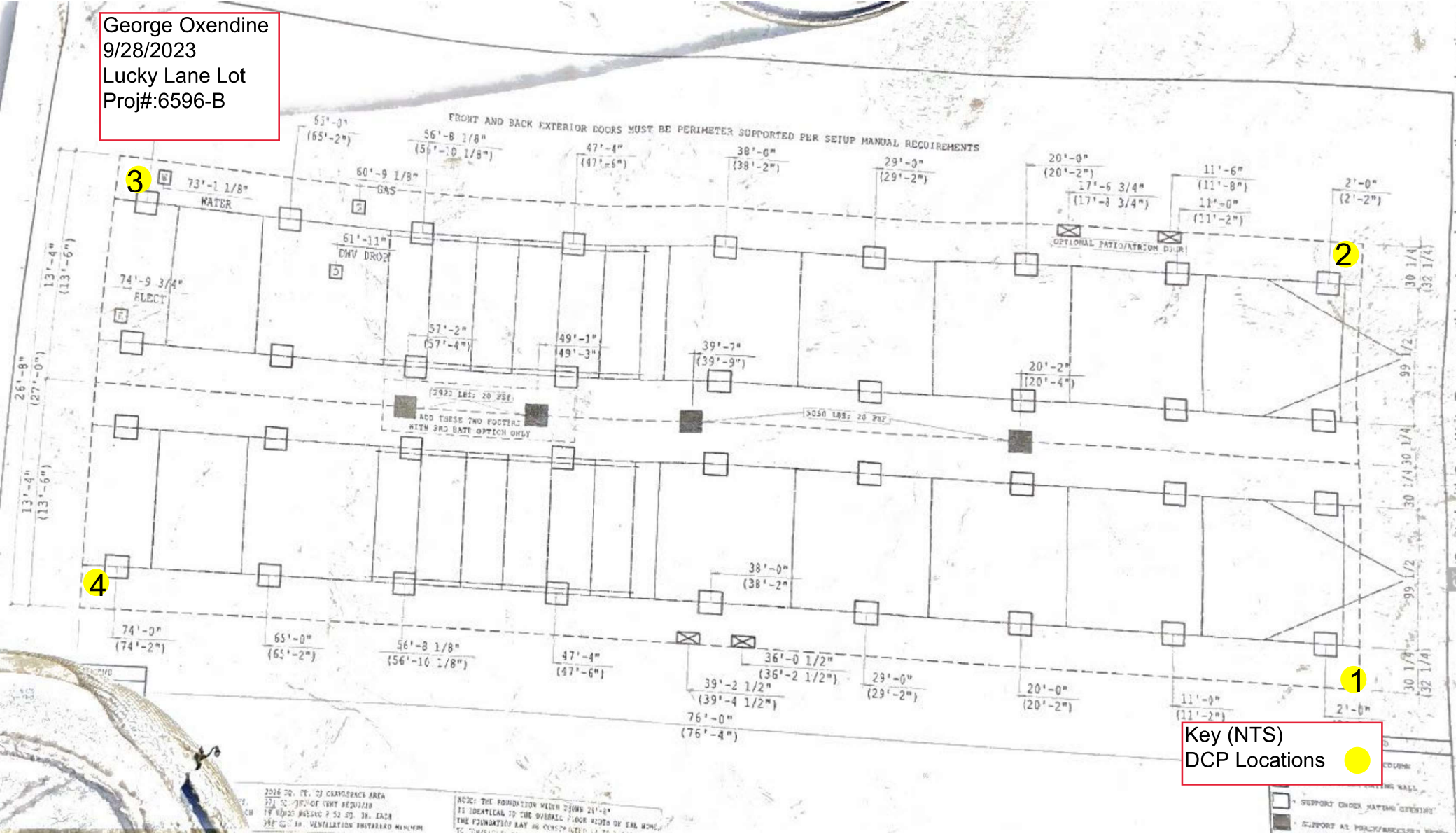

Key (NTS)
 DCP Locations

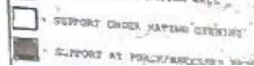

Created with ScanWritr. To remove this watermark please use the upgrade options



Report of Spread Footing - Foundation Observations

Project: Lucky Lane Lot
 Location: 320 Lucky Ln.
 Bunnlevel - Harnett County - NC - 28323
 Contractor: None Listed

Project No.: 33:6596-B
 Day/Date: 9/28/2023

Footing Number	Location	Size (W x H x L)		Footing Bottom Elevation		Description of Steel Placed	Description of Subgrade Material	Required Blow Counts	Design Bearing Pressure
		Design	Actual	Design **	Depth of Undercut (in)			# of Blows / Increment	
1	S.E corner of lot	x x	x x	N/A	N/A		(0)/-3Orange sand	6 (0)12,5,7(-1)12,10,25+(-2)25+(-3)20,22,25	2000
2	N.E corner of lot	x x	x x	N/A	N/A		(0)/-2Orangesand(-2)orange black sand(-3)BS	6 (0)4,5,5(-1)9,12,17(-2)7,12,20(-3)15,16,20	2000
3	N.W corner of lot	x x	x x	N/A	N/A		(0)/-2 Tan Sand (-3) Tan Orange Clay sand	6 (0)8,5,5(-1)5,7,7(-2)7,11,13(-3)11,17,20	2000
4	S.W corner of lot	x x	x x	N/A	N/A		(0)/-2 Tan Sand (-3) Tan Orange Clay sand	6 (0)5,9,11(-1)9,9,9(-2)20,25+(-3)25+	2000

** SGE: Subgrade Elevation to be determined by surveyor.

By: George Pate Oxendine Jr.

ECS Southeast, LLP

WO: 74430