

Depth Dim. "A"	16'-0"	20'-0"	24'-0"
Gable 16'-0" wide by:			

DESIGN CRITERIA: ASCE 7-10			
Ultimate Design Wind Speed (mph)	130	Fir, Live Ld. / Wood (psf)	50
Wind Exposure	D	Fir, Dead Ld. / Wood (psf)	10
Seismic Design Category	D	Loft Live Ld. / Wood (psf)	10
		Loft Dead Ld. / Wood (psf)	30
		Roof Live Load (psf)	19
		Ground Snow Load (psf)	10
		Roof Sheathing:	7/16" Rated 24/0
		Wall Sheathing:	3/8" Siding Rated 24/0

* NOTE *
FOLLOW LOCAL BUILDING CODES FOR FOUNDATION REQUIREMENTS



16'-0" GABLE STYLE BUILDING	
DATE: 03/21/2012	USER: JMB
PROJECT: 1000 Terms Dr. Monroe, NH 03102	DATE: 03/21/2012
STATUS: As Noted	PAGE: 1 of 1



* NOTE *
IF INSTALLING A PANEL STYLE DOOR... CONSULT MANUFACTURERS REQUIREMENTS FOR THE PROPER ROUGH OPENING DIMENSIONS

* NOTE *
WHEN OPTIONAL LOFT IS INSTALLED DO NOT USE 2 X 6 COLLAR TIES THAT ARE DIRECTLY ABOVE THE LOFT

* NOTE *
FOR END WALL WITH NO DOOR: USE 3/8" SmartSide and Attach w/ 0.131x2.5" nails at 6" o.c. Edge & 12" o.c. field. Holddown from Wall stud to Ground for 992 lbs.

* NOTE *
Holdown from Wall stud to Ground for 1,094 lbs.

* NOTE *
Holdown from Wall stud to Ground for 1,360 lbs.

5/8" thick WB Treated Floor Sheeting
 Secure floor decking to Joists w/ 8d nails
 @ 6" o.c. at Edge & 12" o.c. at Intermediate supports

2 x 8 TREATED Band Board
 Secure Bond @ corners w/
 (3) 16d nails

Floor joist to box
 sill w/(3) 16d nails,
 at ea. joists (TYP.)

2 x 8 TREATED
 Floor Joist

4 x 4 TREATED
 Runners

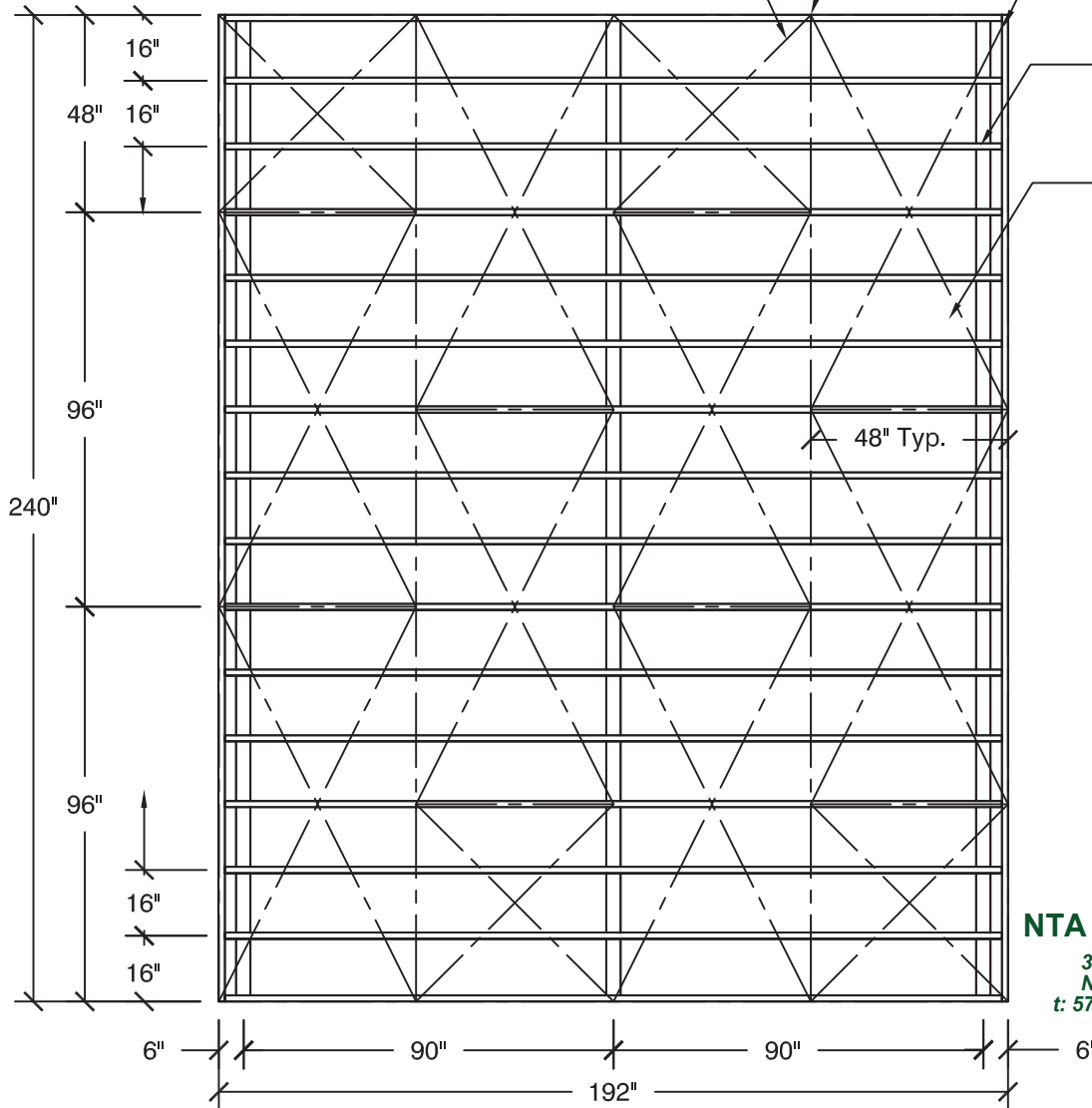

NTA ENGINEERING P.C.
 305 N. Oakland Ave
 Nappanee, IN 46550
 t: 574-773-7975 www.icc-nta.org

A
1

16' x 20' FLOOR FRAMING

SCALE: 1/4" = 1'-0"

*** NOTES:

- 1) FLOOR CAN BE UPGRADED TO 3/4" TREATED PLYWOOD.
- 2) IF THE 5/8" SQUARE EDGE OSB OPTION IS CHOSEN, SOLID BLOCKING MUST BE PROVIDED BETWEEN JOISTS AT SEAMS.
- 3) FOLLOW LOCAL BUILDING CODES FOR FOUNDATION REQUIREMENTS.



Timothy A. Baldrige
 Date Signed: Jun 09, 2023



16'-0" GABLE BUILDING WOOD FLOOR FRAMING

DATE	ADDRESS	DWG BY:	Last Revision
A	1000 Terres Dr. Monroe, MI 48162	S. Breilfield	March 8, 2012
SCALE	As Noted	SHEET	

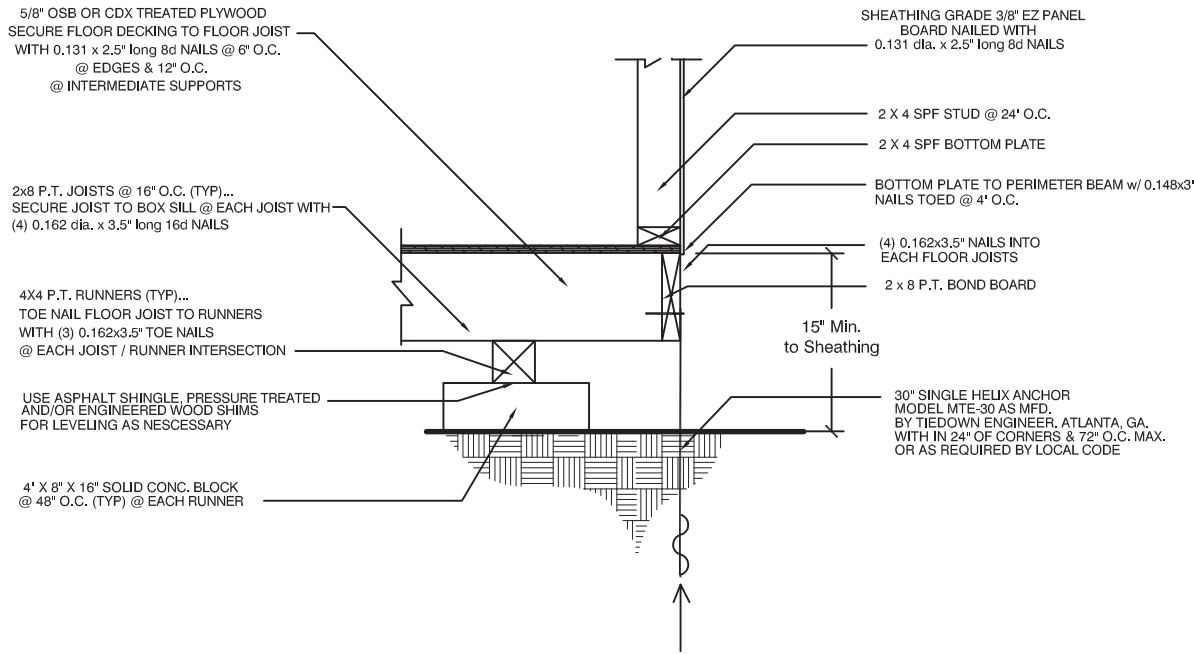

WOOD FLOOR FRAMING DETAIL

SCALE: 3/4" = 1'-0"

NOTES:

1. WHEN MONOLITHIC SLAB IS USED, THIS FLOOR FRAMING IS NOT REQUIRED
2. ALL MATERIALS AND LABOR SHALL MEET OR EXCEED APPLICABLE LOCAL CODES.
3. ALL LUMBER TO BE NO. 2 GRADE SPRUCE PINE FIR OR EQUIVALENT
4. THIS FLOOR FRAMING PLAN IS FOR THE BACKYARD PRODUCTS, LLC 16' WIDE GABLE ANY DEVIATION OR MODIFICATION IS STRICTLY PROHIBITED.
5. IN THE EVENT OF A DIMENSIONAL OR MATERIAL DISCREPANCY, NOTIFY BACKYARD PRODUCTS, LLC

4" CONCRETE
OR FIBERMESH
4' COMPACTED SAND OR GRAVEL
SEE NOTE 4

*** (1) Anchor Minimum On ***
Each Side Of Door Opening

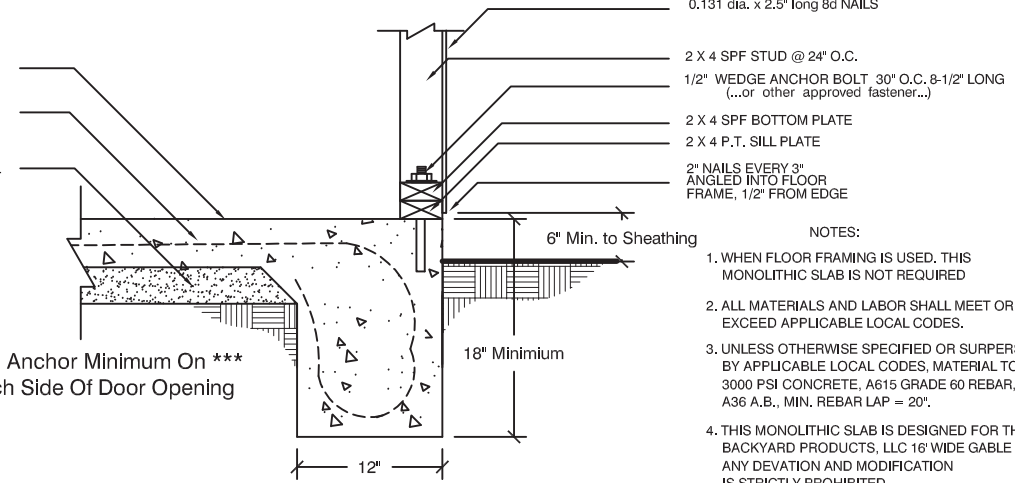

NOTES:

1. WHEN FLOOR FRAMING IS USED, THIS MONOLITHIC SLAB IS NOT REQUIRED
2. ALL MATERIALS AND LABOR SHALL MEET OR EXCEED APPLICABLE LOCAL CODES.
3. UNLESS OTHERWISE SPECIFIED OR SUPERSEDED BY APPLICABLE LOCAL CODES, MATERIAL TO BE 3000 PSI CONCRETE, A615 GRADE 60 REBAR, A36 A.B., MIN. REBAR LAP = 20".
4. THIS MONOLITHIC SLAB IS DESIGNED FOR THE BACKYARD PRODUCTS, LLC 16' WIDE GABLE ANY DEVIATION AND MODIFICATION IS STRICTLY PROHIBITED.

MONOLITHIC CONCRETE SLAB DETAIL

SCALE: 3/4" = 1'-0"

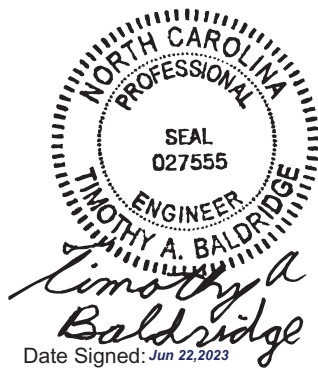

NTA Engineering, P.C., 305 N Oakland Ave
Nappanee, Indiana 46550
Engineering COA C-4764

These documents are applicable only to the elements and loading criteria specifically provided herein. These documents shall not be construed in any way to specify, certify or design any aspects of the building not contained herein. Specified design criteria are based solely on information provided by the client and must be verified and approved by the local authority having jurisdiction. NTA Engineering P.C. is not responsible for fabrication or erection. If it is suspected that these drawings have been modified, substituted or altered in any way, contact NTA Engineering P.C. at (574) 773-7975 to obtain a true copy.

Depth Dim. "A"	16'-0" Base	20'-0"	24'-0"			
GABLE Style						
16'-0" wide by:						



16' Wide GABLE
Style

SIZE A	ADDRESS 1000 Tarnes Drive Monroe, MI 48162	DWG BY: Ken Sutter	Last Revision July 15, 2021
SCALE As Noted	(800) 221-1848		SHEET