

7-17-2023

Joe Bednash

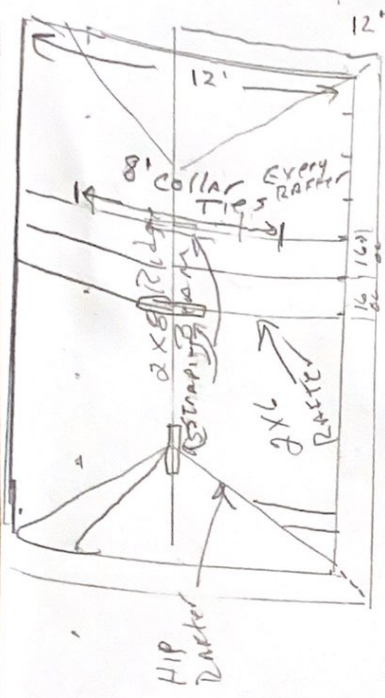

- 12" overhangs
- HIP Style Roof
- 2x8 Ridge Beam Board
- 2x6 Hip Rafters
- 2x6 Common Rafter 16 oc
- 2x6 Jack Rafters 16 oc
- 4-Pitch on Roof
- 7/16" OSB Sheathing
- #15 Felt Paper
- Arch Shingles
- 8' Collar Ties, Every Common Rafter
- 12" Strapping every 32" oc Common Rafter
- 12" Strapping Common Rafter to Ridge Board
- SIMPSON Strong-Tie Hurricane Tie (All) Rafters

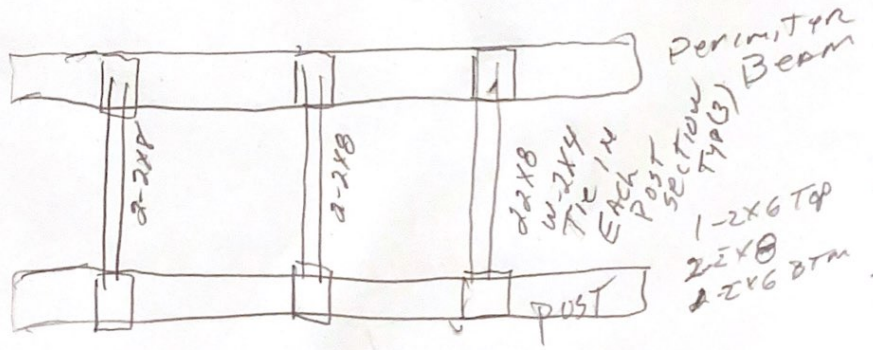
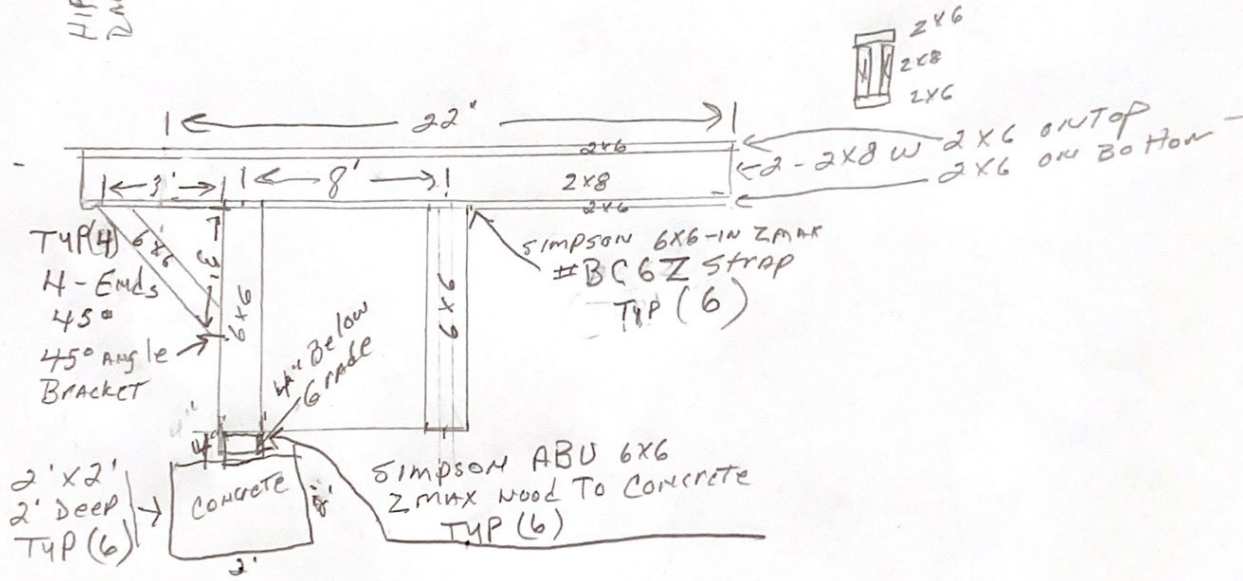

Joe Bednash
570-362-1268

JEANMAN DIRECT
910-814-6421

Joseph Rodush
570-363-1268

OSB Sheathing
2x6 Roof Rafters

2x8 w 2x6 on Top
2x6 on Bottom
Perimeter Beam
2x6
2x8
2x6

24" Deep
Typ (6)

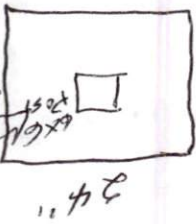

Metal Bracket
Metal Post Bracket

Footer
6x6 Post
Typ (6)

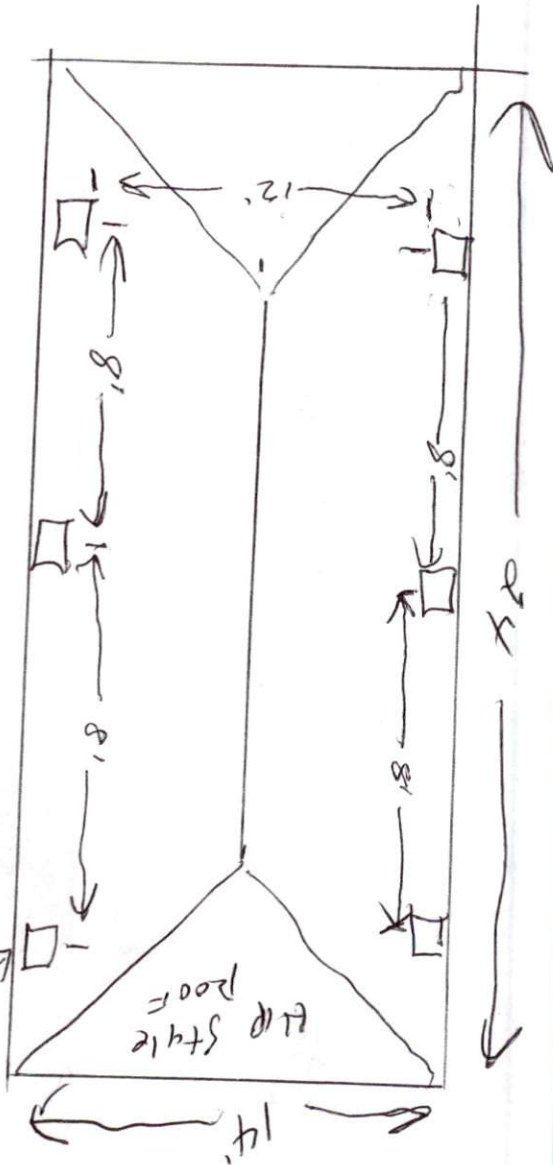

Mike Hendry
92 Golf Dr
Sanford NC 27332

7-11-2023