

## Harnett County Department of Public Health Improvement Permit

A building permit cannot be issued with only an Improvement Permit

ISSUED TO: Christopher Luetzger PROPERTY LOCATION: 2835 Barbecue Church Rd (SR 1209)  
 SUBDIVISION \_\_\_\_\_ LOT # \_\_\_\_\_  
 NEW  REPAIR  EXPANSION  Site Improvements required prior to Construction Authorization Issuance: \_\_\_\_\_  
 Type of Structure: existing house  
 Proposed Wastewater System Type: 25% reduction  
 Projected Daily Flow: 480 GPD  
 Number of bedrooms: 4 Number of Occupants: 8 max  
 Basement  Yes  No  
 Pump Required:  Yes  No  May be required based on final location and elevations of facilities  
 Type of Water Supply:  Community  Public  Well Distance from well \_\_\_\_\_ feet Permit valid for:  Five years  
 Permit conditions: \_\_\_\_\_  No expiration

Authorized State Agent: *Moh U REHS* Date: 08-14-23 SEE ATTACHED SITE SKETCH  
 The issuance of this permit by the Health Department in no way guarantees the issuance of other permits. The permit holder is responsible for checking with appropriate governing bodies in meeting their requirements. This site is subject to revocation if the site plan, plat, or the intended use changes. The Improvement Permit shall not be affected by a change in ownership of the site. This permit is subject to compliance with the provisions of the Laws and Rules for Sewage Treatment and Disposal and to conditions of this permit.

### Construction Authorization (Required for Building Permit)

The construction and installation requirements of Rules .1950, .1952, .1954, .1955, .1956, .1957, .1958, and .1959 are incorporated by references into this permit and shall be met. Systems shall be installed in accordance with the attached system layout.

ISSUED TO: Christopher Luetzger PROPERTY LOCATION: 2835 Barbecue Church Rd (SR 1209)  
 SUBDIVISION \_\_\_\_\_ LOT # \_\_\_\_\_  
 Facility Type: existing house  New  Expansion  Repair  
 Basement?  Yes  No Basement Fixtures?  Yes  No  
 Type of Wastewater System\*\* 25% reduction (Initial) Wastewater Flow: 480 GPD  
 (See note below, if applicable )  
25% reduction (Repair)  
 Installation Requirements/Conditions  
 Number of trenches 1  
 Septic Tank Size existing gallons Exact length of each trench 100 add feet Trench Spacing: 9 Feet on Center  
 Pump Tank Size \_\_\_\_\_ gallons Trenches shall be installed on contour at a Soil Cover: 6 inches  
 Maximum Trench Depth of: 12-18 inches (Maximum soil cover shall not exceed  
 (Trench bottoms shall be level to +/-1/4" 36" above the trench bottom)  
 in all directions)  
 Pump Requirements: \_\_\_\_\_ ft. TDH vs. \_\_\_\_\_ GPM \_\_\_\_\_ inches below pipe  
 Aggregate Depth: \_\_\_\_\_ inches above pipe  
 Conditions: Adding a 100' Drain line at 12" Deep, 9' above  
EXISTING Drain line, and must bring in 6" of cover for Drain line  
 WATER LINES (INCLUDING IRRIGATION) MUST BE 10FT. FROM ANY PART OF SEPTIC SYSTEM OR REPAIR AREA.  
 NO UTILITIES ALLOWED IN INITIAL OR REPAIR DRAIN FIELD AREA.

\*\*If applicable: I understand the system type specified is different from the type specified on the application. I accept the specifications of this permit.

Owner/Legal Representative Signature: \_\_\_\_\_ Date: \_\_\_\_\_

This Construction Authorization is subject to revocation if the site plan, plat, or the intended use changes. The Construction Authorization shall not be transferred when there is a change in ownership of the site. This Construction Authorization is subject to compliance with the provisions of the Laws and Rules for Sewage Treatment and Disposal and to the conditions of this permit. SEE ATTACHED SITE SKETCH

Authorized State Agent: *Moh U REHS* Date: 08-14-23  
 Construction Authorization Expiration Date: 08-14-28

Application # BRES2307-0007

## Harnett County Department of Public Health Site Sketch

Property Location: 2835 Barbecue Church Rd (SR 1209)

Issued To: Christopher Luetger Subdivision \_\_\_\_\_ Lot # \_\_\_\_\_

Authorized State Agent: *Michael DEHS* Date: 08-14-23

*★ Adding 100' Additional Drain line  
of 25% reduction to Existing Septic*

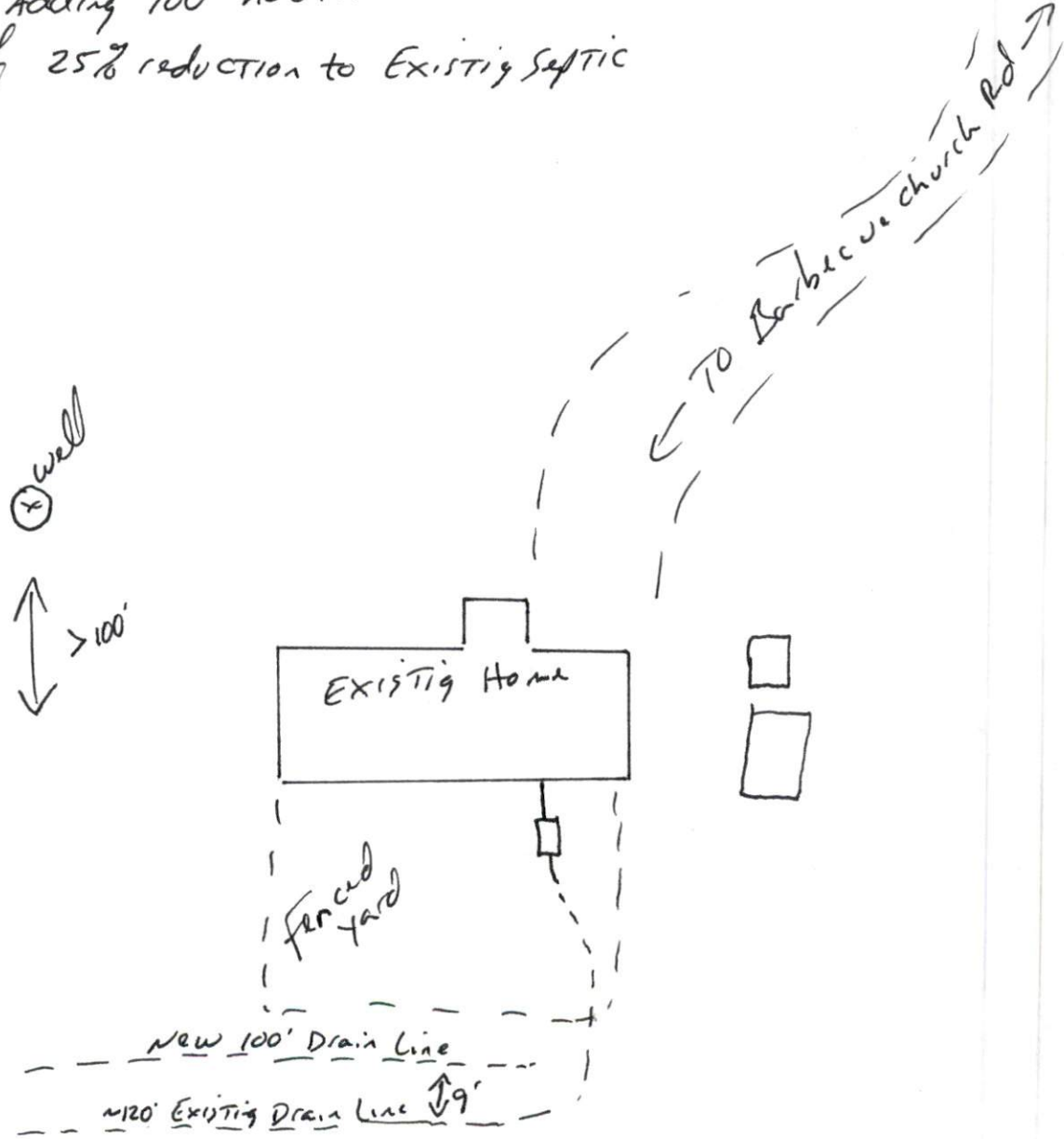

This drawing is for illustrative purposes only. System installation must meet all pertinent laws, rules, and regulations.