

Notched Slab

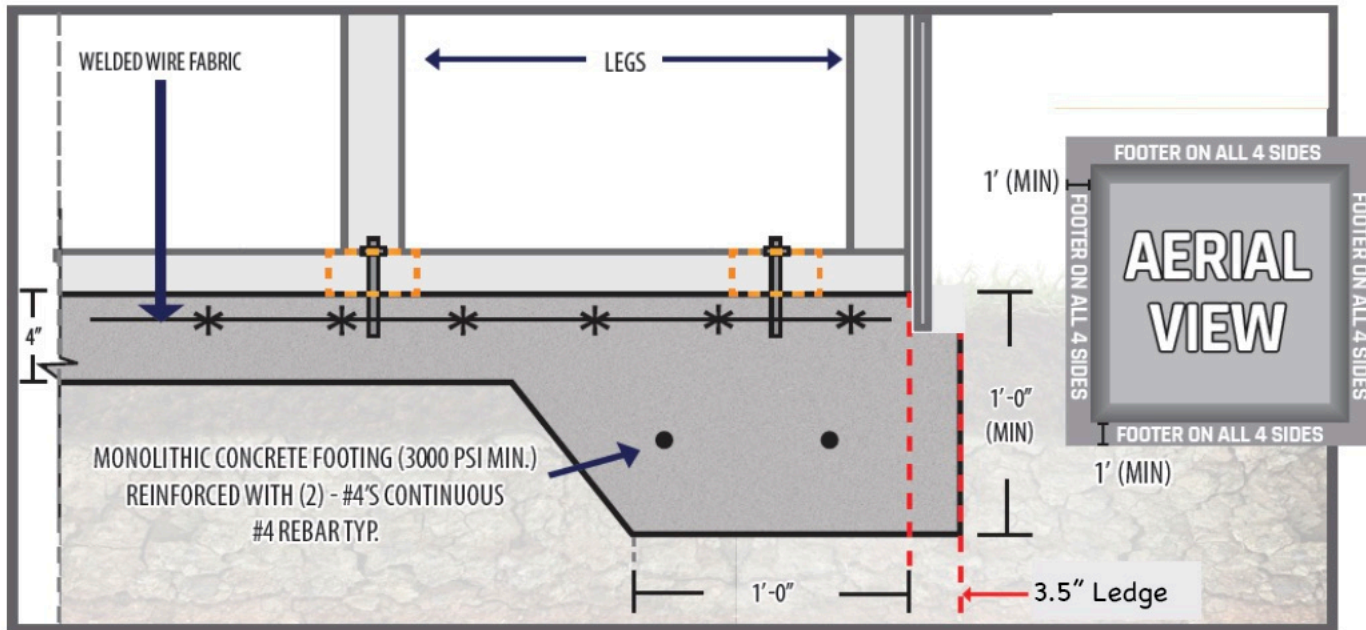

Oversized Slab

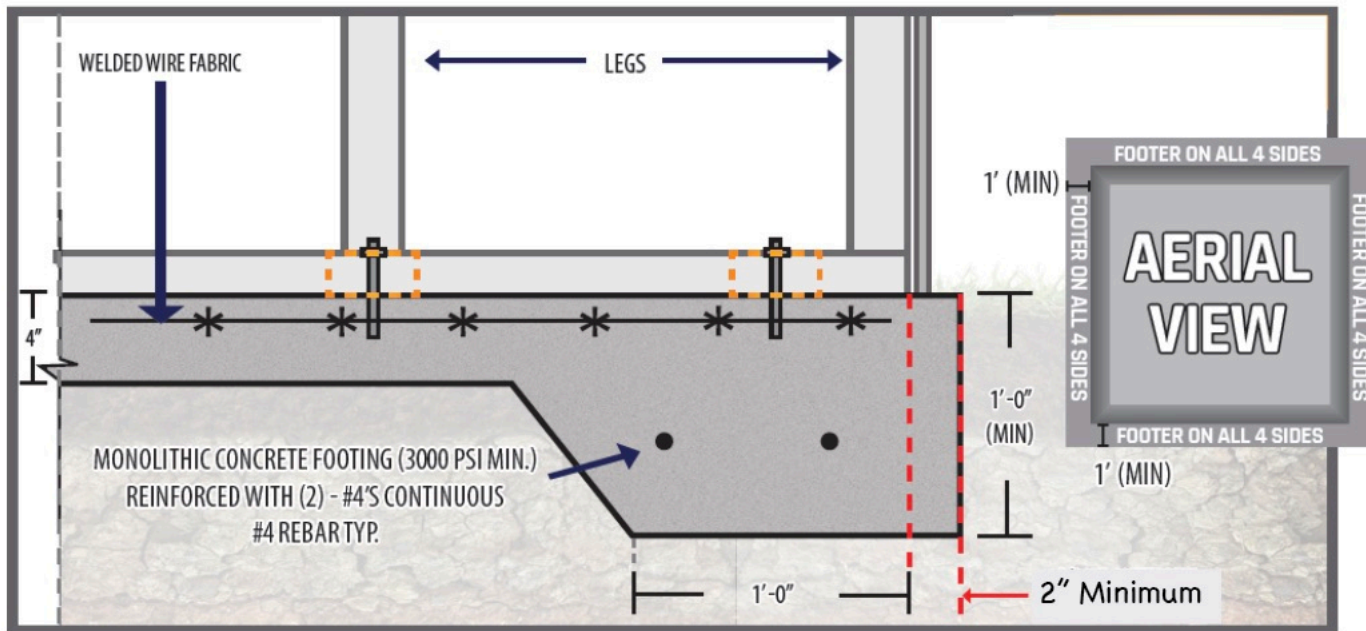

Notched Slab

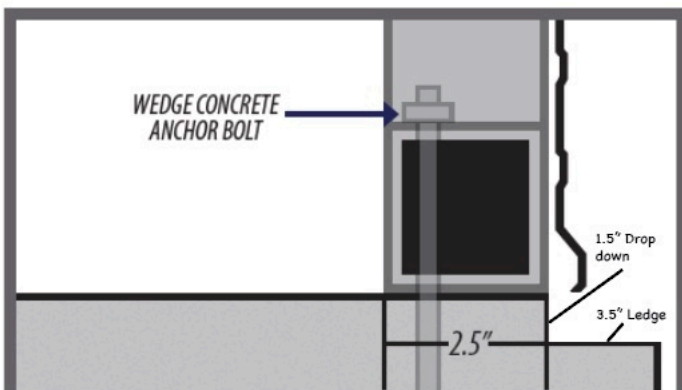

EXAMPLE:

This customer had a 30x40' building so his pad measured 30'7\"/>

With the notched edge, you will need the overall pad to be 7\"/>



Oversized Slab

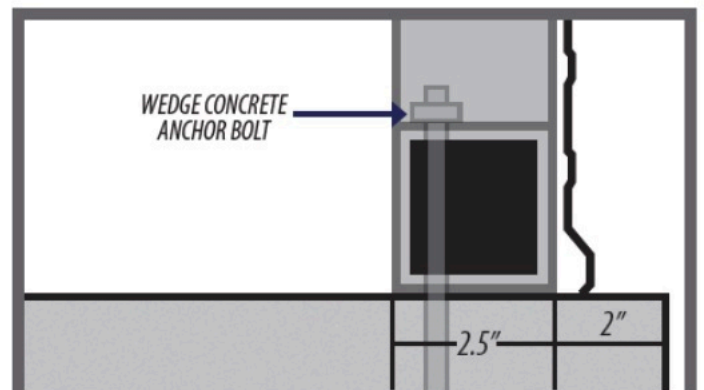

EXAMPLE:

This customer had a 34x50' building. Their overall pad was 24'4\"/>

With the oversized slab, you will need the overall pad size to be 4\"/>

