

## Harnett County Department of Public Health Improvement Permit

A building permit cannot be issued with only an Improvement Permit

ISSUED TO: Matthew Maxfield PROPERTY LOCATION: SL 1401 ROLLINS MILL RD  
 NEW  REPAIR  EXPANSION  SUBDIVISION \_\_\_\_\_ LOT # \_\_\_\_\_  
 Type of Structure: EX BLDG to office Site Improvements required prior to Construction Authorization Issuance: \_\_\_\_\_  
 Proposed Wastewater System Type: 25% REDUCTION  
 Projected Daily Flow: \_\_\_\_\_ GPD  
 Number of bedrooms: \_\_\_\_\_ Number of Occupants: \_\_\_\_\_ max  
 Basement  Yes  No  
 Pump Required:  Yes  No  May be required based on final location and elevations of facilities  
 Type of Water Supply:  Community  Public  Well Distance from well \_\_\_\_\_ feet Permit valid for:  Five years  
 Permit conditions: \_\_\_\_\_  No expiration

Authorized State Agent: James Markon JIP ZIPS Date: 6-23-23 SEE ATTACHED SITE SKETCH  
 The issuance of this permit by the Health Department in no way guarantees the issuance of other permits. The permit holder is responsible for checking with appropriate governing bodies in meeting their requirements. This site is subject to revocation of the site plan, plat, or the intended use changes. The Improvement Permit shall not be affected by a change in ownership of the site. This permit is subject to compliance with the provisions of the Laws and Rules for Sewage Treatment and Disposal and to conditions of this permit.

## Construction Authorization (Required for Building Permit)

The construction and installation requirements of Rules .1950, .1952, .1954, .1955, .1956, .1957, .1958, and .1959 are incorporated by references into this permit and shall be met. Systems shall be installed in accordance with the attached system layout.

ISSUED TO: Matthew Maxfield PROPERTY LOCATION: SL 1401 ROLLINS MILL RD  
 Facility Type: EX BLDG  New  Expansion  Repair  
 Basement?  Yes  No Basement Fixtures?  Yes  No  
 Type of Wastewater System\*\* 25% REDUCTION SYSTEM (Initial) Wastewater Flow: \_\_\_\_\_ GPD  
 (See note below, if applicable  25% REDUCTION (Repair))

**Installation Requirements/Conditions**

Septic Tank Size <u>1000</u> gallons	Number of trenches <u>2</u>	Trench Spacing: <u>2</u> Feet on Center
Pump Tank Size _____ gallons	Exact length of each trench <u>100</u> feet	Soil Cover: <u>6</u> inches
	Trenches shall be installed on contour at a	(Maximum soil cover shall not exceed
	Maximum Trench Depth of: <u>20</u> inches	36" above the trench bottom)
	(Trench bottoms shall be level to +1/4"	
	in all directions)	
Pump Requirements: _____ ft. TDH vs. _____ GPM		Aggregate Depth: _____ inches below pipe
		_____ inches above pipe
Conditions: _____		_____ inches total

**WATER LINES (INCLUDING IRRIGATION) MUST BE 10FT. FROM ANY PART OF SEPTIC SYSTEM OR REPAIR AREA.  
 NO UTILITIES ALLOWED IN INITIAL OR REPAIR DRAIN FIELD AREA.**

\*\*If applicable: I understand the system type specified is different from the type specified on the application. I accept the specifications of this permit.

Owner/Legal Representative Signature: \_\_\_\_\_ Date: \_\_\_\_\_

This Construction Authorization is subject to revocation if the site plan, plat, or the intended use changes. The Construction Authorization shall not be transferred when there is a change in ownership of the site. This Construction Authorization is subject to compliance with the provisions of the Laws and Rules for Sewage Treatment and Disposal and to the conditions of this permit. SEE ATTACHED SITE SKETCH

Authorized State Agent: James Markon JIP ZIPS Date: 6-23-23  
 Construction Authorization Expiration Date: 6-23-28

Application # Bres 2305-0064

### Harnett County Department of Public Health Site Sketch

Property Location: SR 1401 Rollers Mill RD

Issued To: Matthew Maxfield

Subdivision \_\_\_\_\_

Lot # \_\_\_\_\_

Authorized State Agent: \_\_\_\_\_

James E. Manton *PHS*

Date: 6-23-23

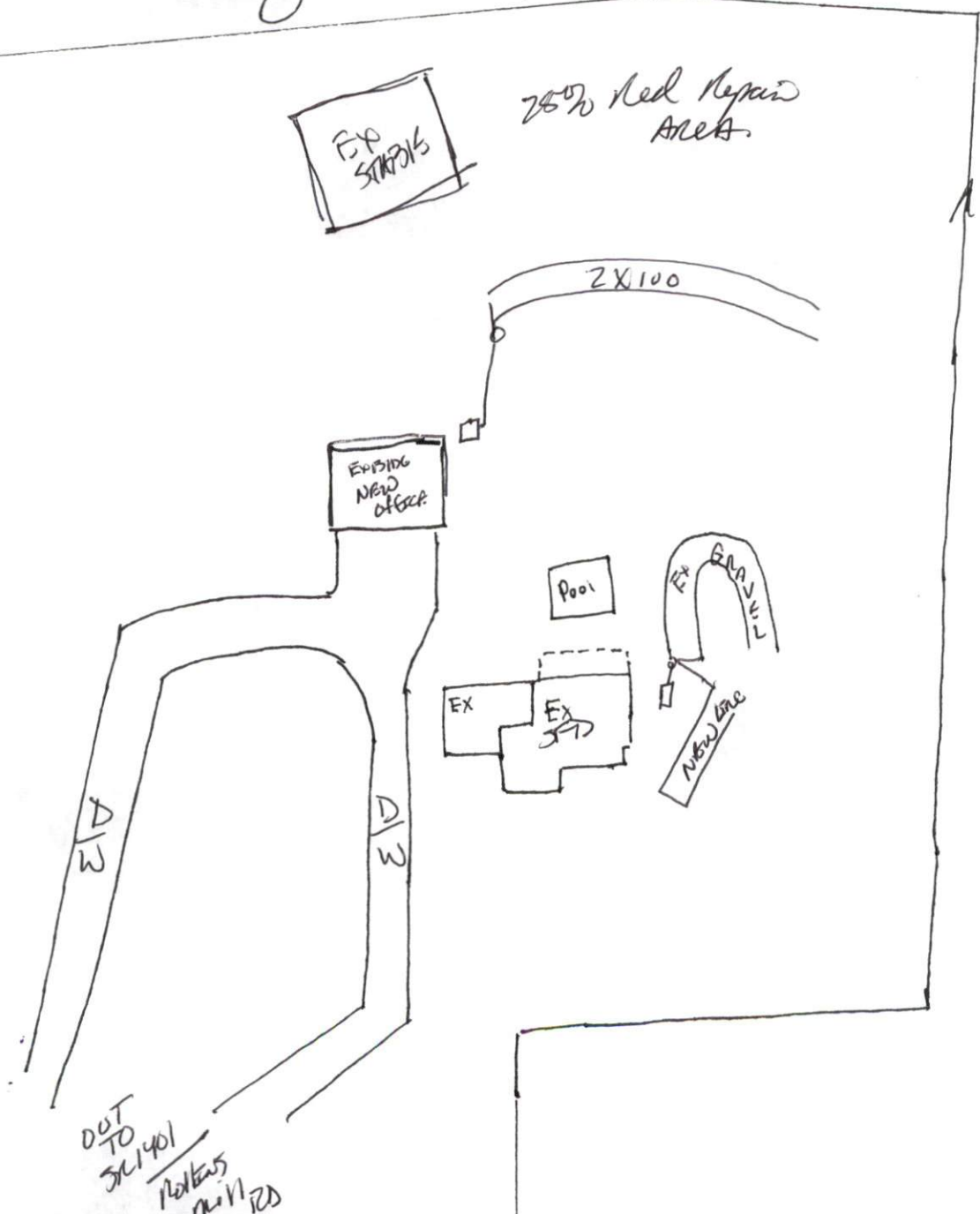

This drawing is for illustrative purposes only. System installation must meet all pertinent laws, rules, and regulations.