

HARNETT DEPARTMENT OF PUBLIC HEALTH PERMIT
TO CONSTRUCT A DRINKING WATER SUPPLY WELL

PIN #: 956398-1574

Parcel #:

Application #: BRES2305-0014

Subdivision:

Lot #:

Applicant Name: Kenneth Woodside
Address: 341 Pine Oak (SR 2612)

Type of Facility Served by Well: 28'x58' DWMH

Sewage System: 25% reduction

Permit Conditions: Well to be drilled in Well Area

General Permit Conditions:

- Drinking water supply well construction must meet 15A NCAC 02C.100 rules
- The permitted drinking water supply well shall be located in accordance with the **SITE PLAN**
- **ANY ALTERATION** of the site of the site (including location of structures and appurtenance) or modification in use of the well, may subject this Permit to revocation

Authorized State Agent Mohammed REHS Date 11-18-25 Expiration Date 11-18-30
 * Construction Authorization Expires within five years of issue

Grouting Inspection Witnessed _____ Date _____

Grouting self-certified by driller GW-1 provided? Yes No

See attachment for construction sketch

WELL CERTIFICATE OF COMPLETION

Date: _____ Application #: BRES2305-0014 Well Contractor: _____

Applicant Name: Kenneth Woodside
Address: 341 Pine Oak (SR 2612)
Directions to Site: _____

Use of Well: _____ Date Drilled: _____ Total Depth: _____ Replacement Well? Yes No
 Static Water Level: _____ Top of Casing is _____ in. above surface. Yield: _____ gpm at _____ ft.
 Disinfection: Type _____ Amount _____

<u>Water Zone (depth)</u>	<u>Casing</u>	<u>Grout</u>
From _____ To _____	From _____ To _____	From _____ To _____
From _____ To _____	Diameter: _____ Material: _____ Thickness: _____	Material: _____ Method: _____
From _____ To _____	From _____ To _____	From _____ To _____
	Diameter: _____ Material: _____ Thickness: _____	Material: _____ Method: _____
	From _____ To _____	From _____ To _____
	Diameter: _____ Material: _____ Thickness: _____	Material: _____ Method: _____

Inspector: _____ On Hold Date: _____ Release Date: _____

Remarks: _____

Well Head Information

Casing Height: 14 (above finished grade) Access Port: Vent Stack:
 Well ID Tag: Pump ID Tag: Sampling Tap: Backflow Preventer:
 Sample Taken? Yes No Well Head properly sealed:

Remarks: _____

Authorized State Agent Mohammed REHS Date 2-5-26

See Attachment for completion sketch

Application #:

BRES2305-004

Applicant Name:

Kenneth Wood

Subdivision:

Lot #:

Well Construction Sketch

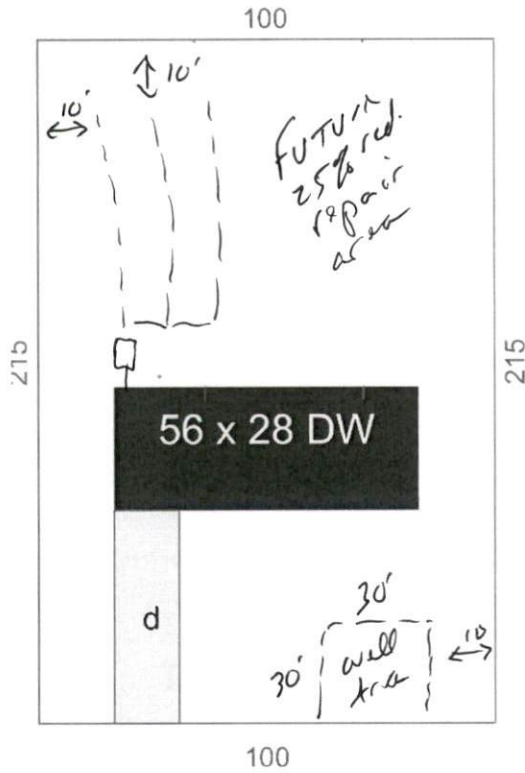

Well Completion Sketch

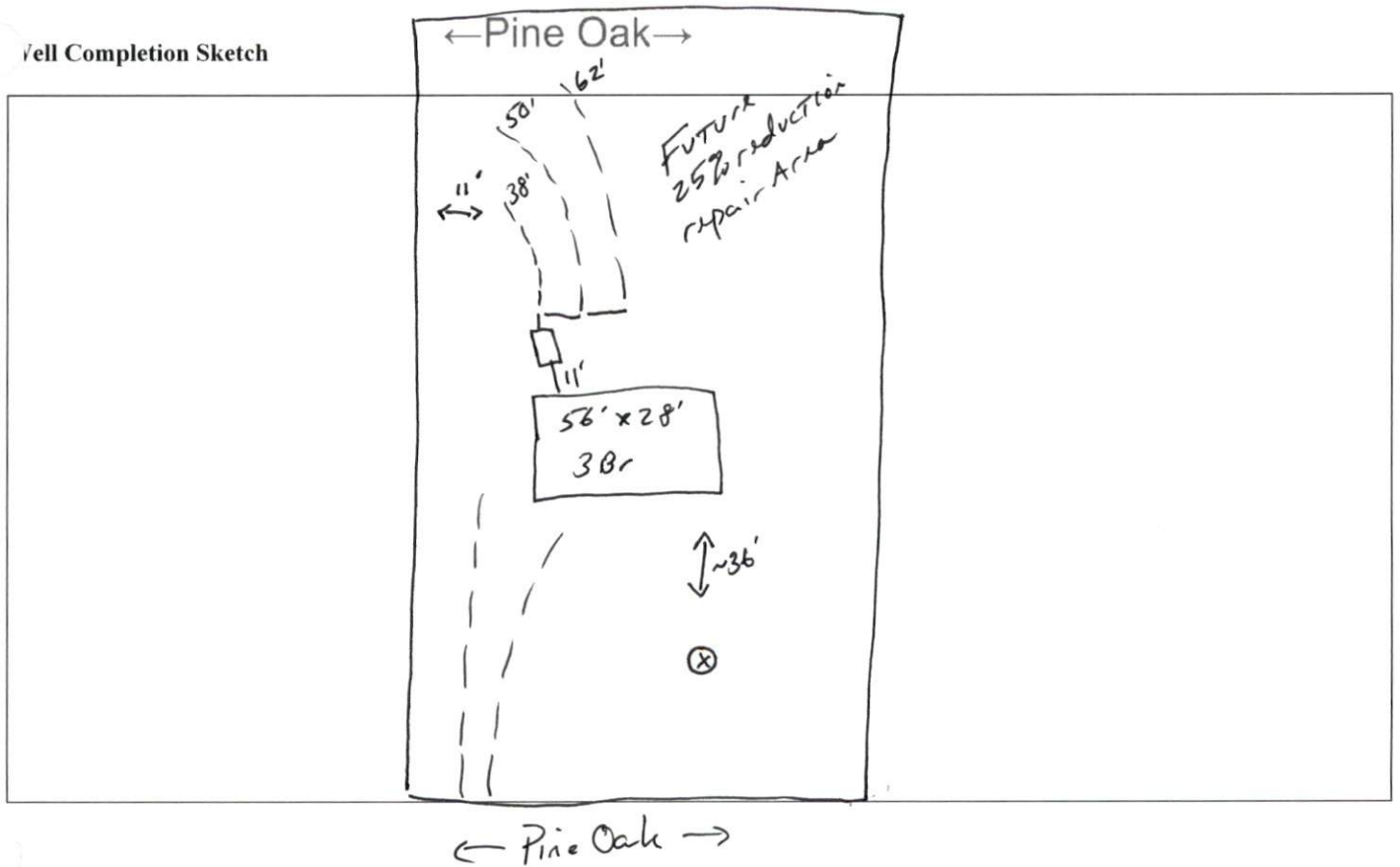

WELL CONSTRUCTION RECORD (GW-1)

1. Well Contractor Information:

Felton Jacobs
 Well Contractor Name
 2765-A
 Well Contractor Certification Number
 Upront Well Company of the Carolinas
 Company Name

2. Well Construction Permit #:
Use all applicable well construction permits i.e. DCR, County, State, Variance, etc.

3. Well Use (check well use):

- Water Supply Well:**
 Agricultural Municipal/Public
 Geothermal (Heating/Cooling Supply) Residential Water Supply (single)
 Industrial/Commercial Residential Water Supply (shared)
 Irrigation Wells > 100,000 GPD
- Non-Water Supply Well:**
 Monitoring Recovery
 Injection Well:
 Aquifer Recharge Groundwater Remediation
 Aquifer Storage and Recovery Salinity Barrier
 Aquifer Test Stormwater Drainage
 Experimental Technology Subsidence Control
 Geothermal (Closed Loop) Tracer
 Geothermal (Heating/Cooling Return) Other (explain under #21 Remarks)

4. Date Well(s) Completed: 1/2/26 Well ID# _____

5a. Well Location:
TED WOODSIDES
 Name
3911 PINE OAK CAMERON
 Facility ID# (if applicable)
HARNETT
 Property Address, City, and Zip
 County Parcel Identification No. (PIN)

5b. Latitude and longitude in degrees/minutes/seconds or decimal degrees:
(if well field, one lat/long is sufficient)
 _____ N _____ W

6. Is/are the well(s): Permanent or Temporary

7. Is this a repair to an existing well: Yes or No
If this is a repair, fill out known well construction information and explain the nature of the repair under #21 remarks section or on the back of this form.

8. For Geoprobe/DPT or Closed-Loop Geothermal Wells having the same construction, only 1 GW-1 is needed. Indicate TOTAL NUMBER of wells drilled: _____

9. Total well depth below land surface: 405 (ft.)
For multiple wells list all depths if different (example: 10,200 and 20,100')

10. Static water level below top of casing: 25 (ft.)
If water level is above casing, use " "

11. Borehole diameter: 6 (in.)

12. Well construction method: Rotary
(i.e. auger, rotary, cable, direct push, etc.)

FOR WATER SUPPLY WELLS ONLY:
 13a. Yield (gpm): 2 Method of test: Blow
 13b. Disinfection type: HTH Amount: 1 lb.

For Internal Use Only:

14. WATER ZONES					
FROM	TO	DESCRIPTION			
310'	315'	1 GPM			
380'	385'	1 GPM			
15. OUTER CASING (for multi-cased wells) OR LINER (if applicable)					
FROM	TO	DIAMETER	THICKNESS	MATERIAL	
0'	220'	6"	.188"	Galvanized	
16. INNER CASING OR TUBING (geothermal closed-loop)					
FROM	TO	DIAMETER	THICKNESS	MATERIAL	
17. SCREEN					
FROM	TO	DIAMETER	SLOT SIZE	THICKNESS	MATERIAL
18. GROUT					
FROM	TO	MATERIAL	EMPLACEMENT METHOD & AMOUNT		
0'	20'	Hole Plug	Poured		
19. SAND/GRAVEL PACK (if applicable)					
FROM	TO	MATERIAL	EMPLACEMENT METHOD		
20. DRILLING LOG (attach additional sheets if necessary)					
FROM	TO	DESCRIBE STRATA (color, hardness, wet/dry type, grain size, etc.)			
0'	3'	Topsoil			
3'	20'	Clay			
20'	220'	Sand			
220'	405'	Granite			
21. REMARKS					
Used Steel Hardened Drive Shoe					

22. Certification:
 Signature of Certified Well Contractor: Felton Jacobs
 Date: 1/2/26

By signing this form, I hereby certify that the well(s) was (were) constructed in accordance with 13A NCAC 62C .0100 or 13A NCAC 62C .0200 Well Construction Standards and that a copy of this record has been provided to the well owner.

23. Site diagram or additional well details:
You may use the back of this page to provide additional well construction info (add "See Over" in Remarks Box). You may also attach additional pages if necessary.

24. SUBMITTAL INSTRUCTIONS
 Submit this GW-1 within 30 days of well completion per the following:

24a. For All Wells: Original form to Division of Water Resources (DWR), Information Processing Unit, 1617 MSC, Raleigh, NC 27699-1617

24b. For Injection Wells: Copy to DWR, Underground Injection Control (UIC) Program, 1636 MSC, Raleigh, NC 27699-1636

24c. For Water Supply and Open-Loop Geothermal Return Wells: Copy to the county environmental health department of the county where installed

24d. For Water Wells producing over 100,000 GPD: Copy to DWR, CCPCUA Permit Program, 1611 MSC, Raleigh, NC 27699-1611