

PLOT PLAN



03/30/2023

NOTE:
THIS SURVEY IS OF AN EXISTING PARCEL OR PARCELS
OF LAND AND DOES NOT CREATE A NEW STREET OR
CHANGE AN EXISTING STREET.

SURVEYOR _____

NOTE:
THIS PROPERTY IS SUBJECT TO ANY AND ALL
EASEMENTS, RIGHT OF WAYS, AND AGREEMENTS
OF RECORD PRIOR TO THIS PLAT.

NOTES:
THIS SURVEY IS OF A PARTIAL SURVEY OF THE
CHRISTOPHER A. RUSSELLO PROPERTY AS RECORDED
IN D.B. 4164, PG. 2352 HARNETT COUNTY REGISTRY.

ALL AREAS BY COORDINATE METHOD

PROPERTY ZONED RA-20R

PROPERTY IN WATERSHED WS-III HQW-P

PID # 099564 0064 09

PIN # 9564-83-2478.000

CHRISTOPHER A. RUSSELLO
D.B. 4164, PG. 2352
TRACT 10
PLAT # 2018-359
22.20 AC. BY DEED

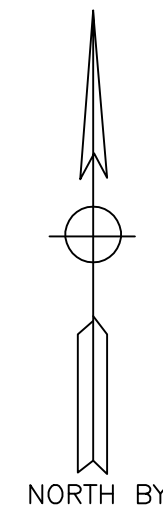
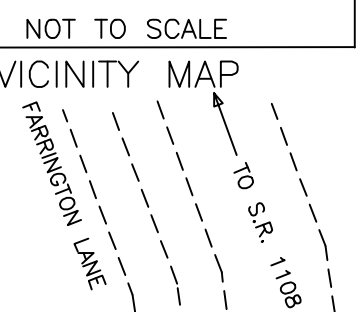

LOT 7
PLAT # 2018-359

LOT 2
PLAT # 2018-359

LOT 8
PLAT # 2018-359

LOT 1
PLAT # 2018-359

LOT 9
PLAT # 2018-359

MINIMUM BUILDING SETBACKS
FRONT - 35'
SIDELINES - 10'
SIDE STREET - 20'
REAR - 25'

EXISTING 30' PRIVATE
ACCESS EASEMENT
PLAT # 2018-359

PROPOSED
DWELLING

PROPOSED
DRIVE

MINIMUM BUILDING SETBACK LINES

CONTROL CR.

CONTROL CR.

- LEGEND:
- EIP-EXISTING IRON PIPE OR IRON ROD
 - NIP-NEW IRON PIPE OR IRON ROD
 - NRRS-NEW RAILROAD SPIKE
 - ERRS-EXISTING RAILROAD SPIKE
 - NPK-NEW P.K. NAIL
 - EPK-EXISTING P.K. NAIL
 - ECM-EXISTING CONCRETE MONUMENT
 - C/L-CENTER LINE
 - PP-POWER POLE
 - LP-LIGHT POLE
 - R/W-RIGHT OF WAY
 - CP-CALCULATED POINT
 - E- ELECTRICITY
 - * - GROUND ELEVATION
 - X-X-X- FENCE

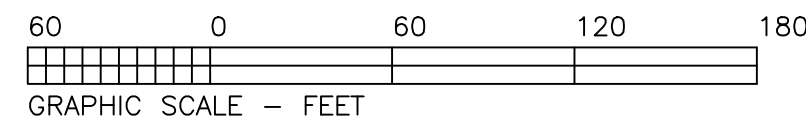

THIS PROPERTY IS NOT IN A SPECIAL
FLOOD HAZARD AREA ACCORDING TO
MAP NUMBER: 3710956400J
OF THE FEDERAL EMERGENCY MANAGEMENT
AGENCY. EFF. DATE: 10/03/2006

TOWNSHIP JOHNSONVILLE	COUNTY HARNETT	STATE NC
SURVEY FOR (OWNER) CHRISTOPHER A. RUSSELLO 10 FARRINGTON LANE CAMERON, NC 28326		DATE: 03/20/2023
		SCALE: 1"=60'
		PROJECT: 4223
MELVIN A. GRAHAM, PLS. 3679 NICHOLSON ROAD CAMERON, NC 28326 PHONE(919)499-6174		REVISION: 04/13/2023 ADD DRIVEWAY