

THIS SURVEY WAS PREPARED BY BATEMAN CIVIL SURVEY CO., UNDER THE SUPERVISION OF STEVEN F. CARSON, P.L.S. IT HAS BEEN PREPARED FOR LAYOUT AND PERMITTING PURPOSES ONLY. ALL LINES SHOWN WERE TAKEN FROM EXISTING FIELD INSTRUMENTS, EXISTING PLATS OR PLATS OF PUBLIC RECORD, AND INFORMATION SUPPLIED TO THE SURVEYOR BY THE CLIENT. ALL BEARINGS ARE HORIZONTAL GROUND DISTANCES AND ALL BEARINGS ARE IN THE STATE PLANE COORDINATE SYSTEM UNLESS OTHERWISE NOTED. THIS SURVEY IS NOT FOR RECORDATION AND SHOULD BE REVIEWED BY A LOCAL AGENCY FOR COMPLIANCE WITH ANY APPLICABLE LAND USE REGULATIONS. ALL RIGHTS AND ALL EASEMENTS, RIGHTS-OF-WAY, BUFFERS, SETBACKS, ETC. REFERENCED IN THIS BLOCK. NO INVESTIGATION INTO THE EXISTENCE OF JURISDICTIONAL WETLANDS OR OTHER FEATURES PERFORMED BY THIS FIRM. THIS FIRM HAS MADE NO INVESTIGATION OR INDEPENDENT SEARCH FOR EASEMENTS, ENCUMBRANCES, RESTRICTIVE COVENANTS, OWNERSHIP OR ANY OTHER FACTS THAT AN ACCURATE AND CURRENT TITLE REPORT SHOULD DISCLOSE. THIS SURVEY IS IN ACCORDANCE WITH THE NATIONAL FLOOD INSURANCE PROGRAM ACT OF 1968, AS AMENDED, DATED OCTOBER 03, 2006. ALL UTILITY EASEMENTS LIES PARALLEL TO THE ROADWAY RIGHT OF WAY 4' SIDE, EXCEPT OPEN SPACE 4'.

ARC/LS	LENGTH	CHORD DIRECTION	CHORD
50.00°	50.00'	N07°58'00"W	46.74'

UGL1111E
 Engin
 1834 Redwood Ave
 www.ugl.com

VICINITY
 (FROM S)

LEGEND

- PG = PORCH
- P = PATIO
- SP = RECESSED PORCH OR PATIO
- CP = CEMENT PORCH OR PATIO
- WC = WOOD DECK
- SW = SIDEWALK
- DW = DRIVE DRIVEWAY
- W = COMPLETED POOL
- IP = IRON PIPE FOUND
- IR = IRON PIPE, BUT EMPTY
- W = WATER METER
- CO = CLEANOUT
- AO = AIR COND/ROOFER
- SE = SELECTED MARK
- CS = CABLE BOX
- TR = TELEPHONE/POSTAL
- CS = GUARD POST
- VI = FIRE HYDRANT
- FI = FIRE HYDRANT
- W = WATER VALVE
- CS = SOBER MANHOLE
- W = FIRE HYDRANT
- TR = TRASH RECEPTACLE

BUILDING SETBACKS

- FRONT = 30'
- REAR = 25'
- EDGE OF SIDE = 5'

CSK

FINAL S
 FC
 CORY H

BIRCHWOOD GF
 29 DEKALB COUNTY, GA

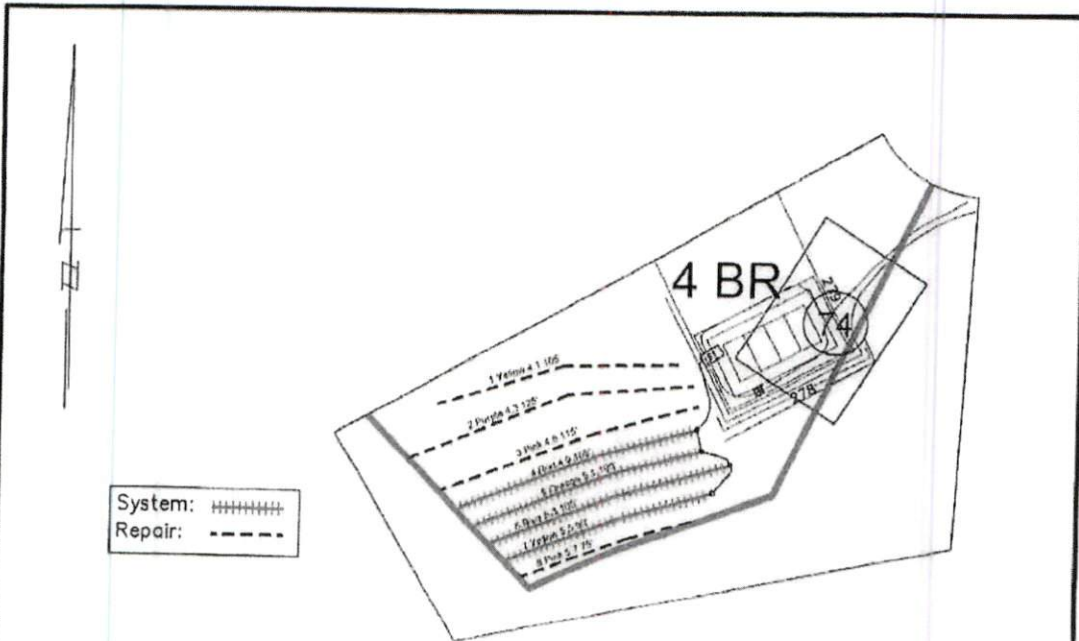

- *Keep tanks and drain lines 10' from property lines.
- *Not a survey.
- *Not a guarantee of a septic permit.
- *Keep supply lines >5' from property lines.
- *Some lines are flagged longer in the field than lengths indicate.
- *No grading septic area.

System: Gravity to Serial Dist. Lines: 4-7, (400') Accepted Status System 0.4 Soil LTAR 18" Trench Bottom
Repair: Pressure Manifold Lines: 5-9, (420') Accepted Status System 0.4 Soil LTAR 18" Trench Bottom

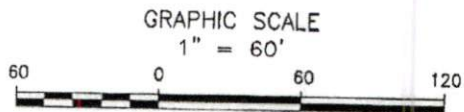

Central Carolina Soil Consulting, PLLC
 1900 South Main Street, Suite 110
 Wake Forest, North Carolina 27587
 Phone (919)569-6704 Fax (919)569-6703

4-Bedroom Septic Layout
 Lot 74, Birchwood Subdivision
 Harnett County, North Carolina

Job# : 3753
Drawn By : LW
Date : 07/02/2021
Revision: