

CENTRAL PERMITTING@HARNETT.ORG

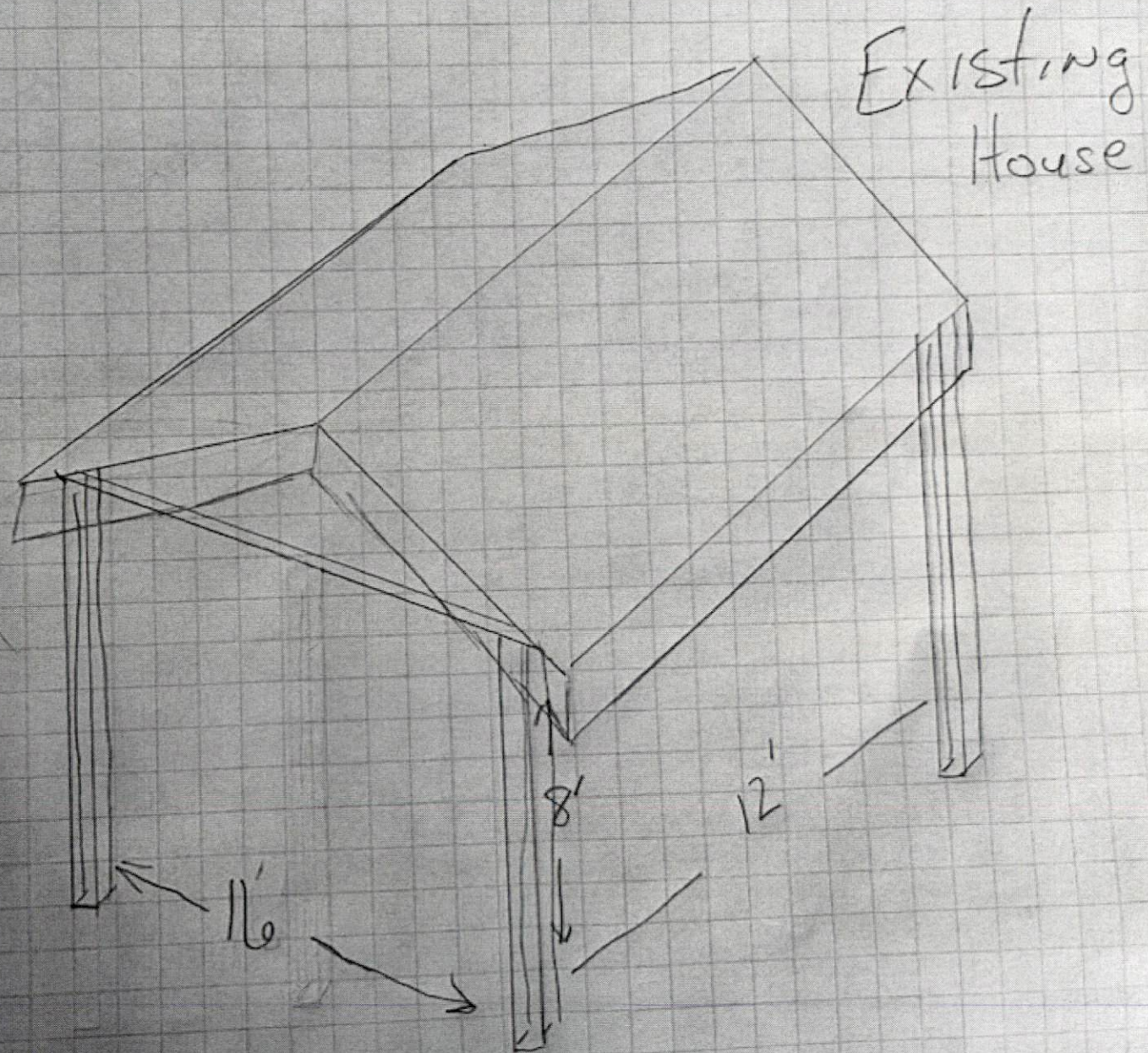

Existing House

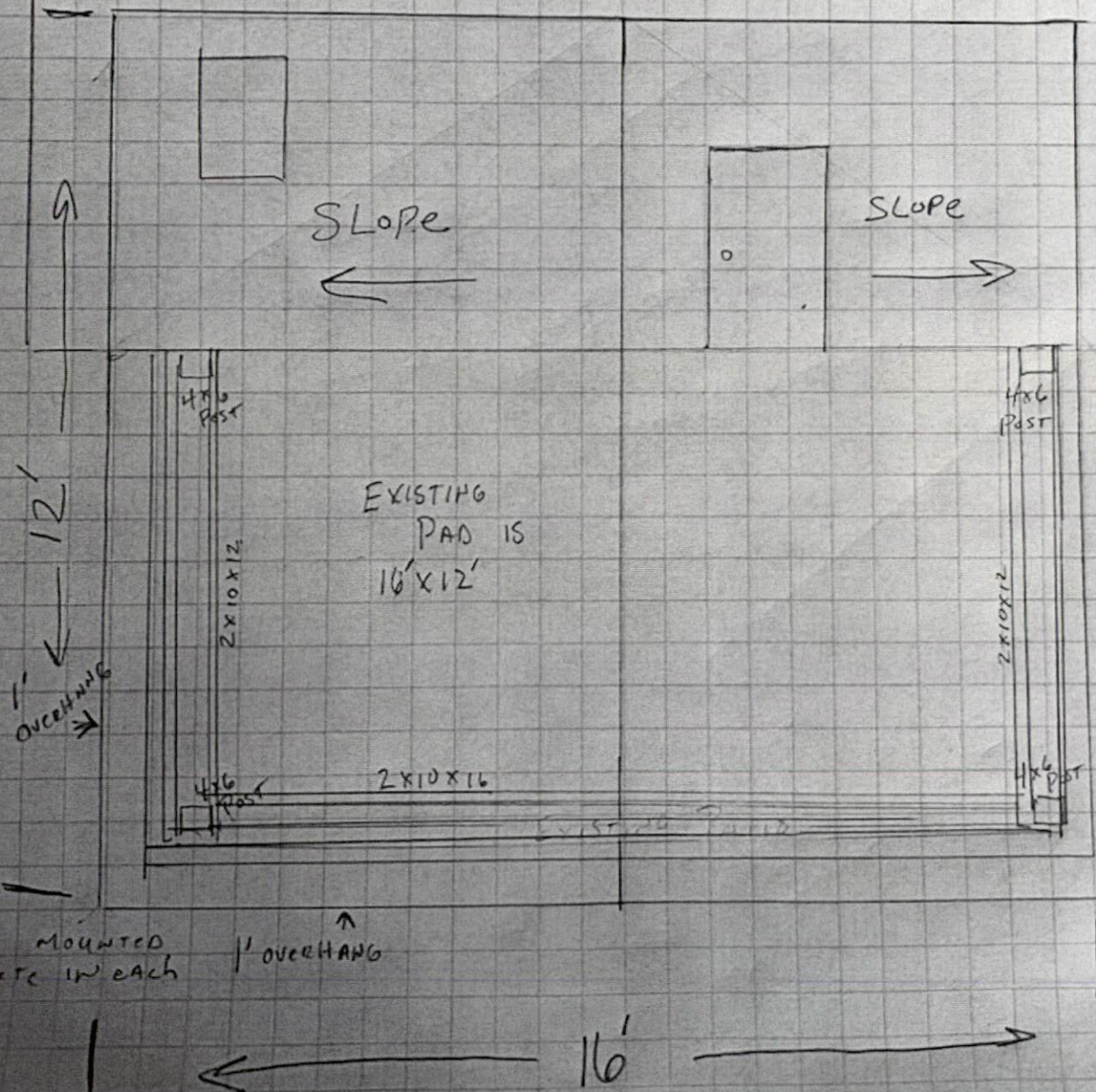

SLOPE

SLOPE

Roof Rafters
Are 2' on Center

EXISTING
PAD IS
16' X 12'

12'

1' OVERHANG

2x10x16

2x10x12

2x10x12

1' OVERHANG

16'

POST ARE MOUNTED
TO CONCRETE IN EACH
CORNER

1' OVERHANG