

THE LINE TO THE INTERSECTION OF
ATKINS RD. & MOONLIGHT DR.
N 16°38'56"W
332.38'

(53)

FISH BROTHERS, INC.
D.B. 2445 PG. 752

10' SETBACK

(1)

1.54 ACRES TO CL
1.44 ACRES TO R/W
PROPOSED SHED

CONTROL
CORNER
EIS

(51)

KENNETH HANINIK
D.B. 3293 PG. 79

CREEK

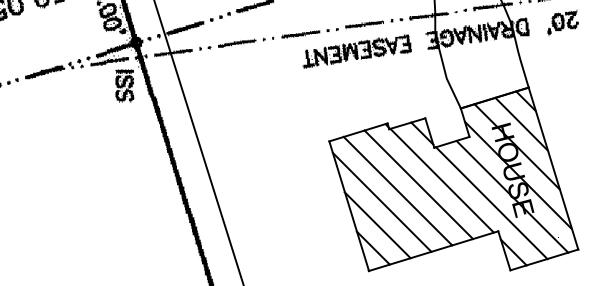

10' SETBACK

(2)

1.54 ACRES TO CL
1.44 ACRES TO R/W

SOILS LINE

SOILS LINE

RUN OF THE CREEK IS
THE PROPERTY LINE

MATTHEW
D.B. 31

(46)

