

852 Cameron Hill Rd. - Soil Evaluation

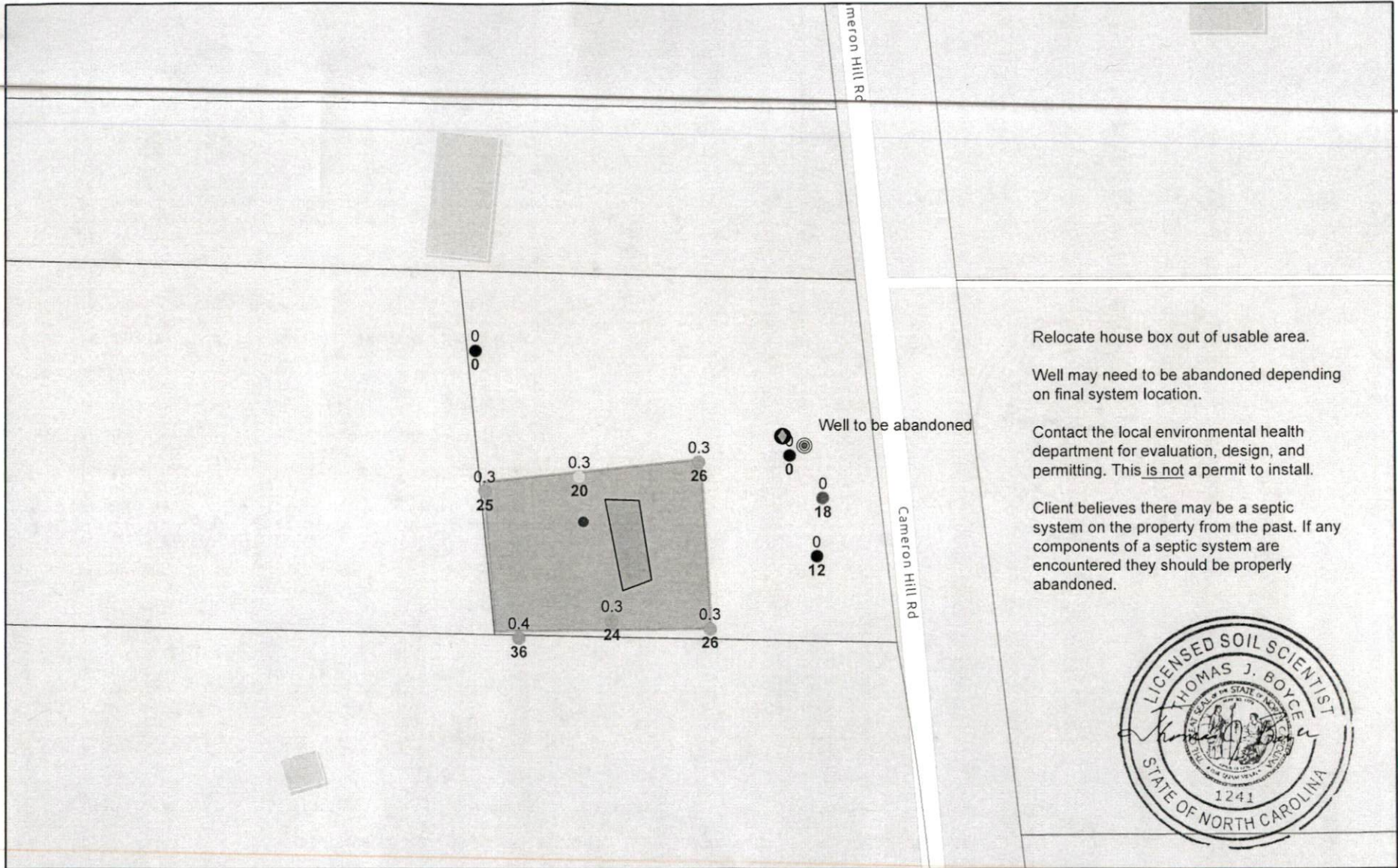

11/11/2022, 5:33:56 PM

- | | | |
|-----------------|--------------------------|-----------------------------------|
| Harnett Parcels | Low Profile PSC - Points | House Box (Needs to be relocated) |
| PSC - Borings | Out | System Area - Usable Soils Area |
| Conventional | Alternative | Usable Soils Area |
| | Point Generic | |
| | Well | |

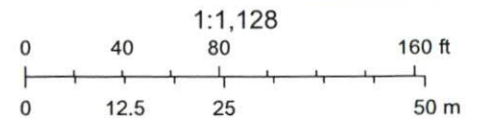

Esri Community Maps Contributors, County of Cumberland, Moore County GIS (NC), State of North Carolina DOT, © OpenStreetMap, Microsoft, Esri,



852 Cameron Hill Rd - Soil Evaluation - 11/11/22

Long	-79.1021923290371	-79.10236788589480	-79.1023853617203	-79.10197104343990	-79.10180442841260
Lat	35.26907498059040	35.26905272101890	35.26926700526220	35.26909795964940	35.26910793207930
Boring_Type	Low Profile	Conventional	Out	Conventional	Out
Slope	5-8	5-8	5-8	5-8	5-8
Landscape_Position	Linear	Linear	Linear	Linear	Linear
LTAR	0.3	0.3	0.0	0.3	0.0
Saprolite	No	No	No	No	No
Soil_Wetness	20	25	N/A	26	10
H1_Depth	6	10		16	
H1_Texture	Sandy Loam	Sandy Loam		Loamy Sand	
H1_Moist_Consistency	Loose	Loose		Loose	
H1_Structure	Gr	Gr		Gr	
H1_Mineralogy	Slightly Expansive	Slightly Expansive		Non Expansive	
H1_Stickiness	Slightly Sticky	Slightly Sticky		Non Sticky	
H1_Plasticity	Slightly Plastic	Slightly Plastic		Non Plastic	
Add_Horizon_2					
H2_Texture	Sandy Clay	Sandy Clay		SC Loam	
H2_Moist_Consistency	Friable	Friable		Friable	
H2_Depth	20.0	25.0		26.0	
H2_Structure	SBK	SBK		SBK	
H2_Mineralogy	Slightly Expansive	Slightly Expansive		Slightly Expansive	
H2_Stickiness	Sticky	Sticky		Sticky	
H2_Plasticity	Plastic	Plastic		Plastic	
CreationDate	2022-11-03 17:48:54	2022-11-03 17:54:31	2022-11-03 17:57:37	2022-11-03 18:04:30.000001	2022-11-03 18:07:33.000001
Usable_Depth	20	25	0	26	0





Soil Evaluation - 852 Cameron Hill 2022 (P2)

-79.10174176014170	-79.10175367719230	-79.101950748701	-79.10213223084630	-79.10230431122380
35.269043147567700	35.26895451112960	35.26884447601360	35.26885641406960	35.2688298579984
Alternative	Out	Conventional	Conventional	Conventional
5-8	5-8	5-8	5-8	5-8
Linear	Linear	Linear	Linear	Linear
0.0	0.0	0.3	0.3	0.4
No	No	No	No	No
18	12	26	24	N/A
4		10	16	18
Loamy Sand		Loamy Sand	Loamy Sand	Loamy Sand
Loose		Loose	Loose	Loose
Gr		Gr	Gr	Gr
Non Expansive		Non Expansive	Non Expansive	Non Expansive
Non Sticky		Non Sticky	Non Sticky	Non Sticky
Non Plastic		Non Plastic	Non Plastic	Non Plastic
Sandy Clay		Sandy Clay	Sandy Clay	SC Loam
Friable		Friable	Friable	V Friable
18.0		26.0	24.0	36.0
SBK		SBK	SBK	
Slightly Expansive		Slightly Expansive	Slightly Expansive	Slightly Expansive
Sticky		Sticky	Sticky	Slightly Sticky
Plastic		Plastic	Plastic	Slightly Plastic
2022-11-03 18:11:07	2022-11-03 18:14:44	2022-11-03 18:20:22.000001	2022-11-03 18:25:21	2022-11-03 18:31:59
18	12	26	24	36

