

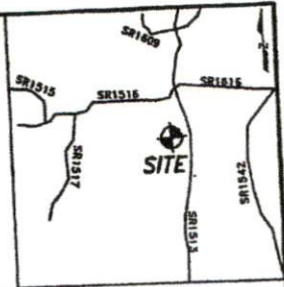

CURVE	RADIUS	LENGTH	CH. BEARING	CHORD
C1B7A	25.00'	39.40'	N45° 49' 23" W	35.50'
C1B7B	25.00'	39.27'	N45° 52' 26" W	35.36'

LEGEND

- R/W-RIGHT OF WAY
- DB-DEED BOOK / PB-PLAT BOOK
- PG-PAGE
- PROP-PROPOSED
- SF-SQUARE FEET
- AC-ACRE(S)
- CONC-CONCRETE
- ESMT-EASEMENT
- PL-PROPERTY LINE
- AG-ABOVE GROUND
- BG-BELOW GROUND
- (F)-FIELD MEASUREMENT
- (R)-RECORDED MEASUREMENT
- EIR-EXISTING IRON REBAR
- SURVEYED LINE
- - -EASEMENT LINE
- LINE NOT SURVEYED



Vicinity Map
(Not to Scale)

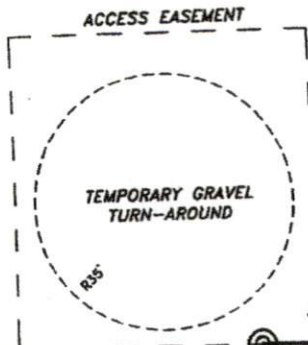

1
N/T
COT L. BROADWELL & WIFE
CAROLYN S. BROADWELL
DB 1384, PG 379
PB F, PG 342-A
DB 2017, PG 343

S 89°15'05" W 100.09' (F)
S 89°07'34" W 101.00' (R)

42
SOUTH CREEK
PB 2018, PG 274

40
SOUTH CREEK
PB 2018, PG 274

INDIGO STREET
50' R/W (PUBLIC & UTILITY ACCESS)

BAYVIEW ROAD
50' R/W (PUBLIC & UTILITY ACCESS)

FOUNDATION SURVEY

PROPERTY OF: RONALD & CHRISTA DUFFER
ADDRESS: BAYVIEW ROAD
CITY: NEAR LILLINGTON, NC
COUNTY: HARNETT
NC PIN: 0661-70-3579.000

TOWNSHIP: NEILLS CREEK
DATE: MAY 7, 2019
SCALE: 1" = 40'
REFERENCE: LOT 41
SOUTH CREEK
SUBDIVISION
PB 2018 PG 274

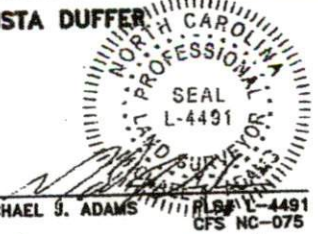

MICHAEL S. ADAMS
L-4491
CFS NC-075

MINIMUM SETBACKS:
35'-FRONT
10'-SIDE
25'-REAR

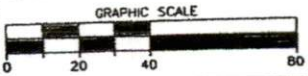

M.A.P.S. SURVEYING, INC.
C-2588
1401 MORGANTON ROAD
FAYETTEVILLE, NC 28305
PHN: (910)484-6432
MAPS@MAPSSURVEYING.COM

DRAWN BY: KA

NOTES

I CERTIFY THAT THIS MAP WAS DRAWN UNDER MY SUPERVISION FROM AN ACTUAL SURVEY MADE UNDER MY SUPERVISION, DEED DESCRIPTION RECORDED IN PB 2018, PG 274, THAT THE BOUNDARIES NOT SURVEYED ARE INDICATED AS DRAWN FROM INFORMATION IN PB 2018, PG 274; THAT THE RATIO OF PRECISION OR POSITIONAL ACCURACY IS GREATER THAN 1:10,000; AND THAT THIS MAP MEETS THE REQUIREMENTS OF THE STANDARDS OF PRACTICE FOR LAND SURVEYING IN NORTH CAROLINA (21 NCAC 58.1600). THIS MAP IS NOT DRAWN IN ACCORDANCE WITH GS 47-30, THIS 7TH DAY OF MAY, 2019.