

Foundation Plan

Original house

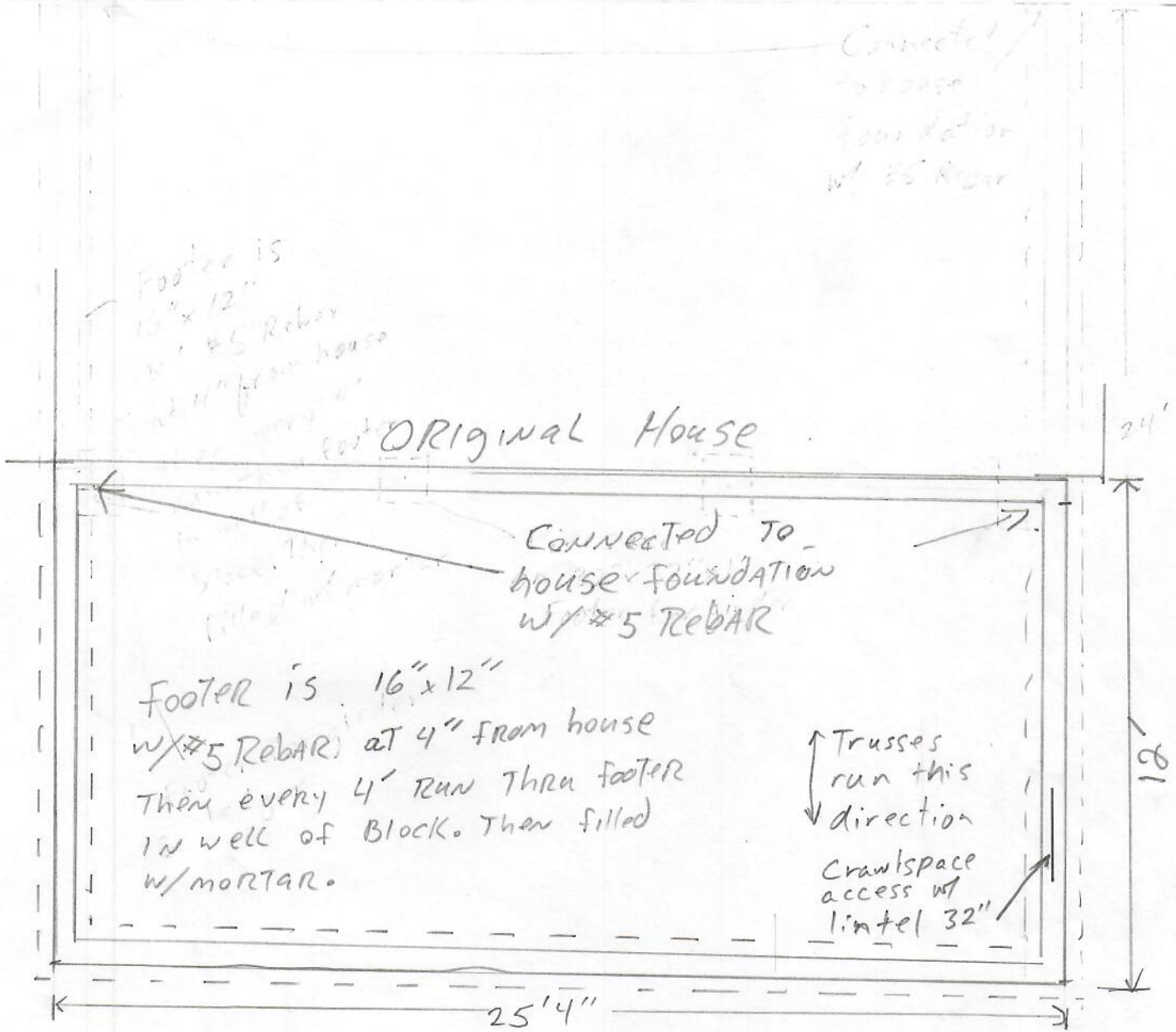

- L-anchor bolts mortared into block at 1' from corners, then every 6' at least, w/ threads exposed at least 3". Bolts are placed at least 4" from outside wall to provide space for a double band
- Foundation wall is 16"x8" block w/ Type-5 mortar

Robben Kadish
589 Rainey Drive
Spring Lake, NC 28390

Scale $\frac{1}{4}'' = 1'$