

Harnett County Department of Public Health Improvement Permit

A building permit cannot be issued with only an Improvement Permit

ISSUED TO: James W Walker PROPERTY LOCATION 511500 Bethel Church RD
 NEW REPAIR EXPANSION SUBDIVISION _____ LOT # _____
 Type of Structure DW m H Site Improvements required prior to Construction Authorization Issuance: _____
 Proposed Wastewater System Type: 25% REDUCTION
 Projected Daily Flow: 480 360 GPD
 Number of bedrooms: 3 Number of Occupants: 8 max
 Basement Yes No
 Pump Required: Yes No May be required based on final location and elevations of facilities
 Type of Water Supply Community Public Well Distance from well: 50' feet Permit valid for: Five years
 Permit conditions: _____ No expiration

Authorized State Agent: James E. Marshon Date: 4-3-23 ~~11-2-22~~ ~~10-15-22~~ SEE ATTACHED SITE SKETCH

The issuance of this permit by the Health Department in no way guarantees the issuance of other permits. The permit holder is responsible for checking with appropriate governing bodies in meeting their requirements. This site is subject to revocation if the site plan, plat, or the intended use changes. The Improvement Permit shall not be affected by a change in ownership of the site. This permit is subject to compliance with the provisions of the Laws and Rules for Sewage Treatment and Disposal and to conditions of this permit.

Construction Authorization

(Required for Building Permit)

The construction and installation requirements of Rules 1950, 1952, 1954, 1955, 1956, 1957, 1958 and 1959 are incorporated by references into this permit and shall be met. Systems shall be installed in accordance with the attached system layout.

ISSUED TO: James W Walker PROPERTY LOCATION 511500 Bethel Church RD
 Facility Type: DW m H New Expansion Repair
 Basement? Yes No Basement Fixtures? Yes No
 Type of Wastewater System** 50% REDUCTION Conventional Gravel (Initial) Wastewater Flow: 480 GPD
 (See note below, if applicable)

Installation Requirements/Conditions		Number of trenches: <u>3</u> <u>100</u> (Repair)	
Septic Tank Size: <u>1200</u> gallons	Exact length of each trench: <u>22-19</u> feet	Trench Spacing: <u>7</u> feet on Center	
Pump Tank Size: _____ gallons	Trenches shall be installed on contour at a Maximum Trench Depth of: <u>22-19</u> inches (Trench bottoms shall be level to +/- 1/4" in all directions)	Soil Cover: <u>6</u> inches (Maximum soil cover shall not exceed 36" above the trench bottom)	
Pump Requirements: _____ ft. TDH vs _____ GPM		Aggregate Depth: <u>6</u> inches below pipe	
Conditions: _____		<u>2</u> inches above pipe	
		<u>12</u> inches total	

**WATER LINES (INCLUDING IRRIGATION) MUST BE 10FT. FROM ANY PART OF SEPTIC SYSTEM OR REPAIR AREA.
NO UTILITIES ALLOWED IN INITIAL OR REPAIR DRAIN FIELD AREA.**

**If applicable, I understand the system type specified is different from the type specified on the application. I accept the specifications of this permit.

Owner/Legal Representative Signature: _____ Date: _____

This Construction Authorization is subject to revocation if the site plan, plat, or the intended use changes. This Construction Authorization shall not be transferred when there is a change in ownership of the site. This Construction Authorization is subject to compliance with the provisions of the Laws and Rules for Sewage Treatment and Disposal and to the conditions of this permit. SEE ATTACHED SITE SKETCH

Authorized State Agent: James E. Marshon Date: 4-3-22 ~~11-2-22~~ ~~10-15-22~~
 Construction Authorization Expiration Date: 10-3-27 ~~11-2-27~~

Application # BCRS 2209-0039

Harnett County Department of Public Health Site Sketch

Property Location: 511500 Bethel Church RD

Issued To: James W Walker Subdivision _____ Lot # _____

Authorized State Agent: James E. Markham 2018 Date: 10-13-22
11-2-22

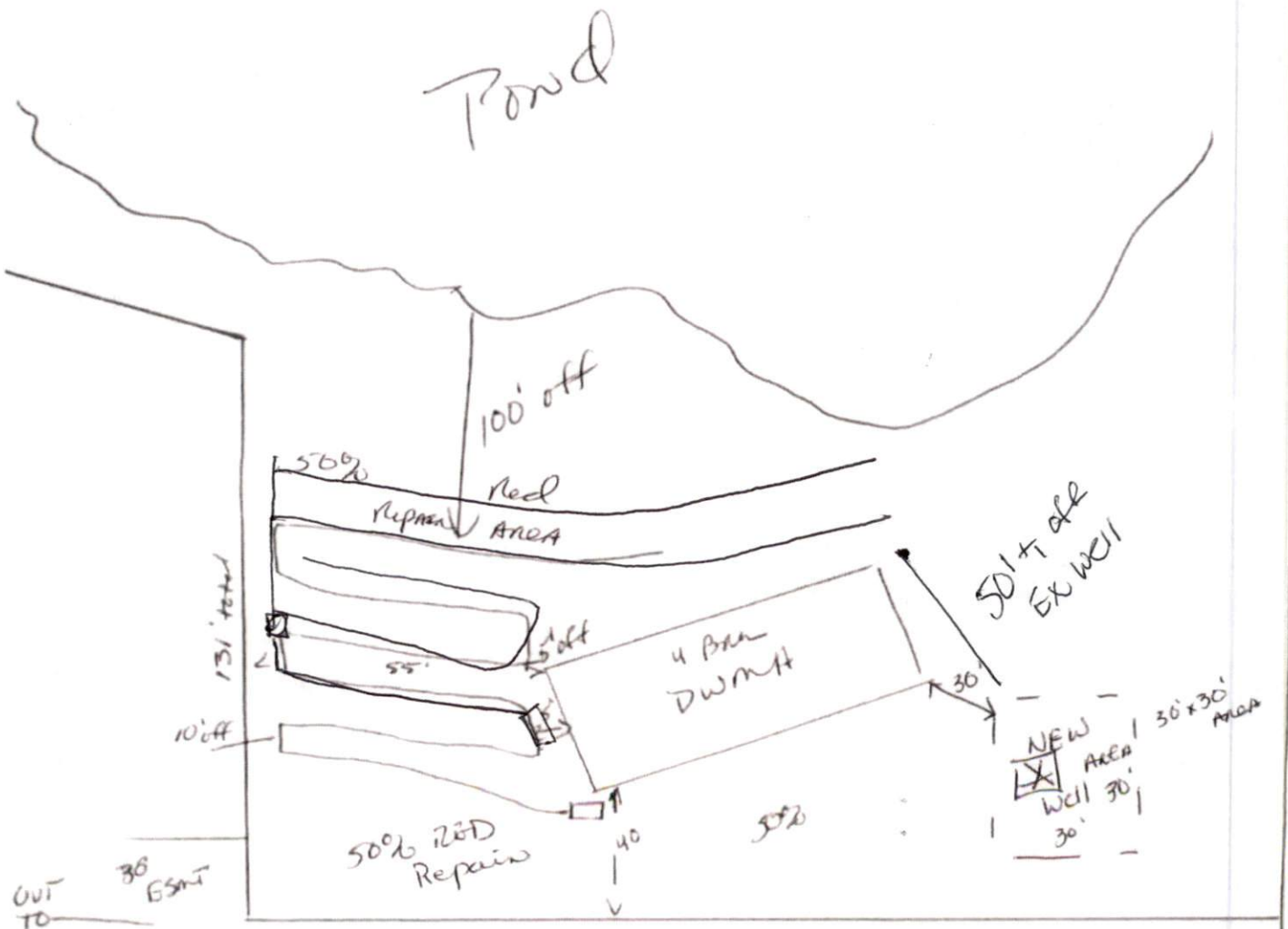

This drawing is for illustrative purposes only. System installation must meet all pertinent laws, rules, and regulations.