

Foundation Plan $\frac{1}{2}'' = 1'-0''$

** All headers shall be double 2X10 SYP unless otherwise noted.**

**All headers shall be supported in accordance with section R602.7.5
(Support For Headers) of the 2018 NC Residential Building Code**

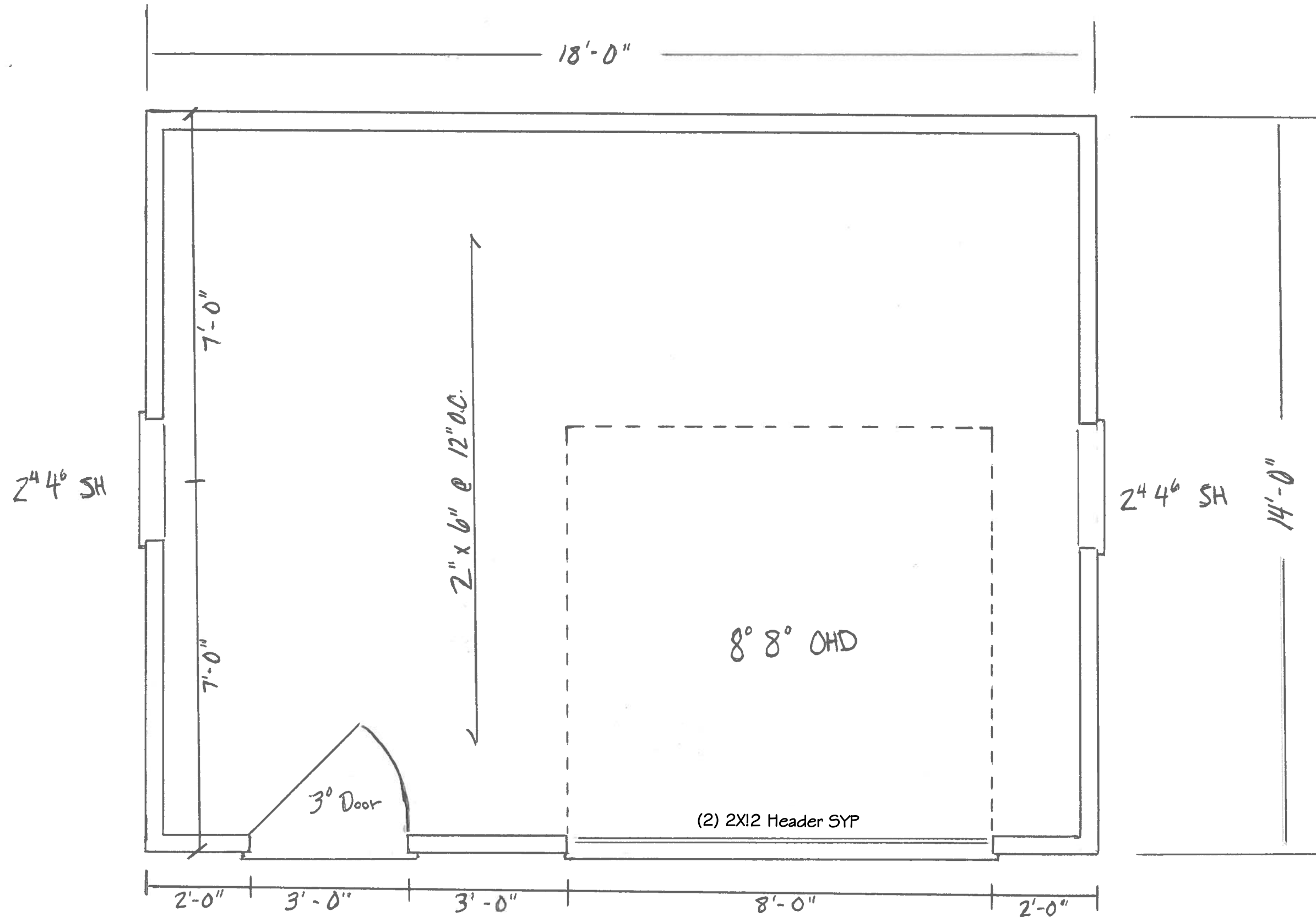

Wall & Ceiling Plan $\frac{1}{2}'' = 1'-0''$

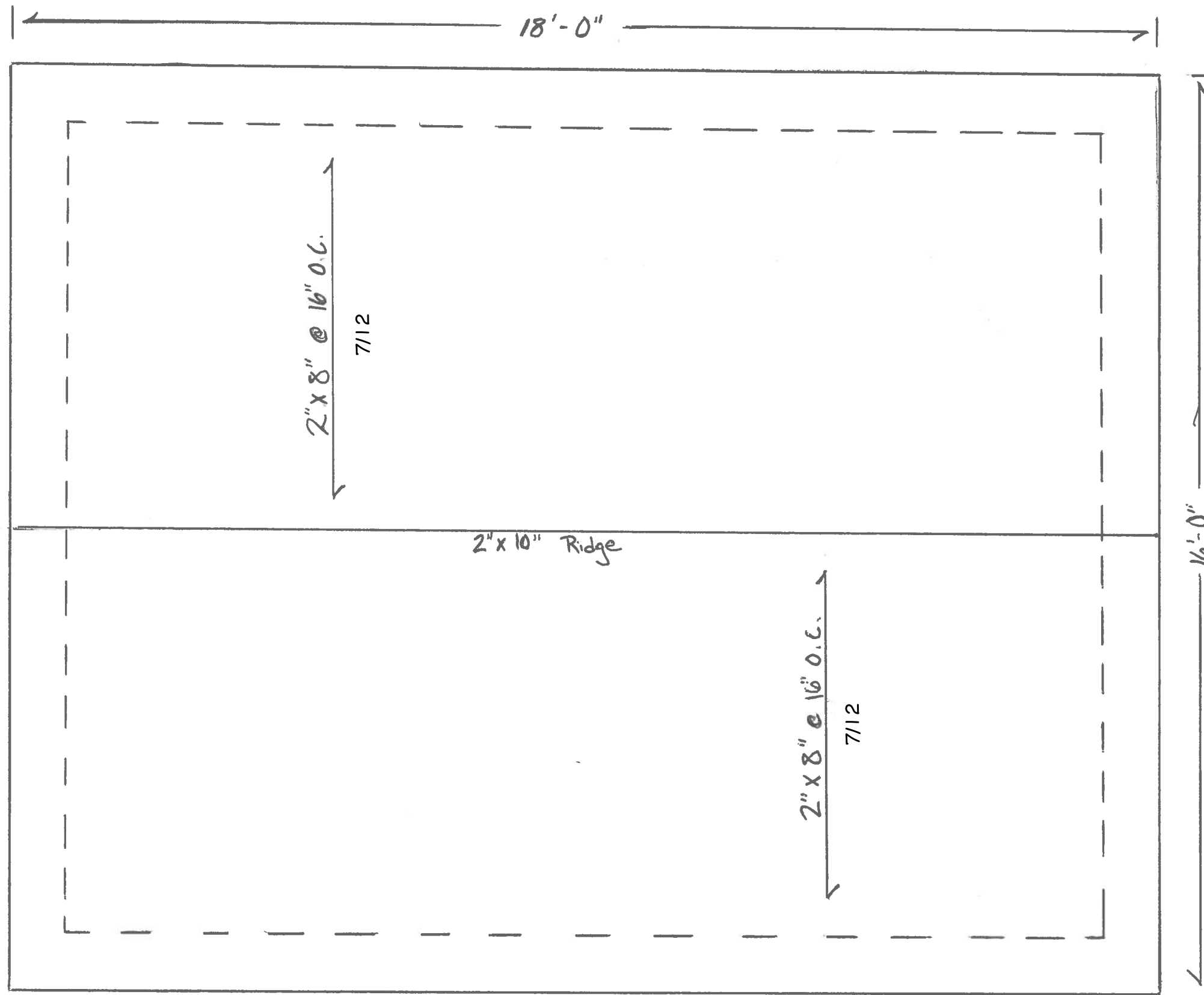

** Provide 2X4 collar ties every second rafter (TYP). **

Roof Framing Plan $\frac{1}{2}'' = 1'-0''$