

**SOIL/SITE EVALUATION**  
**for ON-SITE WASTEWATER SYSTEM**

Owner: *R. Erickson*  
 Applicant: *R. Erickson*  
 Address: *Overhills Rd*  
 Proposed Facility: *14' x 76'*  
 Location of Site:

Date Evaluated: *8-31-22*  
 Design Flow (.1949): *360 GPD* Property Size:  
 Property Recorded:

Water Supply:  Public  Individual  Well  Spring  Other  
 Evaluation Method:  Auger Boring  Pit  Cut  
 Type of Wastewater:  Sewage  Industrial Process  Mixed

P R O F I L E #	.1940 Landscape Position/ Slope %	Horizon Depth (In.)	SOIL MORPHOLOGY .1941		OTHER PROFILE FACTORS				Profile Class & LTAR
			.1941 Structure/ Texture	.1941 Consistence Mineralogy	.1942 Soil Wetness/ Color	.1943 Soil Depth (IN.)	.1956 Sapro Class	.1944 Restr Horiz	
<i>1, 2, 4</i>	<i>L</i>	<i>0-26</i>	<i>LS Gr</i>	<i>Fc/nc/np/ncp</i>	<i>10YR 7/2</i>	<i>&gt; 48"</i>	<i>-</i>	<i>-</i>	<i>PS-4 Group III</i>
	<i>2-5%</i>	<i>26-48</i>	<i>sc1 SBk</i>	<i>Fc/ls/sp/bsp</i>	<i>≥ 40"</i>				
<i>3</i>	<i>L</i>	<i>0-18</i>	<i>LS Gr</i>	<i>Fc/nc/np/ncp</i>	<i>10YR 6/2</i>	<i>≥ 48"</i>	<i>(unsuitable Topography) Drainage Ditches through entire Area</i>		
	<i>5-7%</i>	<i>18-48</i>	<i>sc1 SBk</i>	<i>Fc/ls/sp/bsp</i>	<i>≥ 30"</i>				

Description	Initial System	Repair System	Other Factors (.1946):
Available Space (.1945)	<i>✓</i>	<i>✓</i>	Site Classification (.1948): <i>PS</i>
System Type(s)	<i>Pump</i>	<i>25% med</i>	Evaluated By: <i>M. K. REW</i>
Site LTAR	<i>.4</i>	<i>.4</i>	Others Present:

COMMENTS: \_\_\_\_\_

LANDSCAPE POSITIONS	GROUP	TEXTURES	.1955 LTAR	CONSISTENCE MOIST	WET
R-RIDGE	I	S-SAND	1.2 - 0.8	VFR-VERY FRIABLE FR-FRIABLE	NS-NON-STICKY SS-SLIGHTLY STICKY
S-SHOULDER SLOPE		LS-LOAMY SAND			
L-LINEAR SLOPE	II	SL-SANDY LOAM	0.8 - 0.6	FI-FIRM VFI-VERY FIRM EFI-EXTREMELY FIRM	S-STICKY VS-VERY STICKY NP-NON-PLASTIC SP-SLIGHTLY STICKY
FS-FOOT SLOPE		L-LOAM			
N-NOSE SLOPE	III	SI-SILT	0.6 - 0.3		P-PLASTIC VP-VERY PLASTIC
H-HEAD SLOPE		SIL-SILT LOAM			
CC-CONCLAVE SLOPE		CL-CLAY LOAM			
CV-CONVEX SLOPE		SCL-SANDY CLAY LOAM			
T-TERRACE	IV	SIC-SILTY CLAY	0.4 - 0.1		
FP-FLOOD PLAN		C-CLAY SC-SANDY CLAY			

STRUCTURE

- SG-SINGLE GRAIN
- M- MASSIVE
- CR-CRUMB
- GR-GRANULAR
- SBK-SUBANGULAR BLOCKY
- ABK-ANGULAR BLOCKY
- PL-PLATY
- PR-PRISMATIC

MINERALOGY

- SLIGHTLY EXPANSIVE
- EXPANSIVE

Show profile locations and other site features (dimensions, references or benchmark, and North)

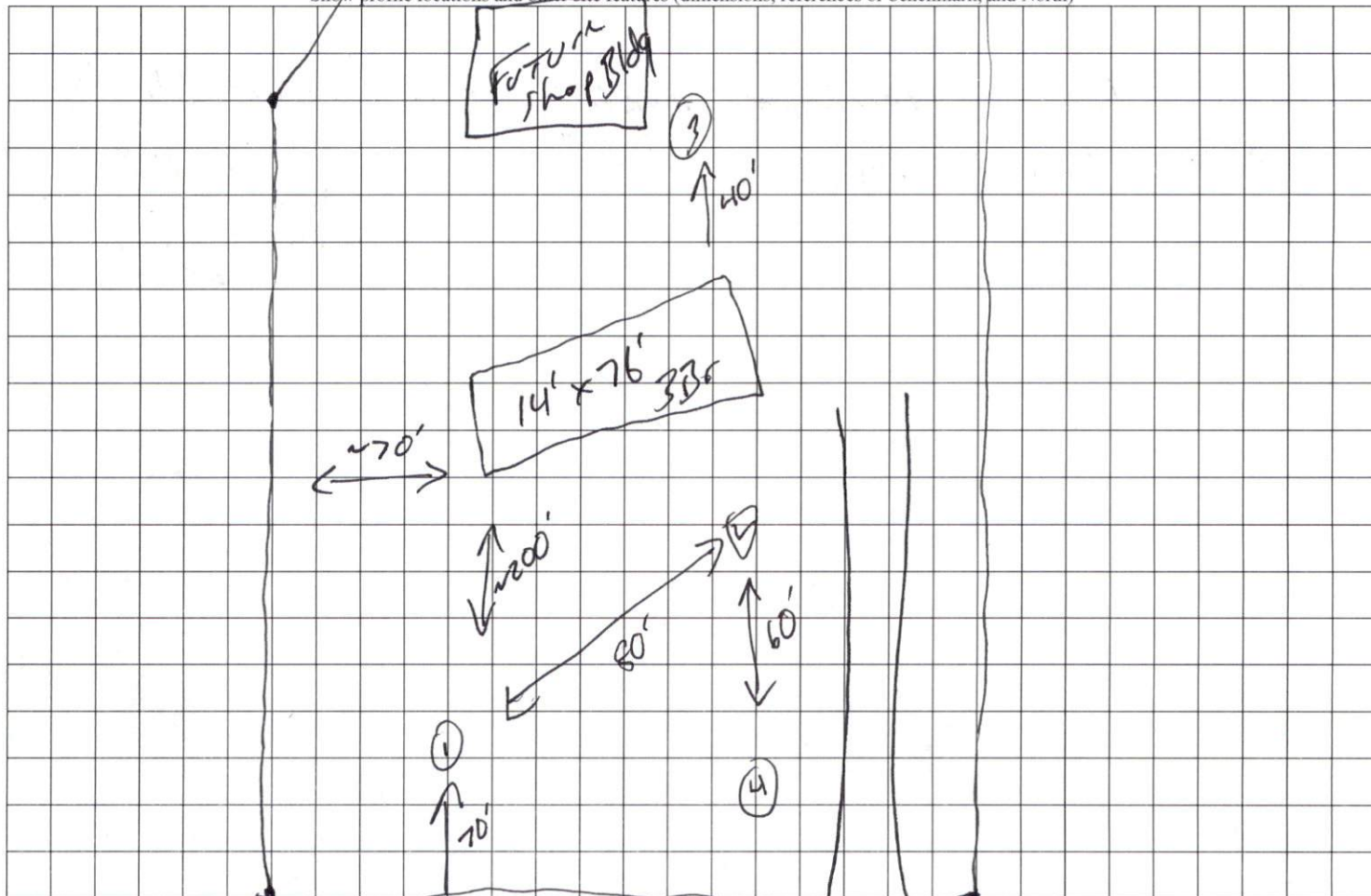

Overhills Rd