

02-5-3924

HETT COUNTY HEALTH DEPARTMENT
ENVIRONMENTAL HEALTH SECTION

No 15682

OPERATIONS PERMIT

Name: (owner) Dalton & Kristy Stokes

New Installation Septic Tank

Property Location: SR# 1516

Repairs Nitrification Line

Subdivision _____ Lot # _____

TAX ID# _____ Quadrant # _____

Contractor: Albert Gregory

Registration # _____

Basement with Plumbing: Garage:

Water Supply: Well Public Community

Distance From Well: 50 ft.

Following are the specifications for the sewage disposal system on above captioned property.

Type of system: Conventional Other Polystyrene Aggregate Trench System I w/RS-95-72

Size of tank: Septic Tank: 1000 gallons Pump Tank: _____ gallons

Subsurface Drainage Field No. of ditches 4 exact length of each ditch 100 ft. width of ditches 3 ft. depth of ditches 18 in.

French Drain: _____ Linear feet

Date: 10/2/2002

PERMIT NO. 19713

Inspected by Bryan McLean L.S.
Environmental Health Specialist

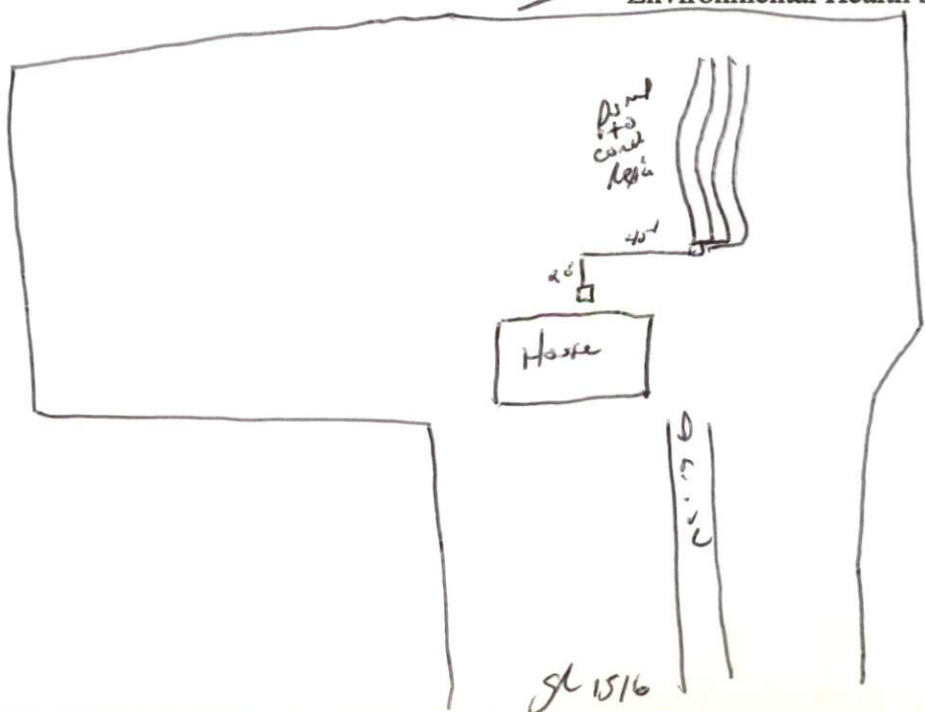

02-5-3824

IMPROVEMENT PERMIT

Be it ordained by the Harnett County Board of Health as follows: Section III, Item B. "No Person shall begin construction of any building at which a septic tank system is to be used for disposal of sewage without first obtaining a written permit from the Harnett County Health Department."

Name: (owner) Dalton & Kristyn Stacks New Installation Septic Tank
 Property Location: SR# 1516 Sher. Ft. Johnson Rd. Repairs Nitrification Line

Subdivision _____ Lot # _____

Tax ID # _____ Quadrant # _____

Number of Bedrooms Proposed: 4 Lot Size: 3.028 Ac

Basement with Plumbing: Garage:

Water Supply: Well Public Community

Distance From Well: 50 ft.

Following is the minimum specifications for sewage disposal system on above captioned property. Subject to final approval.

Type of system: Conventional Other 25% reduction system

Size of tank: Septic Tank: 1000 gallons Pump Tank: _____ gallons

Subsurface Drainage Field No. of ditches 4 exact length of each ditch 100 ft. width of ditches 3 ft. depth of ditches 18 in. max

French Drain Required: _____ Linear feet

Date: 6/2/2002

This permit is subject to revocation if site plans or intended use change.

Signed: Bryan McSwain, D.S.
Environmental Health Specialist

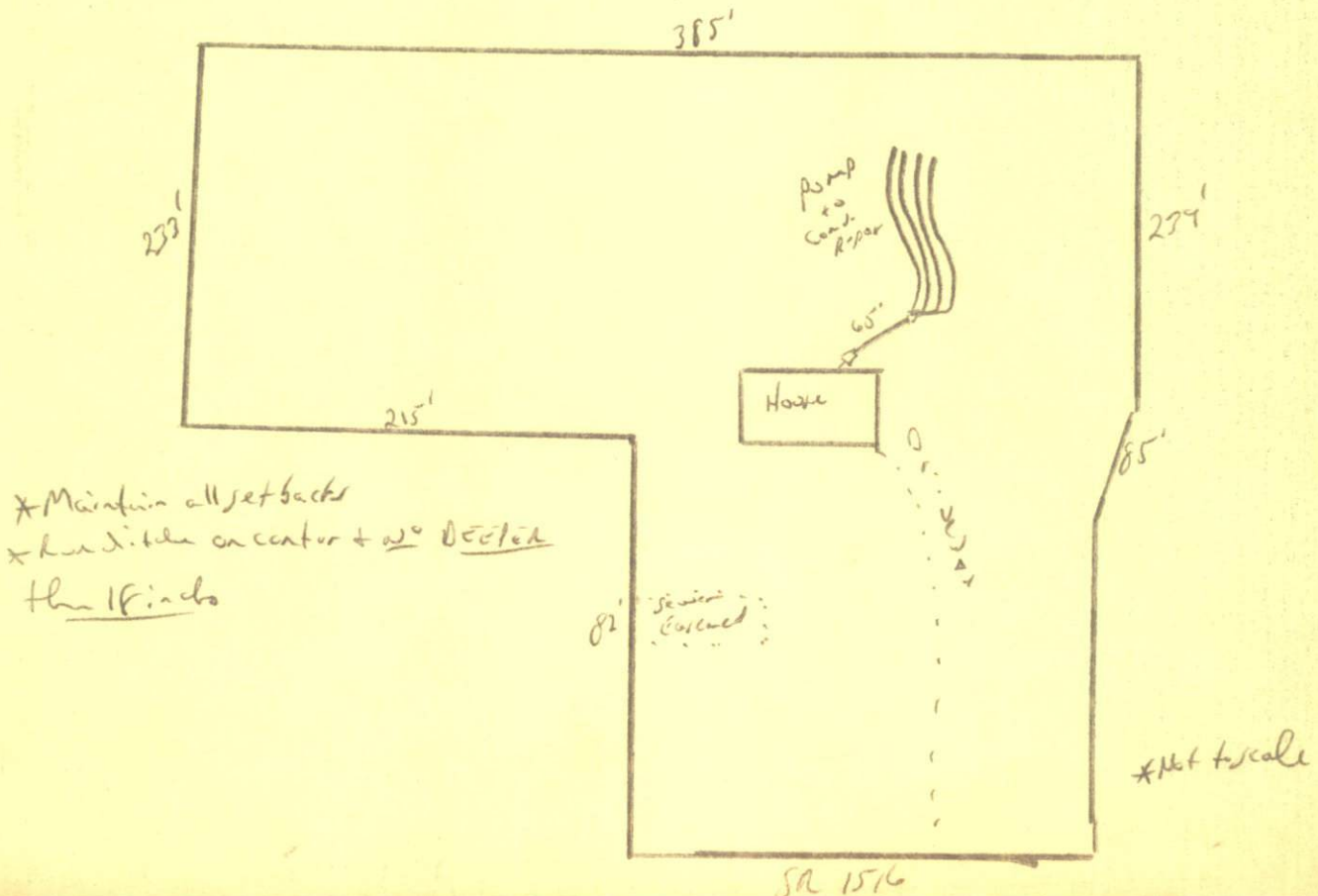

*Maintain all setbacks
*Run ditches on center + 20' depth
then 18" dia