

Doggendorf - Pool Proposal
 3-Bedroom Septic Relocation Proposal
 104 Lonnie Betts Drive

*Repair Area per existing permit with Harnett County Health Department is not impacted.



Existing System

System: Gravity
 Lines: 1-2 (140')

Proposed Primary System Modification

Abandon existing trenches.
 Add 2 new line as shown meeting all required setbacks.
 0.4 LTAR
 18" Trench Bottoms
 2- 120' Trenches - Innovative Product

Lonnie Betts Drive

Pool:

- 25' from House
- 21' from septic lines
- 75' from property line

Shed:

- 16' x 32' Enclosed
- 10' x 32' covered porch area
- 15' from pool
- 34' from property line
- 17' from house

* Size will now be 30 x 32 including covered porch
 Denny Doggendorf
 7/21/22

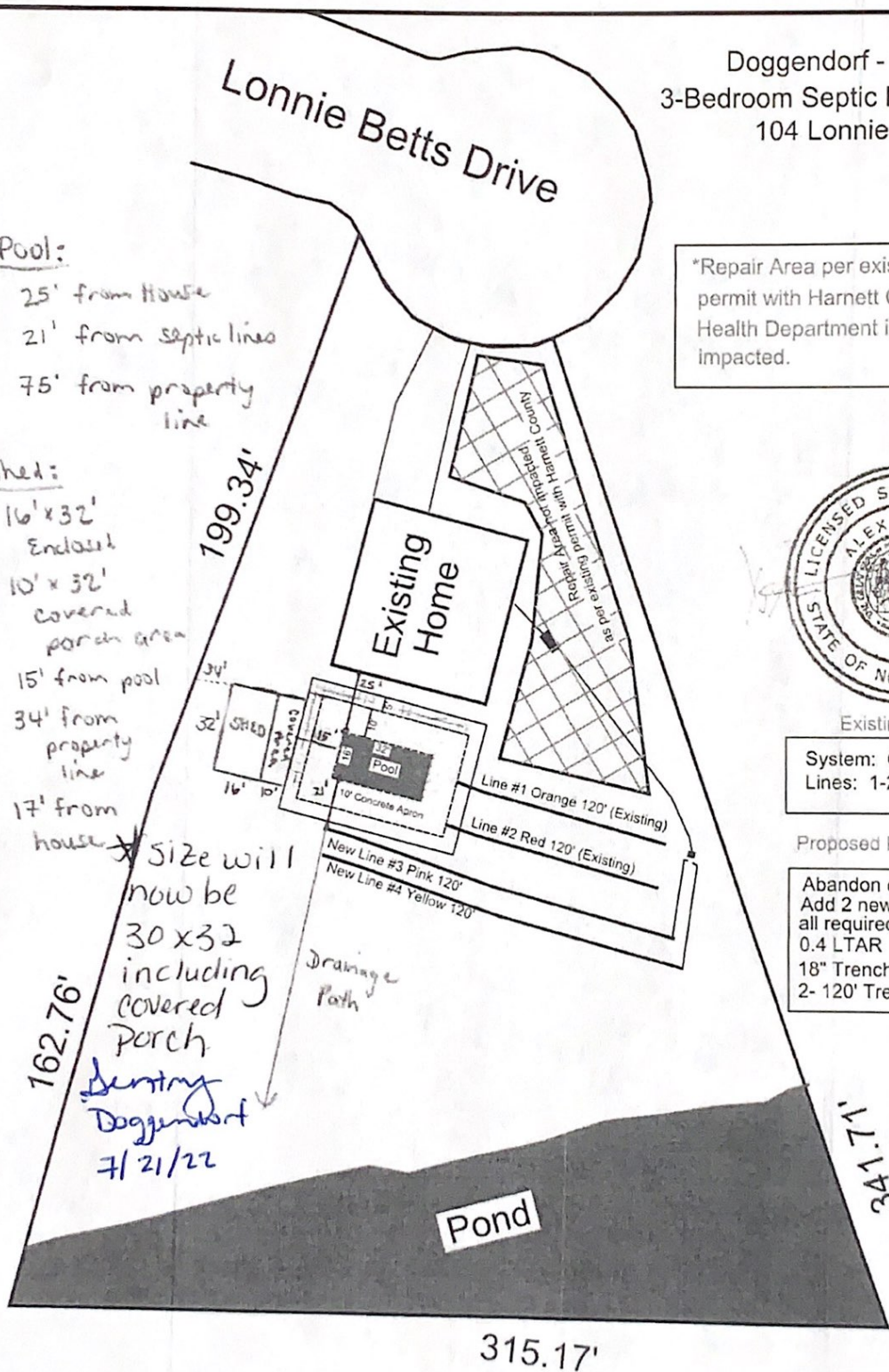

GRAPHIC SCALE
 1" = 50'



Adams
 Soil Consulting
 919-414-6761
 Job #830