

ROOF PLAN
 1/4" = 1'-0"

GD G DOUBLE CONSTRUCTION, INC
 (919) 469-4798 email: gdouble@nc.rr.com
 www.GDoubleConstruction.com www.GDoubleInc.com

JOB NAME: JOON SMITH

ADDRESS: 720 N 14TH ST
 ERWIN, NC

PLAN: ROOF PLAN

DATE: 8/17/22

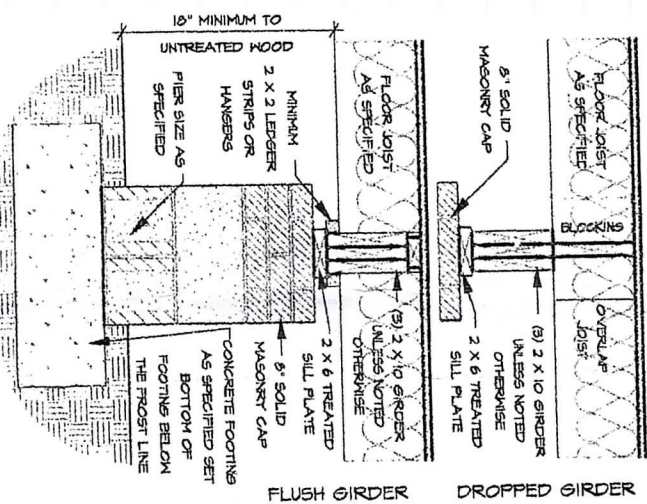
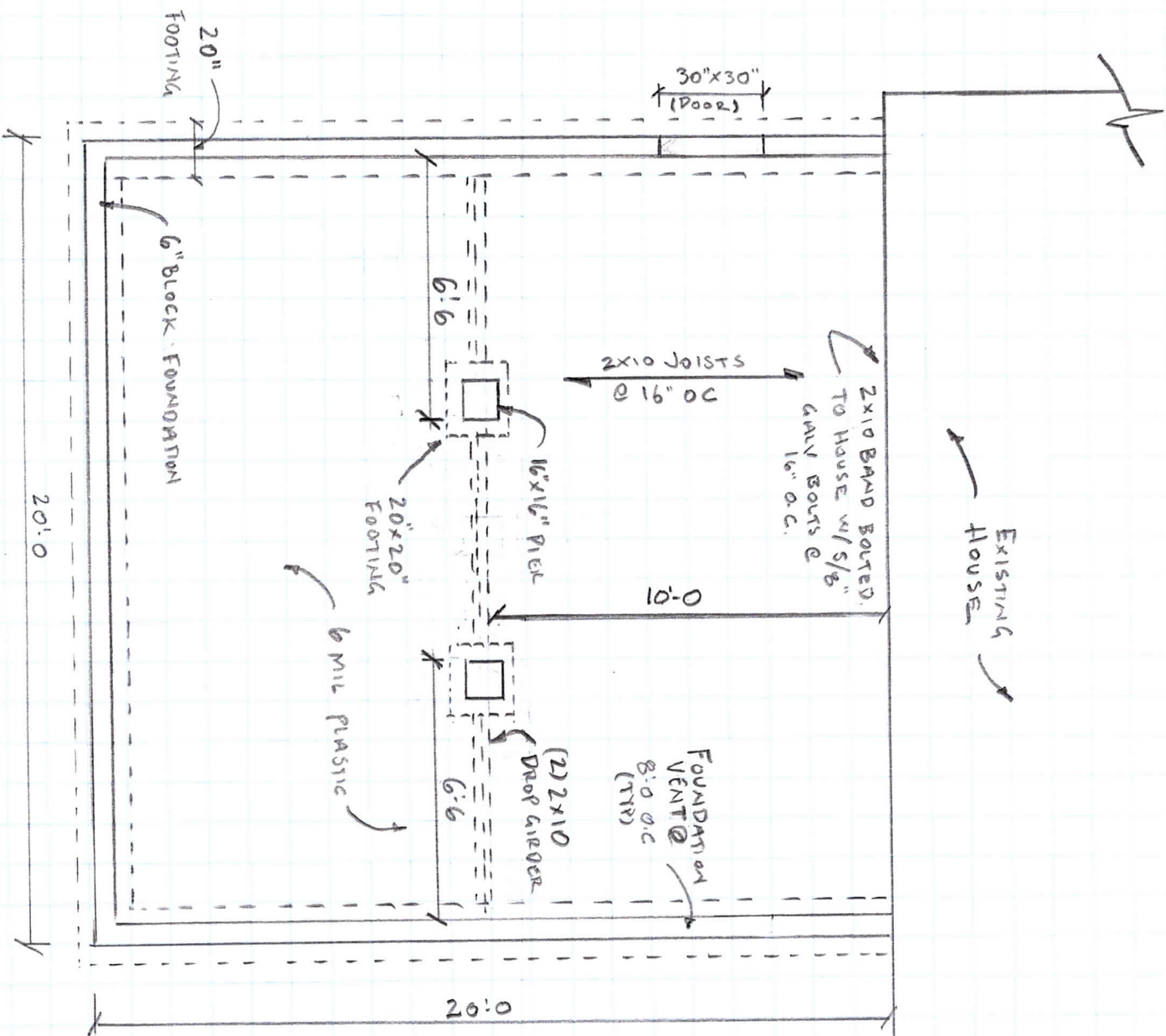

DROPPED/ FLUSH PIER
SCALE 3/4" = 1'-0"

TYPICAL WALL SECTION
SCALE 3/4" = 1'-0"

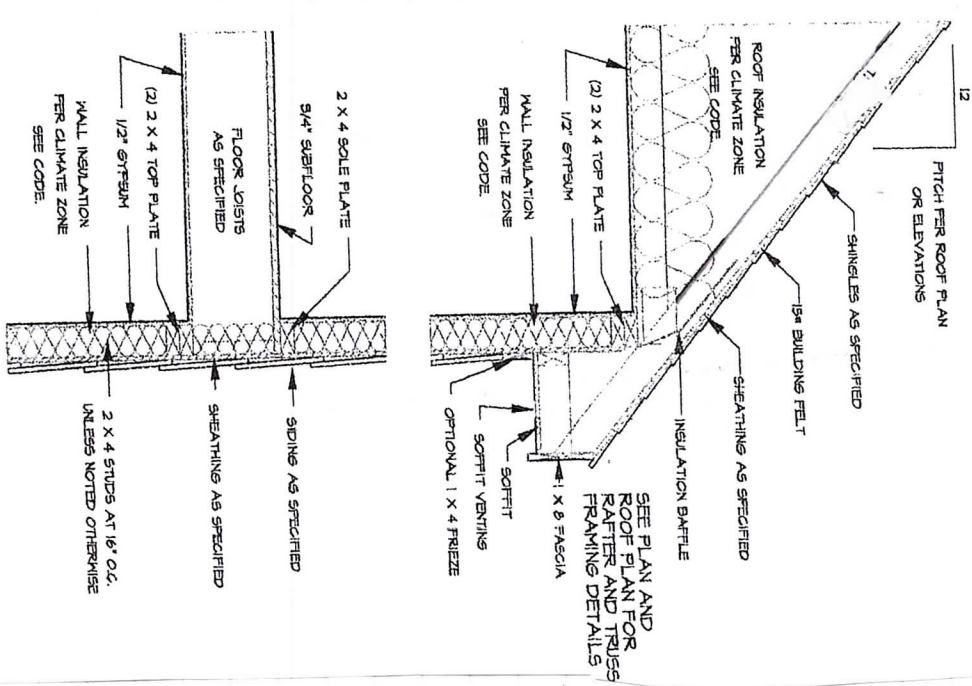

Room Addition (400 SF)

- Duties:**
- Provide framing plan & permit for entire project.
 - Foundation:** Dig trench for footing and install #4 Rebar. Treat soil for termites as per building code. Install 6 mil plastic on crawl space. Build a block foundation wall with a stucco finish to match the elevation of the main house.
 - Framing:** Demo existing deck from rear of home. Frame floor system to match elevation of house. Frame all walls with 2x4's creating 1-13' x 20' bedroom, full 6' x 14' bathroom, 5' x 8' closet. Site frame roof and ceiling with a gabled roof design. Master bedroom perimeter walls to have 4 single window units. Ceiling height shall be 9' to match the rest of the house. Frame a 9' x 11' tray ceiling in Master Bedroom.
 - Roof:** Cover all roof decking with synthetic underlayment then cover roof with matching shingles of the rest of the house.
 - Insulation:** Insulate walls with R-15, floor with R-19 and ceilings with R-38.
 - Plumbing:** Rough in and set water and drain lines for double 60" vanity, 1 elongated toilet, tub with shower. Add 1 water spigot to the rear of home. Tie drain and water lines into existing system of house.
 - HVAC:** Install 1 bath exhaust fan vent to exterior of home. Add 3 air supply ducts and 1 return in bedroom and bath addition. Upgrade existing HVAC system to entire home.
 - Electrical:** Wire and trim out 10 receptacles and 7 switches as per NC electrical code. Switches and receptacles shall include 2 bath vanity light and 1 bath exhaust fan, 1 recessed can over tub, 1 ceiling fan w/ light combo, 1 closet light and 1 flood light on exterior. Also, 5 recessed cans.
 - 1 recessed can at entry into bedroom, 1 ceiling fan and light in bedroom, and laundry room light.
 - Interior Trim & Closet:** Install 2 prehung interior doors, 1 pocket door, baseboards and casing that will match the rest of the house. Install custom wooden closet shelving and rods in bedroom closet.
 - Tile:** Install 1/2" backer board to walls. Install customer provided wall tile, grout and niche to walls above tub.
 - Flooring:** Install LVP tile in the bathroom and closet. Install carpet and padding in bedroom.
 - Exterior:** Install Hardi Plank siding & composite trim around perimeter of addition to match the rest of the house. Install vinyl, new construction windows that resembles the rest of the house.
 - Drywall:** Hang and finish gypsum wall boards on ceilings and walls using 1/2" drywall.
 - Painting:** Prime, prep, and paint the entire interior and exterior of addition.
 - Gutters:** Install seamless gutters and down spouts
 - Dispose of all debris. Provide portable bathroom for workers.

GD
G DOUBLE CONSTRUCTION, INC
(919) 489-4798
www.GDoubleConstruction.com

JOB NAME: JOONI SMITH

ADDRESS: 720 N 14TH STREET
EDWIN, NC

PLAN: FOUNDATION & DETAILS

DATE: 8/17/22