

HTE \_\_\_\_\_

# OPERATIONS PERMIT

Name: (owner) James + Pearl Smith  New Installation  Septic Tank  
 Property Location: SR# RADFORD RD  Repairs  Nitrification Line  
 Subdivision HANNA HEIGHTS Lot # 53754  
 Tax ID # \_\_\_\_\_ Quadrant # \_\_\_\_\_  
 Contractor: IVEY JOHNSON Registration # \_\_\_\_\_

Basement with Plumbing:  Garage:

Water Supply:  Well  Public  Community

Distance From Well: 50' ft.

Following are the specifications for the sewage disposal system on above captioned property.

Type of system:  Conventional  Other 25% Reduction Syst

Size of tank: Septic Tank: EXISTING gallons Pump Tank: \_\_\_\_\_ gallons

Subsurface	No. of	exact length	width of	depth of
Drainage Field	ditches <u>2</u>	of each ditch <u>120</u> ft.	ditches <u>3</u> ft.	ditches <u>24</u> in.

French Drain Required: - Linear feet

Date: 2-29-05

Inspected by: James E. Manshart  
Environmental Health Specialist

PERMIT NO. 21619

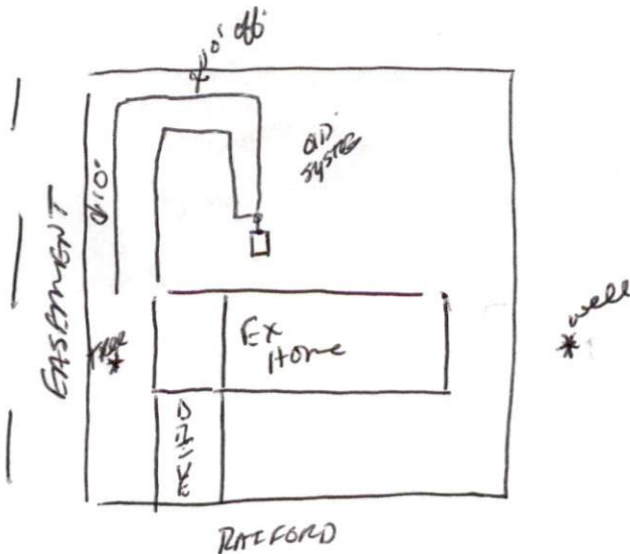

NETT COUNTY HEALTH DEPARTMENT

IMPROVEMENT PERMIT

21619

HTE \_\_\_\_\_

Be it ordained by the Harnett County Board of Health as follows: Section III, Item B. "No Person shall begin construction of any building at which a septic tank system is to be used for disposal of sewage without first obtaining a written permit from the Harnett County Health Department."

Name: (owner) James + Pearl Smith  New Installation  Septic Tank  
Property Location: SR# RACFORD RD - ENFARWIS  Repairs  Nitrification Line

Subdivision HANNA HEIGHTS Lot # 53154

Tax ID # \_\_\_\_\_ Quadrant # \_\_\_\_\_

Number of Bedrooms Proposed: 3 Lot Size: 100 X 150'

Basement with Plumbing:  Garage:

Water Supply:  Well  Public  Community

Distance From Well: 50' ft.

Following is the minimum specifications for sewage disposal system on above captioned property. Subject to final approval.

Type of system:  Conventional  Other 75% Reduction System

Size of tank: Septic Tank: EPSTEIN gallons Pump Tank: \_\_\_\_\_ gallons

Subsurface Drainage Field No. of ditches 2 exact length of each ditch 120 ft. width of ditches 3 ft. depth of ditches 24 in.

French Drain Required: - Linear feet

Date: 2-17-05

This permit is subject to revocation if site plans or intended use change.

Signed: James E. Markham  
Environmental Health Specialist

