

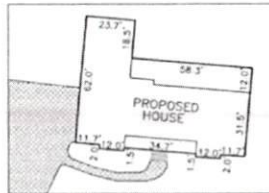

CURVE	RADIUS	LENGTH	DELTA	CHORD	CH. BEARING
C-1	205.00'	64.38'	17°59'36"	64.11'	N 74°38'34"W
C-2	255.00'	80.10'	17°59'54"	79.77'	N 74°43'31"W

BOBBY JOE & JANE LONG
 PIN #0671-25-2648.000
 D.B. 3370 PG. 122
 MAP #2003-1157



NOTES

NOT AN ACTUAL SURVEY AREA BY COORDINATES

THIS PLAT DID NOT HAVE THE BENEFIT OF A TITLE REPORT AND IS SUBJECT TO ANY MATTERS ONE MAY DISCLOSE.

PROPERTY SUBJECT TO BOTH ABOVE AND/OR BELOW GROUND UTILITIES AND/OR EASEMENTS.

CALL 811 BEFORE ANY DIGGING OR CONSTRUCTION.

THIS PROPERTY IS NOT LOCATED IN A FLOOD HAZARD AREA PER F.E.M.A. MAP #3720066000J EFF. DATE: 10/3/2006 ZONE X

PROPERTY ZONED RA-30

SETBACKS

FRONT - 35'
 SIDE - 10'
 REAR - 25'
 CORNER - 20'

LEGEND

EIS - EXISTING IRON STAKE
 ERS - EXISTING IRON STAKE
 D.B. - DEED BOOK
 NTS - NOT TO SCALE

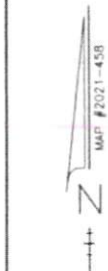

I, BENTON W. DEWAR CERTIFY THAT THIS PLAT WAS DRAWN UNDER MY SUPERVISION FROM AN ACTUAL SURVEY MADE UNDER MY SUPERVISION THAT THE BASIS OF PRECEDENCE IS 1. N/A THAT THE BOUNDARIES NOT SURVEYED ARE SHOWN AS DASHED LINES PLOTTED FROM INFORMATION FOUND IN BOOK 4001 PAGE 363 THAT THIS PLAT DOES NOT MEET SIZE REQUIREMENTS FOR RECORDING IN THE REGISTER OF DEEDS PER G.S. 47-30 AS AMENDED. LICENSE NUMBER AND SIGN THIS 20th DAY OF OCTOBER 20.21

Benton W. Dewar
 PROFESSIONAL LAND SURVEYOR L-3649

THIS PLAT MAY NOT BE A CERTIFIED SURVEY AND HAS NOT BEEN REVIEWED BY A LOCAL GOVERNMENT AGENCY FOR COMPLIANCE WITH ANY APPLICABLE LAND DEVELOPMENT REGULATIONS AND HAS NOT BEEN REVIEWED FOR COMPLIANCE WITH RECORDING REQUIREMENTS FOR PLATS

