

Subject **Your Steel Craft Structures Order (#1652391114898213-4)**
 From Steelcraft Structures <sales@steelcraftmetal.com>
 Sender <sales=steelcraftmetal.com@mg.idearoominc.com>
 To <chris.kiper@att.net>
 Date 2022-05-25 09:51



STEEL CRAFT

Steel Craft Structures
 1841 Amity Hill Rd.
 Statesville, NC 28625
 980-434-5400
 sales@steelcraftmetal.com

Customer Order - **May 25, 2022**

Sales Rep: John Moreno

Ship To			Dealer		
Name	John Kiper	Order #	1652391114898213		
Billing Address	10339 Hwy NC42				
City	Holly springs	State	NC	Zip Code	27540
Install Address	10339 Hwy NC42				
City	Holly Springs	State	NC	Zip Code	27540
Email	chris.kiper@att.net	Phone #	919-812-2088	Mobile #	919-812-2088
			First Choice Carports 224 Metcalf CT Spartanburg SC 219306 Phone: 864-580-8589 john@firstchoicecarports.com		

Building Info		Size		Color		Anchoring & Site Preparation	
Style:	Garage	25' X 26' X 10'	Width X Roof Length X Leg Height	Roof	Charcoal <input type="checkbox"/>	Installation Surface	Cement
Roof Overhang:	6"			Trim:	Evergreen <input type="checkbox"/>	Power Available	<input checked="" type="checkbox"/>
Roof Style:	Vertical Style			Gable End Siding	Old Town Gray <input type="checkbox"/>	Site Ready	<input checked="" type="checkbox"/>
Gauge:	14-Gauge Framing			Side Wall Siding	Old Town Gray <input type="checkbox"/>	Jobsite Level Within 6"	<input checked="" type="checkbox"/>
Leg Style:	Standard					Engineer Certified: Certification included	
Brace:	Standard Brace						

Design Link & Notes

Design Link: <https://carportview.steelcraftmetal.com/#ba8b50a6d89feea2fd4116e2feaf33bc>

Building Images

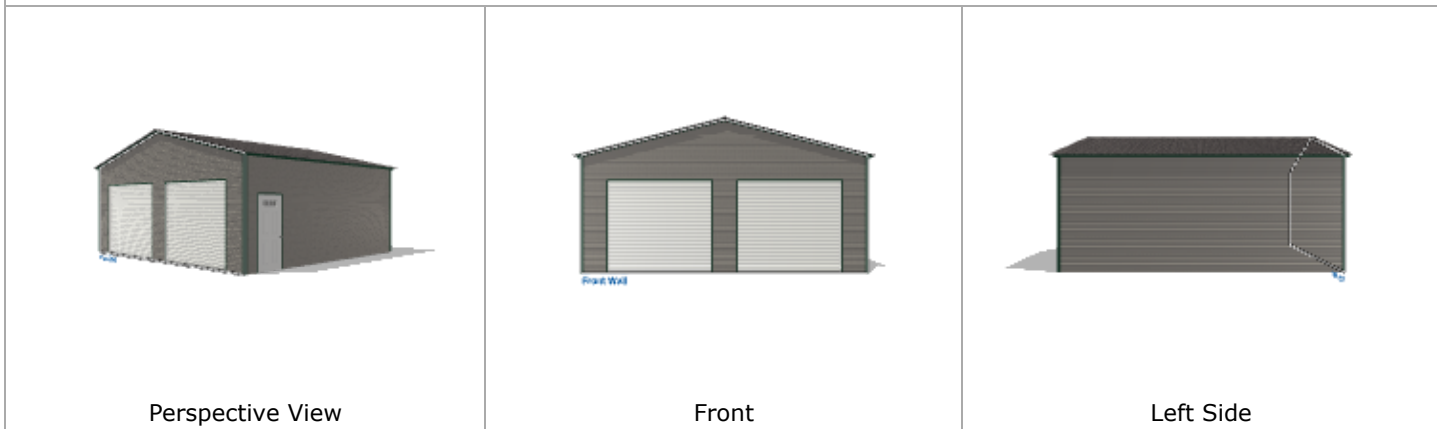

Building Images



Right Side

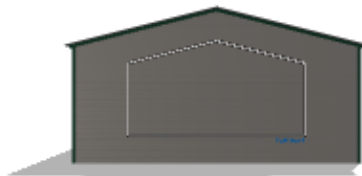

Back

LEFT SIDE

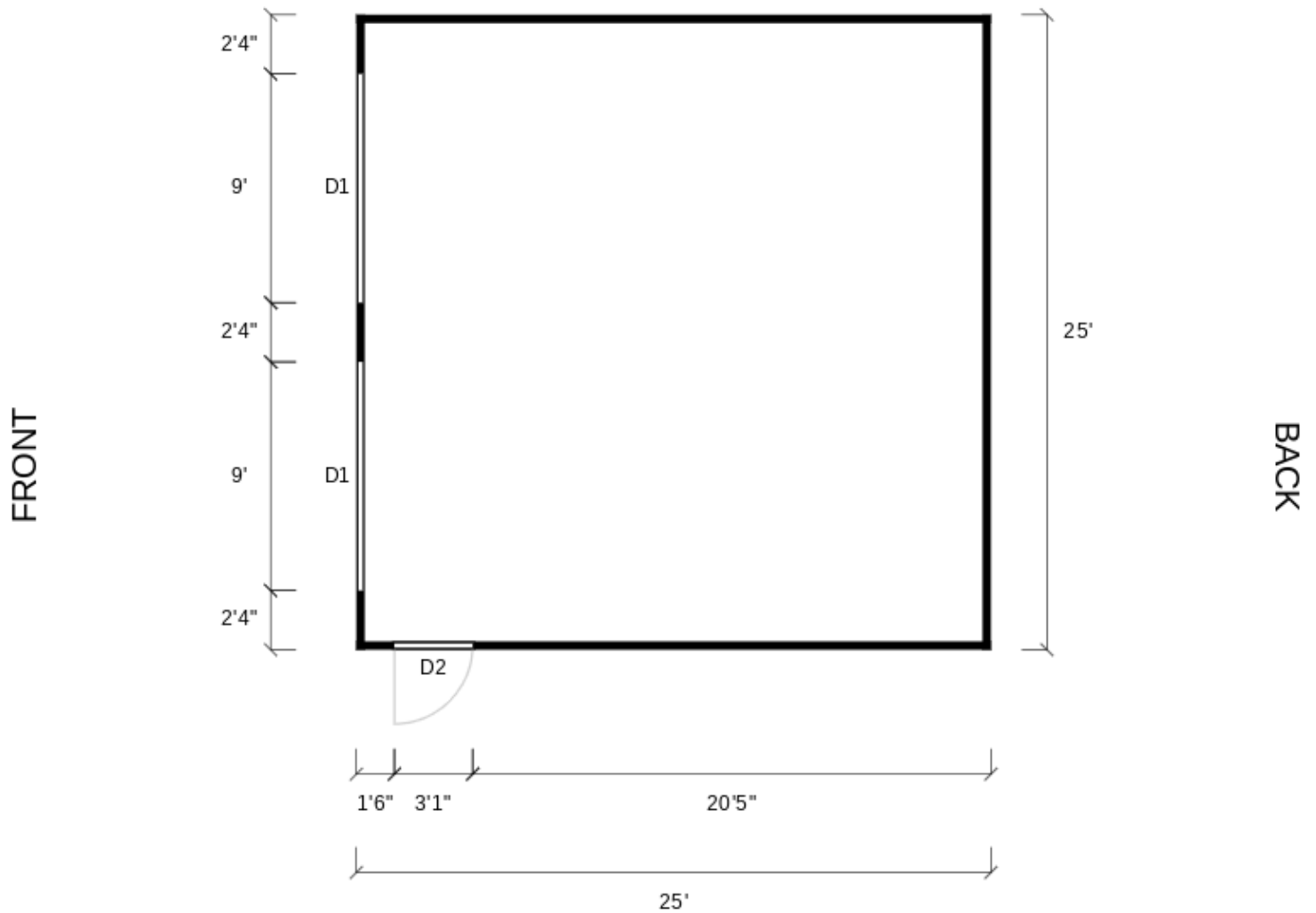

RIGHT SIDE

SYMBOL LEGEND

D1 9'x8' Garage Door

D2 4-Lite Walk-in Door

Closed Wall

Section	Description	Quantity	Amount
Structure Details			
	Style: Garage	1	-
	Base Price: 25'x26'	1	\$3,932.25
	Roof: Charcoal	1	-
	Trim: Evergreen	1	-
	Gable End Siding: Old Town Gray	1	-
	Side Wall Siding: Old Town Gray	1	-
	Roof Style: Vertical Style	1	-
	Roof Overhang: 6"	1	-
	Trusses: Triple Wide	1	-
	Leg Style: Standard	1	-
	Gauge: 14-Gauge Framing	1	-
	Brace: Standard Brace	1	-
	Engineer Certified: Certification included	1	-
	Leg Height: 10'	1	\$462.00
	Left Side: Fully Enclosed	1	\$420.00
	Left Side Siding: Horizontal	1	-
	Right Side: Fully Enclosed	1	\$420.00
	Right Side Siding: Horizontal	1	-
	Front End: Fully Enclosed	1	\$1,459.50
	Front End Siding: Horizontal	1	-
	Back End: Fully Enclosed	1	\$1,459.50
	Back End Siding: Horizontal	1	-
Roll Doors & Ramps			
	9'x8' Garage Door	2	\$1,700.00
Doors & Ramps			
	4-Lite Walk-in Door	1	\$437.50
Frameouts			
	Corner Style: Square (Traditional)	2	-
Building Estimate:			\$10,290.75
Material Surcharge:			\$1,440.71
Subtotal:			\$11,731.46
Sales Tax (7.25%):			\$850.53
Total Order Amount:			\$12,582.00
Deposit Required to Order:			\$1,543.61
Final Balance Due at Installation:			\$11,038.38

Signatures

Customer Signature:

John Kiper
 dotloop verified
 05/25/22 12:01 PM EDT
 U5UN-NLJE-ALDC-MT6D

Date:

Delivery Notes:

Dealer or Manufacturer Signature:

John Moreno
 dotloop verified
 05/25/22 11:57 AM EDT
 0CKO-ILIE-XQFO-NKOG

Date:

This purchase agreement (the "Agreement") is made by and between Steel Craft Structures, LLC, and the Buyer. Buyer agrees, after being fully educated about Steelcraft Structure's various products, include the fourteen (14) gauge, twelve (12) gauge, non-certified, and certified units, to buy, and Steel Craft Structures agrees to sell, pursuant to the terms listed in this Agreement described above. Buyer has read and understands the terms of this agreement, including the terms and conditions contained at the bottom of this document, which terms are expressly incorporated herein by reference, as well as any and all relevant warranty information and agrees to be bound by same.

Terms, Conditions, and Warranties

1. Steel Craft Structures shall have the right to correct any errors made by any party in regard to pricing and/or sales tax.
2. Lot must be level prior to installation, otherwise unit may be installed 'as is' and any and all warranties will be void.
3. Buyer is aware of Steel Craft Structures' various products and warranties, without limitation the following:
 - a. Standard (Non-certified) Units - This unit is built according to the manufacturer's specifications and industry standards, but will not likely be available for a building permit in certain areas. Inquire for warranty information.
 - i. Standard Fourteen (14) Gauge Unit - The fourteen (14) gauge unit references the tubing thickness used on the framing. Those units are constructed with 2 1/2" x 2 1/2" square tubing. Inquire for warranty information.
 - ii. Standard Twelve (12) Gauge Unit - The twelve (12) gauge unit is constructed of more rigid 2 1/4" x 2 1/4" square tubing, which offers a higher tensile strength and thickness of material. Inquire for warranty information.
 - b. Certified Units - These units, available in fourteen (14) or twelve (12) gauge, are typically installed in areas that require building permits. Certified units are built according to engineer specifications and engineer blueprint/drawings.
 - c. Anchors - All units are secured with anchors that pass through the base rail of the frame and into the ground (concrete, asphalt, etc.) The base rail is affixed only to the installation surface with those anchors and the Buyer is aware of and understands and agrees that he/she may experience water leakage under the baserail.
 - i. Standard (Non-Certified) Units - These units are anchored with rebar anchors for ground installation or concrete wedge anchors for concrete installations. The rebar anchors are thirty-two inches (32") long but may be shortened in length when installing on difficult terrain. Mobile home (auger type) anchors are available for non-certified units at a small additional charge.
 - ii. Certified Units - The standard anchor for this unit is the mobile home (auger type) anchor for ground installations. We utilize concrete anchors for concrete installations. There is an additional charge for installing mobile home (auger type) anchors on asphalt.
4. Buyer is responsible for informing the Independent Installation Contractors of any underground cables, gas lines, utility hazards or relevant matters prior to commencement of installation. Buyer agrees to indemnify and hold Steel Craft Structures (the manufacturer) and the Dealer (seller) harmless for any damage done to submerged lines, pipes, cables, or other utility instrumentalities during installation.
5. Buyer shall be solely responsible for, and shall obtain, any and all necessary city, county, or state permits prior to commencement of installation. Buyer agrees to indemnify and hold Steel Craft Structures and the Dealer (seller) harmless for violation of any and all city and county ordinances or codes and/or covenants, set-backs and restrictions.
6. Payment Terms
 - a. Down Payment --Buyer shall pay the Steel Craft Structures Authorized Dealer a 10%-15% deposit based on the retail (before tax) purchase price. The Buyer shall not pay the Steel Craft Structures Authorized Dealer an amount exceeding the above mentioned deposit. In the event that Buyer pays an amount exceeding the above mentioned deposit, Buyer does so at his/her own risk, understanding that he/she is contractually obligated to remit the remaining eighty-five to ninety percent (85%-90%) of the purchase price as set forth below.
 - b. Balance - Buyer shall pay the remaining balance of eighty-five to ninety percent (85%-90%) to the installation crew on the date of installation. Payment may be made by check or money order to the crew. To pay the balance by credit card, call to process your payment at 980-434-5400.
 - c. Excessive Down Payments - If Buyer pays more than the required deposit/down payment, at the time of the sale, Steel Craft Structures must receive those excessive funds from the Steel Craft Structures Authorized Dealer prior to installation.
 - d. Refunds - In the event Buyer cancels the order, Buyer will receive no refund of the down payment. Specifically, there are NO REFUNDS on special orders.
7. If Buyer alters the unit in any manner, including without limitation any interior or exterior modifications, installing electric or plumbing to the unit, all warranties shall be immediately void.
8. Buyer will pay an additional "labor charge" of not less than fifty dollars (\$50.00) if installers are required to dig, cut frame to level, transport materials more than fifty feet (50'), install on any wall or deck, or to install over any existing obstruction or structure. Buyer agrees to notify the Steel Craft Structures Authorized Dealer of any of these conditions at the time of the sale.
9. Buyer will pay a service charge of not less than 12% if installers cannot install the unit initially and the unit has to be reshipped due to any, but not limited to the following: Customer error, un-level installation site, concrete pad out of square, etc.
10. Steel Craft Structures and the Steel Craft Structures Authorized Dealer will not be liable to Buyer for punitive, indirect, incidental, special or consequential damages resulting from any defect or deficiencies in accepted items. For more specific terms, please contact us.
11. Steel Craft Structures and the Steel Craft Structures Authorized Dealer are not responsible for changes in delivery dates caused by circumstances beyond our control (weather, equipment breakdown, etc.). It is Steel Craft Structures intent to keep installation time frames to a minimum at all times, however, given that the weather is unpredictable and can vary from day to day, and state to state, thus we do not have an accurate way to predict dedicated leads times regardless of any statement made by any party in regard to lead times.
12. The Agreement shall be interpreted and construed according to, and governed by, the laws of the state of North Carolina. The parties hereto: (i) consent to submit itself to the personal jurisdiction of any state of federal court sitting in the County of Iredell, State of North Carolina, in any action or proceeding arising out of or relating to this Agreement, (ii) agree that all claims in respect of such action or proceeding may be heard and determined in such court, (iii) agree that they shall not attempt to deny or defeat such personal jurisdiction by motion or other request for leave from any such court, and (iv) agree not to bring any action or proceeding arising out of or relating to this Agreement in any other court. Each of the parties waive any defense of inconvenient forum to the maintenance of any action or proceeding so brought and waives any bond, surety, or other security that might be required of the other party with respect thereto.
13. The parties attest that this Agreement is the complete and exclusive statement of the agreement between the parties, and supersedes all prior written or oral communications, representations and agreements relating to the subject matter of this agreement. The terms of this Agreement, save and except the price term in the event of a pricing error/change order, may be modified or amended by a written instrument executed by the parties hereto.
14. It is the customer's responsibility to provide a telescoping lift for the installation of any of the following units:
 - o Any units w/ 14' tall or taller legs
 - o Any units w/ double legs or ladder legs
 - o Any units that are clear span
 - o Any units 28' or wider that have 12' tall or taller legs

The lift will be needed at the start of installation for a minimum of one full day with the possibility of needing the lift for multiple days depending on the size of the unit.
15. Customer will be required to pay half of the retail balance on any unit \$15,000.00 and higher prior to the unit being manufactured.
16. Customer expressly agrees that the unit shall remain property of Steel Craft Structures until payment in full is received. Steel Craft Structures hereby retains a purchase money interest in said building as set forth in Section 9 of the Uniform Commercial Codes enacted in the state where building is installed. Failure to pay will result in repossession of unit. This does not relieve the customer from liability for specific performance of the contract including legal fees and court costs, at the seller's option.

5/25/22, 11:54 AM

Roundcube Webmail :: Your Steel Craft Structures Order (#1652391114898213-4)

17. Steel Craft Structures strongly recommends any unit longer than 36' be purchased in the Vertical Roof, roof style configuration to avoid possible leaks and or rust at the overlap seam. Any unit that is purchased 37' long or longer will forfeit all warranties other than the workmanship warranty. The workmanship warranty on units that are 37' long or longer will be 30 days from the date of install.
18. Current approximate lead time is _____. You accept and understand a week consists of 5 business days. Scheduling may change ~~due to weather from time to time~~.

Customer Initials: _____

John Riper

dotloop verified
05/25/22 12:01 PM EDT
63ZK-NSUC-TTSC-J7OX

Pricing Table (For Internal Use): - Steel Craft Structures

This estimate is provided by Steel Craft Structures. Use of this estimate with any other company violates the terms and conditions of Steel Craft Structures and will be subject to legal action.



STEEL CRAFT

Steel Craft Structures

1841 Amity Hill Rd.

Statesville, NC, 28625

980-434-5400

sales@steelcraftmetal.com